



NOTES

BT SKYLINE No. **BS0066**

PROJECT No.	COM-0027685
CSID	12406601
CSR	6899
VFID	87565_7
CELL No.	689902

COM-0027685			
A	CONSTRUCTION	14.03.24	HFC/HFC
ISS	REVISION	DATE	DRN APP



CELLNEX UK
 R+, 4TH FLOOR, 2 BLAGRAVE STREET, READING, RG1 1AZ
 Tel. 020 4526 8553

SITE No **163403**
 WORLE TE
 ST MARKS ROAD
 WORLE
 WESTON SUPER MARE
 NORTH SOMERSET
 BS22 7PW

NGR **ST 36110 63210**
 OS GRID **336110 163210**

TITLE
 SITE PLAN ENHANCED
 CONSTRUCTION
 VODAFONE

SCALE **1:250**

DRAWN	HFC	14.03.24
APPROVED	HFC	14.03.24

DRG No. **163403-04-201-MD013** Sheet 1 of 1 Rev **A**

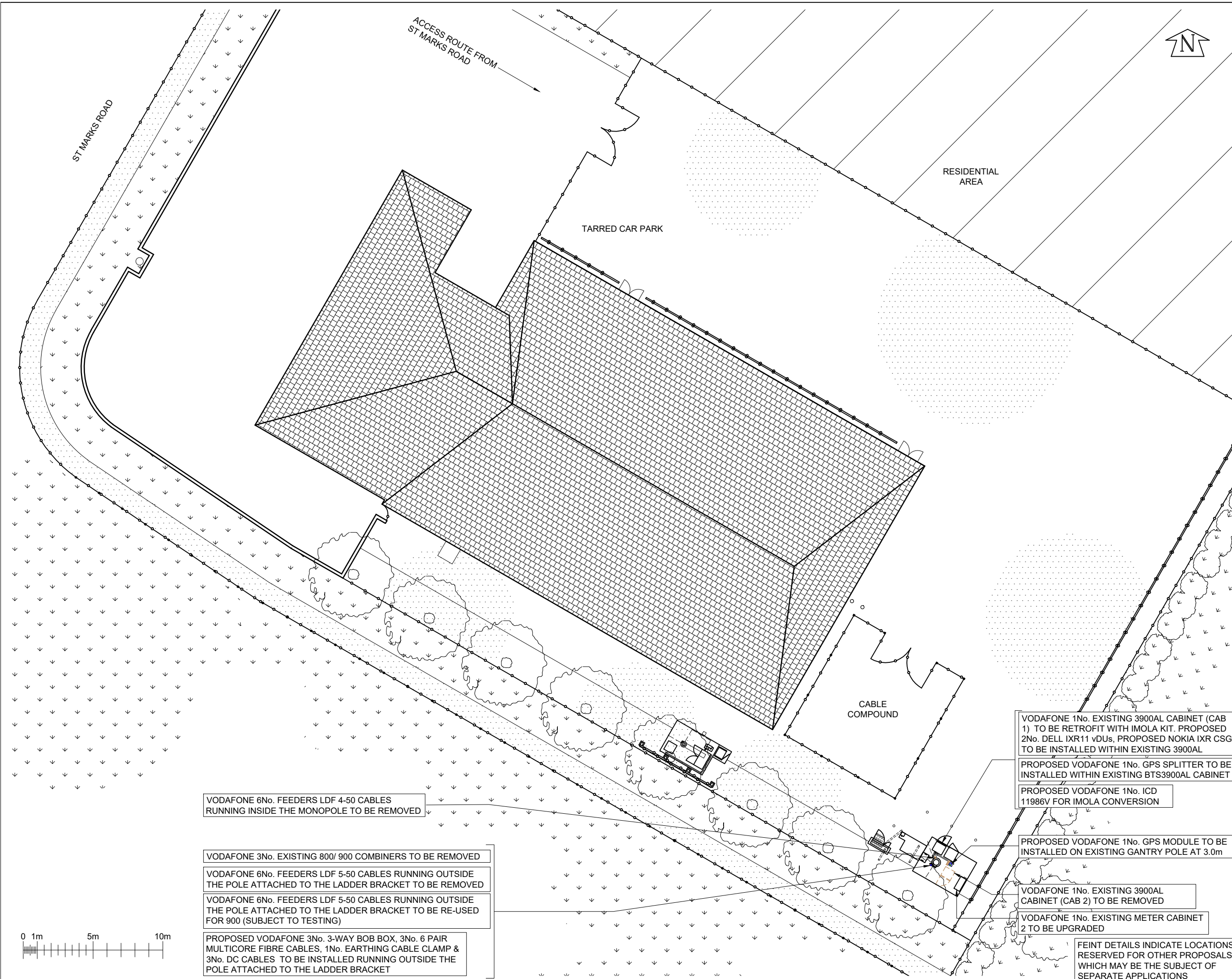

VODAFONE 6No. FEEDERS LDF 4-50 CABLES RUNNING INSIDE THE MONOPOLE TO BE REMOVED

VODAFONE 3No. EXISTING 800/ 900 COMBINERS TO BE REMOVED

VODAFONE 6No. FEEDERS LDF 5-50 CABLES RUNNING OUTSIDE THE POLE ATTACHED TO THE LADDER BRACKET TO BE REMOVED

VODAFONE 6No. FEEDERS LDF 5-50 CABLES RUNNING OUTSIDE THE POLE ATTACHED TO THE LADDER BRACKET TO BE RE-USED FOR 900 (SUBJECT TO TESTING)

PROPOSED VODAFONE 3No. 3-WAY BOB BOX, 3No. 6 PAIR MULTICORE FIBRE CABLES, 1No. EARTHING CABLE CLAMP & 3No. DC CABLES TO BE INSTALLED RUNNING OUTSIDE THE POLE ATTACHED TO THE LADDER BRACKET

VODAFONE 1No. EXISTING 3900AL CABINET (CAB 1) TO BE RETROFIT WITH IMOLA KIT. PROPOSED 2No. DELL IXR11 vDUs, PROPOSED NOKIA IXR CSG TO BE INSTALLED WITHIN EXISTING 3900AL

PROPOSED VODAFONE 1No. GPS SPLITTER TO BE INSTALLED WITHIN EXISTING BTS3900AL CABINET

PROPOSED VODAFONE 1No. ICD 11986V FOR IMOLA CONVERSION

PROPOSED VODAFONE 1No. GPS MODULE TO BE INSTALLED ON EXISTING GANTRY POLE AT 3.0m

VODAFONE 1No. EXISTING 3900AL CABINET (CAB 2) TO BE REMOVED

VODAFONE 1No. EXISTING METER CABINET 2 TO BE UPGRADED

FEINT DETAILS INDICATE LOCATIONS RESERVED FOR OTHER PROPOSALS WHICH MAY BE THE SUBJECT OF SEPARATE APPLICATIONS