

This Site Plan to be read with  
Heritage Report and Arboreal Report.

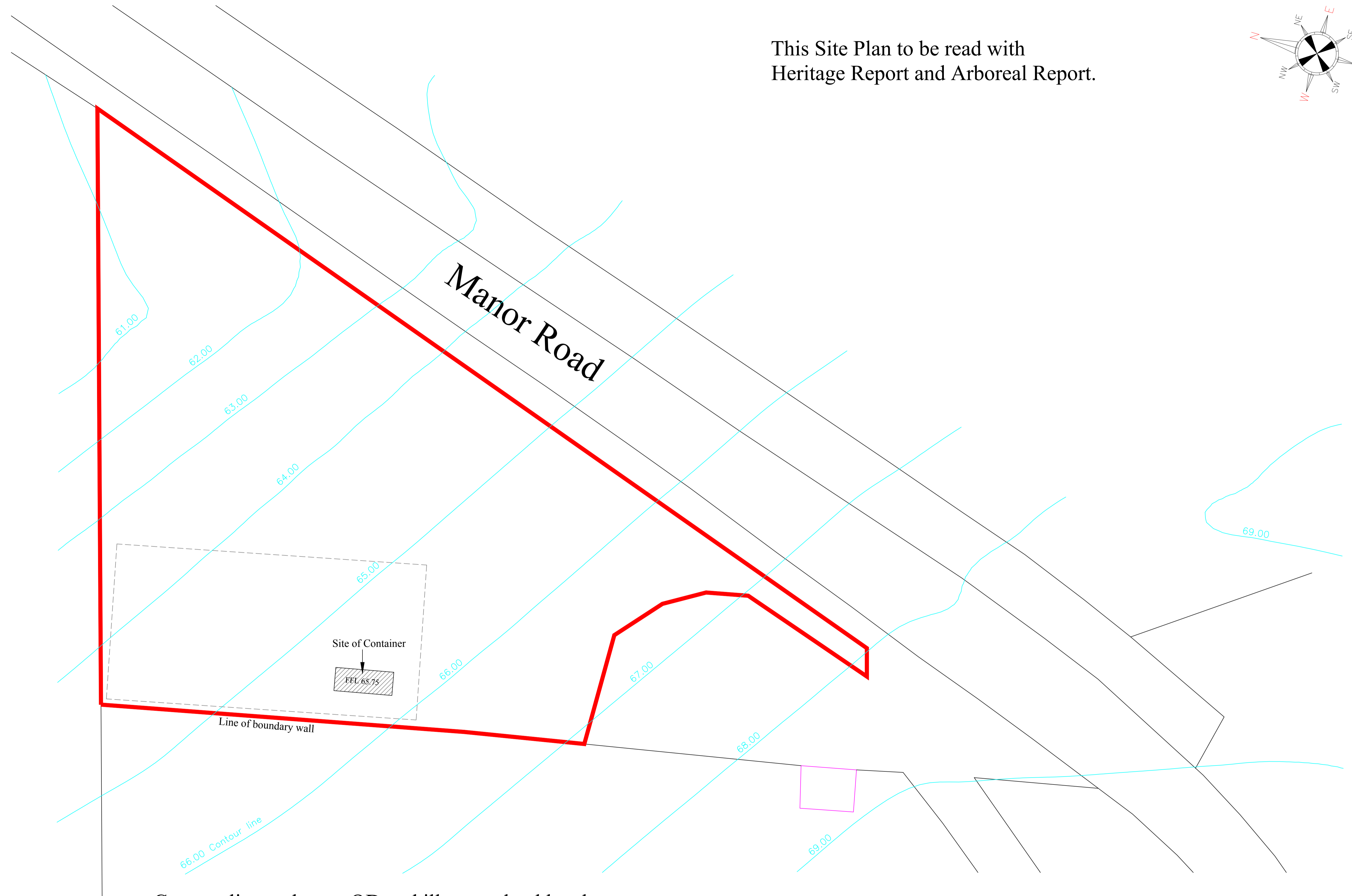
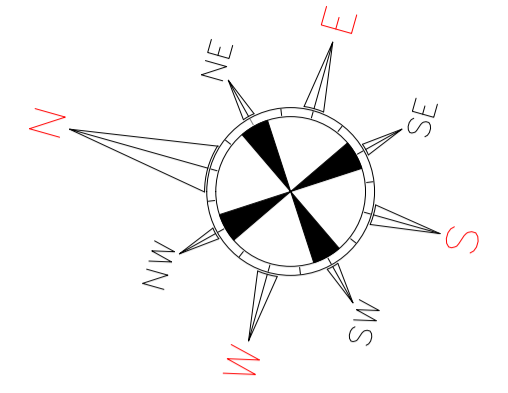

Contour lines relate to OD and illustrate land levels  
at 1.0m changes.

ALL LEVELS AND DIMENSIONS MUST BE CHECKED ON SITE. THESE DRAWINGS ARE TO BE READ IN CONJUNCTION WITH ENGINEERS, AND ALL OTHER SPECIALIST CONSULTANT DETAILS. THIS DRAWING IS COPYRIGHT OF MACAIRE ASSOCIATES. IT IS THE CLIENTS RESPONSIBILITY TO AGREE ANY ALTERATIONS TO APPROVED PLANS WITH THE PLANNING AND BUILDING REGULATION AUTHORITIES.

IT IS THE CLIENTS RESPONSIBILITY TO READ AND COMPLY WITH CONDITIONS IMPOSED ON ANY PLANNING AND BUILDING REGULATION APPROVALS ASSOCIATED WITH THESE PLANS, INCLUDING AGREEING MATERIALS AND FINISHES WITH PLANNERS PRIOR TO COMMENCEMENT.

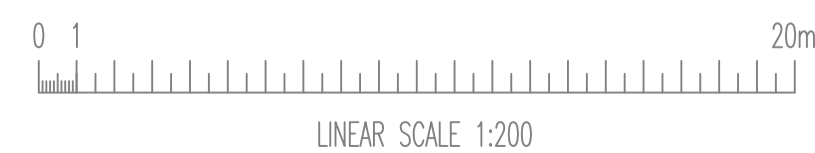

Date  
March 2024

Drawn by  
PM

Checked by

Revision

Scale  
A1 @1:200

Drawing No.  
3-2023-1

Location:  
Site Adj Shanklin Manor  
Manor Road,  
Shanklin.

Project:  
Nature Conservation Wildlife Project,  
Site Plan.

'The Dairy' at Heberdens,  
Yarmouth Road, Shalfleet,  
Newport,  
Isle Of Wight,  
PO30 4NB.

Tel: 01983 555132

