

Notes & Legend:

- Category A trees ● Category B trees ●
- Category C trees ● Category U trees ●
- RPAs Trees to be removed (red crowns and numbers)
- BS5837 Specification Ground Protection
- No Dig Permeable Hard Surface Treatment
- Tree Protective Fencing —●—●—●—●—●—●—●—●—●—
- Proposed development —

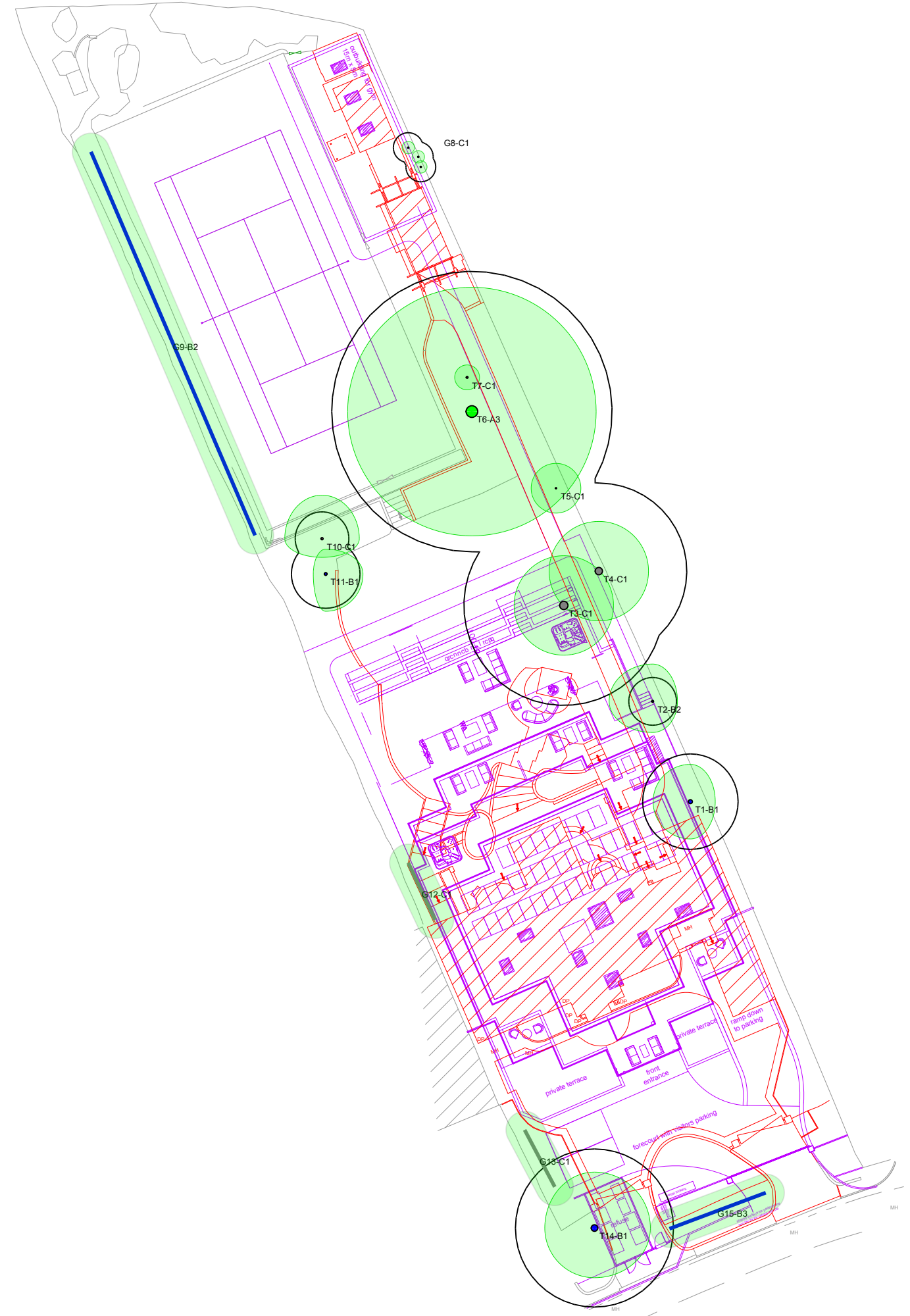

<p>Jomas Associates Ltd. Unit 24 Sarum Complex, Salisbury Road, Uxbridge, UB8 2RZ. Email: info@jomasassociates.com Tel: 0333 305 9054 www.jomasassociates.com</p>	
Client:	Date: November 13th 2023
Scale @ A3:	Ref: Figure 1
Site: 20 Watford Road Radlett	Scale @ A3: 1:400
	Title: Tree Constraints Plan