

GROUND FLOOR PLAN
Scale 1:50 @ A1 or 1:100 @ A3

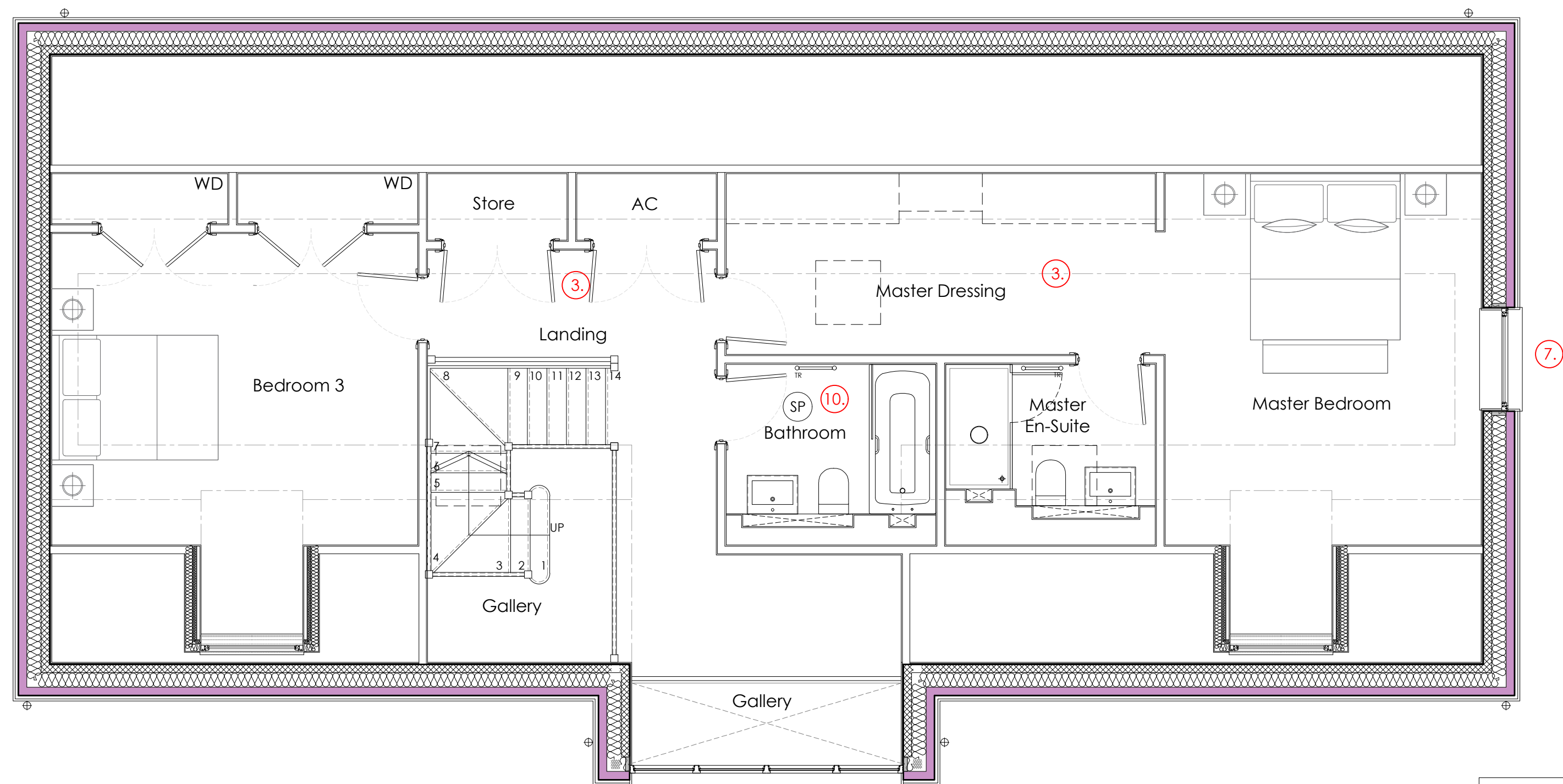

FIRST FLOOR PLAN
Scale 1:50 @ A1 or 1:100 @ A3

FLOOR AREAS (GROSS INTERNAL)

	Ground	First	Total
PLOT 5	129.30m ²	80.05m ²	209.35m ² (2253.44sqft)

Note: For sales purposes all floor areas in rooms-in-roof are taken to 1500mm high oshlar wall line.

PLOT 5 SCHEDULE OF ALTERATIONS

ITEM	DESCRIPTION
1.	Windows (2no.) omitted ground floor side (south east) elevation
2.	Window omitted from ground floor rear (north east) elevation
3.	Roof lights omitted (5no.)
4.	Dormers (2no.) shown on roof plan (missing on previous revision in error)
5.	Ground floor window sizes altered on front (south west) and rear (north east) elevation
6.	Flue removed
7.	Window size amended to first floor side (north west) elevation
8.	Faux stable doors removed on front (south west) and rear (north east) elevation
9.	Low level brick plinth removed
10.	Sun pipe added

NOTES

This drawing is the copyright of Hampshire Architecture Ltd ©. All rights reserved. Do not scale from this drawing except for planning purposes. Contractors, Sub Contractors and Suppliers are to check all relevant dimensions and levels of the site and building before commencing any third party drawings or building work. Any discrepancies should be recorded to Hampshire Architecture Ltd. Where applicable this drawing is to be read in conjunction with all the relevant consultants, suppliers and manufacturers drawings and information.

REV	DESCRIPTION	DATE	AUTHOR	CHK'D
-	-	-	-	-



info@hampshirearchitecture.com | www.hampshirearchitecture.com

CLIENT
SHOREWOOD HOMES

PROJECT
Bob's Farm
Vyne Road, Sherborne St John

DRAWING
Plot 5
Floor Plans

SCALE: 1:50 @ A1 DATE: Feb 24 AUTHOR: CA

JOB NO. 8160 DRAWING NO. D12 REV B