

This drawing is copyright and shall not be reproduced nor used for any other purpose without written permission of the author. Do not copy from this drawing, use figured dimensions only.

The drawing must be read in conjunction with all other related drawings and documentation.

It is the contractor's responsibility to ensure compliance with the Building Regulations. It is the contractor's responsibility to check all dimensions on site, any discrepancy to be reported immediately.

Details and sizes shown are indicative only and are subject to confirmation by the relevant Specialist Sub-contractor.

This drawing is not to be for Land Registry purposes.

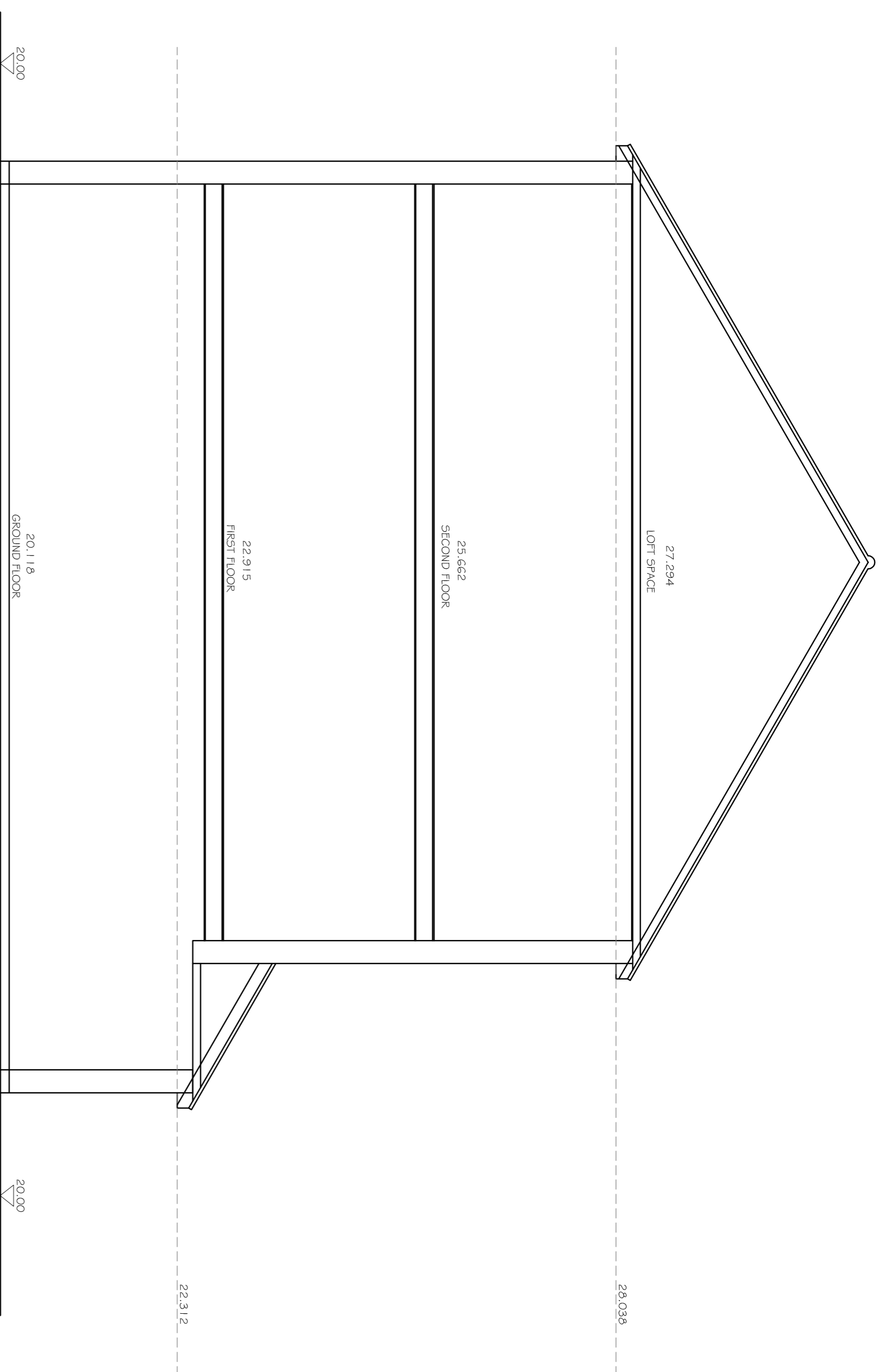

Existing Site Section

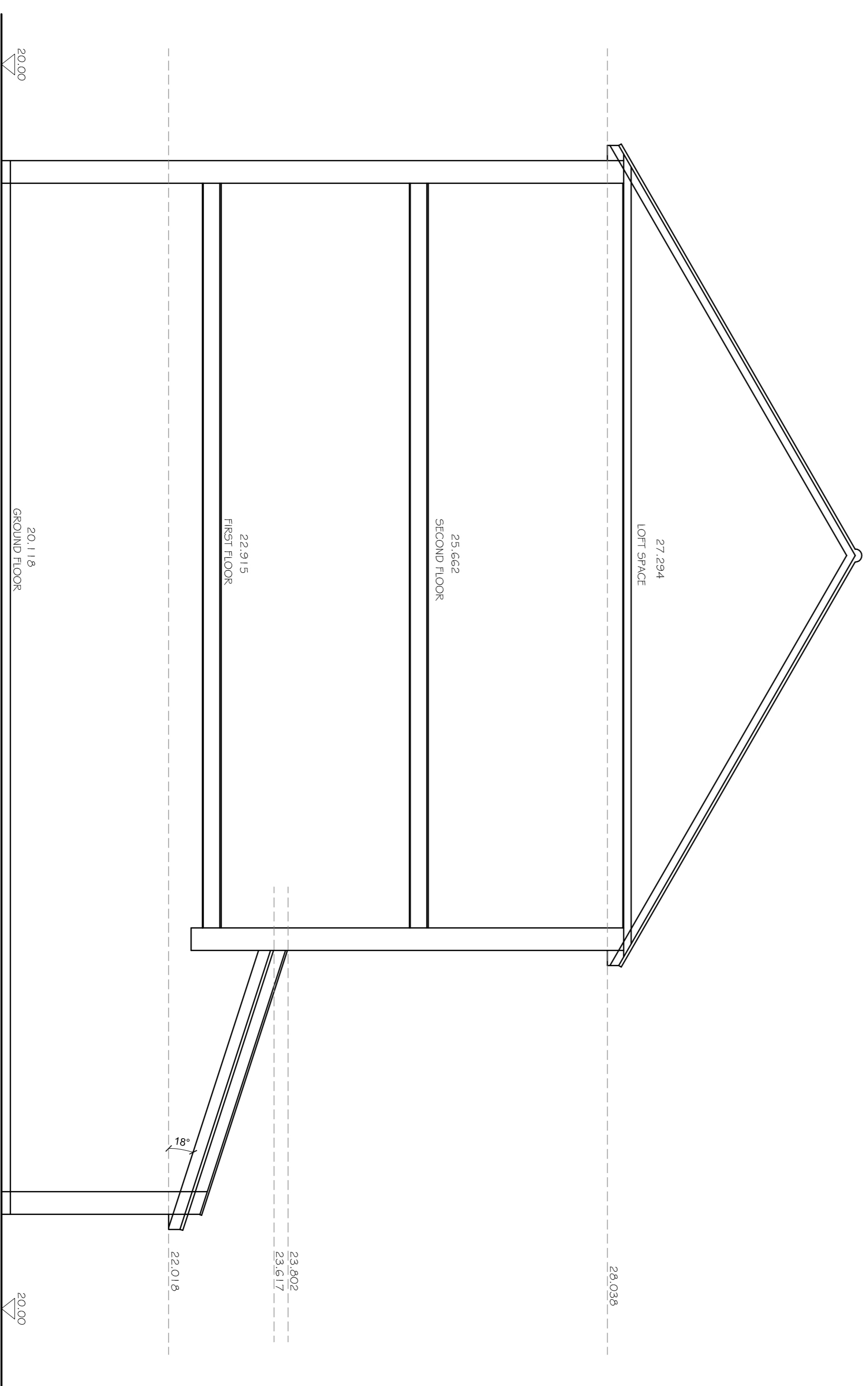

Proposed Site Section

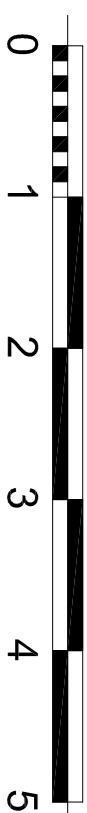

EXISTING & PROPOSED SITE SECTIONS



The Warren
21 Grange Road
Rimwell
Wickford
SS11 7LZ
T 01268 574191

e: mail@architecturalesignandplan.com
w: www.architecturalesignandplan.com

Client
MS TAK WAH CHAN
Project
11 ARCHER WAY
ENFIELD
EN2 8PW

Description
PROPOSED EXTENSIONS & ALTERATIONS

SITE SECTIONS		
Scale	Date	Revision
PLANNING	Drawn	
A1@1:50	PCE	MAR 2024
	Drawing No.	
ADP477REP	02	