

PGC/ First floor Proposed

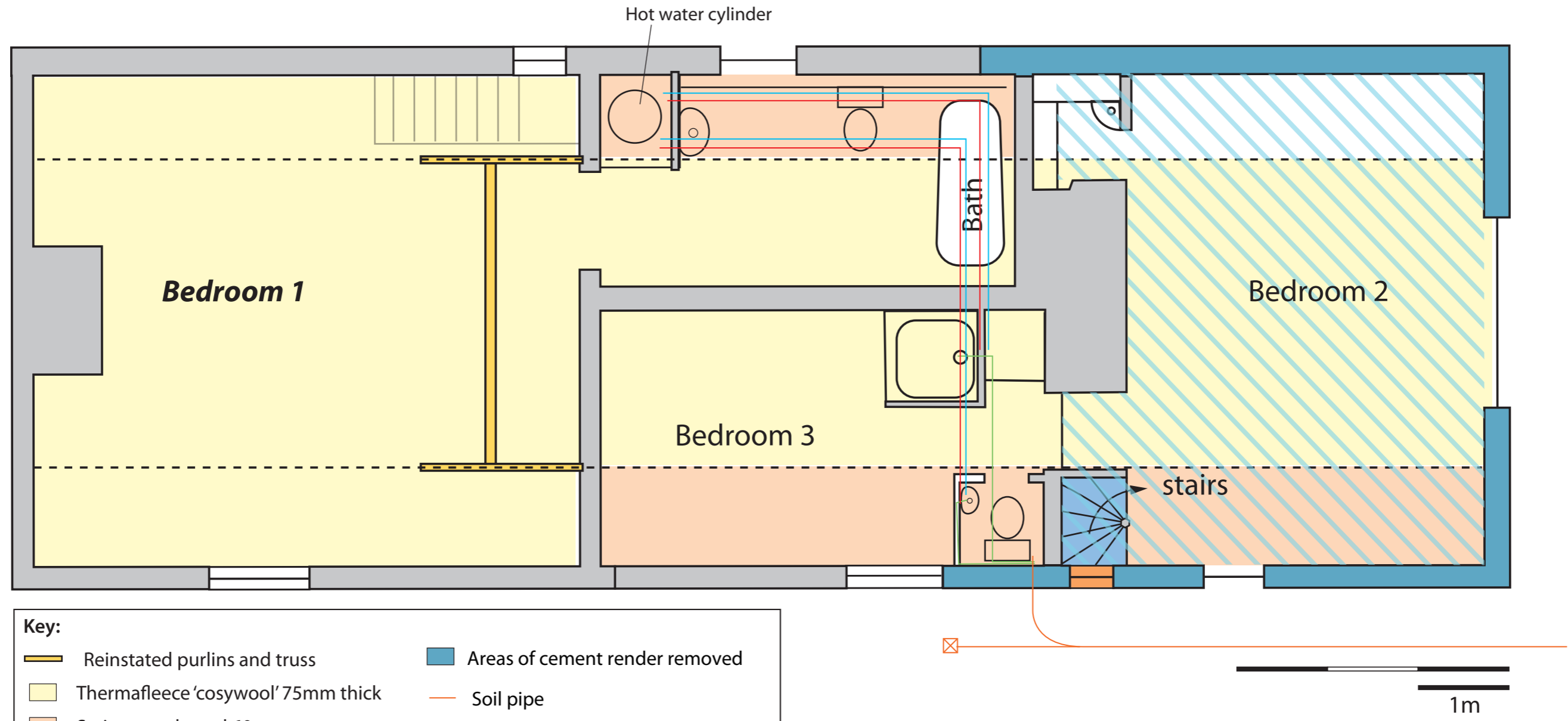

Key:

Reinstated purlins and truss	Areas of cement render removed
Thermafleece 'cosywool' 75mm thick	Soil pipe
Steico wood-wool 60mm	Hot and cold water pipes
Replaced stairs	Waste water pipe
New window opening	
Repairs to lath and earth plasters.	

Scale 1: 50