

Overlapping RPAs all beneath existing hard landscaped side access and rear paving/pool area - no alterations in this area & no additional ground protection required

Existing hard surfaced driveway within overlapping RPAs to remain intact - no additional ground protection required

Temporary BS5837 tree fencing to protect unsurfaced RPAs of on and off-site retained trees around perimeter of site in proximity to proposed alterations

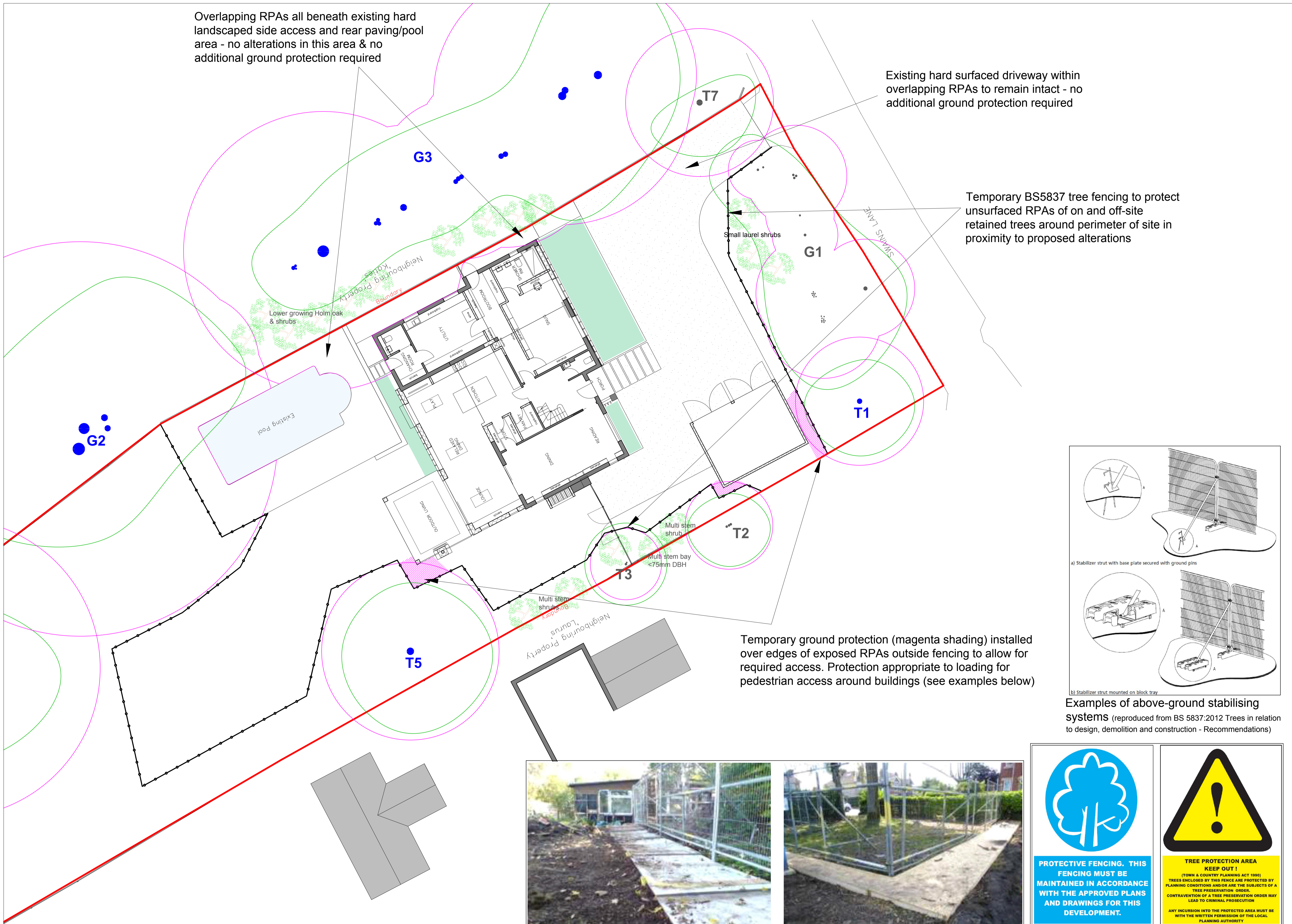

Temporary ground protection appropriate to loading within exposed RPAs (magenta shading) - refer to example specifications shown on this plan

BS 5837:2012 Tree Retention Categories (tree stems & numbers)

High quality	(A)	
Moderate quality	(B)	
Low quality	(C)	
Unsuitable for Retention	(U)	

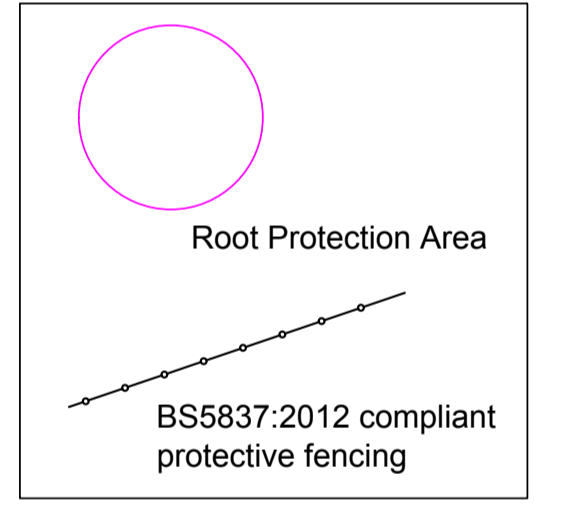
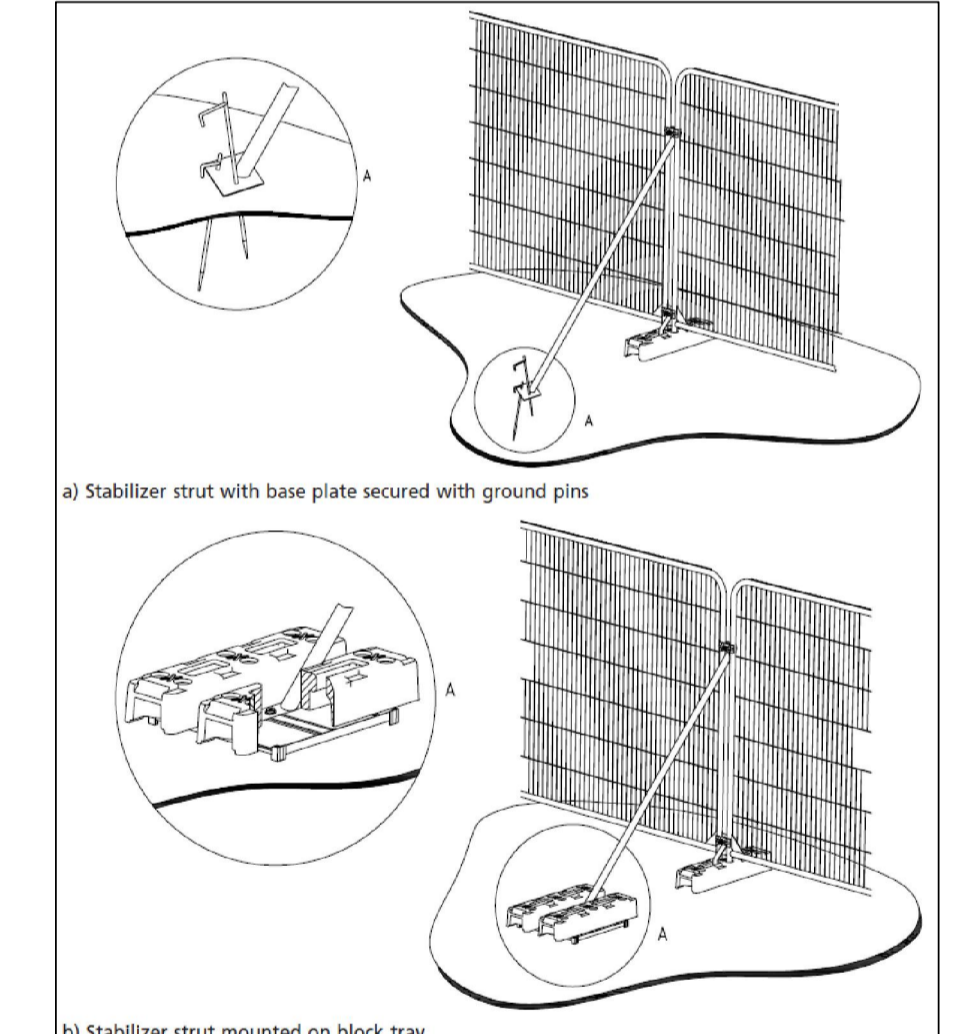

Temporary ground protection (magenta shading) installed over edges of exposed RPAs outside fencing to allow for required access. Protection appropriate to loading for pedestrian access around buildings (see examples below)

Examples of above-ground stabilising systems (reproduced from BS 5837:2012 Trees in relation to design, demolition and construction - Recommendations)



Examples of temporary ground protection suitable for pedestrian movements only - heavy-duty plywood sheets pinned into position (left) and plywood sheets fixed to a timber framework (right)



Examples of protective fencing signage
Site as proposed



M: 07867 725238
E: info@woodsidetrees.co.uk
W: www.woodsidetrees.co.uk

CLIENT:
Ms H. Southby

PROJECT:
Land at Wight Haven, Swains Lane, Bembridge

DRAWING TITLE:
Draft Tree Protection Plan

DRAWING NO: AS/ED/0324 DTPP	REV.
--------------------------------	------

DRAWN BY:
AS

DATE:
06.03.2024

SCALE:
1:125 @ A1