

*PROPOSED ROOF PLAN*

*RAFTERS: 175x50mm @400mm c/c*

*PURLIN: 203x133x30UB @MID-SPAN*

*100x50mm TIMBER BOLTED TO UB  
RAFTERS SPIKE TO TIMBER  
UB SET ON CONCRETE PADSTONES*

*100mm BLOCK WALL BUILT UP FROM NEW  
FOUNDATIONS TO SUPPORT UB*

*3No. LAYERS OF BONDED FELT ON PLY DECK  
UNDER CROSS BATTENS (AIR GAP) TO ROOF*

*NATURAL SLATES TO ROOF*

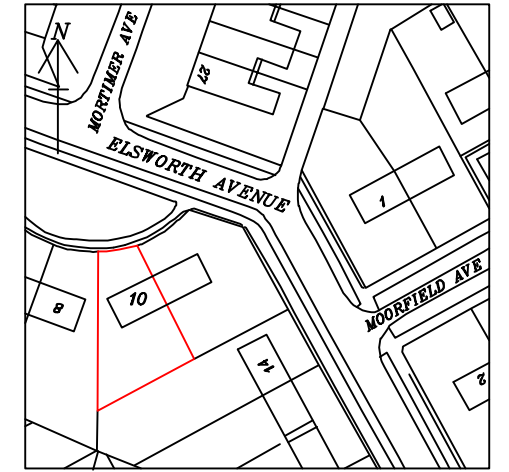

*LOCATION PLAN  
SCALE: 1:1250*

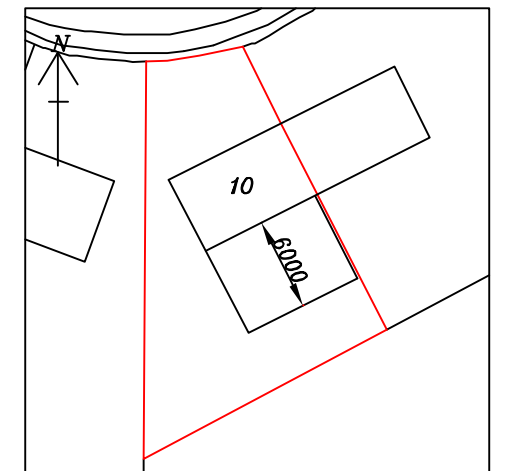

*SITE PLAN  
SCALE: 1:500*

*PROPOSED 1-STOREY REAR  
EXTENSION TO CREATE  
DISABILITY BEDROOMS AT  
10 ELSWORTH AVENUE,  
BRADFORD, BD3 7EX, FOR  
MEAHIRUN KHAN*

SCALE: 1:100(A3) | DATE: FEB 2024 | DRAWN BY: ZESHAN KHAWAJA

PLANNING/BUILD REGS | DRAWING NUMBER: 24/3078/MK3

**Khawaja**  
PLANNING SERVICES

TEL: 01274 618780 | MOB: 07956 184960