

A 768

THE LOAN

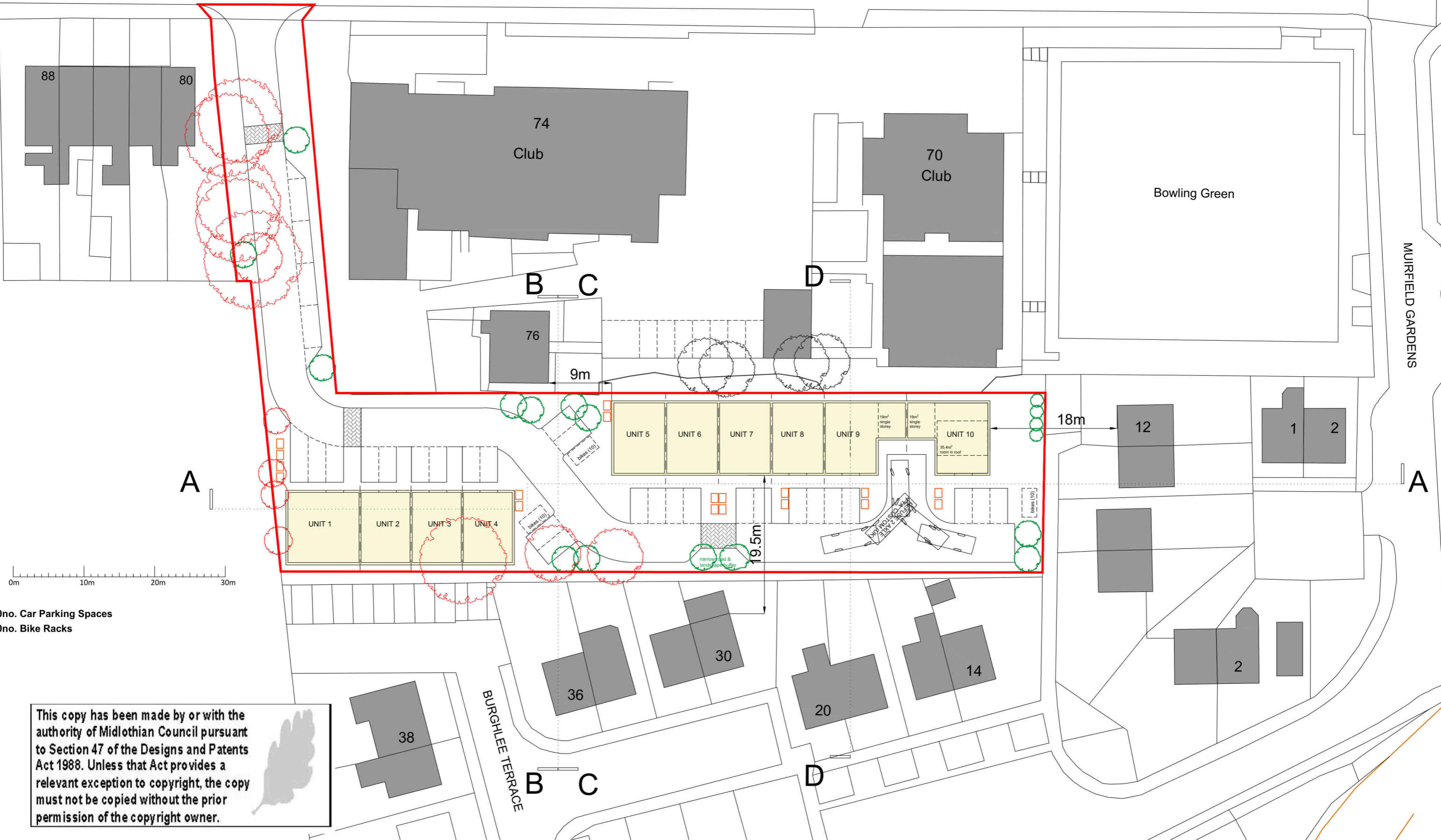

0m 10m 20m 30m

30no. Car Parking Spaces  
30no. Bike Racks

This copy has been made by or with the authority of Midlothian Council pursuant to Section 47 of the Designs and Patents Act 1988. Unless that Act provides a relevant exception to copyright, the copy must not be copied without the prior permission of the copyright owner.

**\*DRAWING REPRESENTS DESIGN INTENT**

26 Mitchell Street, Dalkeith  
tel. 0131 663 3938 mob. 07906324343  
www.chrismatson.co.uk mail@chrismatson.co.uk  
**CHRIS MATSON ARCHITECT**

Client	Braidwood Building Contractors Ltd		
Scale	Date	Drawn	Status
1:500@A3	28.02.24	CJM	PLANNING

Project	Business Units at 72 The Loan, Loanhead EH20-9AQ		
Drawing Title	Site Plan as Proposed		

Drg No  
2105\_05 PL03