

FIRST FLOOR PLAN - INDICATIVE
As Proposed

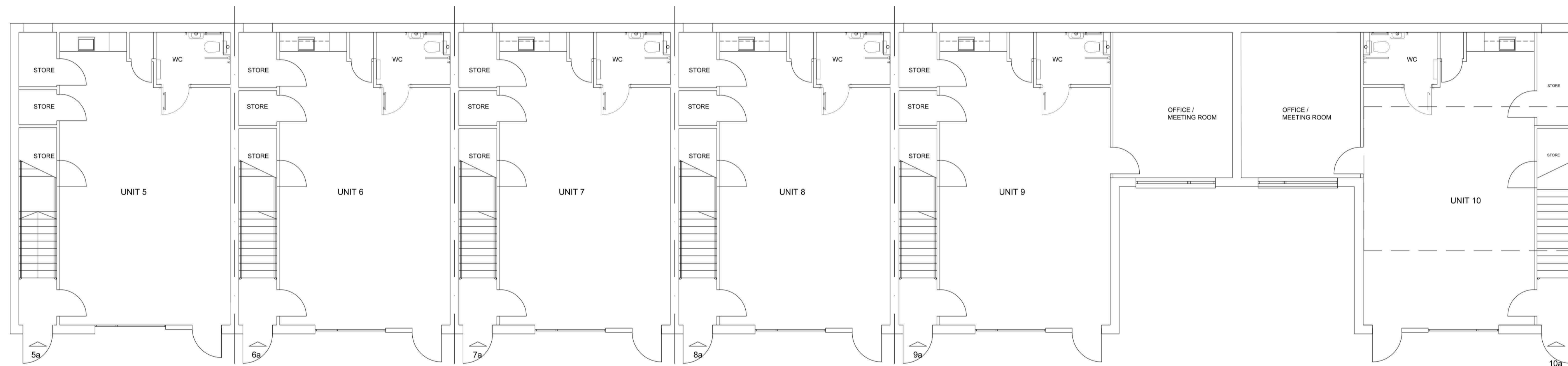

GROUND FLOOR PLAN - INDICATIVE
As Proposed

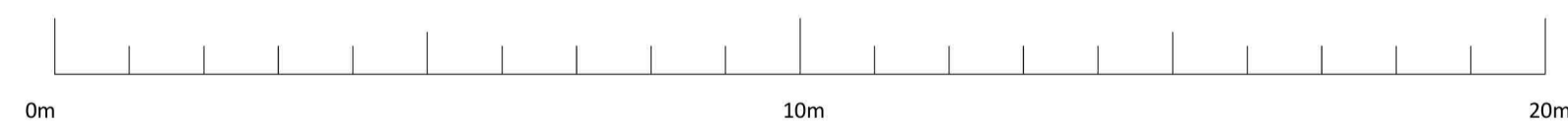

This copy has been made by or with the authority of Midlothian Council pursuant to Section 47 of the Designs and Patents Act 1988. Unless that Act provides a relevant exception to copyright, the copy must not be copied without the prior permission of the copyright owner.

***DRAWING REPRESENTS DESIGN INTENT**

26 Mitchell Street, Dalkeith
tel. 0131 663 3938 mob. 07906324343
www.chrismatson.co.uk email@chrismatson.co.uk
CHRIS MATSON ARCHITECT

Client
Braidwood Building Contractors Ltd
Scale 1:100@A1 Date 28.02.24 Drawn CJM Status **PLANNING**

Project
Business Units at 72 The Loan, Loanhead EH20-9AQ
Drawing Title
Floor Plans: Units 5 to 10 - INDICATIVE LAYOUT Drg No **2105_05 PL04**