

This copy has been made by or with the authority of Midlothian Council pursuant to Section 47 of the Designs and Patents Act 1988. Unless that Act provides a relevant exception to copyright, the copy must not be copied without the prior permission of the copyright owner.

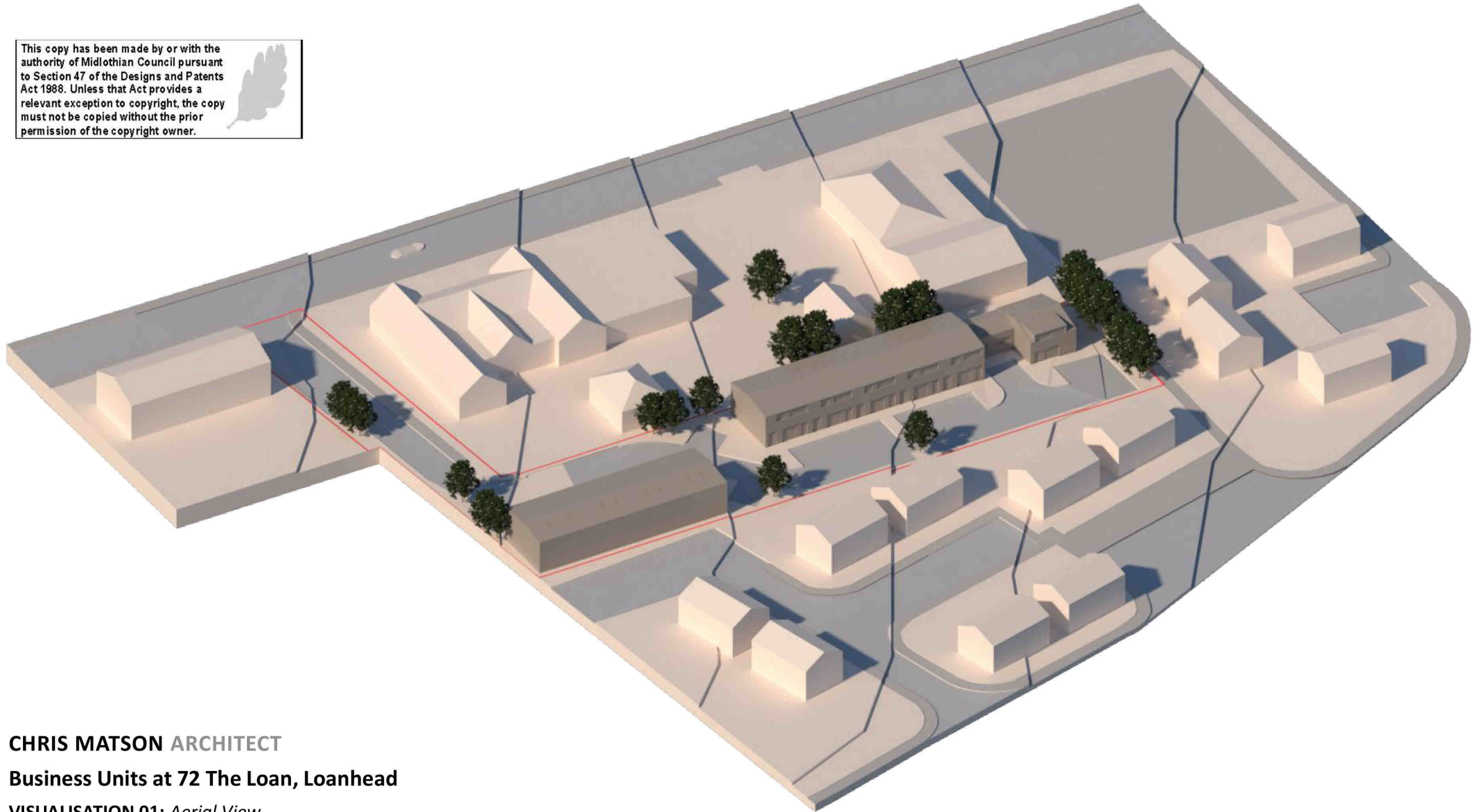

CHRIS MATSON ARCHITECT
Business Units at 72 The Loan, Loanhead
VISUALISATION 01: Aerial View