

Note
Contractor to check all site sizes prior to construction.
Do Not Scale

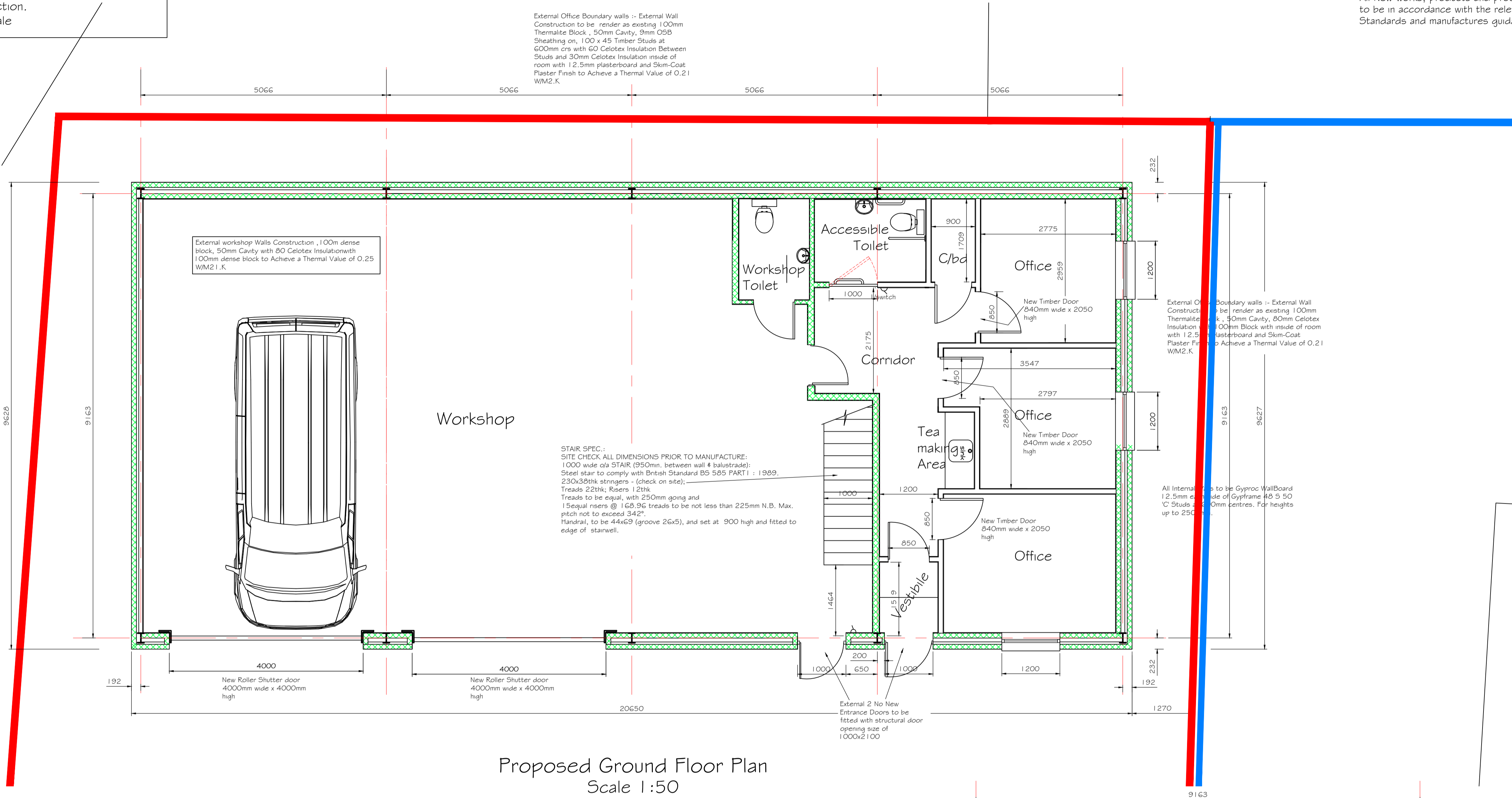

Proposed Ground Floor Plan
Scale 1:50

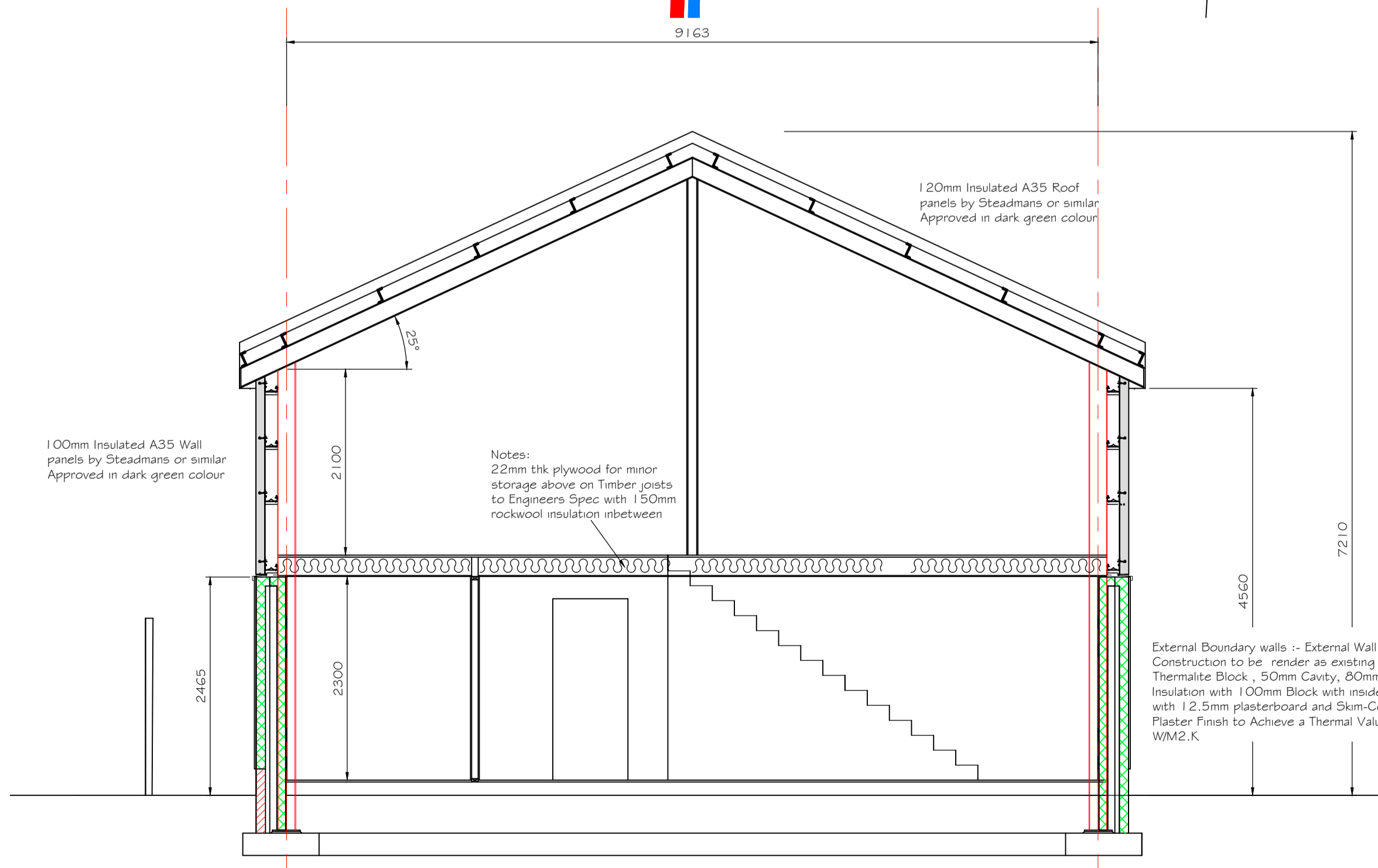

Proposed Typical Cross Section
Scale 1:50

All New works are to be in accordance with the Building (Scotland) Regulations 2019 and all current amendments
All New works, products and processes are to be in accordance with the relevant Building Standards and manufactures guidance.

General Notes
1. electrical :- denotes light switch
 denotes light point
 denotes 1.3amp P.P. circuit
All electrical works to be in accordance with part 4.5 of the current technical handbook B57671 :2018 and 18th Edition and to current I.E.T. Regulations
All construction details, so far as possible, to be in accordance with the Small Buildings Guide 2010, and the Small Buildings Structural Guidance to the Technical Handbook and Accredited Construction Details Scotland 2015.

GROUND PREPARATION
Site to be cleared of topsoil and vegetable matter to a minimum depth of 250mm.



Rev	Description	Date
Capital Draughting Consultant's Ltd 40 Dinmont Drive Edinburgh EH16 5RR Email: cdc.ltd@sky.com Tel: 0131 666 1804 Mob: 07834156071		
Status Planning		
Project Title Proposed New Additional Office-Industrial Estate at Burnhouse Industrial Estate, Whitburn, West Lothian, EH47 0LQ		
Client Mr M. Dunnigan		
Drawing Title Proposed Ground Floor Plan and Typical Cross Section		
Date Mar '24		Scale As Shown
Drawn		
Drawing Number CDC/24/110/03		Rev.