

1 SITE PLAN
1:100 @ A1

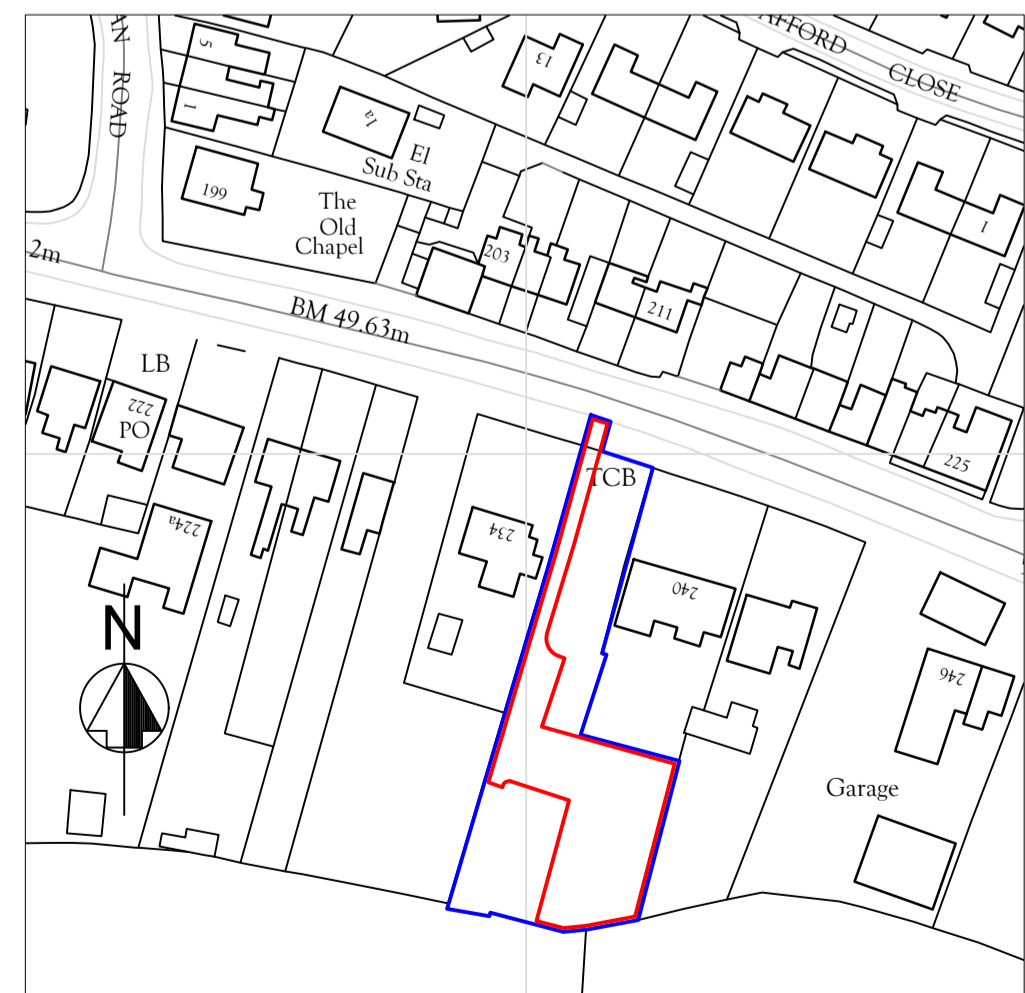

2 LOCATION PLAN
1:1250 @ A1

Dashed line denotes edge of new development; see location plan for full boundary of block 3.

Notes:
Revision D: - Solar panels added to roof and site plans.

**Keith Parker
Architectural &
Building Services**
If in doubt ask! -
Land line: - 01637 872458
Mobile: - 07891 169684
-----xkparker@aol.co.uk-----

M & J. Developments
236 Henver Road,
Newquay,
Cornwall.
TR7 3EM.

Proposed Block 3 Domestic Dwellings
Block 3 Location, site plans

Scale @ A1	Issue	Dwg	Date
1:50-1:200	Planning	3 of 3	Mar - 2024
Ref.		Drawn	Rev.
202136 - 11		JRP	D

This drawing is to be used in conjunction with all current services and engineers drawings, details and calculations.
All materials and workmanship shall comply with the current British Standards, Codes of Practice and Building regulations.
DO NOT SCALE FOR CONSTRUCTION PURPOSES: USE FIGURED DIMENSIONS. All dimensions in millimetres.
CHECK ALL DIMENSIONS ON SITE PRIOR TO FABRICATION. Report any discrepancies to this architectural office. The contractor is responsible for the correct setting out of the work on site.
Contractors are to comply with all health and safety legislation applicable. Particularly the CDM Regulations, provision should be made for safe working procedures for the construction work. Avoid hazards where possible. If unavoidable use suitable precautions.
The Construction Design and Management Regulations CDM 1994 applies to all commercial work including flats, conversions and housing developments. It does not apply where the work is solely in an unoccupied dwelling.
This drawing is Copyright KP Keith Parker Architectural & Building services.