

BLOCK PLAN @ 1:500
(PROPOSALS HATCHED)

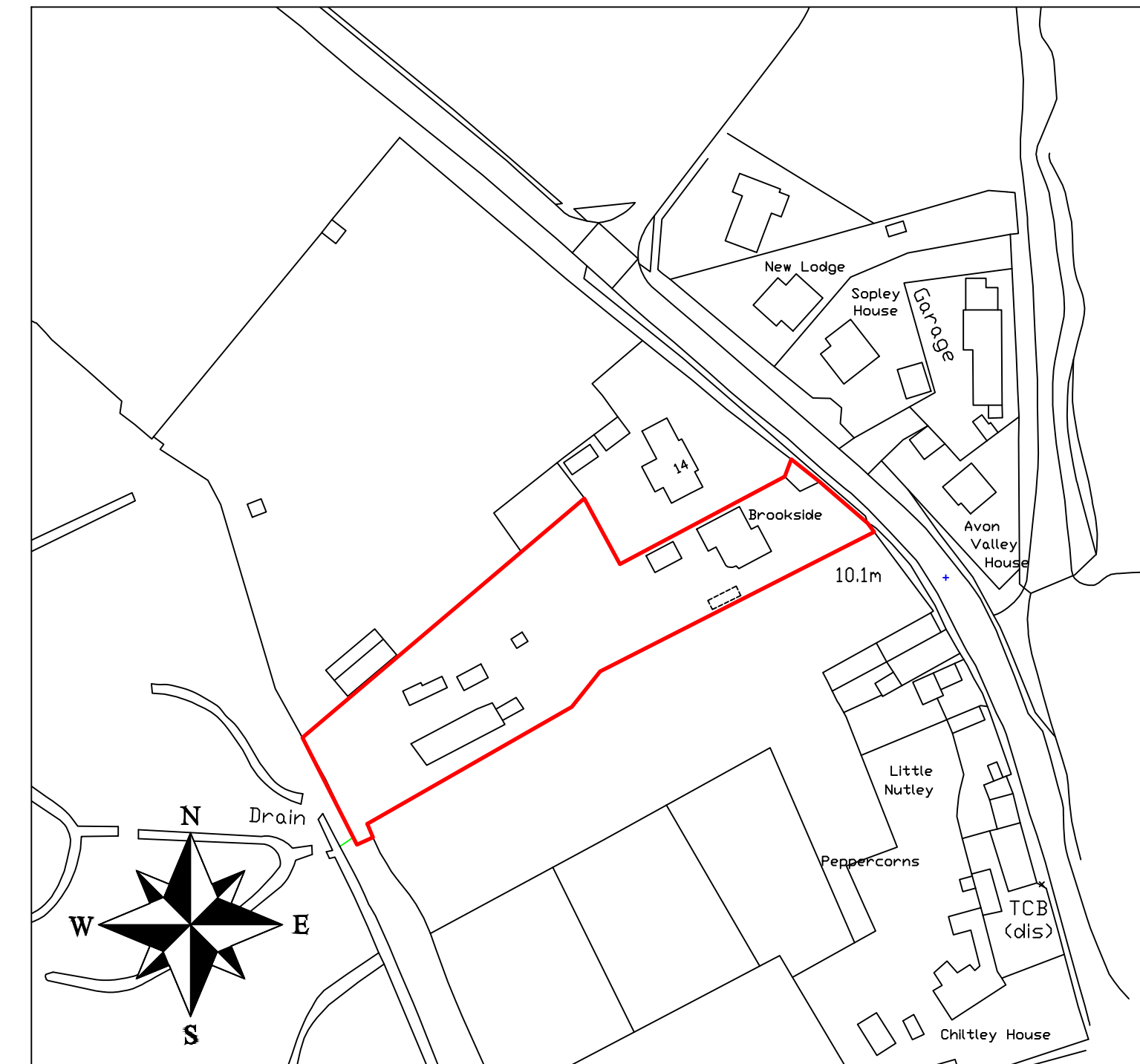

SITE LOCATION PLAN @ 1:1250

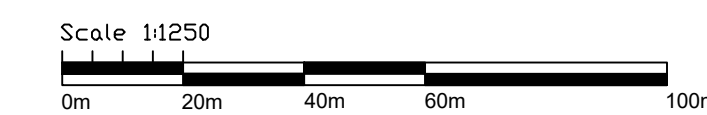

© COPYRIGHT APS LTD. ALL RIGHTS RESERVED. THIS DRAWING MAY NOT BE COPIED OR RE-USED IN WHOLE OR IN PART, WITHOUT THE WRITTEN CONSENT OF APS LTD.

SCALING FOR REFERENCE ONLY, WRITTEN DIMENSIONS SHALL GOVERN

GENERAL NOTES

THIS DRAWING MUST BE READ IN CONJUNCTION WITH ALL OTHER RELEVANT ASSOCIATED DRAWINGS & DOCUMENTS SPECIFICALLY PREPARED FOR THIS PROJECT, INCLUDING: DETAILS & CALCULATIONS BY STRUCTURAL ENGINEERS, ENERGY (SAP) ASSESSORS, & ALL OTHER EXTERNAL CONSULTANTS, & OTHER PARTICULAR SITE SPECIFICATIONS. TO VIEW ALL INFORMATION ACCURATELY, THIS DRAWING IS TO BE PRINTED AS SEEN ON SCREEN PDF WITH ALL DWG. PLOT STYLES (COLOURED/SHADED WHERE APPLICABLE) DISPLAYED

THIS DRAWING IS FOR GENERAL REFERENCE AND THE PURPOSES OF OBTAINING LOCAL AUTHORITY OR APPROVED INSPECTORATE APPROVALS ONLY. THIS IS NOT A WORKING DRAWING. ALL FINAL DIMENSIONS MUST BE DETERMINED ON SITE AT THE SETTING OUT STAGE OF THE WORKS. DISCREPANCIES ARE LIKELY, AND IF NECESSARY ARE TO BE VERIFIED WITH CLIENT/AGENT BEFORE WORK PROCEEDS. IT IS THE RESPONSIBILITY OF THE CLIENT AND THE APPOINTED BUILDING CONTRACTOR TO OBSERVE ALL RELEVANT HEALTH AND SAFETY RULES INCLUDING THE CONSTRUCTION (DESIGN & MANAGEMENT) REGULATIONS, THE PARTY WALL ACT, THE CONSTRUCTION ACT, ALL AS APPLICABLE

REV	BY	DATE	DESCRIPTION

REVISIONS / AMENDMENTS

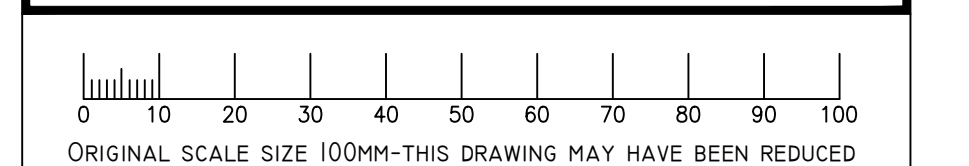

CLIENT: MR & MRS WATTS

SITE: BROOKSIDE, RINGWOOD ROAD, SOPLEY BH23 7BB

PROJECT: GROUND FLOOR EXTENSION TO REAR + INTERNAL ALTERATIONS

DWG. TITLE: SITE & LOCATION PLANS

DWG. STATUS: AS PROPOSED

DWG. No. P704/2/02 REVISION:

DRAWN BY: PA DATE: FEB 2024

CHECKED BY: MW DATE: FEB 2024

SCALE: 1:500 & 1:1250 @ A1

AVON PROJECT SERVICES
Building Design & Technology
3 Wren Close, Hightown, Ringwood, Hants, BH24 3RF
Tel/Fax: 01425 472217
Web: avonserve.com e: info@avonserve.com