

Note:

All levels and dimensions to be site surveyed and confirmed by the contractor. See also architectural details, mechanical and electrical intent layout and structural engineers drawings and specifications. Door and windows manufacturer to produce shop drawings for comment before manufacture. All details are intent only, to be finalised by the contractor. Drawings subject to statutory approvals.

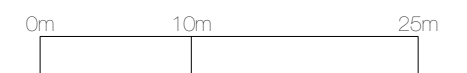
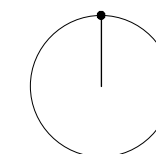
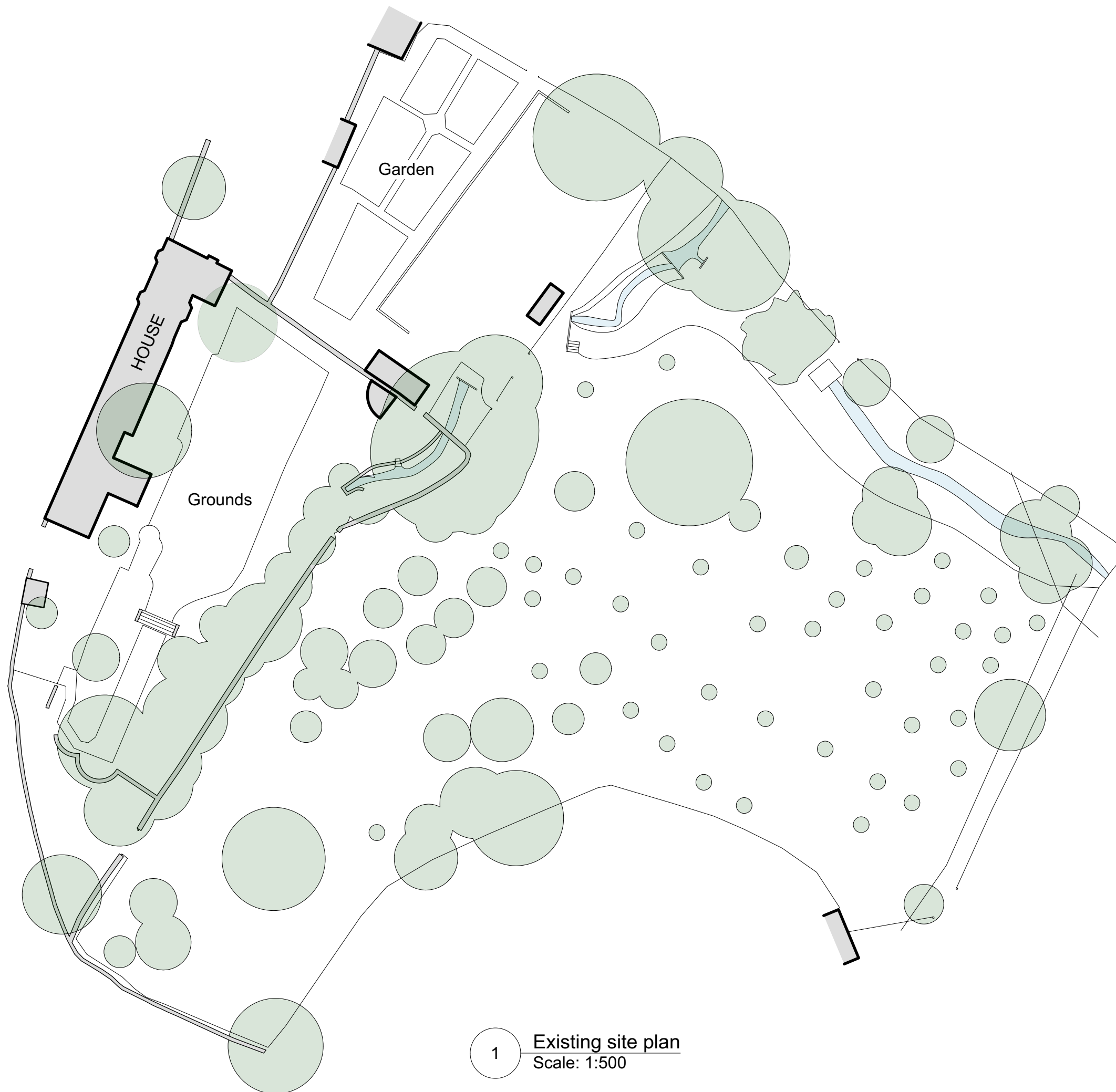

Revision

P1 23.01.24 Planning Issue

MALTHOUSE PV ARRAY

The Malt House
Broad Campden
Gloucestershire
GL55 6UU

044_01_100

Existing site plan

1:500 @ A3

1 Existing site plan
Scale: 1:500

TAW FITZWILLIAM

hello@tawfitzwilliam.com | 01865 806 076 | www.tawfitzwilliam.com