

NORTH

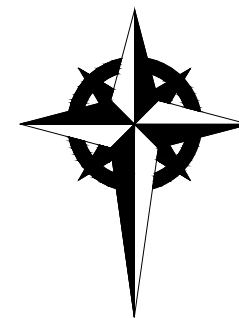

2440.00 N

2400.00 N

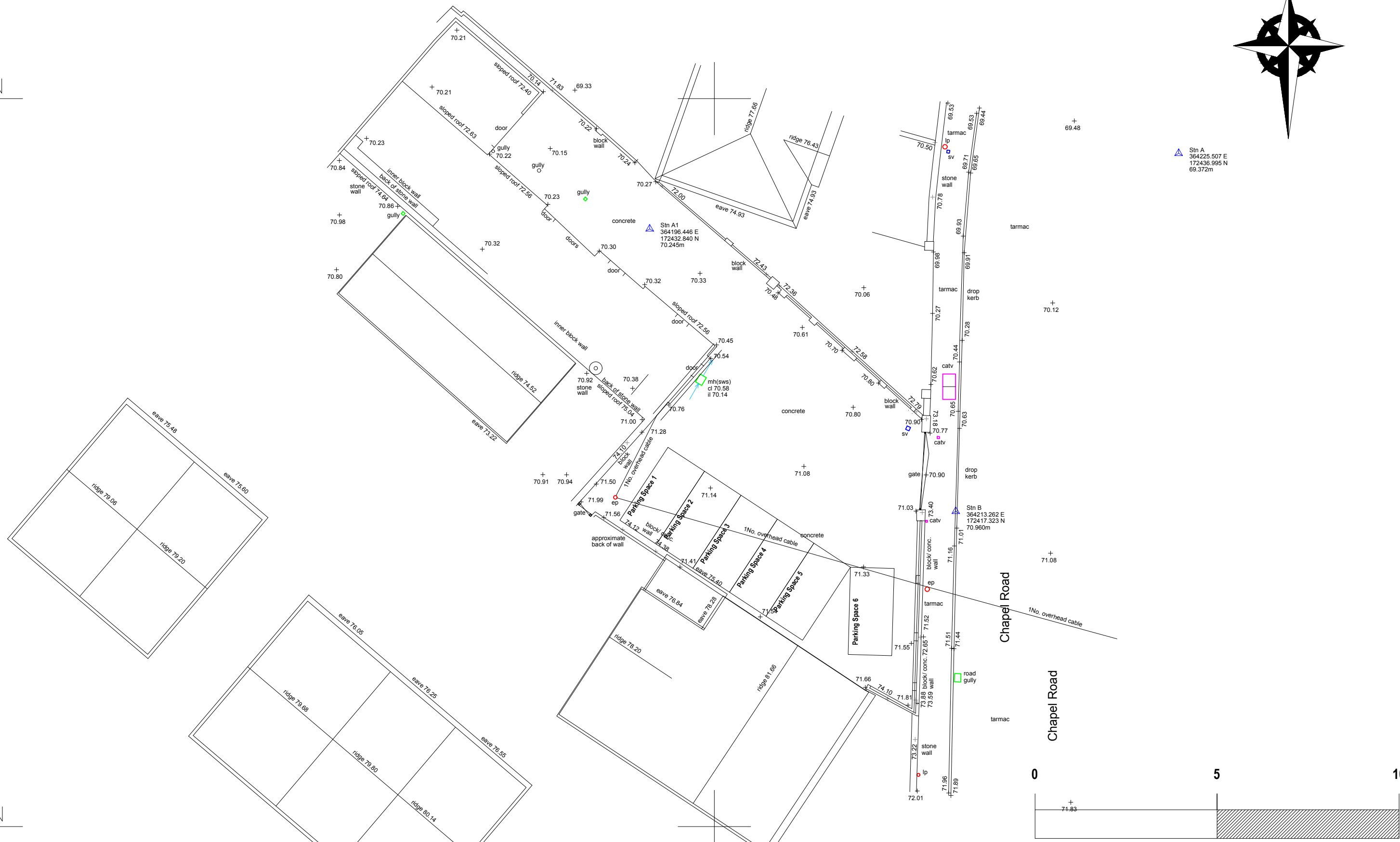

Stn A
364225.507 E
172432.840 N
70.245m

Stn B
364213.262 E
172417.323 N
70.960m

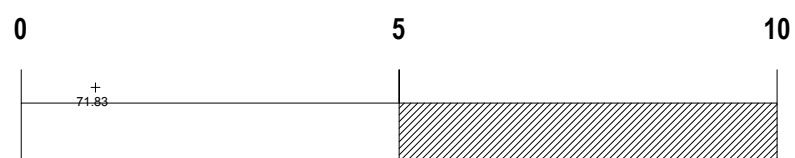

Rev:	Date:	Note

Proposed Replacement Commercial Building
14a Chapel Road Hanham
Bristol

Existing Site Plan

Date:
Feb 2024

Scale:
1:200 @ A3

DWG No:
3701/1

David Cahill
Design Consultants Ltd
Unit 2 Office 4 Tower Lane Business Park
Warmley Bristol BS30 8XT
Tel: 01179618888
Email: davidcahilldesign@btopenworld.com