

RHEINZINK INSECT MESH (AERO 63) LOCATED AT VENT OPENING TO ALSO WORK AS Baffle AGAINST WIND BLOWN SNOW

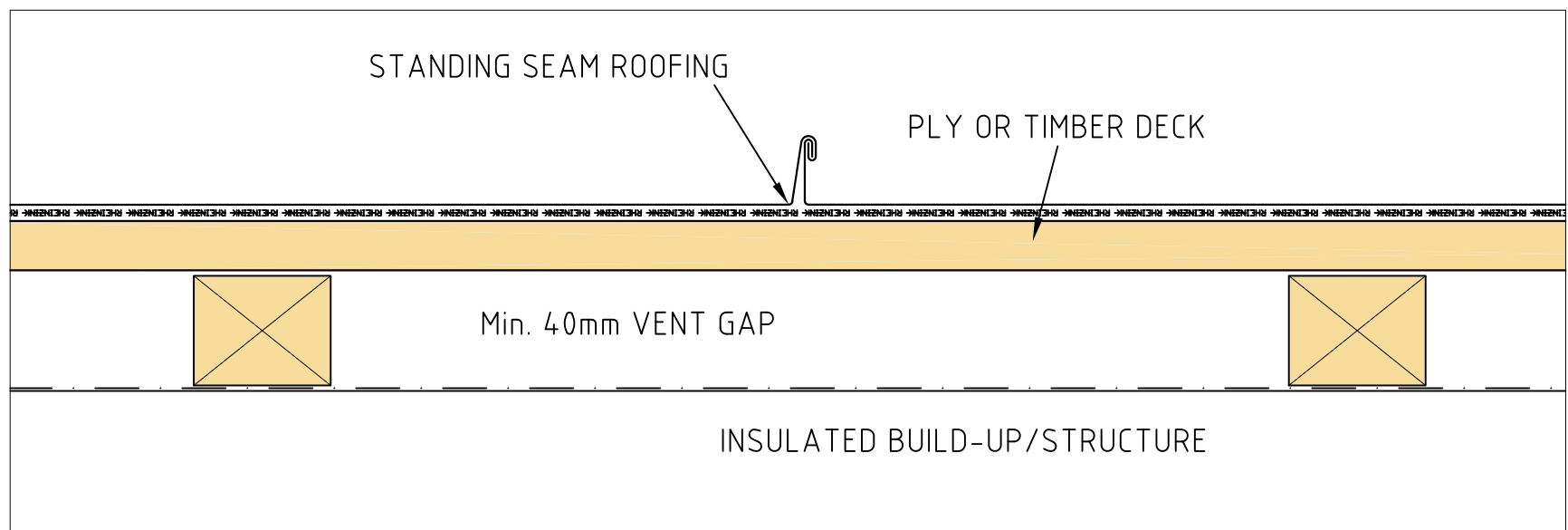

**RHEINZINK®**

**VENTED RIDGE DETAIL**

Title		Scale
OPTION 2 WITH CENTRAL Baffle TO AID WITH PREFENTION OF WIND BLOWN RAIN		1:2.5
Detail-Nr.		Size
		A3
Drawn		Date
W. G. M.		17.08.18

The detail describes an optional design in standard cases based on a European climate. Any user of this document is responsible to verify the feasibility of the solution with respect to the specific local situation and conditions. Using the documents provided by RHEINZINK is a service, which excludes liability for damages or claims of any kind. Contingent liability for malice or gross negligence is unaffected.