

- a) Proposed new 4 bed detached house, refer drawings S44.1 and S44.2.
- b) Detached garage refer drawing S44.3.
- c) Existing holly hedge to be reduced in height.
- d) Proposed route of new foul drain. Connect to existing lateral from Guest House to Public Sewer or make new sewer connection. Verify exact route and capacity of existing drains.
- e) Submersible Pump, for foul drain.
- f) New shingle drive with turning area in front of proposed house. Minimum width of drive 3.6m.
- g) Existing private drive from Kill Lane to be re-aligned. Minimum width 4.5m.
- h) Re-design, existing Car Park for Guest House.
- i) Outline of proposed extension to Guest House, granted consent by planning permission DC/16/01982.
- j) Laurel clipped hedge approx 1.3m high.

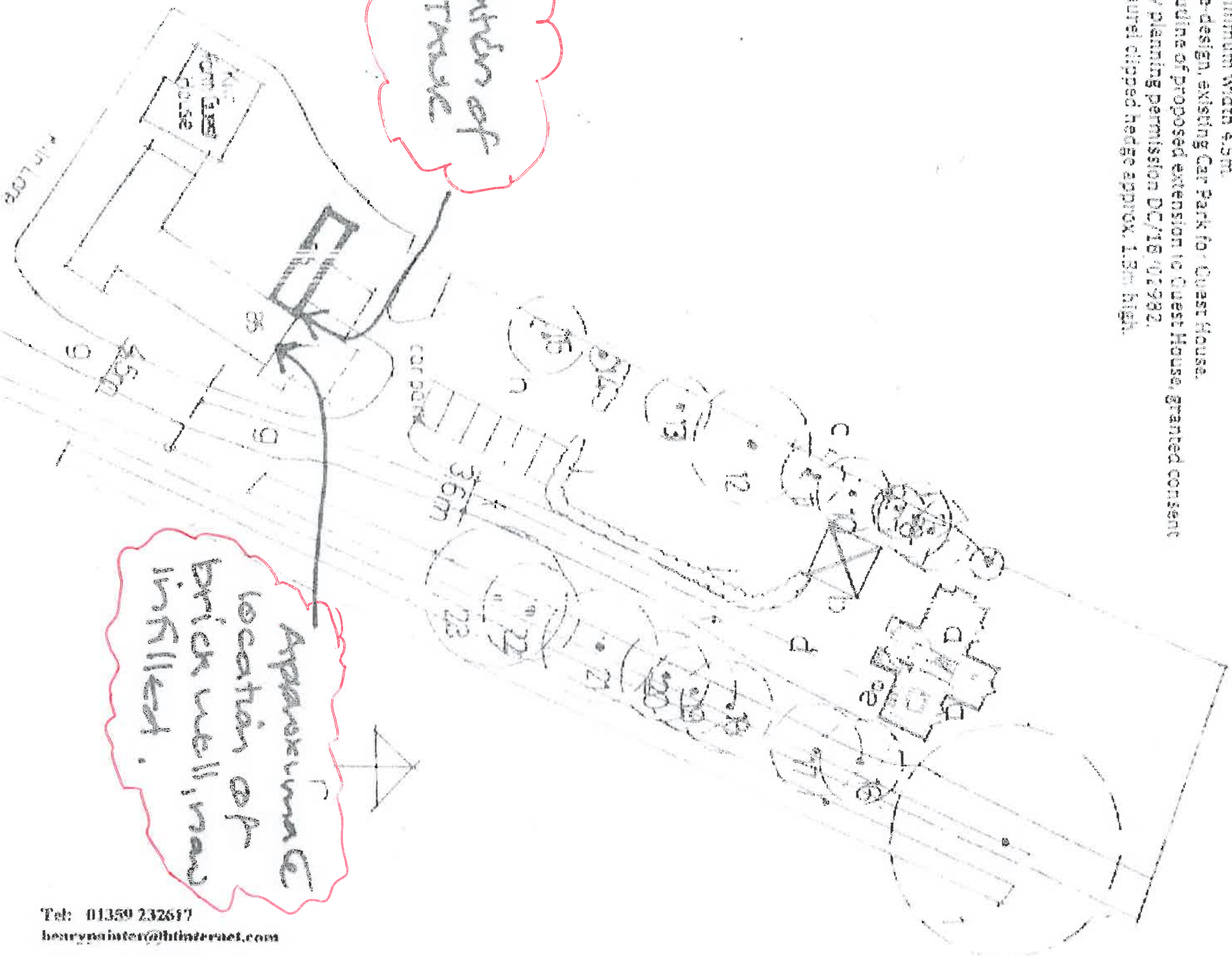

Approximate location of brick well, may infill.

Location of OIL TRUCK

Tel: 01350 232617  
 henryd@btinternet.com

**HENRY DAVIER**  
 Mr. Arch., R.I.B.A.  
 I.H.B.C., A.A.B.C.  
 ARCHITECT

Mr. & Mrs. E. Copeman,  
 Kill Farm Guest House,  
 Kill Lane,  
 Elmswell

Proposed New 4 Bedroom Detached  
 House with Detached Garage  
 Site Plan As Proposed

Scale: 1:500 November 2020  
 Drawing: S44.5  
 AT A3