

Figured dimensions only are to be used. All dimensions to be checked on site. Differences between drawings and between drawings and specification or bills of quantities to be reported to JJR Designs Ltd
 © This drawing is prepared for the application for:
 1. Planning permission
 2. Building Regulation Permission
 on behalf of the applicant named below and for no other purpose.
 The copyright of the drawing and designs remains JJR Designs Ltd.
 All copies are only for information about the application, they may not be used for any other purpose without the express written permission of JJR Designs Ltd.

Revisions:

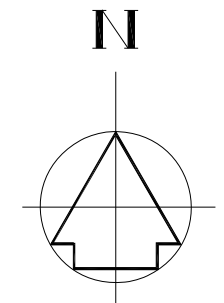

LEGEND:

LINE OF DOMESTIC CURTILAGE INCLUDED IN THIS POSITION AT THE INSTRUCTION OF CDC

NOTE: THE APPLICANT DOES NOT CONSIDER THE POSITION OF THE DOMESTIC CURTILAGE TO BE IN THIS POSITION

AREA OF LAND CONTROLLED BY OWNER

NOTE: THE LINE APPEARS TO BE ARBITRARY LINE SET OUT BY PREVIOUS PLANNING APPLICATION DATING BACK TO 1996

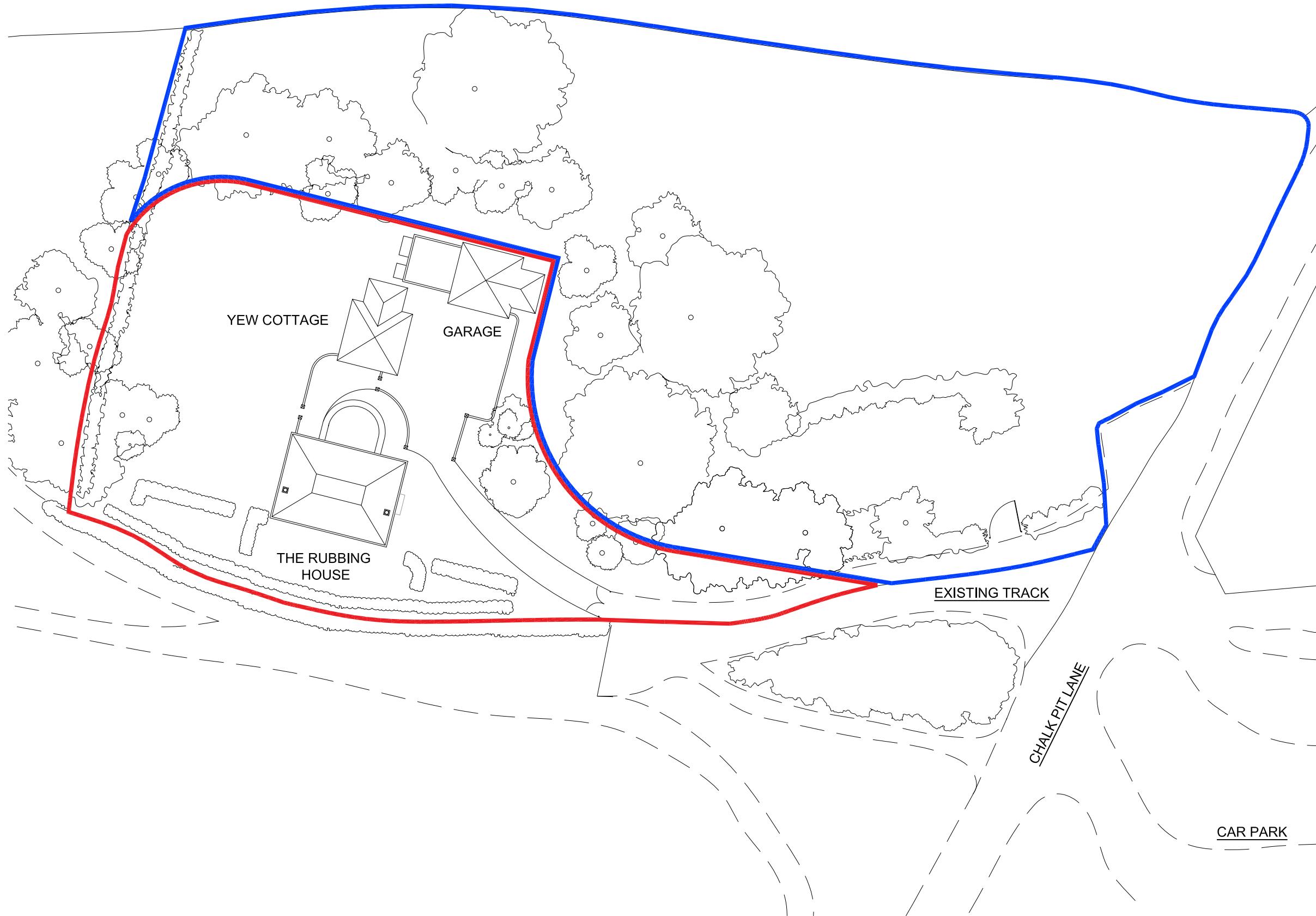

BLOCK PLAN
 Sc 1:500

 Suite 6a,
 Church House,
 94 Felpham Road
 Felpham
 West Sussex,
 PO22 7PG
 TEL: 01243 822081

Architectural
 Services
 Planning
 Building Regs
 On Site Supervision
 Landscape Design

e-mail: info@jjrdesigns.com

Client:
MR A. BURROWS

Project:
**THE RUBBING HOUSE
 TOWN LN, SINGLETON
 CHICHESTER, PO18 0SP**

Drawing Title:
BLOCK PLAN

Issue status:
 Outline proposals Production information Scheme design
 Tender drawing Detail design Contract drawing

Scale: 1:500 @A3	Drawn: I. Bruma	Checked: R.Stefanski	Date: 11.03.2024
Job No: 1623	Drawing No: PL 101	Revision:	

