

Ryde Academy Secondary School

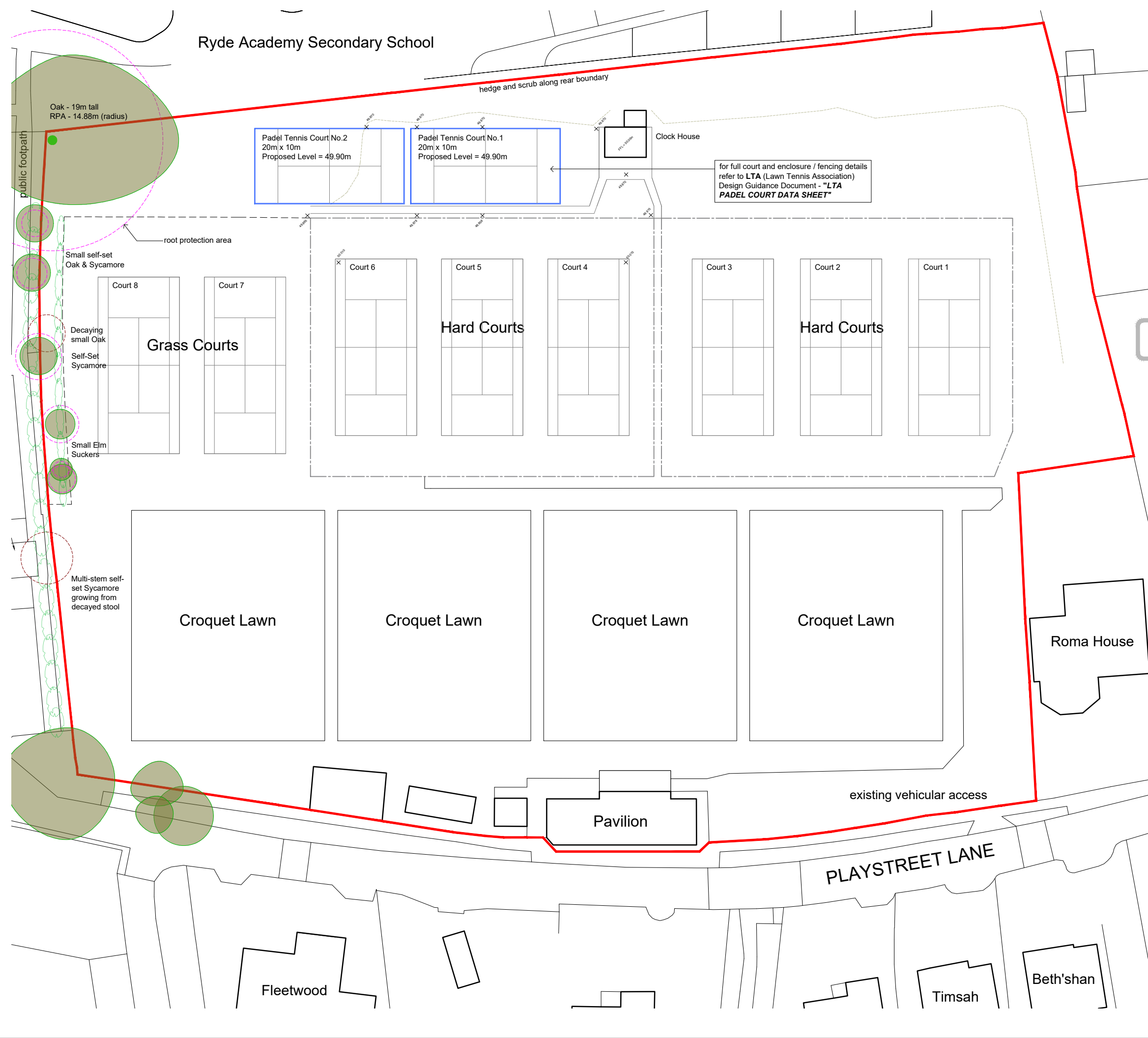

GENERAL NOTES

- 1) This drawing is the copyright of the **Simon Denness Architecture Ltd** and may not be altered or reproduced in any way without the written permission of **Simon Denness Architecture Ltd**
- 2) Written dimensions supersede manual or electronically scaled dimensions. All dimensions must be checked on site by Contractor before commencement of the works or fabrication
- 3) This drawing is to be used only for the purposes intended as described in the Drawing Title box.
- 4) This drawing must be read in conjunction with all other Consultants drawings & specifications applicable to this project.

CONSTRUCTION DESIGN & MANAGEMENT REGULATIONS 2015

DESIGNERS HAZARD INFORMATION FOR CONSTRUCTION

The notes below refer specifically to the information shown on this drawing. Refer to the Health and Safety Plan for further information.

- 1) If you do not fully understand the risks involved during the construction of the items indicated on this drawing ask your Manager, Health & Safety Advisor or a member of the Design Team before proceeding.

PLANNING ISSUE ONLY

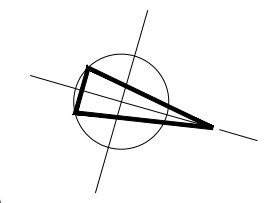
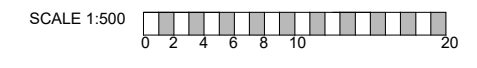

B	21.03.24	Client Alterations
A	20.03.24	Client Alterations

Revisions:

Residential | Commercial | Education | Healthcare

SDA SIMON DENNESS ARCHITECTURE

Site Office - Place Road / Deauville Ave t : 07851 290134
 Cowes, Isle of Wight e : simon.denness@btinternet.com
 PO31 7UA w : www.sd-architecture.co.uk

Feasibility Design | Planning Applications | Building Regulations | 3D Visualisation
 Tender/Contract Management | Construction & CAD Support

Client:
Ryde Lawn Tennis and Croquet Club

Project Title:
Proposed Padel Tennis Courts
Ryde Lawn Tennis and Croquet Club
Playstreet Lane, Ryde
Isle of Wight
PO33 3HH

Drawing Title:
Proposed Site Block Plan

Date:	19.03.24	Scale(s):	1:500 @ A3
-------	----------	-----------	------------

Drawing Number:	Revision:
RLT	001 B