

Proposed Site Location Plan 1:1250

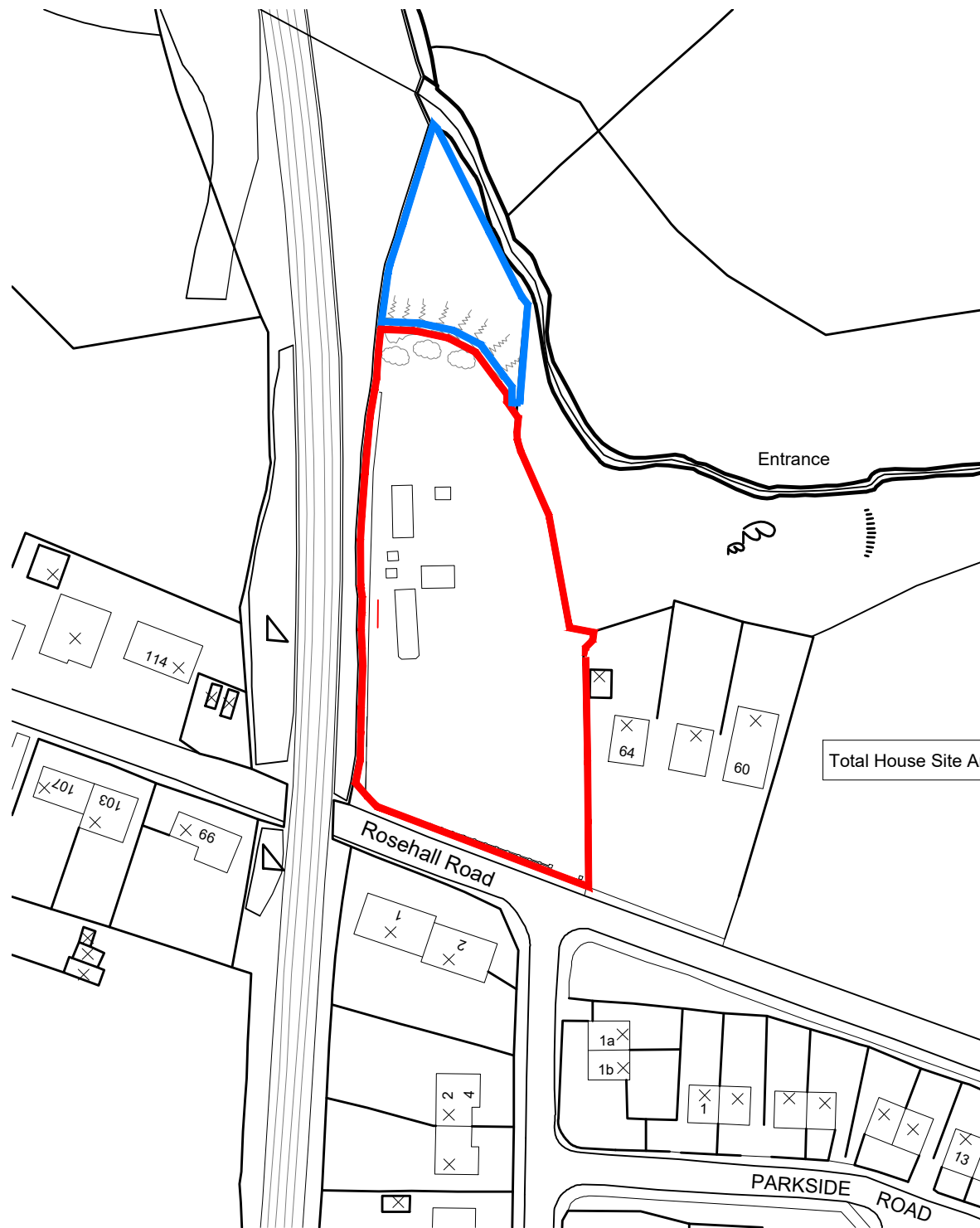

Existing Site Location Plan 1:1250

Total House Site Area = 3600sqm approx

Important

The contractor will be held to have examined the site and checked all dimensions and levels before commencing construction work. No assumption should be made without reference to the architect. No dimensions should be scaled from this drawing.

| Revision | Date | By |
|--|---------|----|
| A Drawing updated proposed site area revised | 09/2023 | |

GENERAL

Drawings and areas are indicative only and are subject to a full measured site survey.

All materials to be installed fully in accordance with the manufacturers recommendations.

All construction to be carried out in accordance with all the relevant current Health and safety guidelines and regulations.

All works to comply with the latest building Scotland Regulations and to the satisfaction of Building Control

All electrical works to comply with the latest edition of the I.E.E Regulations

Do not scale drawing.

Planning Approval

Client
Stephen McPhee

Project Title
Proposed 2 No Detached Houses
Rosehall Road
Shotts
ML7 4AH

Drawing Title
Site Location Plans

AI Architectural Design Ltd
Complete Bespoke Architectural Services

5 Cherrybank Walk, Airdrie
North Lanarkshire ML6 0HZ

Tel: 01236 769579
Mob: 07770611090
email: george@a1archdesign.co.uk

Scale
1:1250

Date
June 2022

Job No.
A1-738/22

Drawing No.
L (2-) 001

Rev.
A

