

FLAT ROOF LAYOUT - PRELIMINARY

JOISTS TO BE BUILT IN AS DISCUSSED

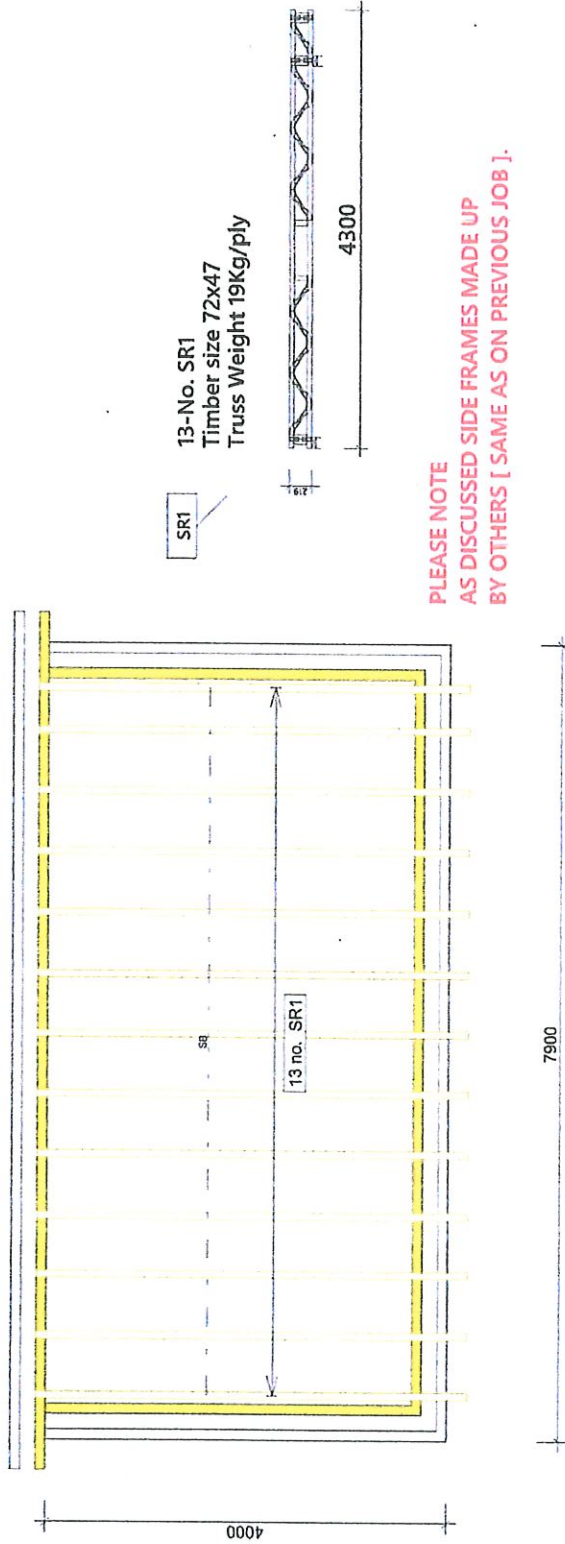

13-No. SR1
Timber size 72x47
Truss Weight 19Kg/ply

PLEASE NOTE
AS DISCUSSED SIDE FRAMES MADE UP
BY OTHERS [SAME AS ON PREVIOUS JOB].

PLEASE NOTE
ALTHOUGH STRONGBACK BRACING IN NOT A STRUCTURAL REQUIREMENT
ON FLAT ROOFS, AS IT IS ON FLOORS, WE HAVE ALLOWED FOR IT AS WE
FEEL IT HELPS SPREAD THE LOAD. WE HAVE ALSO ALLOWED FOR PERIMETER
NOGGINS WITHIN THIS QUOTATION.

 ENVIRO E.T.E. Checked LF	 CE	Ivan Stubbings 7500 Flat Roof TBA, Wymondham	
		20230630 Flat Roof Joists CODE TYPE NO.	DRAWING NUMBER SCALE 1:50
DRAWN LF		CHECKED LF	REV.

76