

PROPOSED

Please refer to page 14 of the document titled 'Evidence to support the reconstruction of the Grade II Listed Barn'.

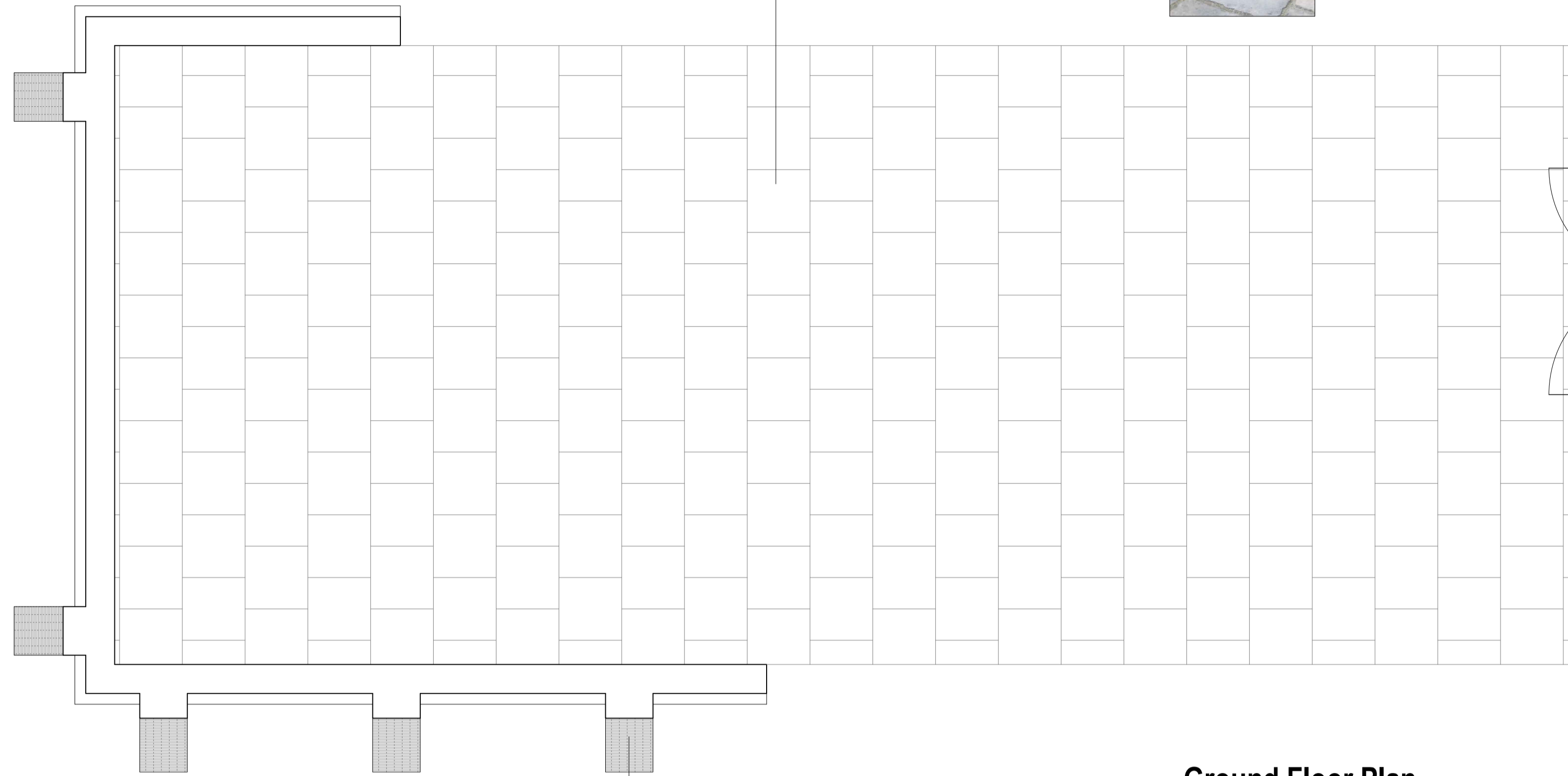

Existing brickwork at this end of the original barn to be fully retained.

Ground Floor Plan
Area ca. 120.07 m²

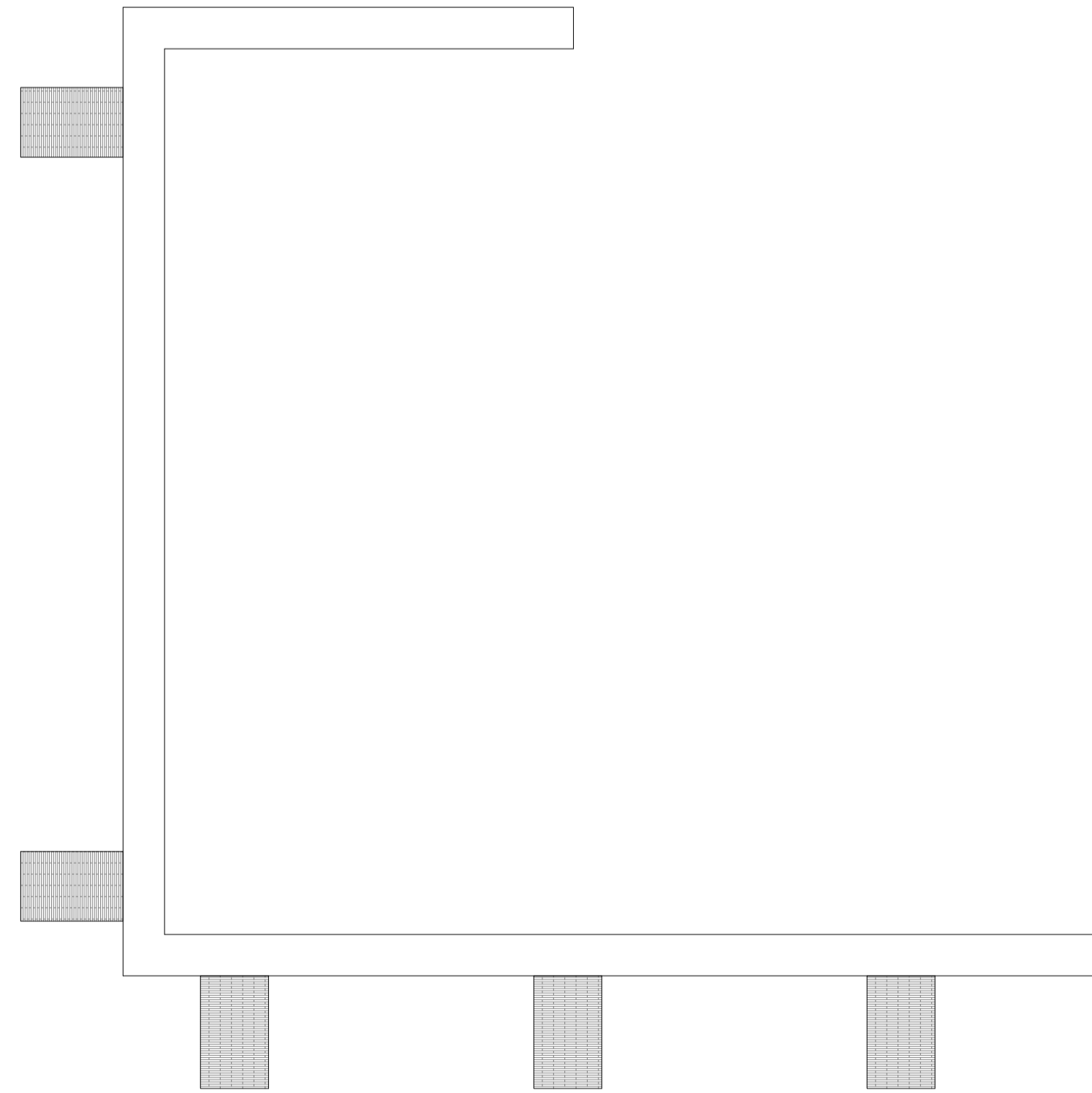

Roof Plan

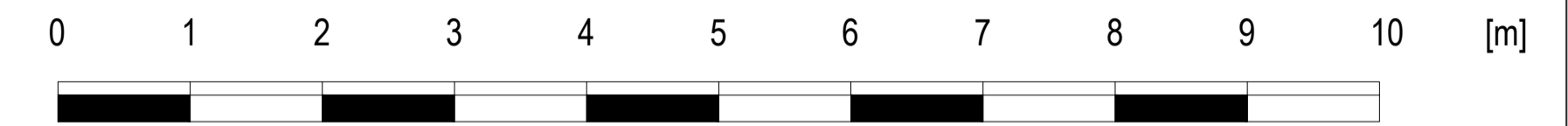
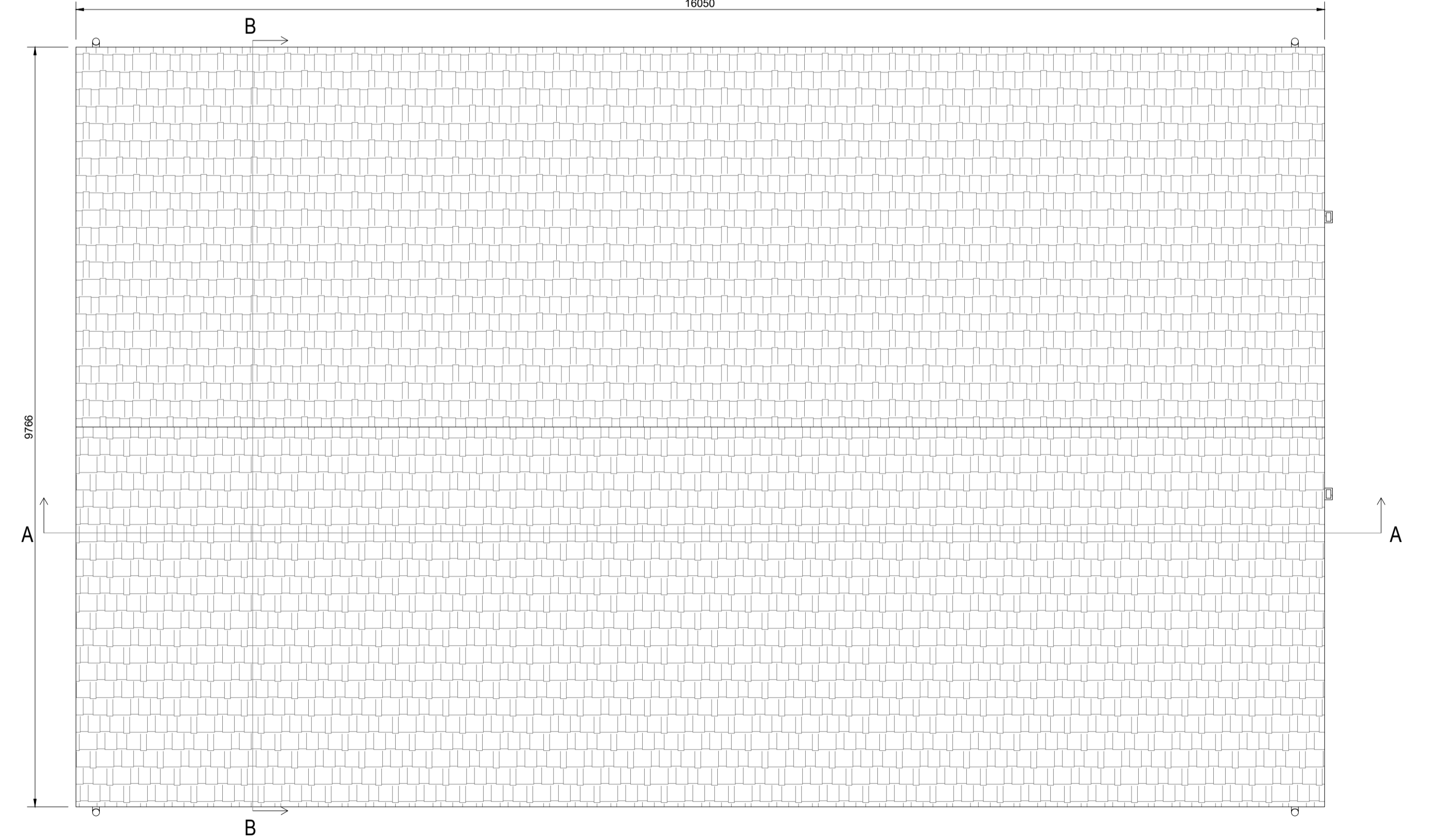
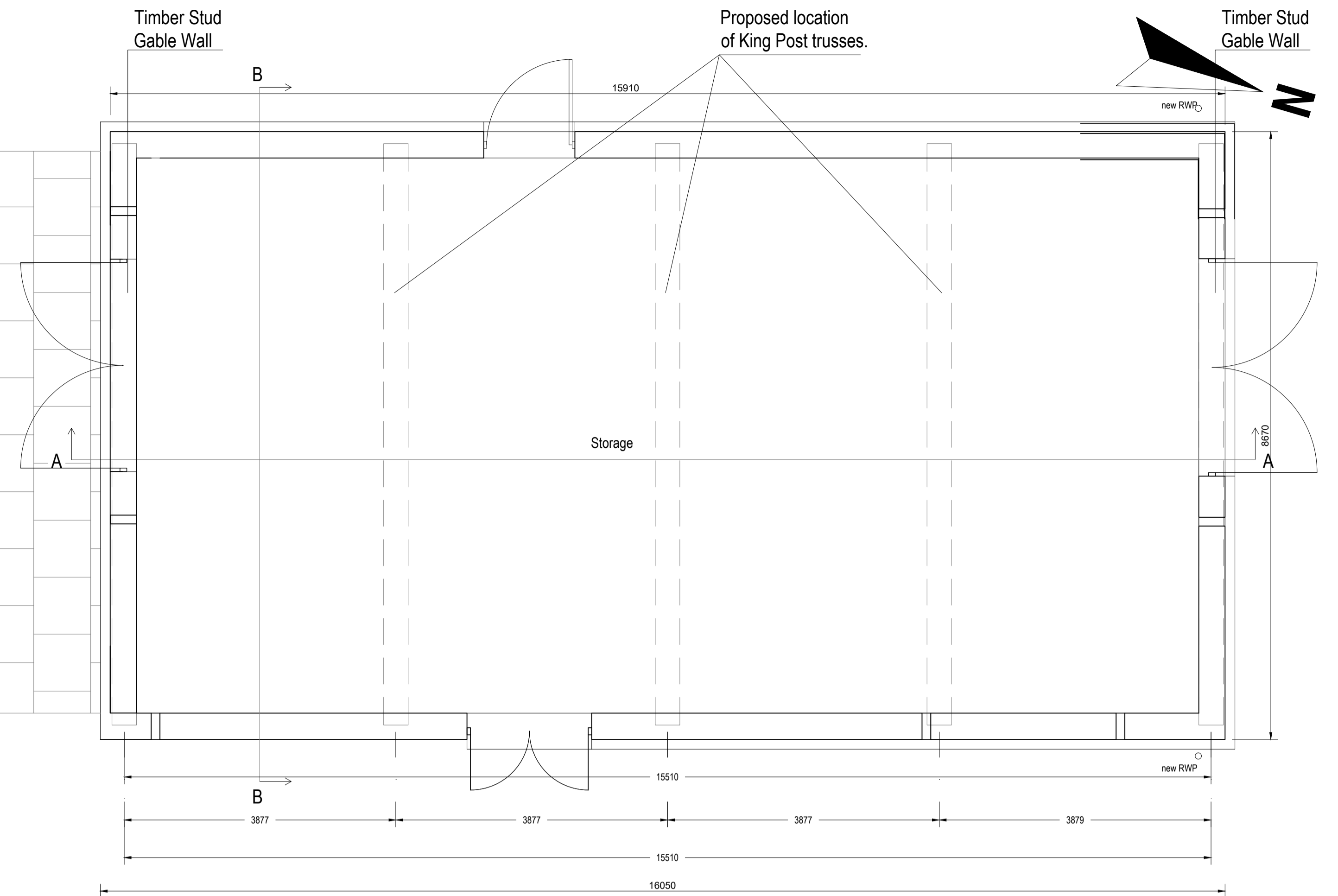

Note to Contractor: Contractor is recommended to carry out an intrusive site investigation prior to commencing works on site to ensure all details designed for this project are appropriate. Contractor to cross reference with Structural Calculations package for suitability, to assess site levels and confirm any design assumptions within the calculations package prior to works commencing on site. If the Contractor requires any additional information, please send a Request For Information to hello@planituk.co.uk before ordering materials and starting the works - requests will be acknowledged and responded to as soon as possible. Please ensure that the drawings have been submitted to Building Control for a Full Plans submission and the compliance report has been discharged before starting works on site.

Drawn by:
FD

Project:
Hartley Court, Grange Hill, DA3 8DY

Date:
08.12.2023

No.:
22-1890

Client:

Drawing Title:
PROPOSED PLANS

Scale @A1:
1:50

Rev:
15

Issue:
PLANNING DRAWING

Page:
D03

