

DO NOT SCALE

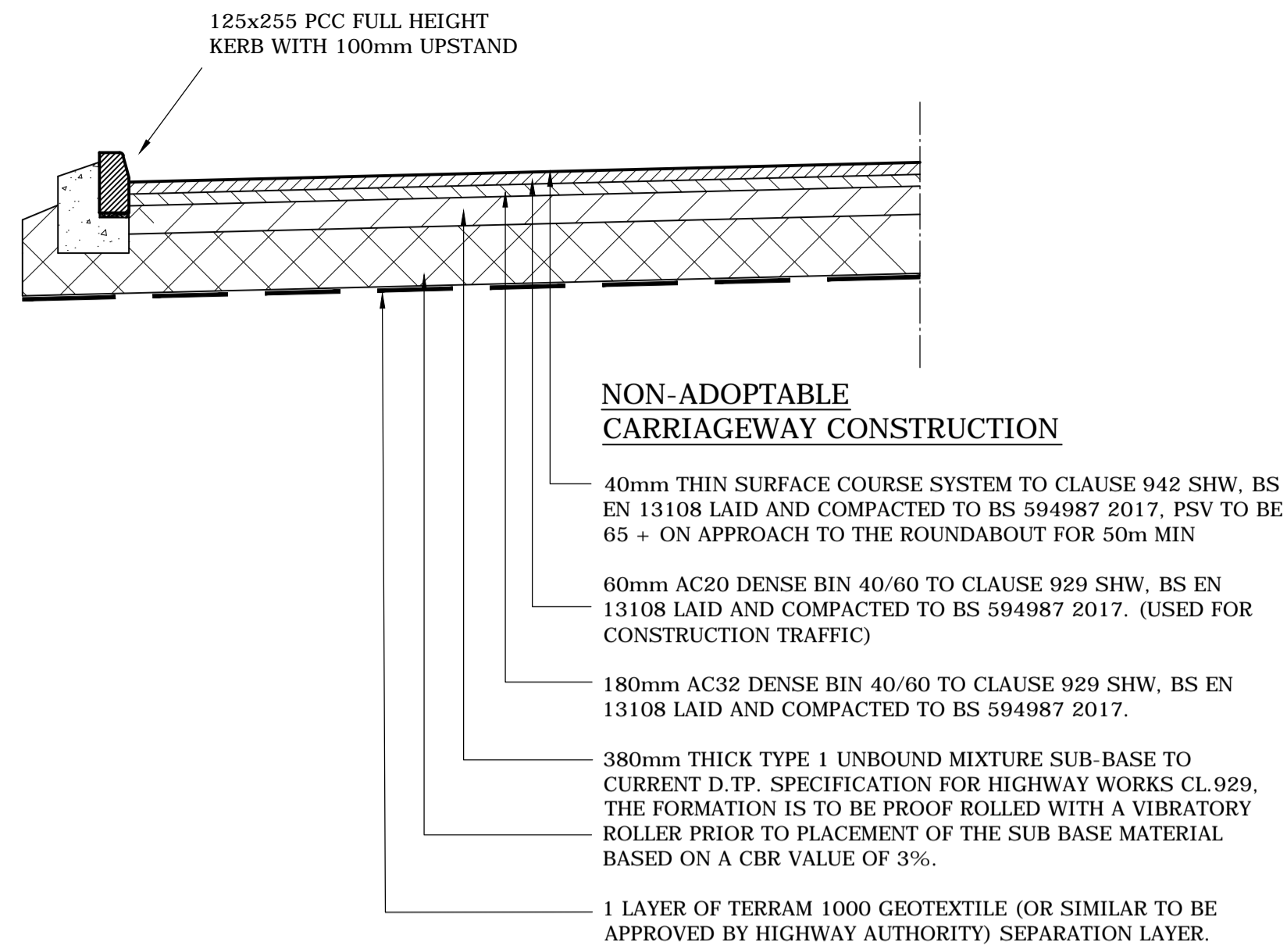

CBRs TAKEN AS PART OF SITE INVESTIGATION UNDERTAKEN BY RICHARD JACKSON DATED SEPTEMBER 2020 SHOW A CBR OF 1% FOR MADE GROUND AND 3% FOR LOWEST OF FORMATION. DESIGN BASED ON CBR VALUES OF 3%. SHOULD CBR DIFFER ON SITE, CONSULT RICHARD JACKSON OR CONSULT TABLE A.

TABLE A - SUB-BASE THICKNESSES

CBR VALUE	INDUSTRIAL ESTATE ROAD	FOOTWAY (ADJ. TO IND. EST RD)
5% OR GREATER	280	150
3-4%	380	200
2%	500	300
<2%	SPECIAL ENGINEERING DESIGNS REQUIRED	

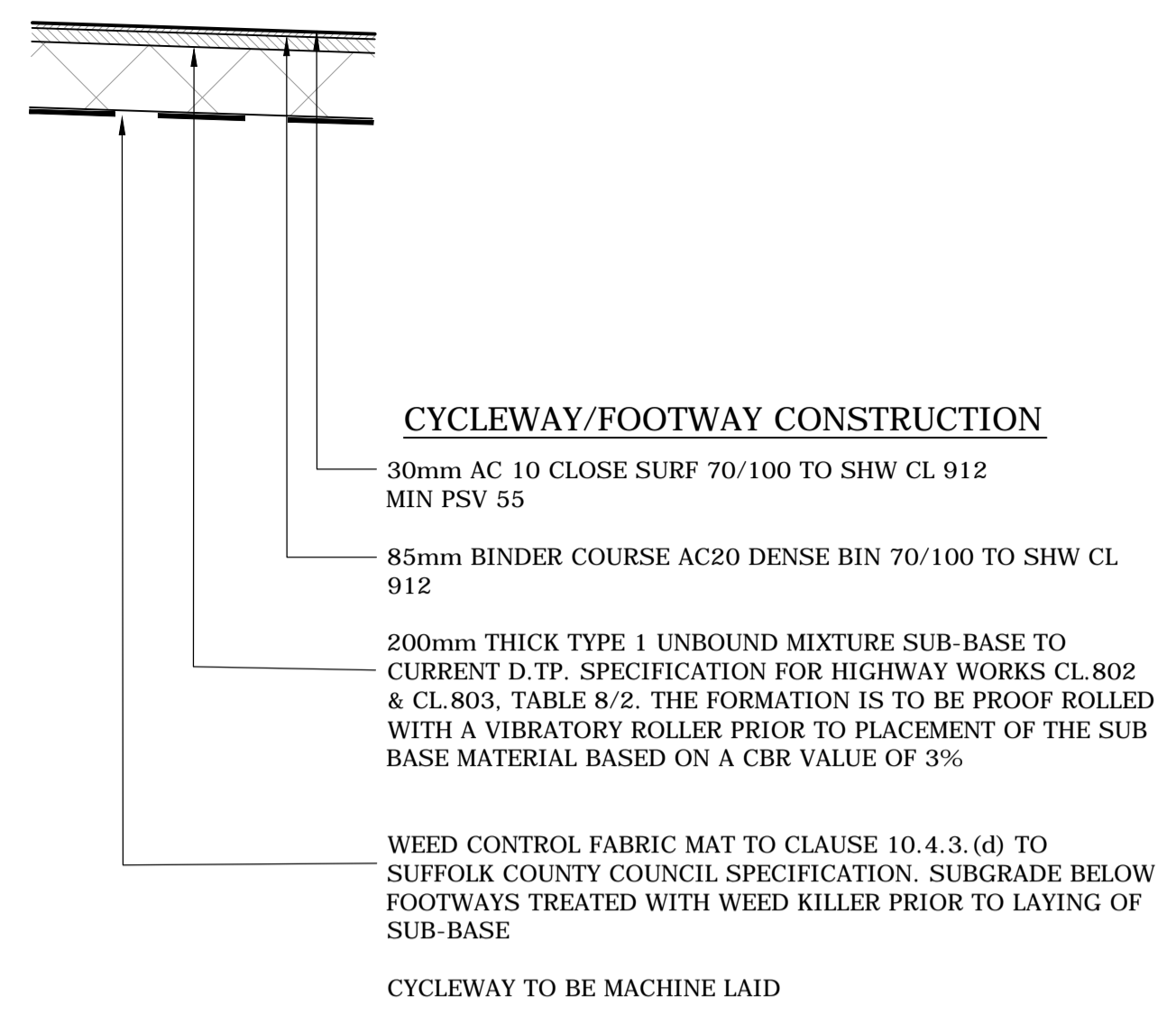

TYPICAL MACADAM, FOOTPATH
SCALE 1:25

- HIGHWAY CONSTRUCTION DETAILS NOTES**
- THIS DRAWING TO BE READ IN CONJUNCTION WITH ALL RELATED RICHARD JACKSON LTD. ARCHITECTS & SUB-CONTRACTORS DRAWINGS. IN THE CASE OF DISCREPANCIES BETWEEN DRAWINGS REFER TO RJD FOR CLARIFICATION.
 - ALL ADOPTABLE HIGHWAY WORKS SHALL BE TO THE REQUIREMENTS AND FULL SATISFACTION OF SUFFOLK COUNTY COUNCIL HIGHWAYS DEPARTMENT.
 - ALL COMPONENTS AND MATERIALS ARE TO BE MANUFACTURED AND SUPPLIED IN ACCORDANCE WITH THE RELEVANT BRITISH STANDARDS AND MANUFACTURERS RECOMMENDATIONS.
 - CONCRETE MIX DESIGNATIONS SHOWN ON THIS DRAWING ARE TO BS 5911-1:2002 & BRE SPECIAL DIGEST 1 "CONCRETE IN AGGRESSIVE GROUND" 2005. DESIGN SULPHATE CLASS DS-1 TO MEET EXPECTED SULPHATE CONDITIONS.
 - EXISTING SERVICES ARE TO BE PROTECTED IN ACCORDANCE WITH THE RELEVANT STATUTORY AUTHORITIES.
 - ALL EXISTING PAVEMENTS AND AREAS OF COLD MILLING TO RECEIVE BITUMINOUS BOND COAT TO SPECIFICATION FOR HIGHWAY WORKS CLAUSES 901.24, AND 920 PRIOR TO OVERLAYING THE NEW BITUMINOUS CONSTRUCTION.
 - ON SUBGRADES OF POORLY GRADED SAND OR WITH CBR OF LESS THAN 5%, A GEOTEXTILE SEPARATOR SHALL BE LAID ON THE FULL WIDTH OF THE COMPACTED SUBGRADE PRIOR TO SPREADING THE SUB-BASE.
 - ON CLAY SUBGRADES DEFINED AS P.I. GREATER THAN 10% THE DEPTH OF SUB-BASE SHALL BE INCREASED BY 75mm AND THE EXTRA MATERIAL MAY BE TYPE 2 COMPLYING WITH THE REQUIREMENTS OF CLAUSE 9.4 OF SCC ERS - AS SCC ERS 10.4.3B
 - GULLY GRATING IN BLOCK PAVED AREAS SHALL HAVE MINIMUM CLEAR DEPTH OF 100mm CONTINUOUSLY AROUND THE EDGE OF THE CASTING.
 - ALL GRATINGS TO BE BEDDED AS PER SECTION 7.13.5 OF SCC ERS.
 - FOR THIN SURFACE COURSE AIR VOIDS TO BE MEASURED TO BS EN 12597-6 PROCEDURE C. RESISTANCE TO PERMANENT DEFORMATION CLASSIFICATION 1 EXCEPT AT APPROACHES TO ROUNDABOUT AND TRAFFIC SIGNALS WHICH IS CLASSIFICATION 2.
 - DENSE BINDER COURSE MATERIALS TO SHW CL929 VOID CONTENT TO BE NOMINATED AND RESISTANCE TO PERMANENT DEFORMATION CLASSIFICATION 1.
 - JOINTS SHOULD AVOID WHEEL TRACKS AND IN HIGH STRESS AREAS WHERE BREAKING LIKELY SURFACE COURSE SHOULD BE LAID FULL WIDTH OF LANE TO AVOID DIFFERENTIAL SKIDDING.
 - TESTING TO BE CARRIED OUT TO SHW CL 882 TO PROVE FORMATION DURING CONSTRUCTION. TESTING ALSO REQUIRED TO VERIFY THE FOUNDATION STIFFNESS MODULUS - 100MPa AS PER THE DESIGN ASSUMPTIONS

TYPICAL INDUSTRIAL ESTATE ROAD ROAD CROSS SECTION
SCALE 1:25

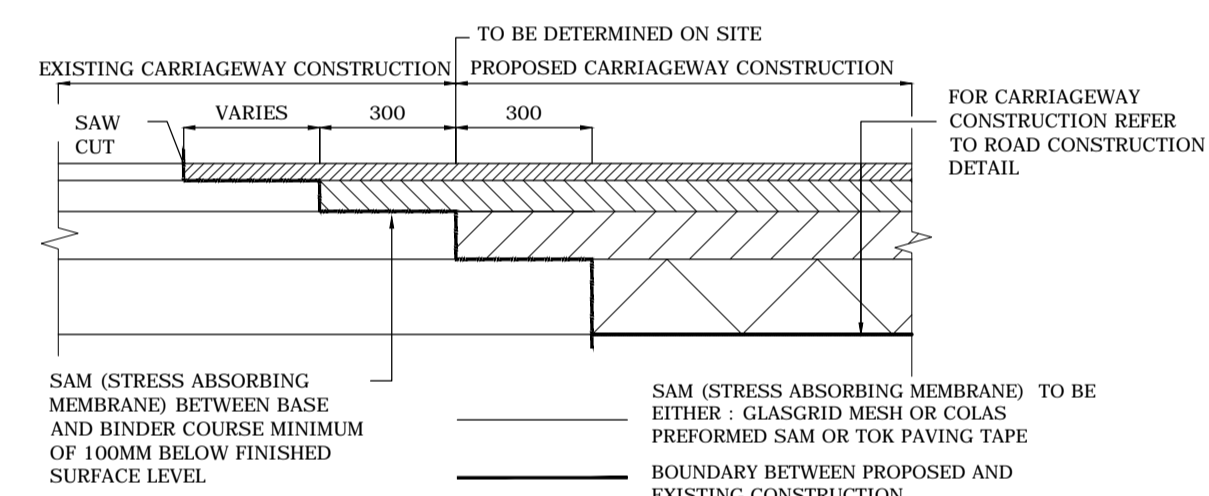
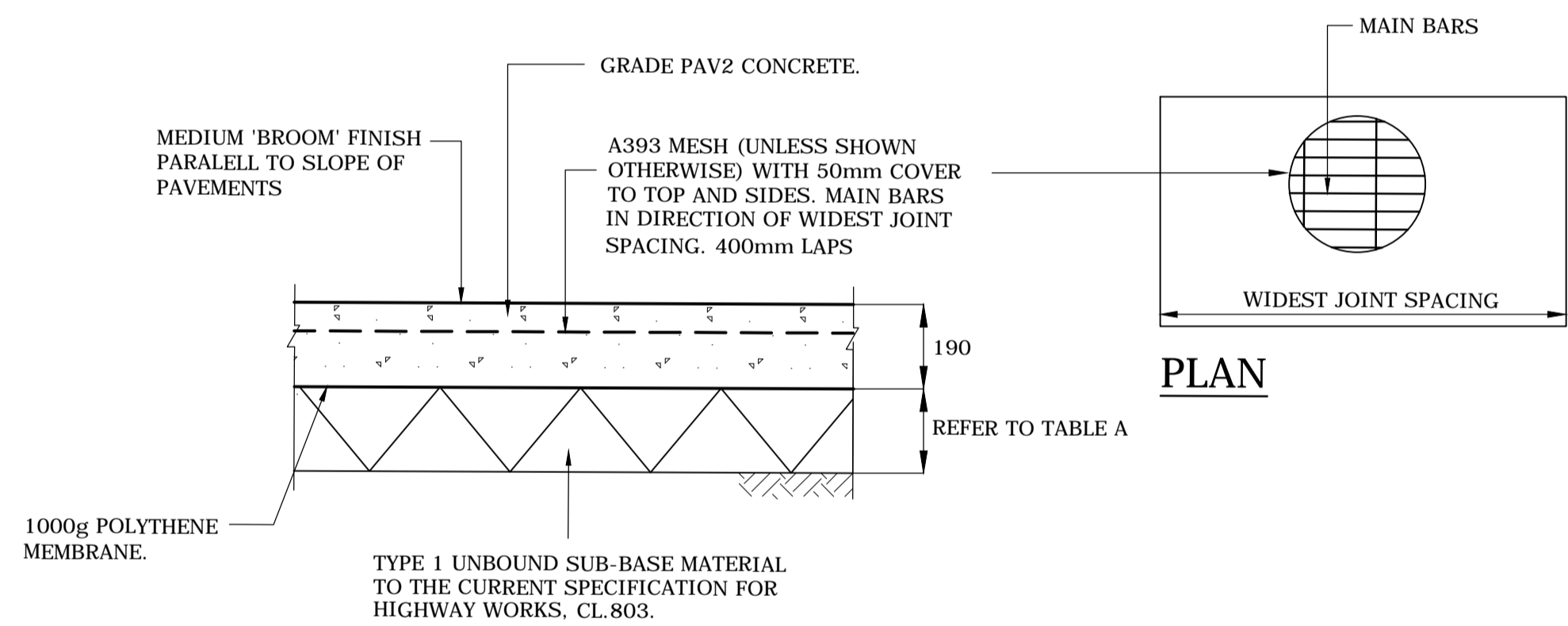

REV	DATE	DESCRIPTION	DRAWN	CHKD
REVISIONS				

This drawing is to be read in conjunction with all other Engineer's drawings and all other project information. Any discrepancy between the Engineer's drawings and other project information is to be reported to the Engineer immediately.



TYPICAL CONCRETE PAVEMENT DETAIL FOR HGV SERVICE YARD

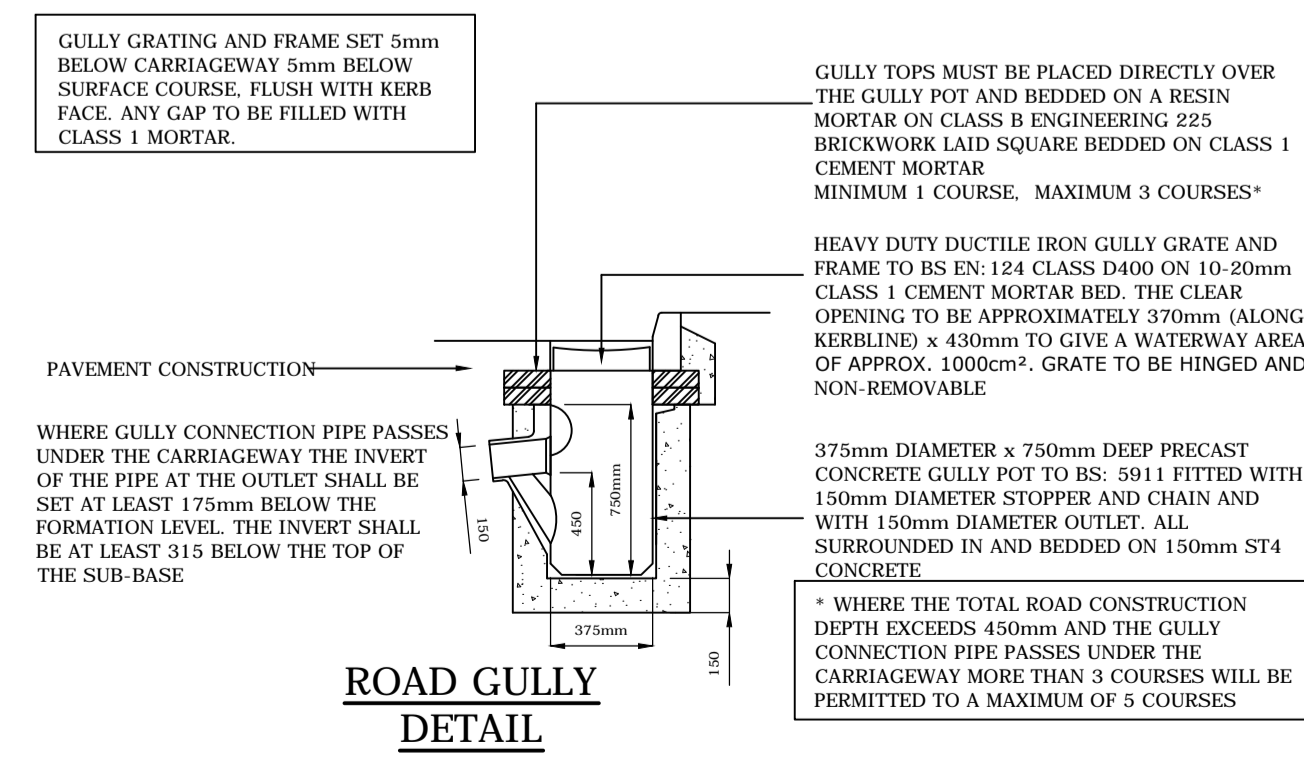
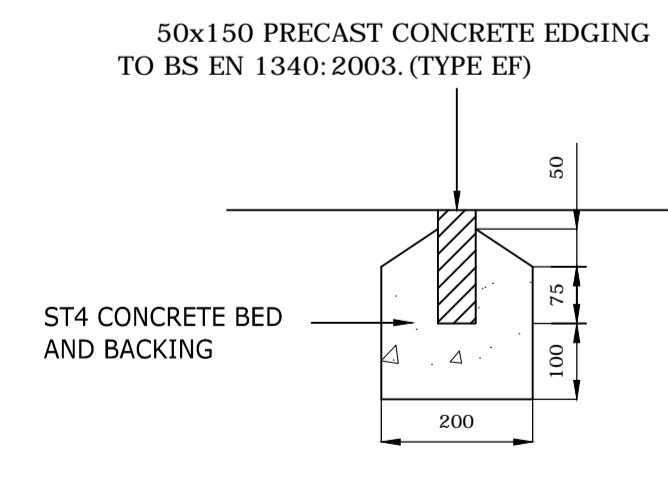
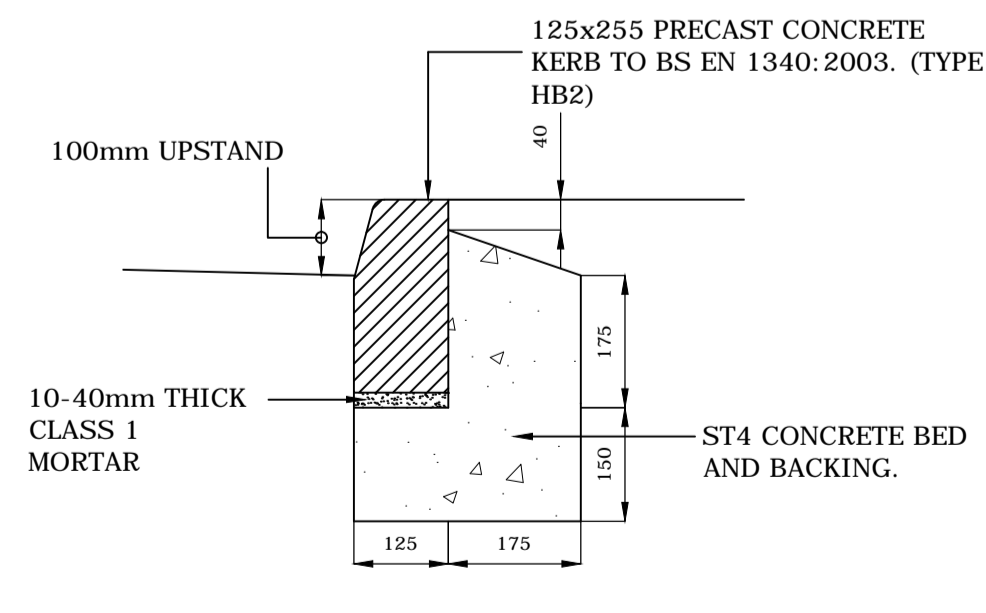
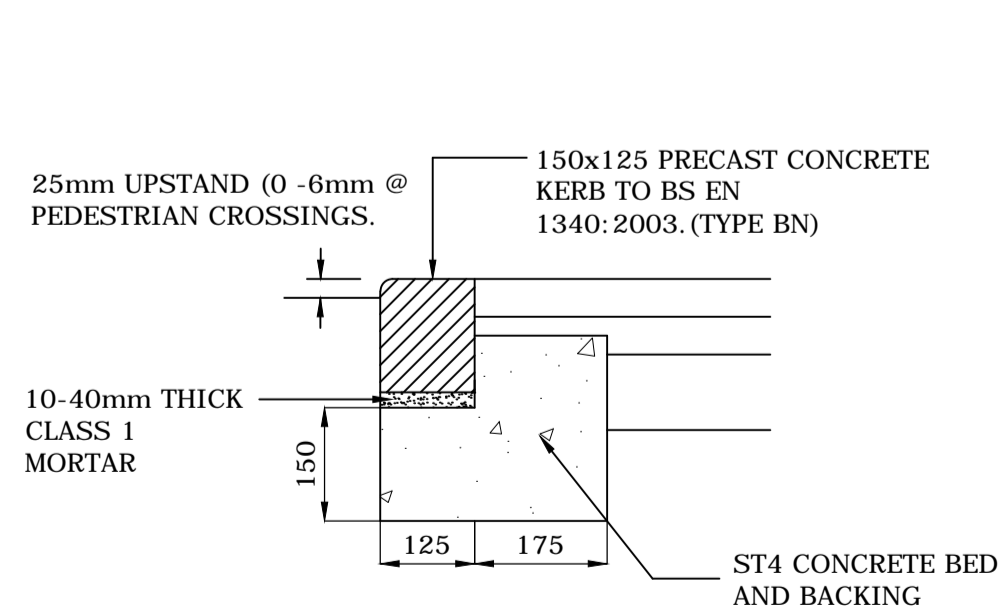

NOTE: FALLS ON CROSSING AREA NOT TO EXCEED 1:15 ACROSS FOOTWAY

Project
G14 PLOT 4000

Title
PRIVATE HIGHWAY CONSTRUCTION DETAILS

Client
GATEWAY14
STOWMARKET

Scale AS SHOWN @ A1	Drawn AA	Date 05/07/22
Job Manager MG	Checked NB	Approved MG

Richard Jackson Engineering Consultants

847 The Crescent, Colchester, Essex CO4 9YQ Tel: 01206 228800
 Suite 400, 1 Albion Street, London E1 6DE Tel: 020 7448 9910
 5 Queens House, Mill Court, Great Shelford, Cambs CB22 5LD Tel: 01223 314794
 6 The Old Church, St. Matthews Road, Norwich, Norfolk NR1 1SP Tel: 01603 230240
 The Wheelhouse, Bonds Mill, Stonehouse, Gloucestershire GL10 3RF Tel: 01172 020070
 Email Address: mail@rj.co.uk Website: <http://www.rj.co.uk>

Drawing No. 61445-C-008	Revision -
-----------------------------------	---------------

<input checked="" type="checkbox"/> INFORMATION	<input type="checkbox"/> APPROVAL	<input type="checkbox"/> COSTING
<input type="checkbox"/> TENDER	<input type="checkbox"/> CONSTRUCTION	<input type="checkbox"/> AS CONSTRUCTED