

## STATUTORY DECLARATION OF JANET TAYLOR

I, JANET TAYLOR, of NEW FARM, ST MAWGAN, CORNWALL TR8 4HH do solemnly and sincerely declare as follows:

1. The triangular section of land [hereafter referred to as "Land A"] situated at New Farm, St Mawgan, Cornwall TR8 4HH as now produced and shown to me on the plan marked "JT1" has continually served as part of the domestic curtilage and garden forming part of the property at New Farm for in excess of the last ten years.
2. In 1991, a strip of access land was sold to our neighbours, Herbert James Hazell, and Violet Kathleen Hazell for creation of a new private vehicular access lane to their property. Land A was severed from adjoining land due to creation of the new access lane and consequently bonded together with curtilage and garden serving our home at New Farm.
3. For in excess of ten years, Land A has been continually used and enjoyed by our family for the purposes of children's play area including children's camp, tree climbing, building dens, stationing of wooden play structures, tree swings, as well as siting of caravan for family use, outhouse / garden store, childhood pets play area, pet houses, pet runs, and sand pit.
4. The rectangular section of land [hereafter referred to as "Land B"] situated at New Farm, St Mawgan, Cornwall TR8 4HH as now produced and shown to me on the plan marked "JT2" has continually served as part of the domestic curtilage and garden forming part of the property at New Farm for in excess of the last ten years.
5. For in excess of ten years, Land B has been continually used and enjoyed by our family for the purposes of stationing of playhouse for children, dog kennels and run, outhouses, as well as garden works and planting and erection of temporary marquee for family events.
6. Now produced and shown to me marked "JT3" are two photographs [hereafter referred to as "Photo 1" and "Photo 2"] taken in July 2006 of a marquee on Land B for the occasion of our daughter Alison's wedding. Photo 1 shows access steps descending from our front lawn to Land B where the marquee is positioned. Photo 2 shows the marquee situated on Land B in proximity to our home.

I make this solemn Declaration conscientiously believing the same to be true by virtue of the provisions of the Statutory Declarations Act 1835

DECLARED by the above named

[Redacted]

JANET TAYLOR at

*Ment, Cross Street,  
Wadebridge PL27 7DT*

THIS *10<sup>th</sup>* DAY OF *June* 2023

Before me: [Redacted]

Timothy Foster Merrick (Solicitor)  
SRA No. 375282 Tel: 01208 812068  
Merricks Solicitors Limited  
Cross Street, Wadebridge  
Cornwall, PL27 7DT

Solicitor/Commissioner for Oaths

This is the exhibit referred to in the Statutory Declaration of

JANET TAYLOR marked "JT1"  
Sworn the 14<sup>th</sup> day of December 2023

Before me ..... 

Solicitor/Commissioner for Oaths

Land used as domestic curtilage / garden land at New Farm, St Mawgan, Cornwall TR8 4HH

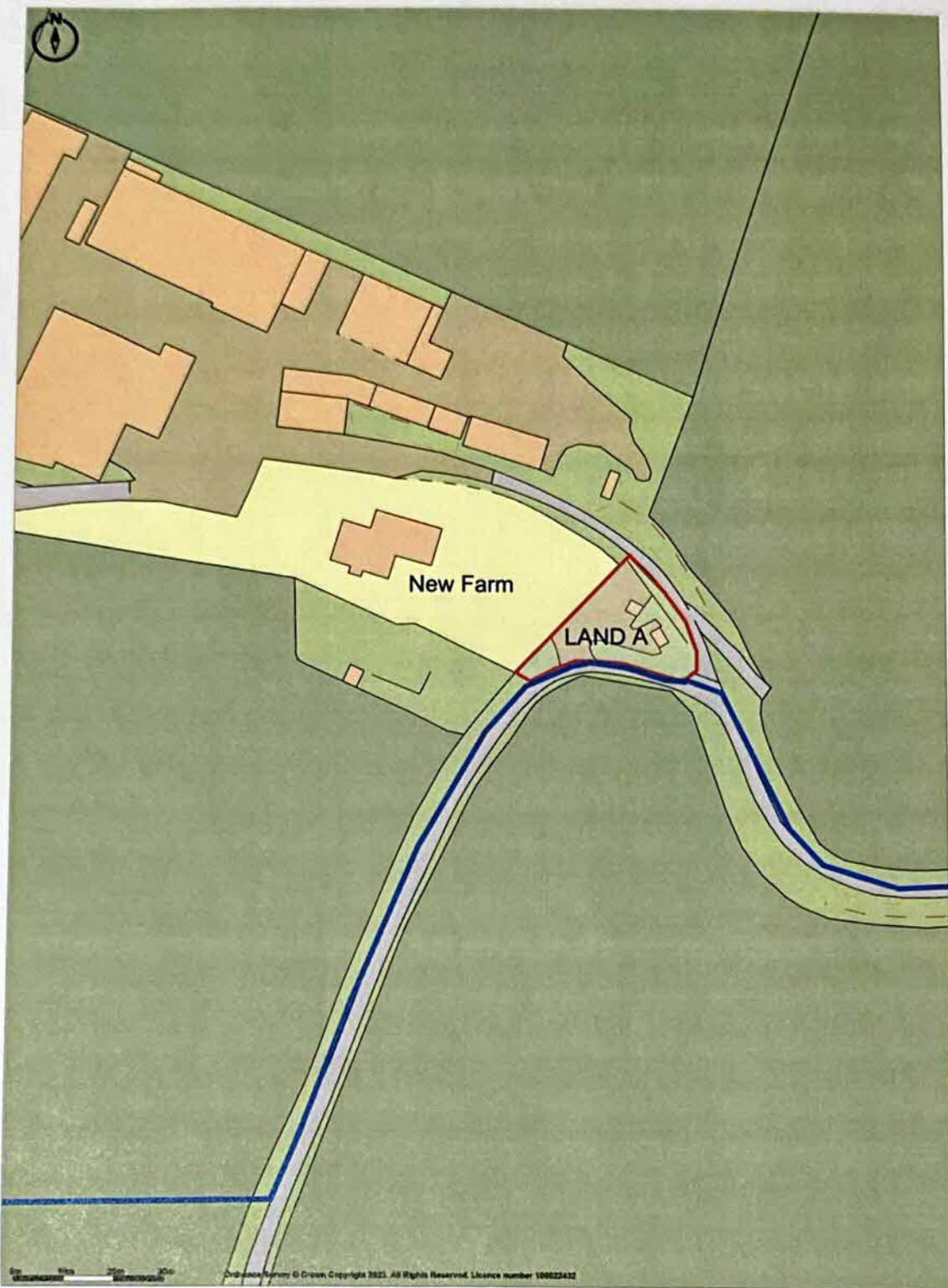

This is the exhibit referred to in the Statutory Declaration of

JANET TAYLOR marked "JT2"  
Sworn the *14<sup>th</sup>* day of *June* 2023

Before me ..



Solicitor/Commissioner for Oaths

Land used as garden curtilage at New Farm, St Mawgan, Cornwall TR8 4HH

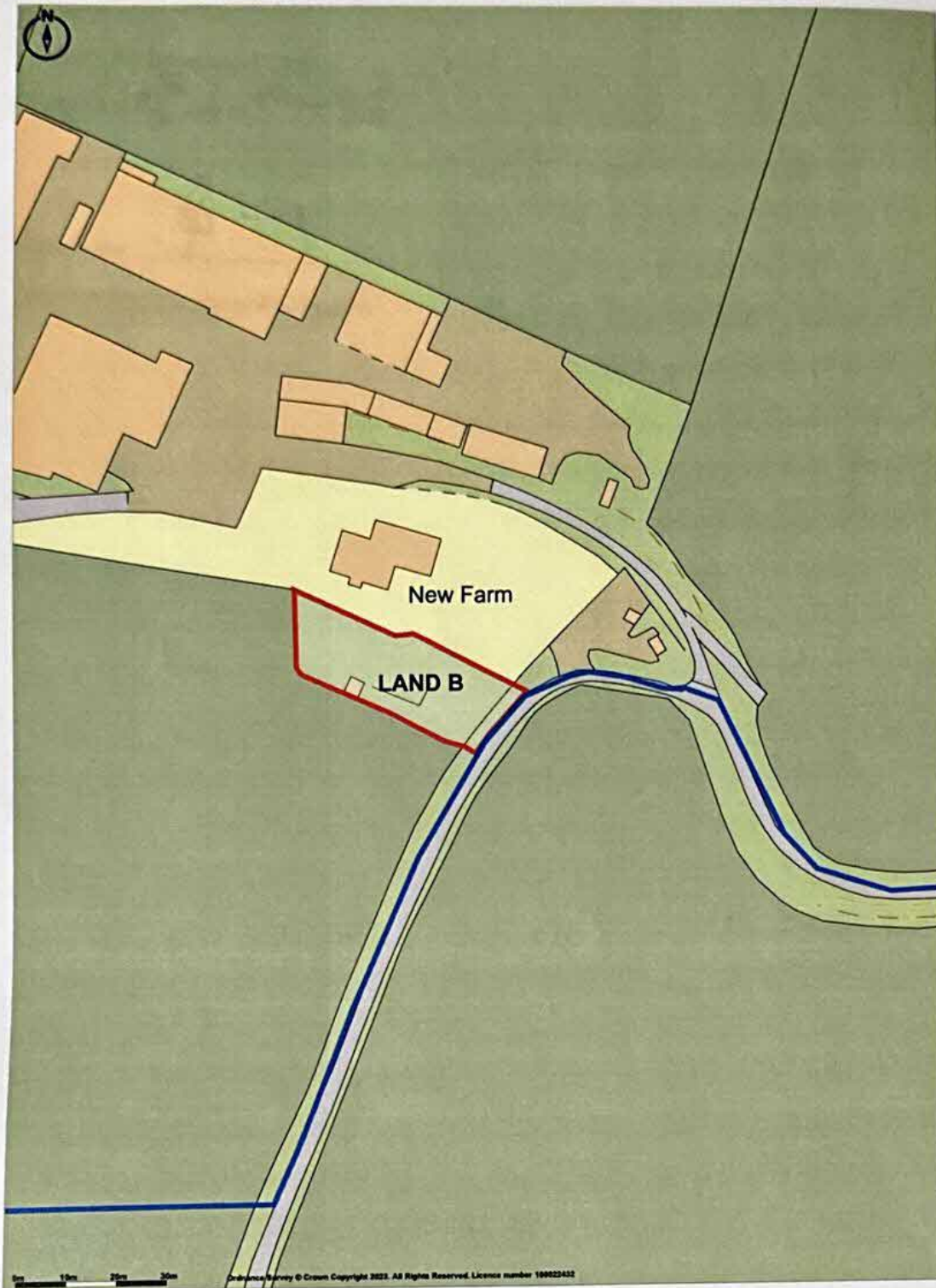

This is the exhibit referred to in the Statutory Declaration of

JANET TAYLOR marked "JT3"

Sworn the 10<sup>th</sup> day of June 2023

Before me



Solicitor/~~Commissioner for Oaths~~

JT3



PHOTO 1



PHOTO 2