

EXISTING BASEMENT FLOOR PLAN 1:50 @ A1

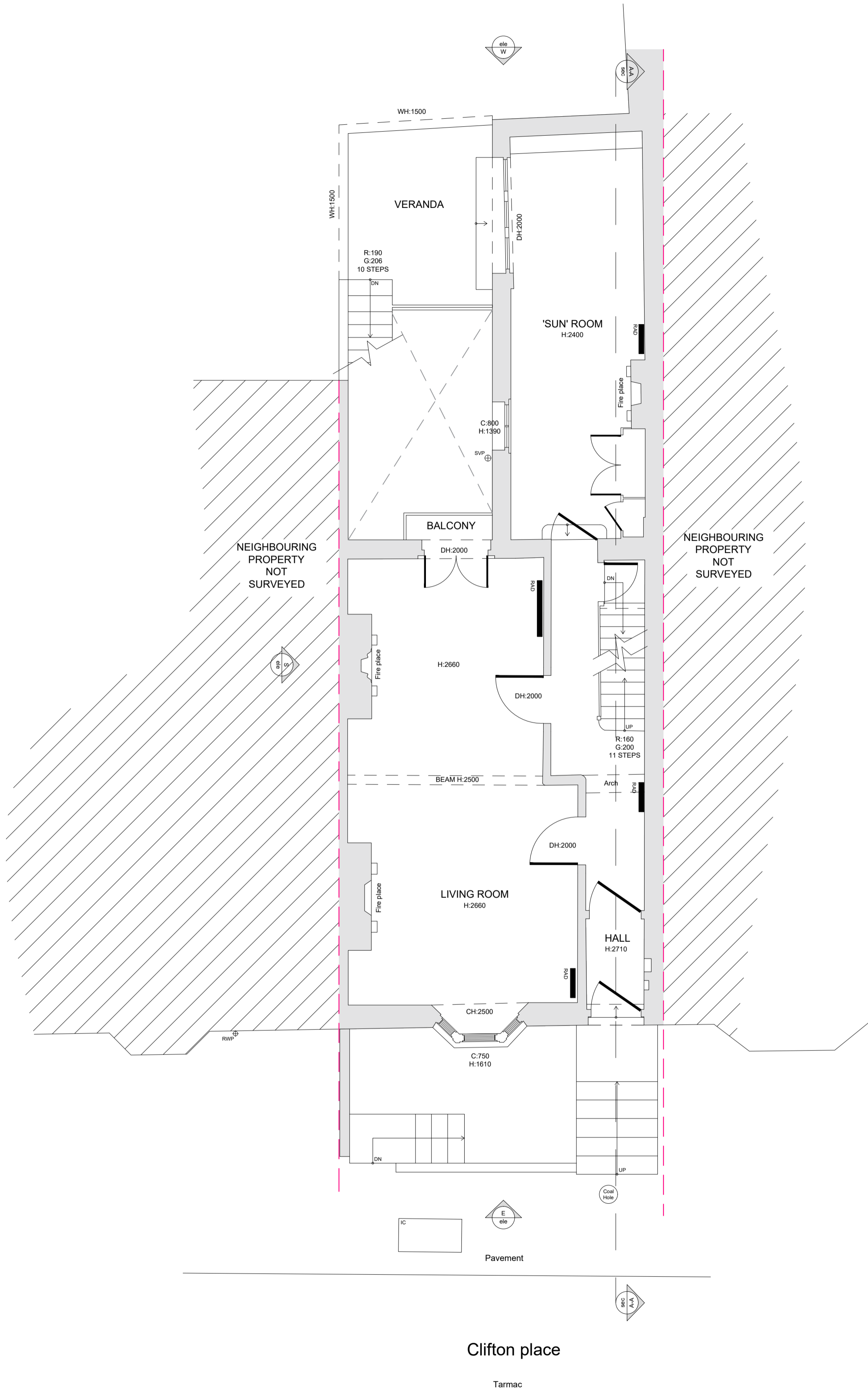

EXISTING GROUND FLOOR PLAN 1:50 @ A1

## LEGEND

- GAS METERS
- ELECTRICAL METERS
- BOILER
- CONSUMER UNIT
- MEGAFLOW UNIT
- RADIATOR
- HEATED TOWEL RAIL
- DIRECTION OF ROOF FALL
- INSPECTION CHAMBER
- SOIL VENTILATION STACK
- STUB STACK
- RAINWATER PIPE
- GULLEY
- WATER FEED/TAPS
- PENDANT LIGHT FITTING
- WALL MOUNTED LIGHT FITTING
- SPOT/DOWN LIGHT FITTING
- UP LIGHT FITTING
- EXTERNAL LIGHT FITTING
- CEILING FAN
- 30MIN FIRE RATED DOOR
- SMOKE DETECTOR
- HEAT DETECTOR
- CARBON MONOXIDE DETECTOR
- TOUGHENED SAFETY GLASS
- OBSCURE GLAZING
- 30LS MECHANICAL VENTILATION
- 60LS MECHANICAL VENTILATION
- BESPOKE MECHANICAL VENTILATION
- KITCHEN VENTILATION FLUE
- BATHROOM VENTILATION FLUE
- UTILITY ROOM VENTILATION FLUE
- BOILER VENTILATION FLUE
- TUMBLE DRYER VENTILATION

LIFE  
SIZE

01273 555 744  
studio@lifesizearchitecture.co.uk  
www.lifesizearchitecture.co.uk

description: date: revision:

## EXISTING BASEMENT & GROUND FLOOR PLAN

project no: 22025CP drawing no: 002

drawing status: PLANNING

client: MR & MRS HASSELL-HART  
project: 11 CLIFTON PLACE, BRIGHTON  
PROPOSED MINOR EXTERNAL AMENDS

date: 05.12.23 scale: 1:50 @ A1 drawn: MB checked: MB