

Location Plan

1 : 1250

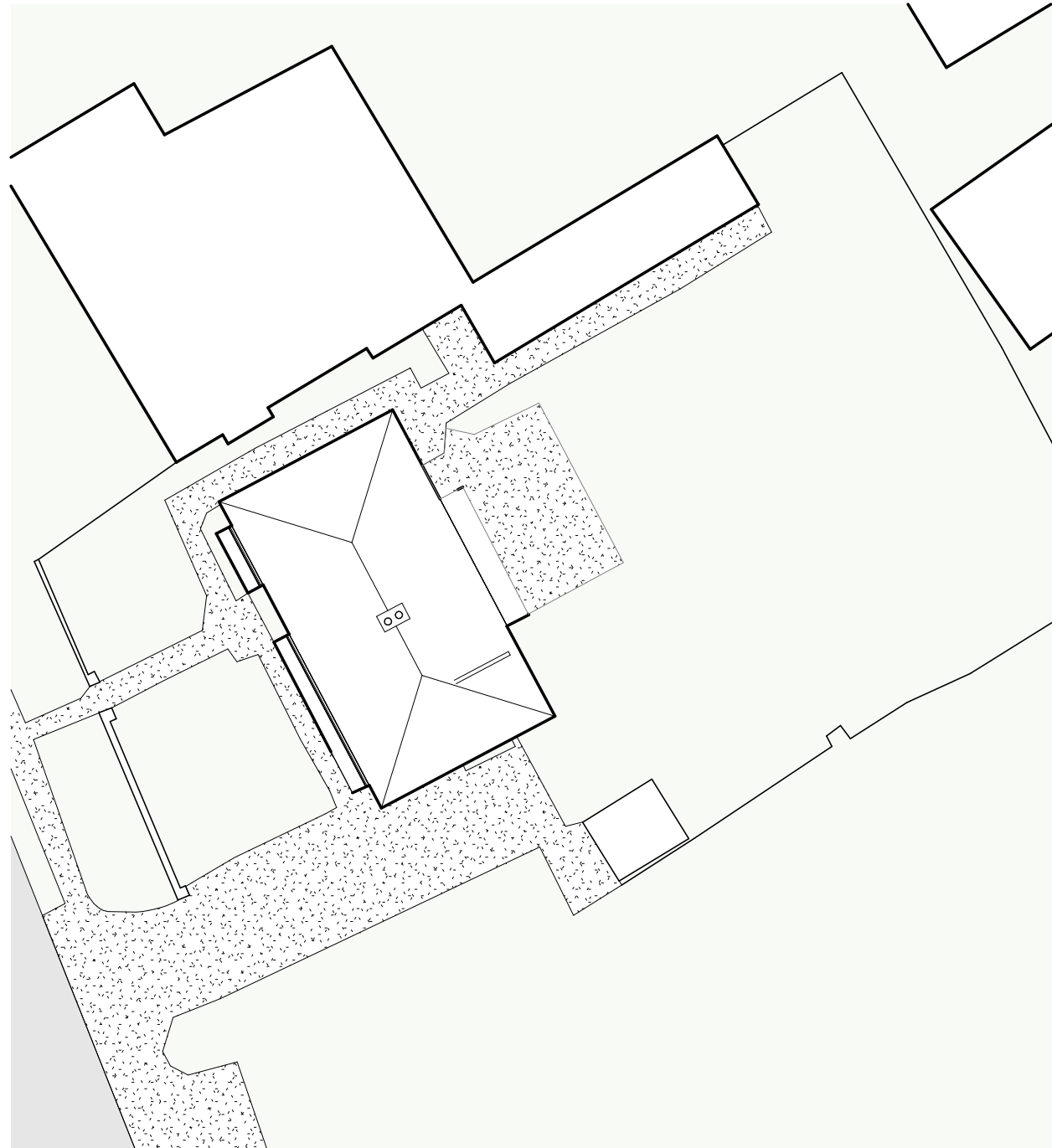
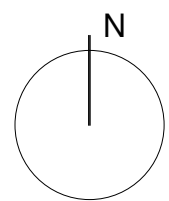
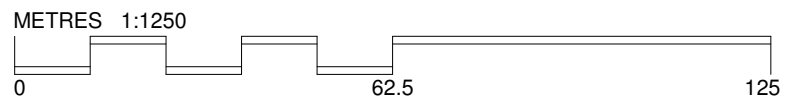

Existing Site Plan

1 : 200

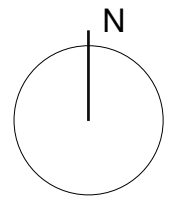
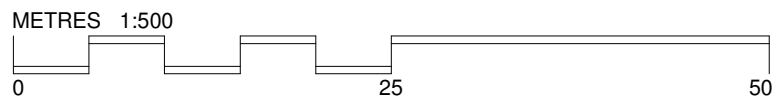

PRELIMINARY

Rev.	Date	Description	Drawn
A	27.03.24	Amendment to location plan	AH

Palmer+
Partners

James Bell and Iola Wordsworth
 66 Corbetts Way, Thame, Oxon
 OX9 2FN

23034 EX 90 A

Existing Site Plan Scale: As indicated A3
 Date: March 24
 Drawn by: AH