

SECTION SHOWING NEW PICTURE RAIL (Bedroom side only)
Scale : FULL SIZE (1:1)

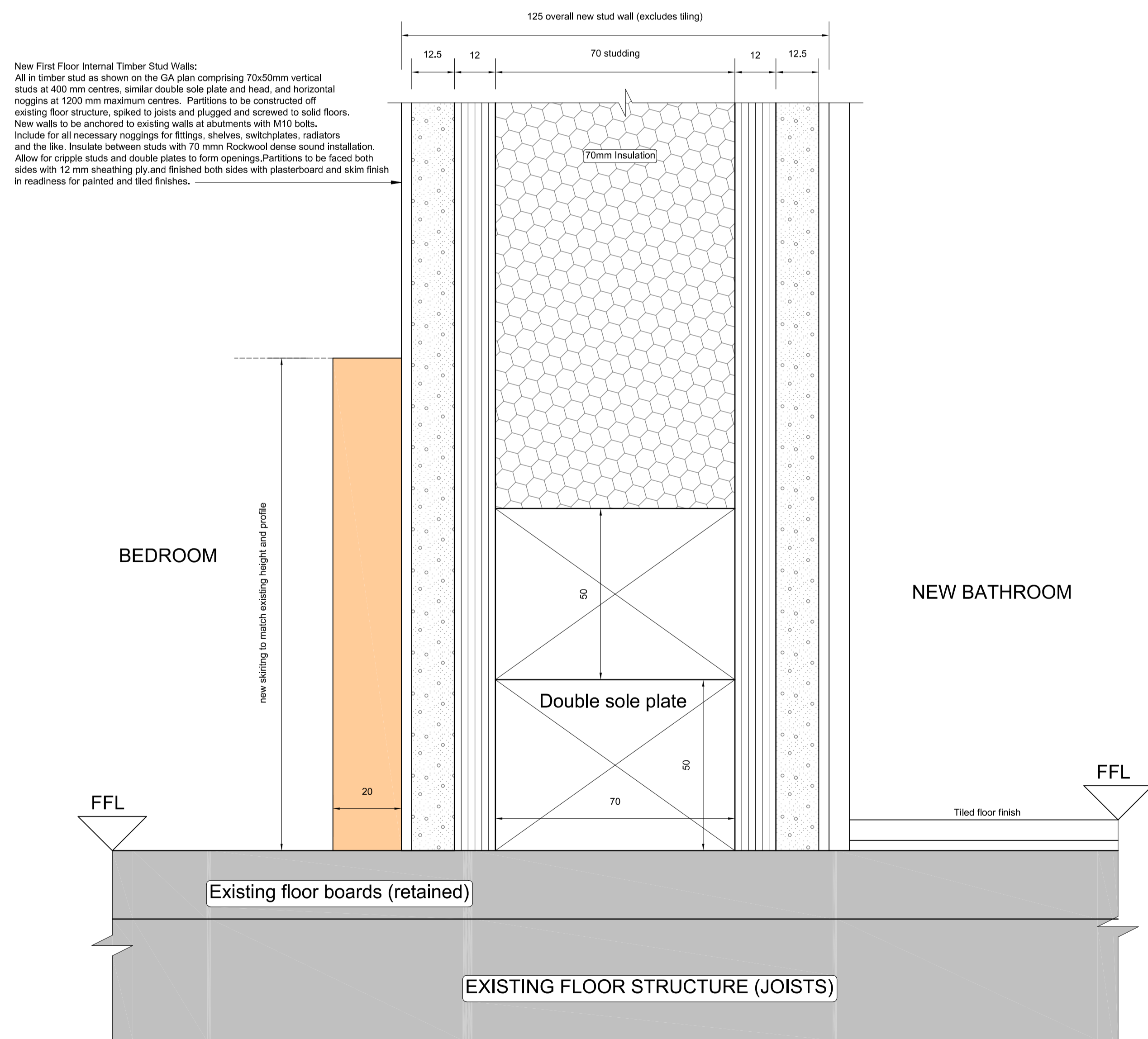

PROPOSED SECTION SHOWING NEW TIMBER STUD WALL & SKIRTING BOARD
Scale : FULL SIZE (1:1)

New First Floor Internal Timber Stud Walls:
All in timber stud as shown on the GA plan comprising 70x50mm vertical studs at 400 mm centres, similar double sole plate and head, and horizontal noggins at 1200 mm maximum centres. Partitions to be constructed off existing floor structure, spiked to joists and plugged and screwed to solid floors. New walls to be anchored to existing walls at abutments with M10 bolts. Include for all necessary noggins for fittings, shelves, switchplates, radiators and the like. Insulate between studs with 70 mm Rockwool dense sound installation. Allow for cripple studs and double plates to form openings. Partitions to be faced both sides with 12 mm sheathing ply and finished both sides with plasterboard and skim finish in readiness for painted and tiled finishes.

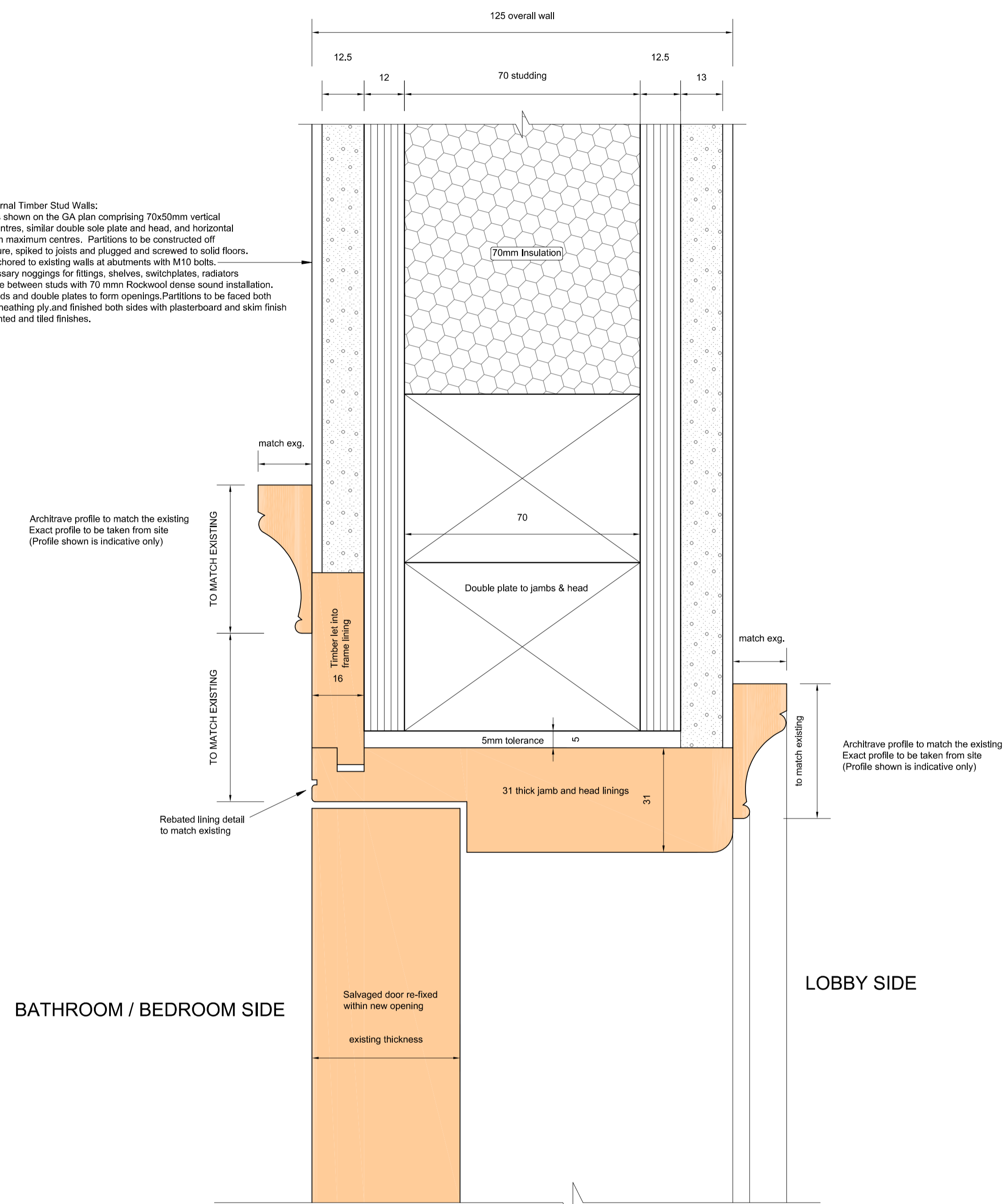

DG.01 - PROPOSED BATHROOM / BEDROOM DOOR HEAD DETAIL (JAMB SIMILAR)
Scale : FULL SIZE (1:1)

David K Donohoe Architectural Design Services	
Email: dkdonohoe@yahoo.com Mobile: 07841 595405	
LOCATION: 16 Gloucester Place Windsor Berkshire SL4 2AJ	
TITLE: Full Size Skirting, Door Lining / Architrave and Picture Rail Details as Proposed	
SCALE: 1:1 @ A1 sheet	DATE: 24 March 2024
Drawing No: 06	