

Section E-E 1:25

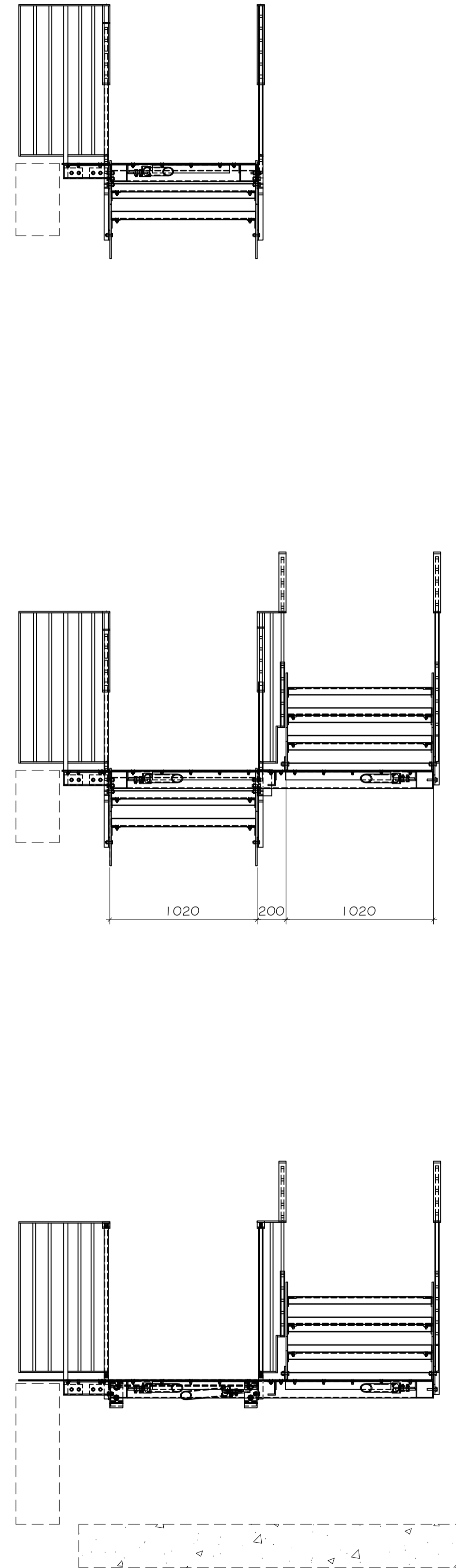

Section F-F 1:25

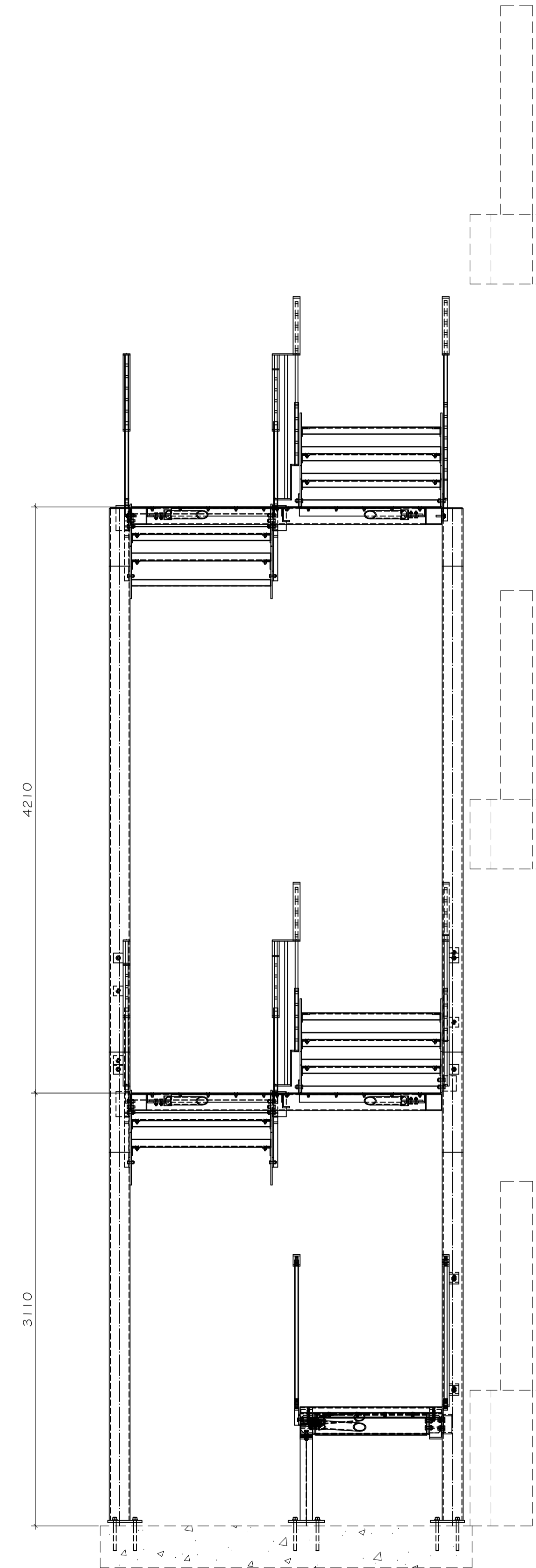

Section G-G 1:25

General Notes

1. This drawing must not be scaled.

Index	Date	Description	Author
1	14/03/2024	Issued for approval	HD

REVISIONS

ABLE 1-2 Park Street, Forton Industrial Estates,
Gosport, Hants, PO12 4JH
Tel: 023 92 425425 Fax: 023 92 425444

STEEL FABRICATIONS LTD.

CLIENT

C & L Management Ltd

PROJECT

King Edward VII Hospital, Windsor

DRAWING TITLE

DRAWN BY	CHECKED BY	DATE	SCALE
HD	PS	14/03/2024	As Noted

PROJECT No.	DRAWING No.	REV
24/C&L/977	[G] - 0005	1