

Existing Block Plan

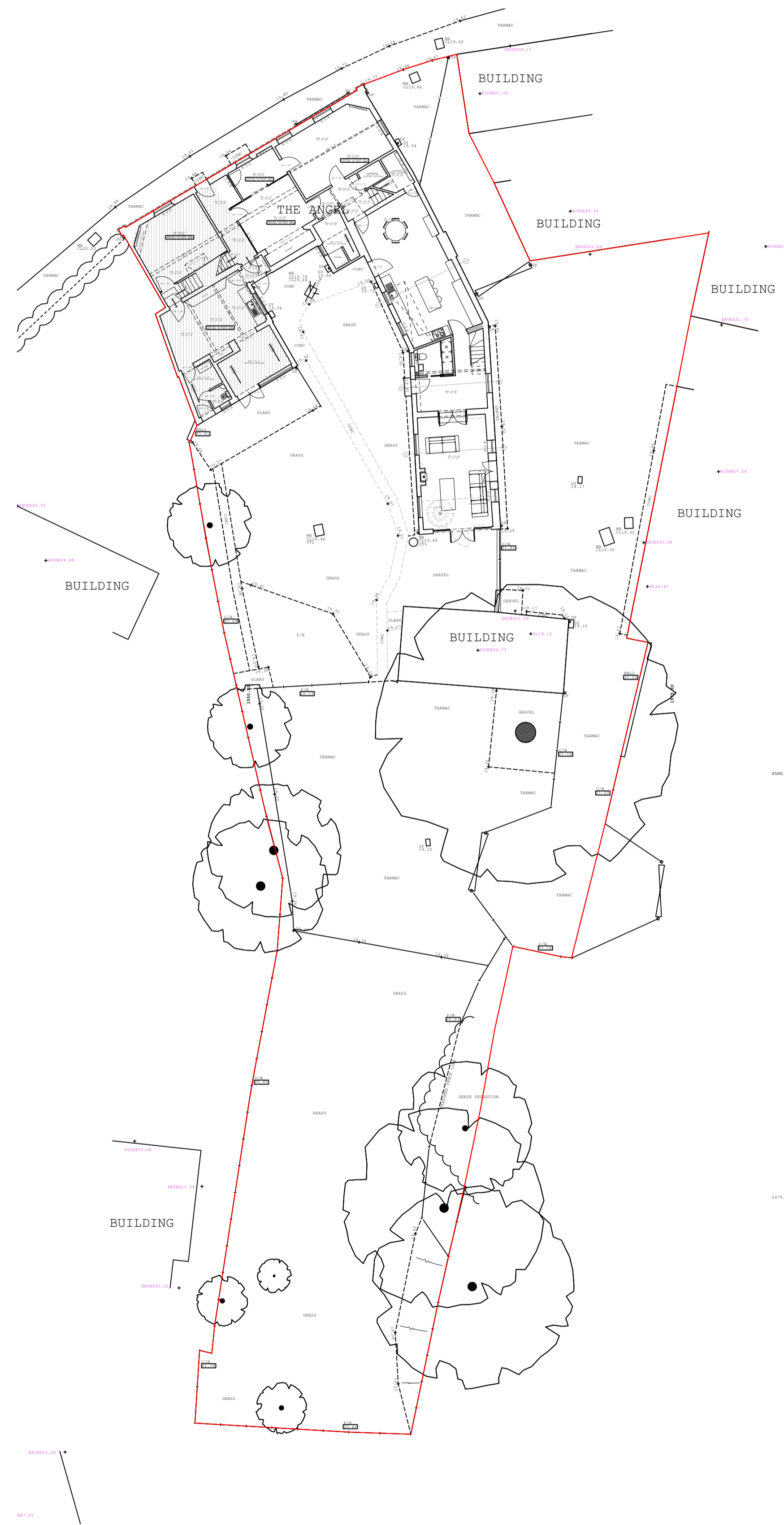

Proposed Block Plan

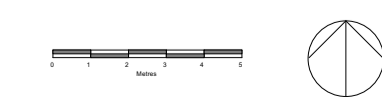

Rev	Date	Note
C	26 03 24	North arrow and scale bar added
B	19 03 24	Red boundary amended
A	18 05 23	Red boundary amended

Purpose of Issue: Planning & LBC Application

**Alison Akester Architects**  
 1 RIDGEWAY, LITTLE HADHAM, WARE, SG11 2BT  
 Tel: 07914 676114  
 E: alison@aakarchitects.co.uk

Client:

Project: Proposed Extension & Internal Alterations  
 The Angel, Stortford Rd, Little Hadham,  
 SG11 2DG

Drawing No: NNS122\_BP(C)

Drawing Title: Existing & Proposed Block Plans

Scale: 1:200 @ A1 Date: 26/04/2023