

PROPOSED 2 No. DWELLINGS
NEWSEAT OF SCHIVAS, YTHANBANK

SITE PLAN
Drg No 2303(Site 2)01 1:250 @ A0

Stephen G Brown Architect Ltd
22 Millwood Road, Ellon, AB41 9FA
01358 720250 M 07483887685
stevebrown.architect@btopenworld.com

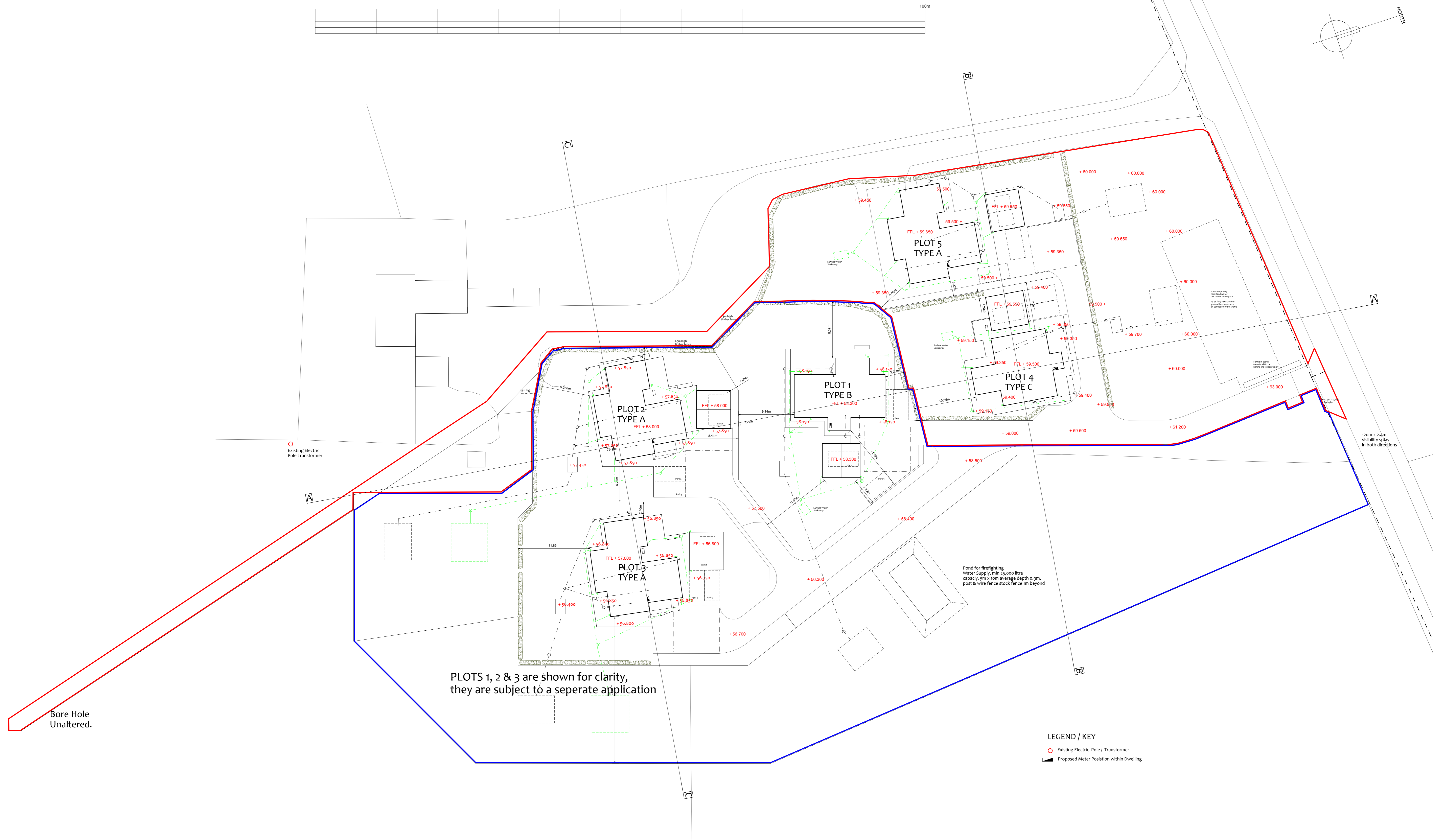

PLOTS 1, 2 & 3 are shown for clarity,
they are subject to a separate application

LEGEND / KEY
 ○ Existing Electric Pole / Transformer
 ■ Proposed Meter Position within Dwelling

Bore Hole Unaltered.

Fund for fire-fighting
Water Supply: min 5,000 litre
capacity, min 1m average depth 0.9m,
post & wire fence stock fence 1m beyond

120m x 2.5m
visibility splay
in both directions