

Existing Ground Floor Plan 1:50

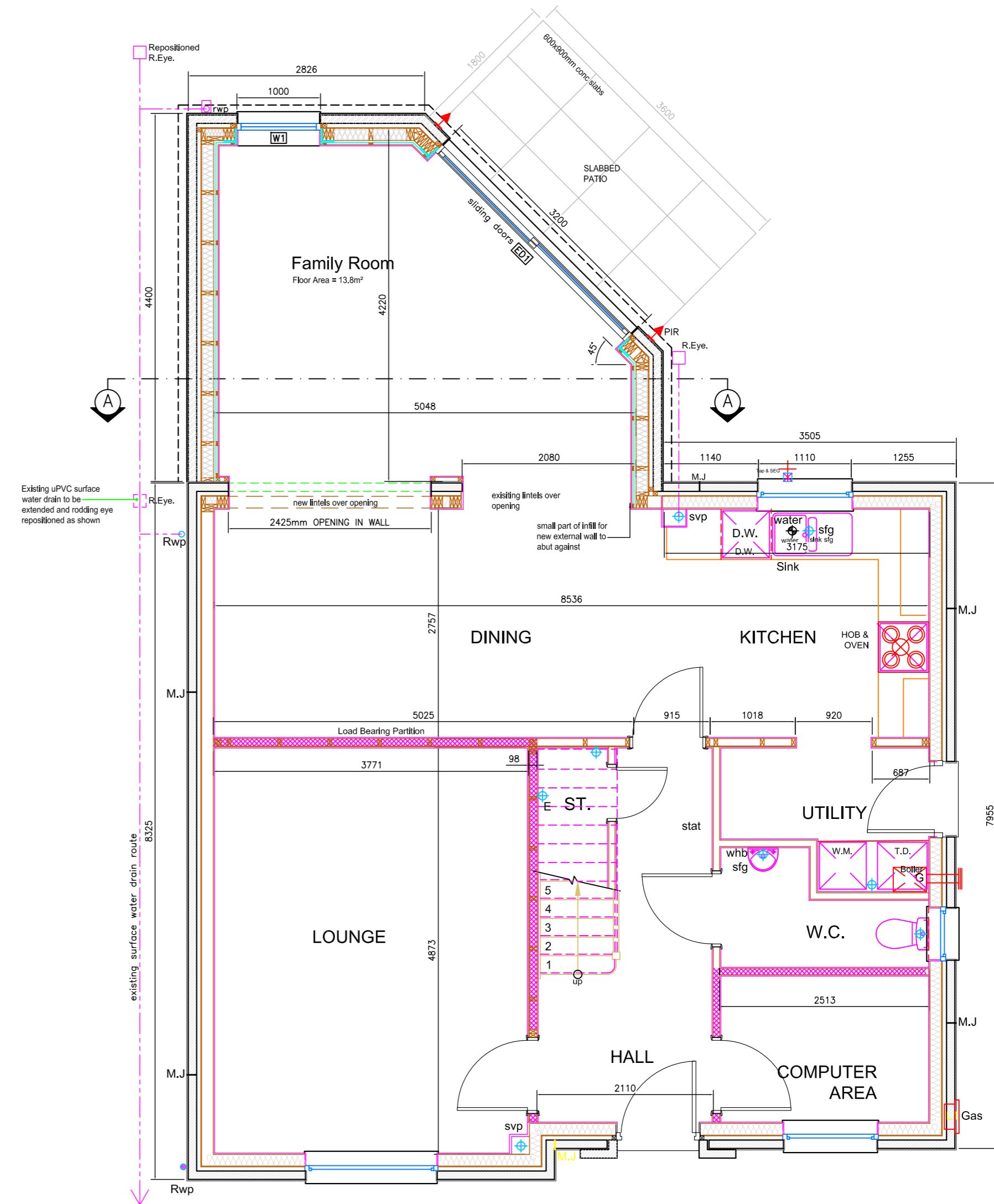

Proposed Ground Floor Plan 1:50

PLANNING APPLICATION DRAWING	
PROJECT	Extension to Dwelling AT 20 Mingary Crescent, Inverness, IV2 6FQ
DRAWING	Existing & Proposed Ground Floor Plans
CLIENT	Mr & Mrs K. Thomson, 20 Mingary Crescent, Inverness, IV2 6FQ
Drg. no.	1367/PL/03
Scale	as shown
Revision	Date March 2024

MIKE MACBETH MOB A/s MICMAC ARCHITECTURAL SERVICES THE OLD POTTERY, MILLBANK ROAD, MUNLOCHY, ROSS-SHIRE IV8 8NL	Tel / Fax 01463 811799 Email - mike.macbeth@icall.co.uk
--	--