

This copy has been made by or with the authority of Midlothian Council pursuant to Section 47 of the Designs and Patents Act 1988. Unless that Act provides a relevant exception to copyright, the copy must not be copied without the prior permission of the copyright owner.

Revision A	MP	01.03.23
by	MP	
	→ Changes as per Client's comments.	
Revision B	MP	08.03.23
by	MP	
	→ Changes as per Client's comments.	
Revision C	MP	24.03.23
by	MP	
	→ Changes as design development.	
Revision D	MP	31.03.23
by	MP	
	→ Overall building width reduced.	
Revision E	MP	19.04.23
by	MP	
	→ Sheet size updated.	
Revision F	SI	06.03.24
by	SI	
	→ Balcony size increased.	

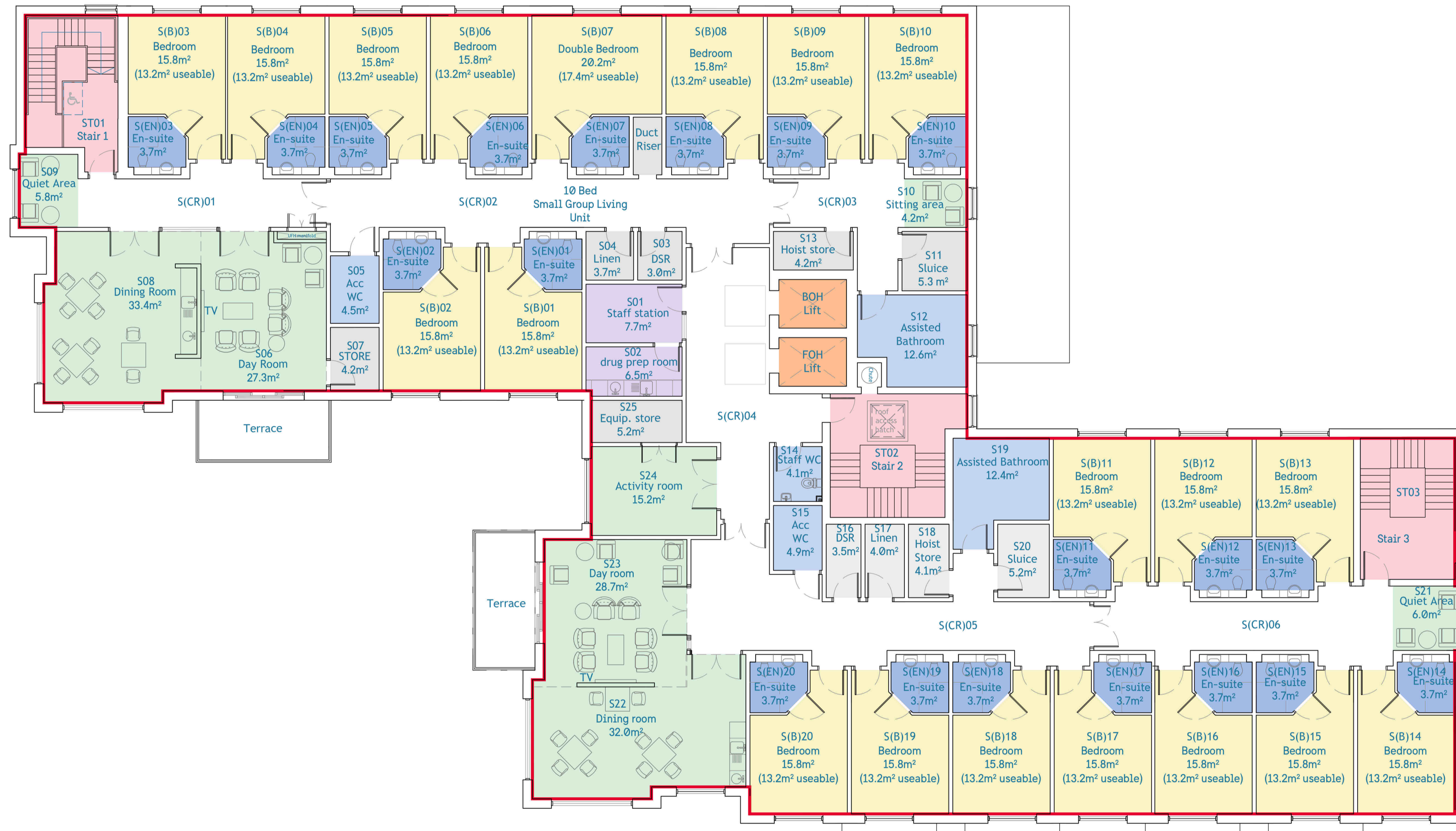

DRAWING LEGEND

GIA area on Plan —

Ground Floor GIA: 1004m²
 First Floor GIA: 966m²
 Second Floor GIA: 960m²

Total GIA: 2930m²
 GIA per Resident: 58.60m²

planform

PROPOSED 50 BED CARE HOME
 HAWTHORN GARDENS
 LOANHEAD

PROPOSED SECOND FLOOR PLAN

DWG NO. 173-302 REV. F

SCALE 1:100 SIZE A1

DWN BY MP CHECK BY SD

© PLANFORM ARCHITECTS LTD
 CENTRUM BUILDING, 38 QUEEN STREET, GLASGOW, G1 3JX

Planform Architects accepts responsibility for this document only to the commissioning party and not to any other. Planform Architects do not accept liability for the accuracy or veracity of the survey information provided by others and used in the preparation of this drawing.

