

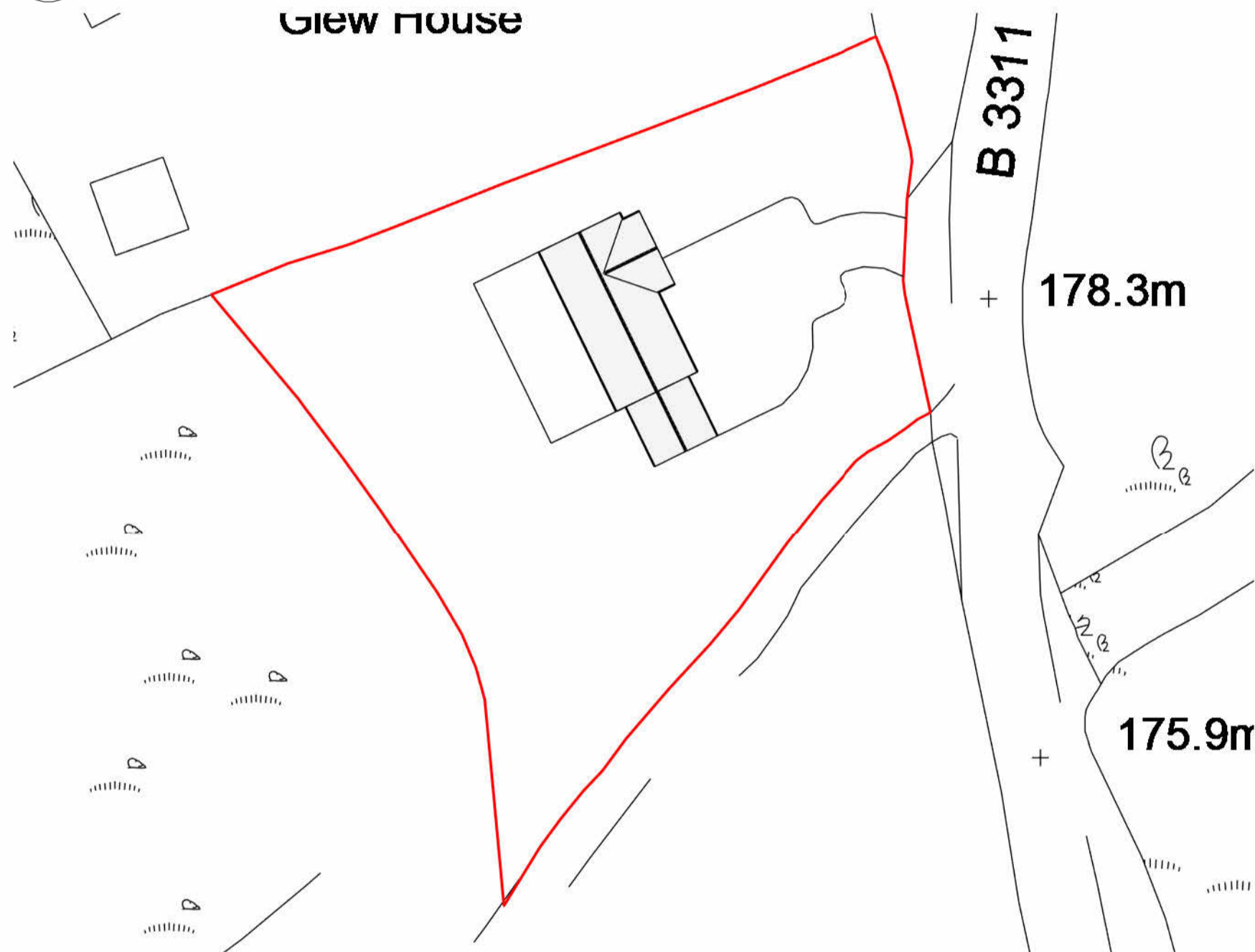

1 Existing Location Plan
1 : 1250



4 Proposed Block Plan
1 : 500



5 Proposed Location Plan
1 : 1250

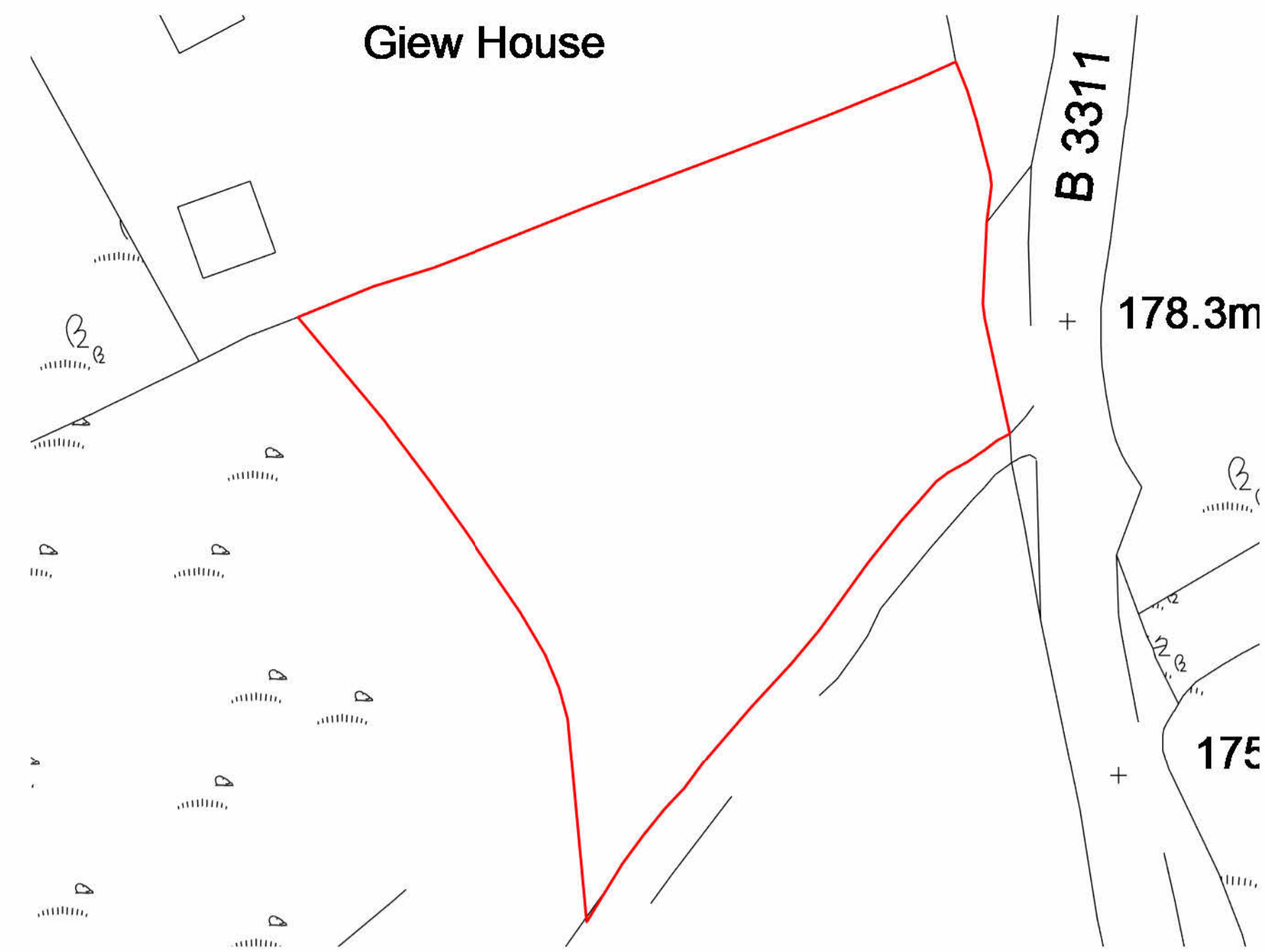

2 Existing Block Plan
1 : 500



3 Proposed Site Plan
1 : 200

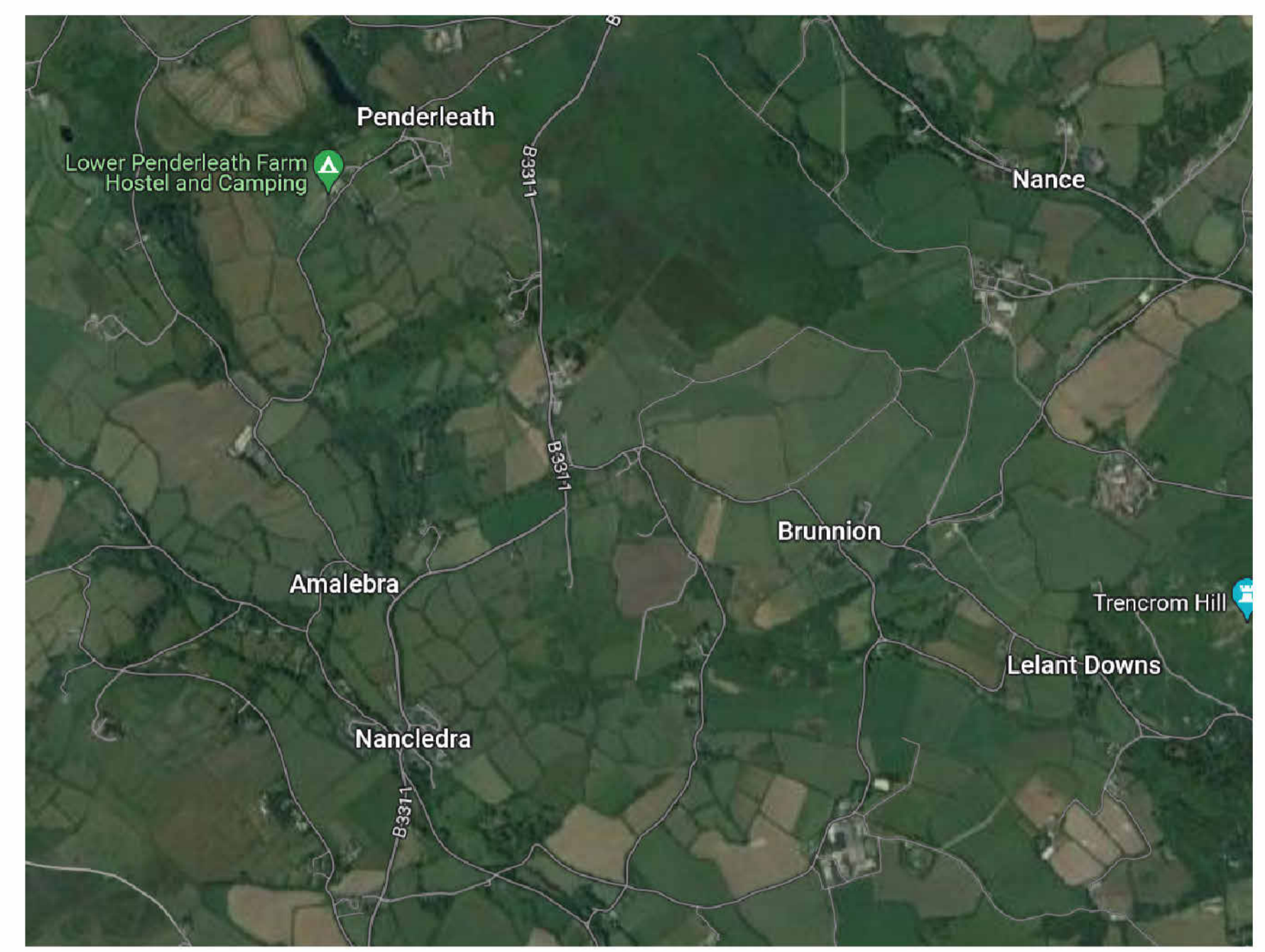

6 Google Earth Image
1 : 1



1. This drawing is the copyright of Cornwall Planning Group and may not be reproduced without licence.
 2. The Contractor shall not scale off this drawing for construction purposes, only figured dimensions shall be worked from.
 3. All dimensions and levels are to be checked on site by the Contractor before the commencement of any work and any discrepancies reported to the Architect.
 4. No responsibility can be accepted for errors arising on site due to unauthorised variations from the Architects drawings.
 5. The Contractor is recommended to visit the site before tendering to ascertain all local conditions and restrictions likely to affect the works.
 6. Tenders must include for all the works described or being apparent on the drawings or can reasonably be inferred as being necessary for the proper execution of the works.
 7. This drawing is for town planning and building regulations only and is not a complete working drawing.
 8. Depth, size and design of foundations shown are preliminary only, actual foundation, depth, size and design may differ depending on site conditions.
 9. On completion of the works, if a National Home Energy Rating Certificate is required by the Client, contact the Local Authority Building Control Department.
 10. L1 and L2 requirements for limiting thermal bridging & air leakage workmanship shall be executed by the Contractor in accordance with the appropriate sections and DEPR/D1LR guidance document "Limiting Thermal Bridging & Air Leakage - Robust Construction Details for Dwellings and Similar Buildings" available from The Stationery Office Ltd.

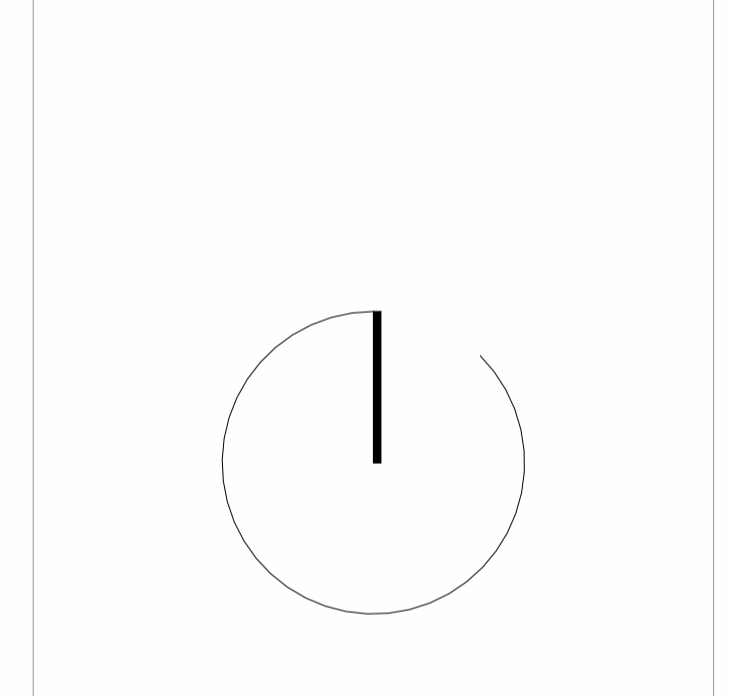
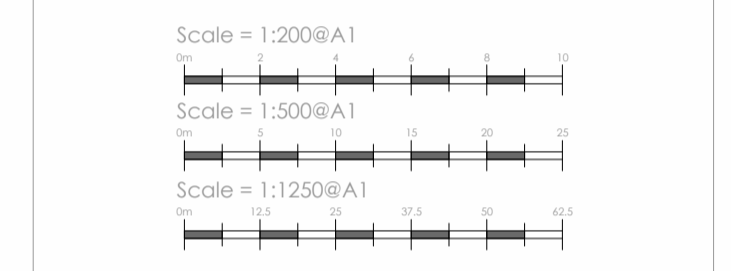

Cornwall Planning Group
 Head Office: Chi Gallos,
 Hayle Marine Renewables Business Park,
 North Quay, Hayle,
 Cornwall, TR27 4DD
 Phone: +44 (0)1736 448 500
 Email: office@cornwallplanninggroup.co.uk
 Web: www.cornwallplanninggroup.co.uk

Client: Mrs Zoe Perkin

Project: Construction of Single Storey Affordable Self Build Dwelling

Address: Land South of Glew House, Glew Hill, Cripplease, Nancledra, Penzance, Cornwall, TR20 8NF

Title: Location Plans

Revisions			
Rev.	Issue Date	Description	Issued by

Stage: Project Status
 Scale: As indicated
 Date: 04/01/2024
 Drawn: TG Checked: CM
 Project No: 2560 Drawing No: 001
 Rev: