



APPENDIX 5.6.5

OVERSHADOWING RESULTS

Royal Arsenal Riverside

29 February 2024

GIA No: **19164**

PROJECT DATA:

Client **Berkeley**
Architect **PRP Architects**
Project Title **Royal Arsenal Riverside**
Project Number **19164**

REPORT DATA:

Report Title **Transient Overshadowing Assessment**
GIA Department **Daylight & Sunlight**
Dated **29 February 2024**

Prepared by **KB**
Checked by **GL**
Type **EIA appendix**

Revisions	No:	Date:	Notes:	Signed:

DISCLAIMER:

N.B This report has been prepared for Berkeley by GIA as their appointed Daylight & Sunlight consultants. This report is intended solely for Berkeley and may contain confidential information. No part or whole of its contents may be disclosed to or relied upon by any Third Parties without the express written consent of GIA. It is accurate as at the time of publication and based upon the information we have been provided with as set out in the report. It does not take into account changes that have taken place since the report was written nor does it take into account private information on internal layouts and room uses of adjoining properties unless this information is publicly available.

SOURCES OF INFORMATION:

Information Received **IR-11-13-19164**
Release Number **Rel_04_19164_DSD**
Issue Number **03**
Site Photos **GIA**
3D models **VU.CITY**
OS Data **FIND Maps**



CONTENTS

1	TRANSIENT OVERSHADOWING ASSESSMENT	2
1.1	21 st March	2
1.1	21 st June	8
1.1	21 st December	16
2	OVERSHADOWING ASSESSMENTS	20

TRANSIENT OVERSHADOWING ASSESSMENT
21ST MARCH (08:00 - 11:00 GMT)

EXISTING

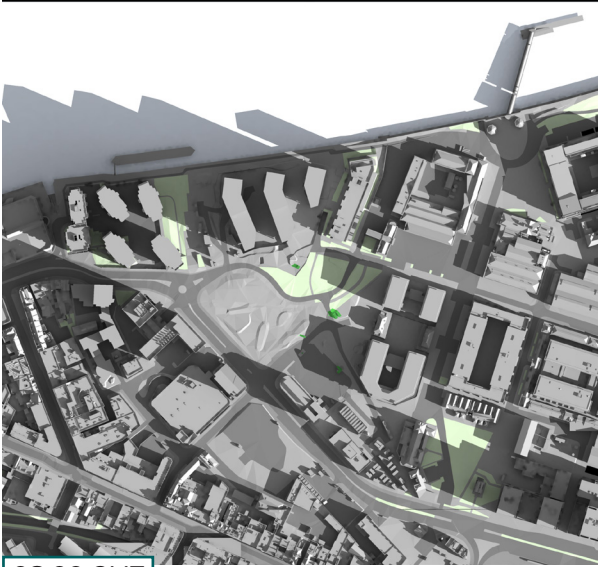

08:00 GMT

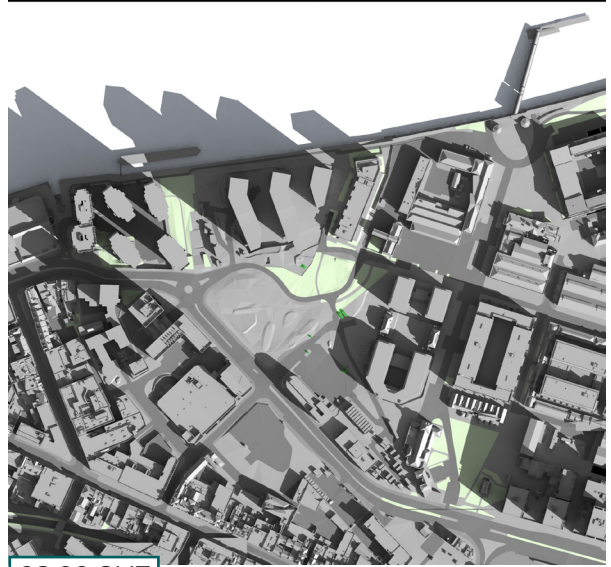

09:00 GMT

PROPOSED

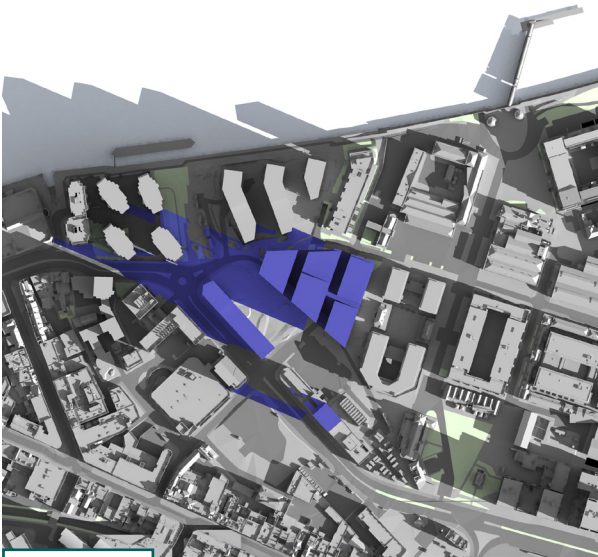

08:00 GMT

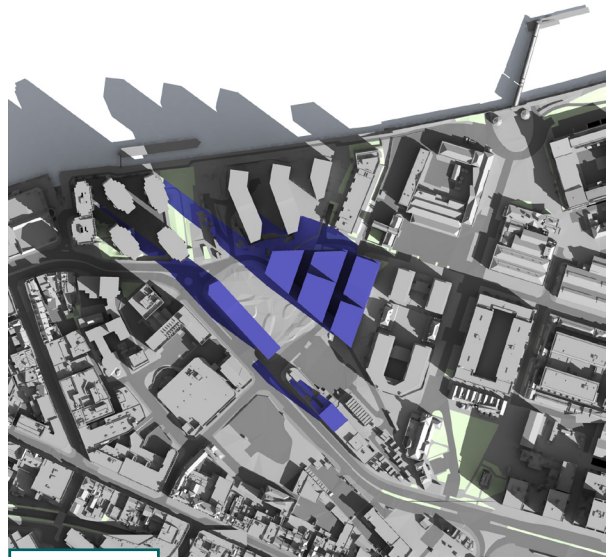

09:00 GMT

CONSENTED

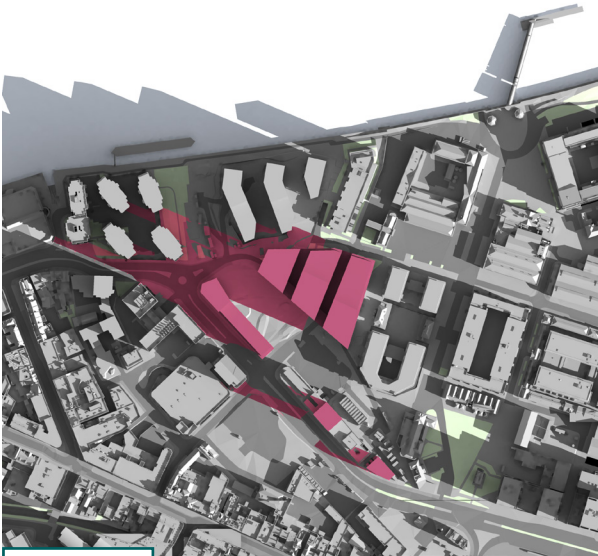

08:00 GMT

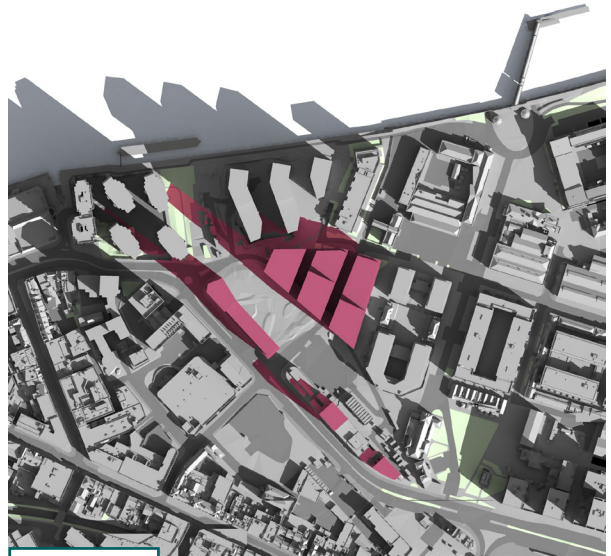

09:00 GMT

EXISTING

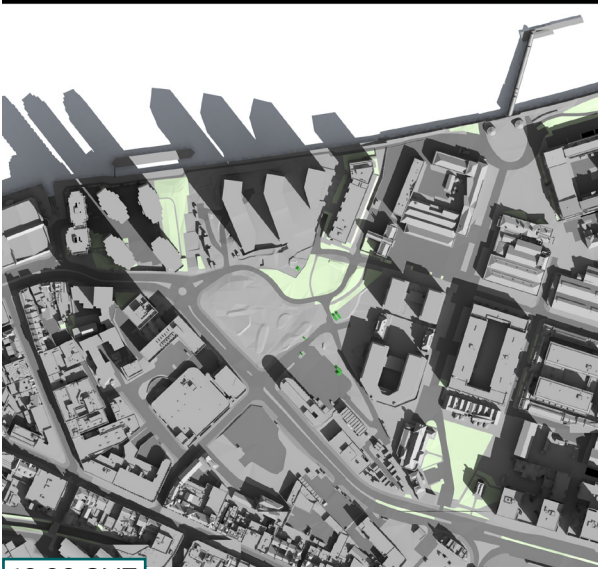

10:00 GMT

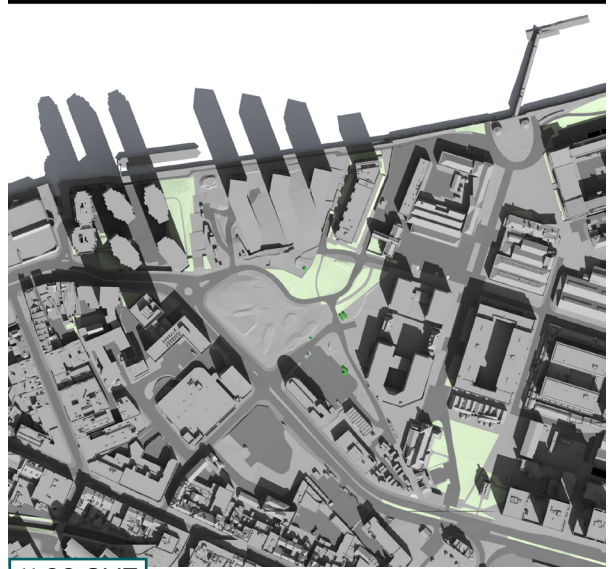

11:00 GMT

PROPOSED

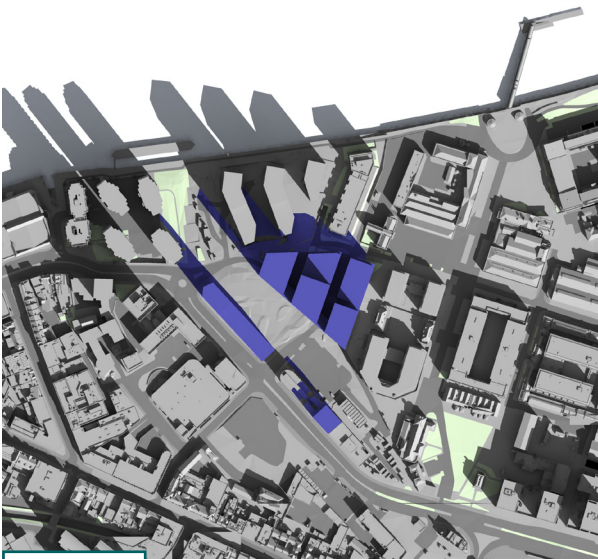

10:00 GMT

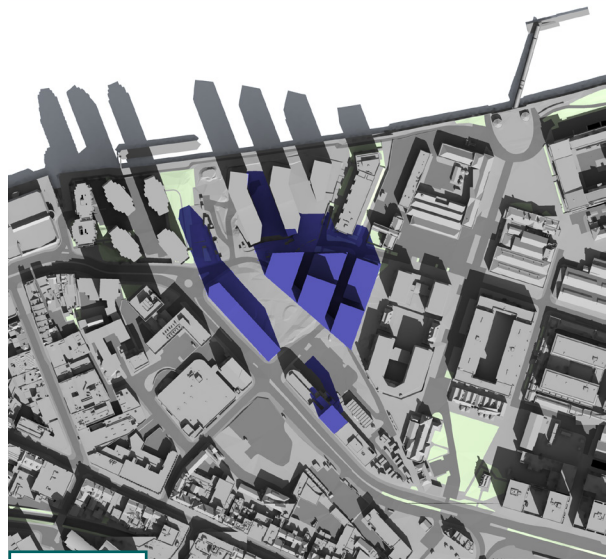

11:00 GMT

CONSENTED

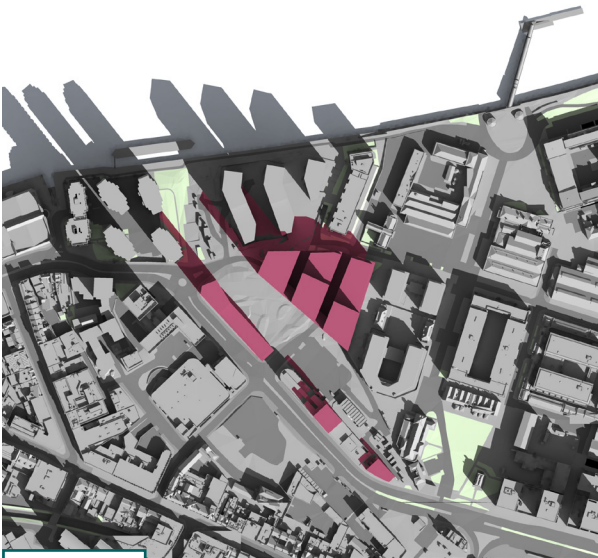

10:00 GMT

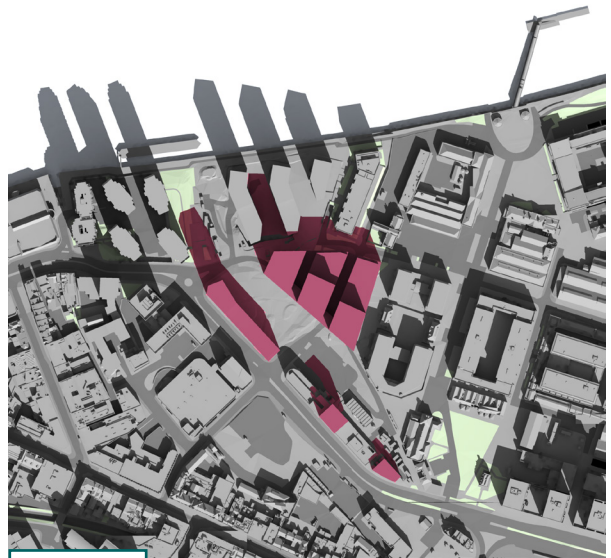

11:00 GMT

TRANSIENT OVERSHADOWING ASSESSMENT
21ST MARCH (12:00 - 15:00 GMT)

EXISTING

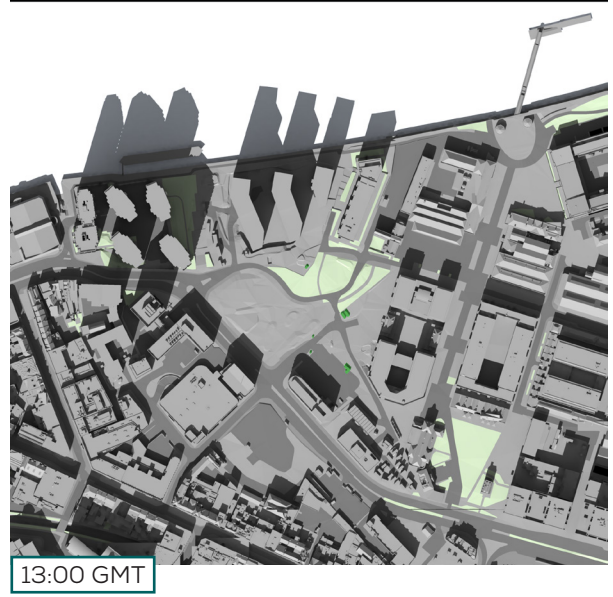
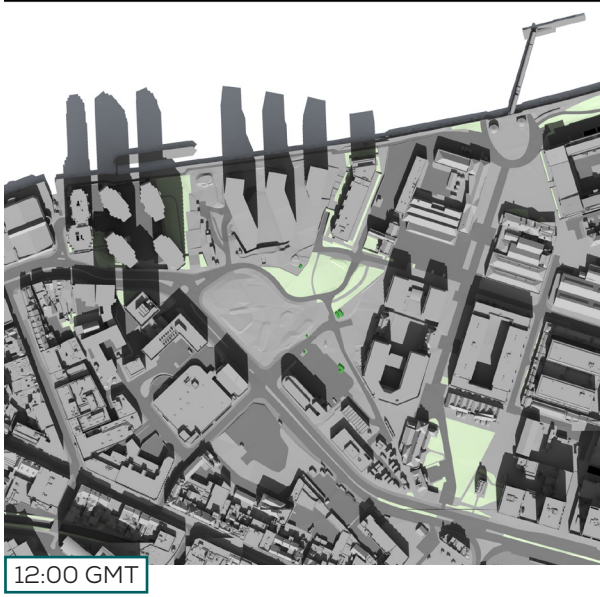

PROPOSED

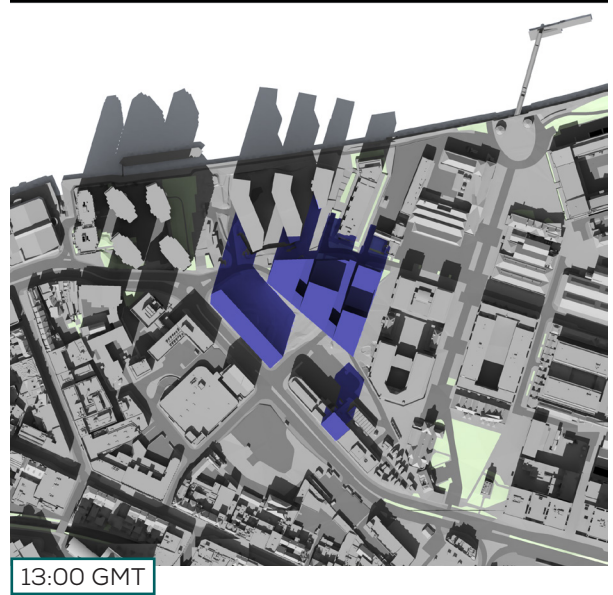
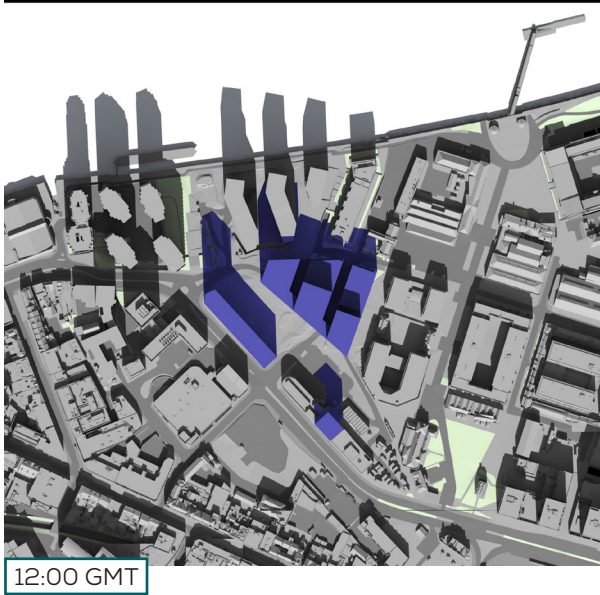

CONSENTED

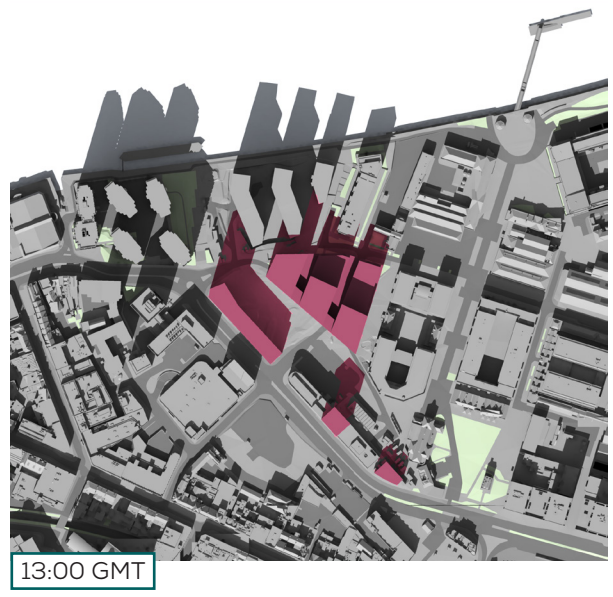
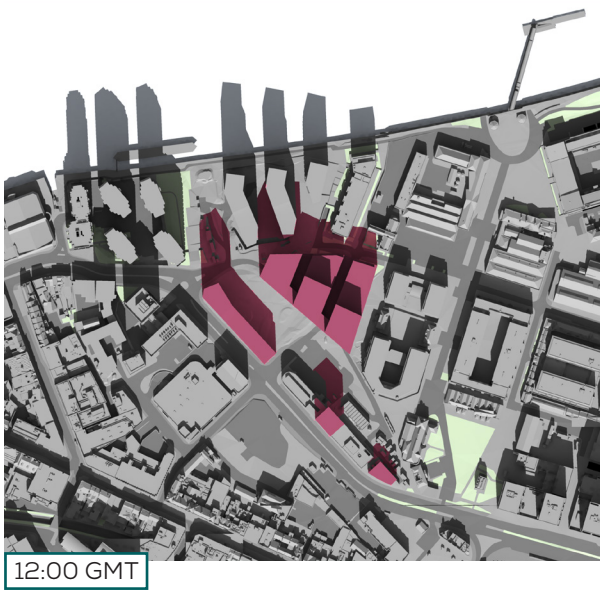

EXISTING

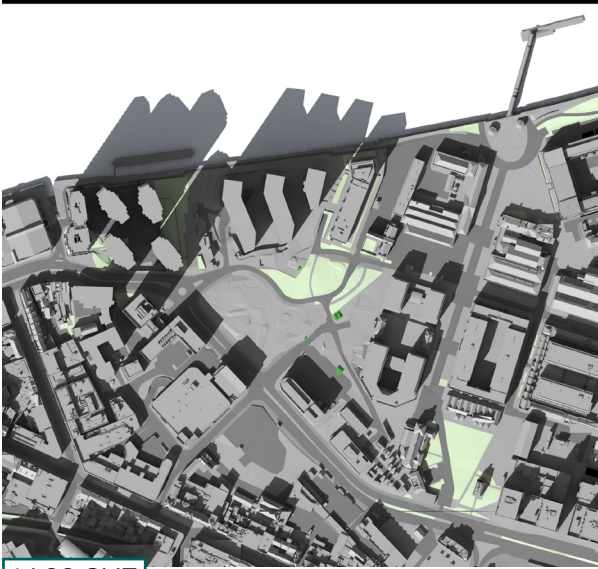

14:00 GMT

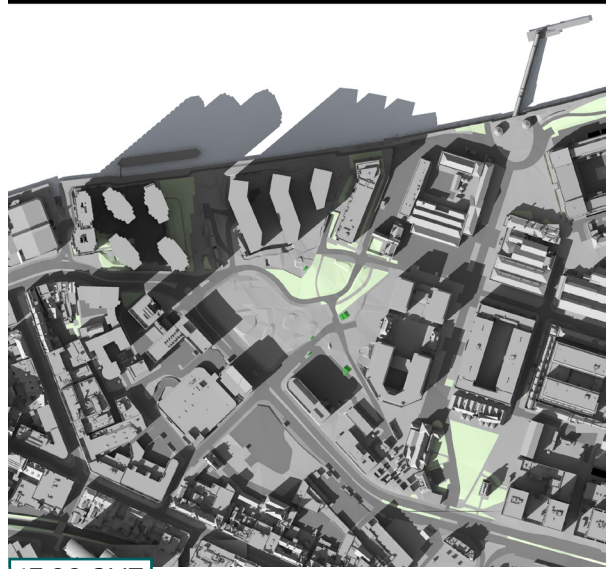

15:00 GMT

PROPOSED

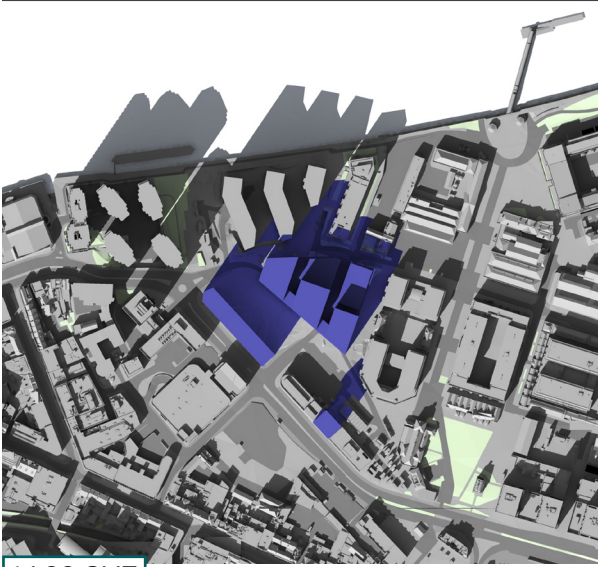

14:00 GMT

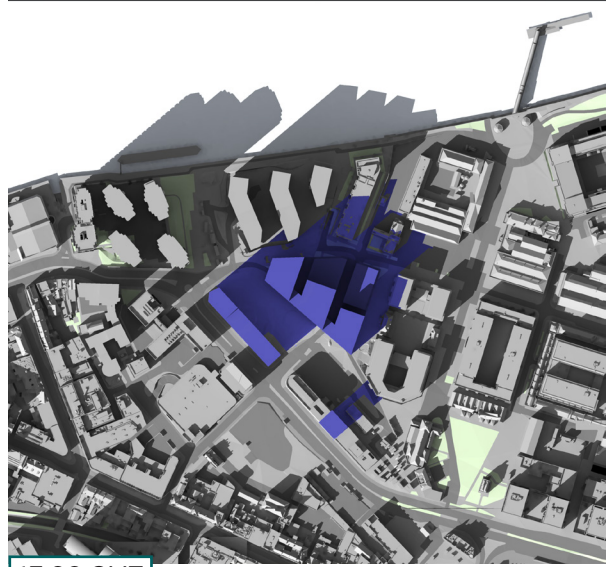

15:00 GMT

CONSENTED

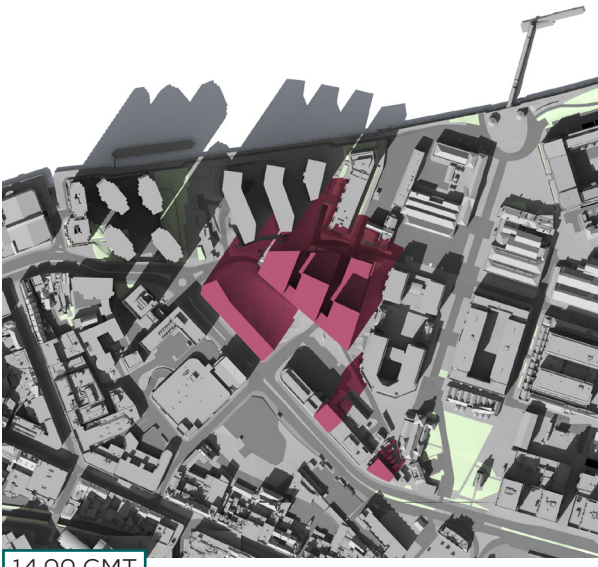

14:00 GMT

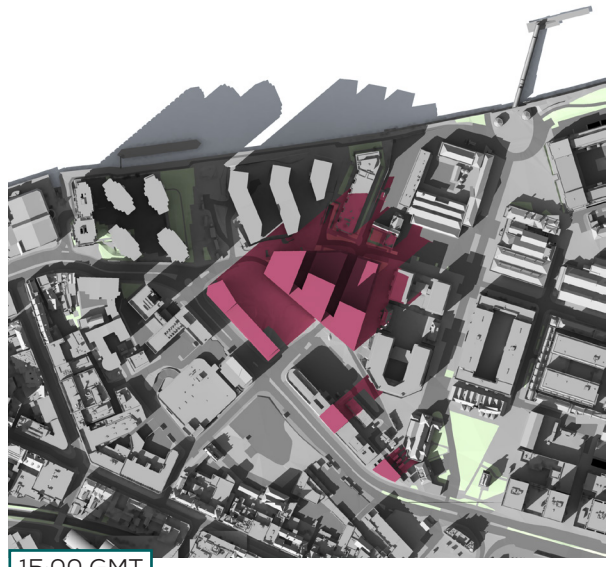

15:00 GMT

TRANSIENT OVERSHADOWING ASSESSMENT
21ST MARCH (16:00 - 17:00 GMT)

EXISTING

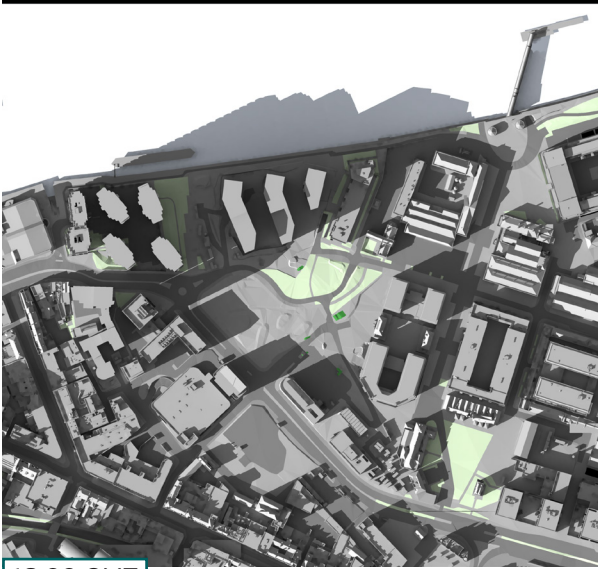

16:00 GMT

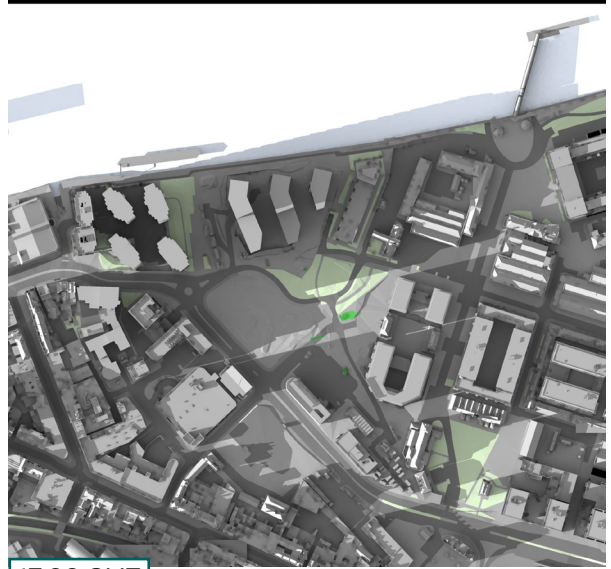

17:00 GMT

PROPOSED

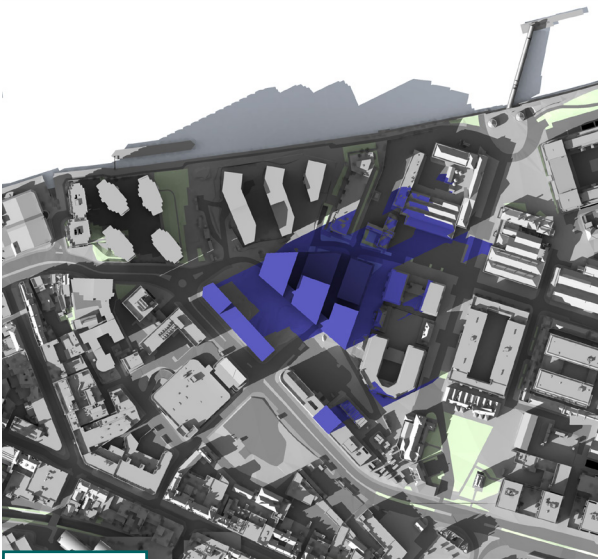

16:00 GMT

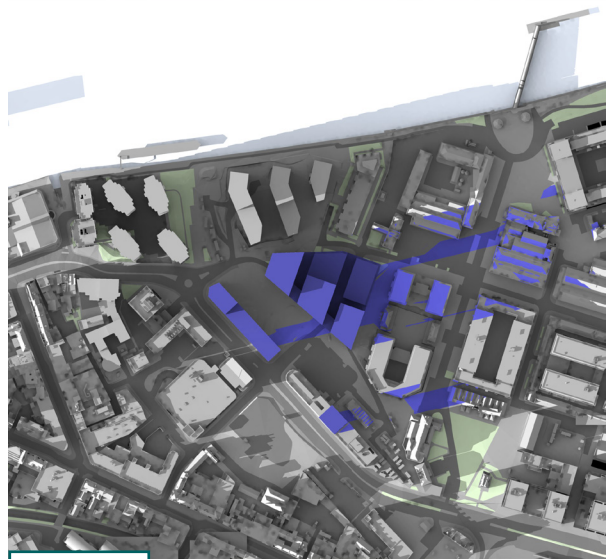

17:00 GMT

CONSENTED

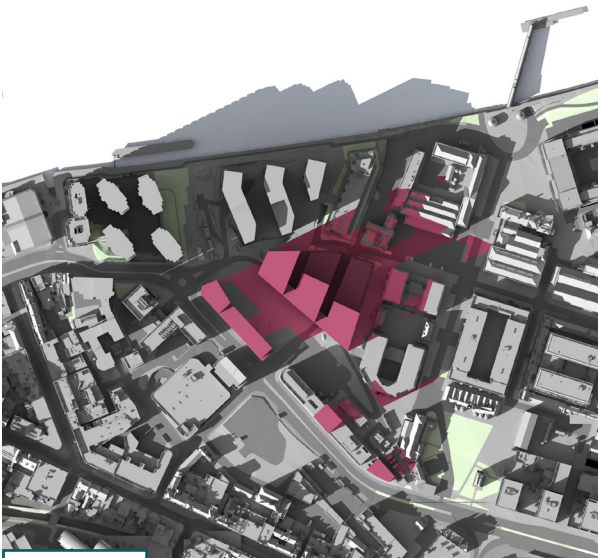

16:00 GMT

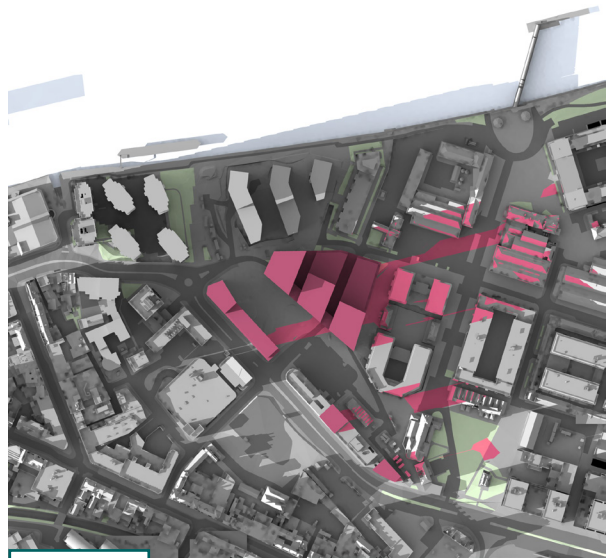

17:00 GMT

PAGE INTENTIONALLY LEFT BLANK

TRANSIENT OVERSHADOWING ASSESSMENT
21ST JUNE (06:00 - 09:00 BST)

EXISTING

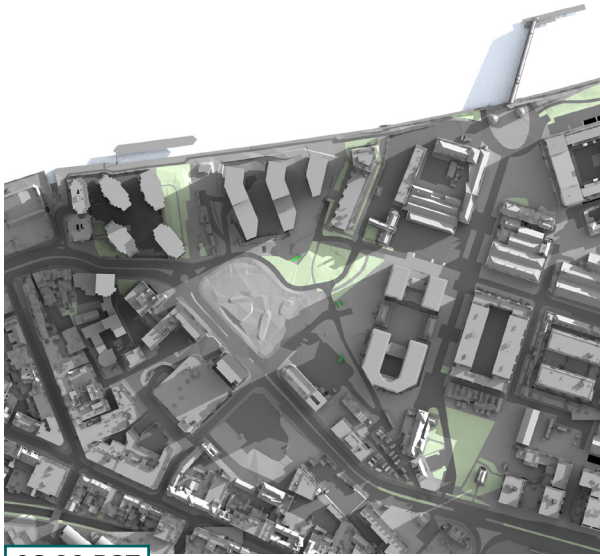

06:00 BST

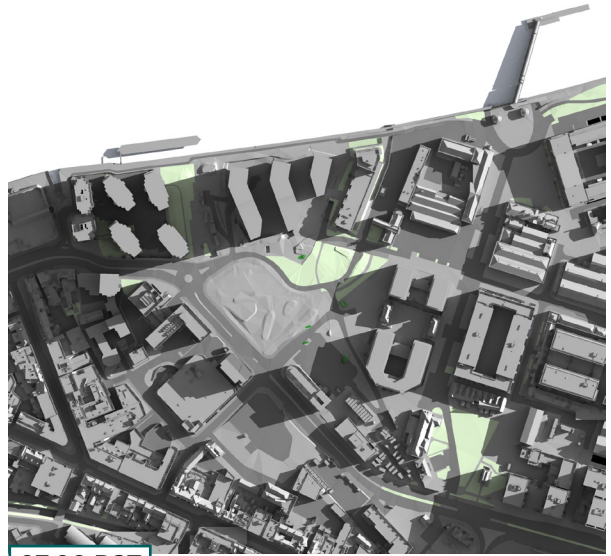

07:00 BST

PROPOSED

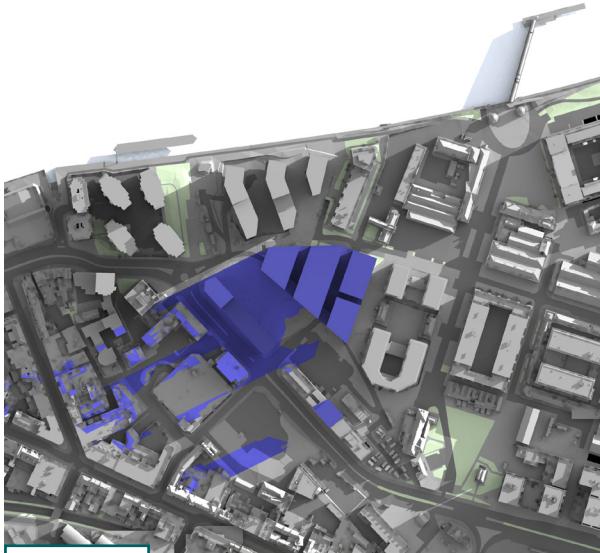

06:00 BST

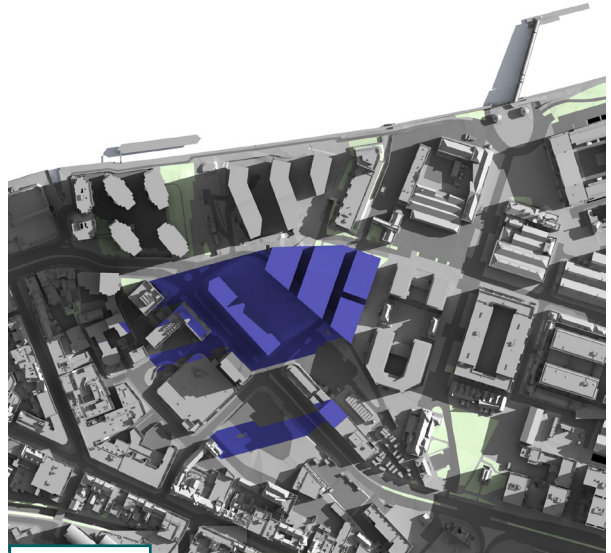

07:00 BST

CONSENTED

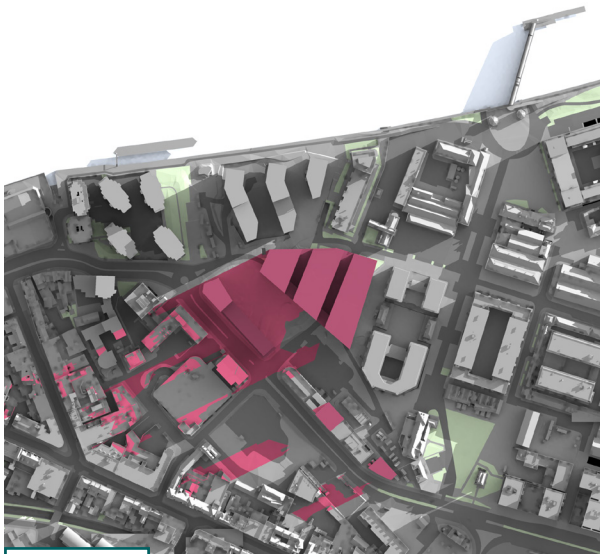

06:00 BST

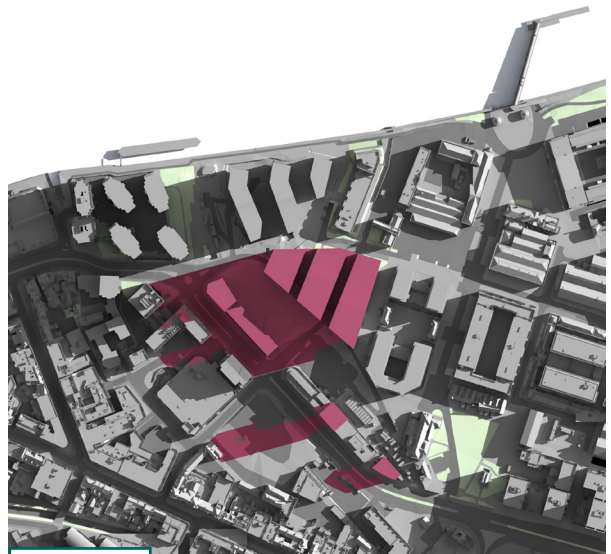

07:00 BST

EXISTING

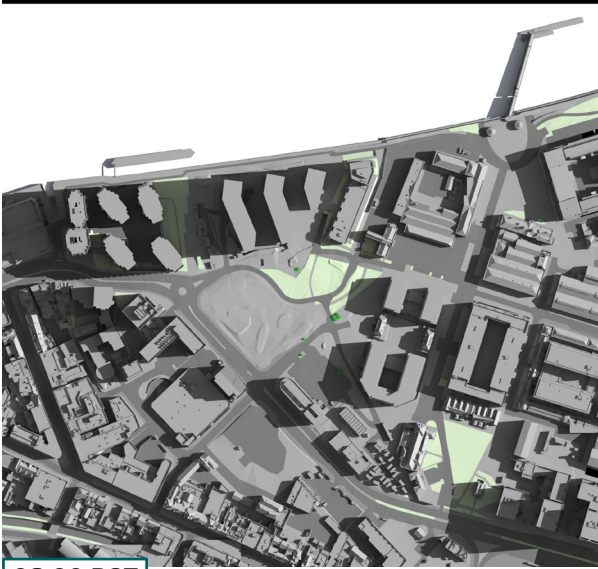

08:00 BST

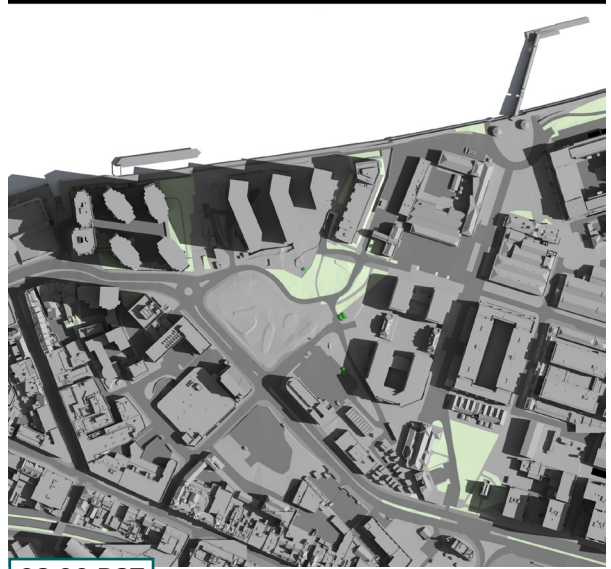

09:00 BST

PROPOSED

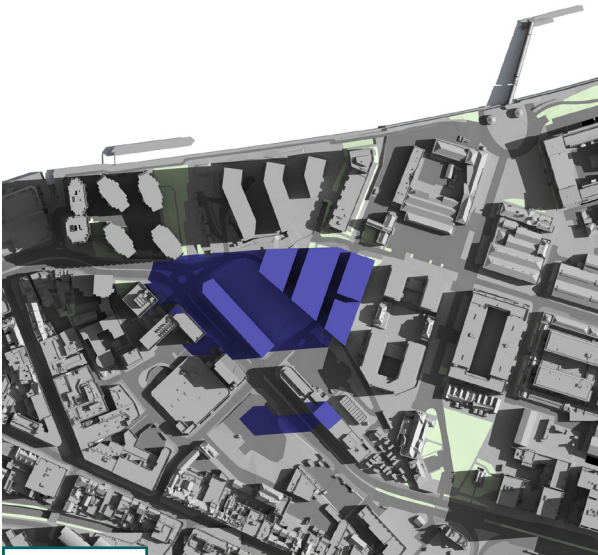

08:00 BST

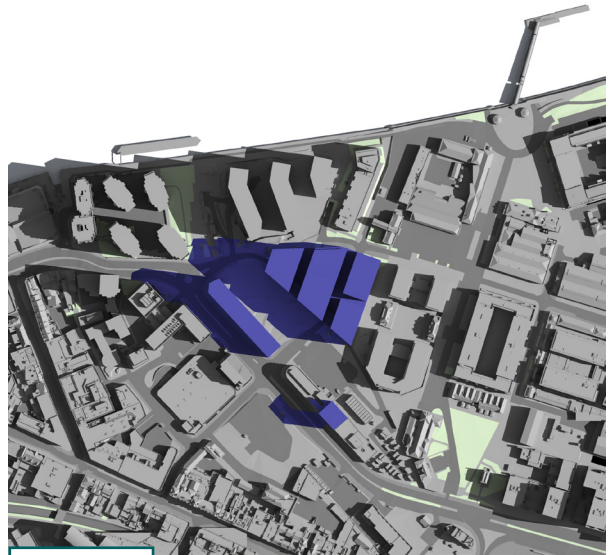

09:00 BST

CONSENTED

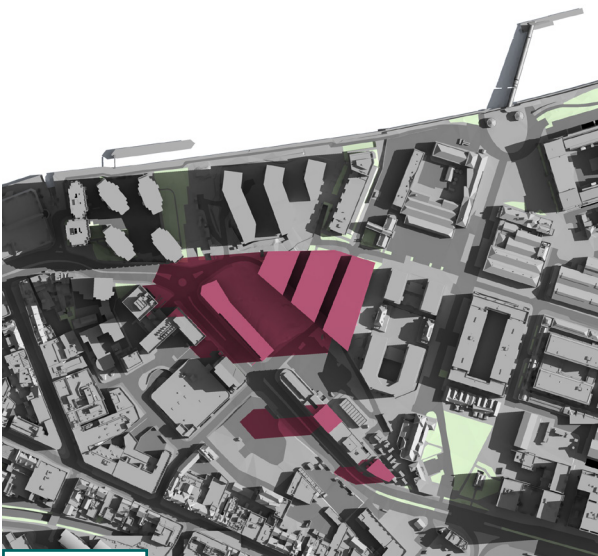

08:00 BST

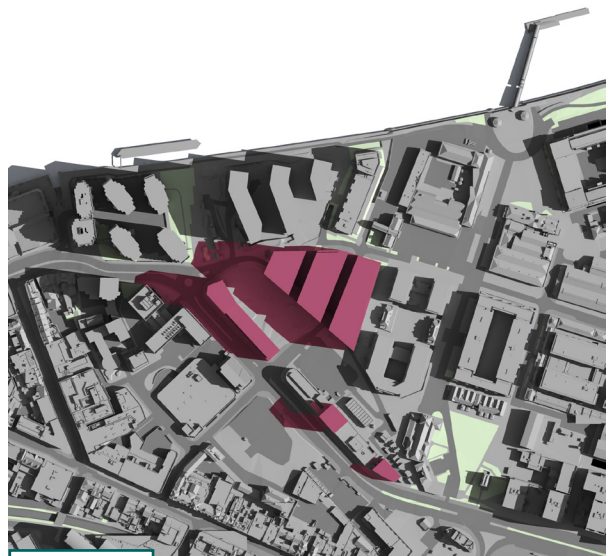

09:00 BST

TRANSIENT OVERSHADOWING ASSESSMENT
21ST JUNE (10:00 - 13:00 BST)

EXISTING

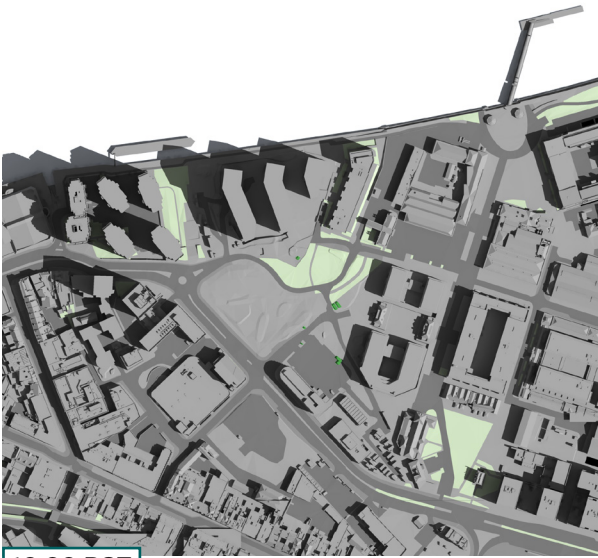

10:00 BST

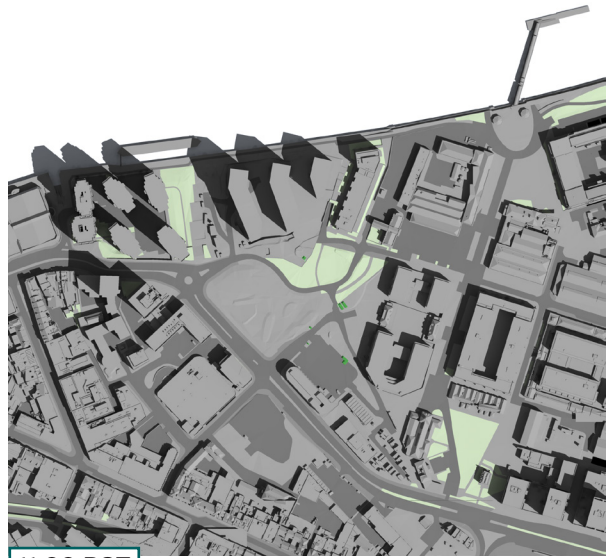

11:00 BST

PROPOSED

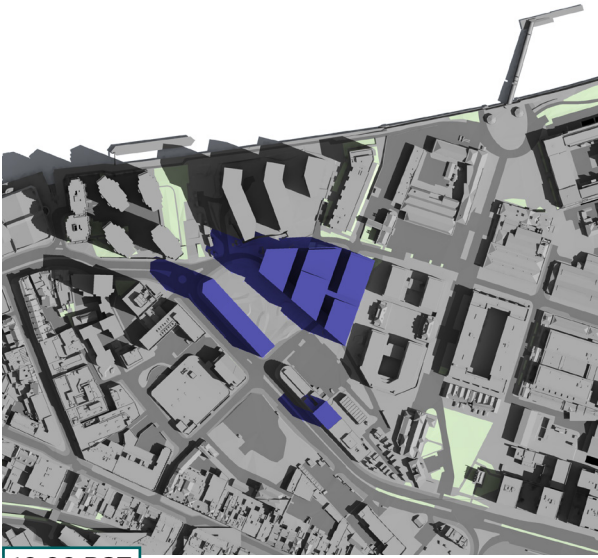

10:00 BST

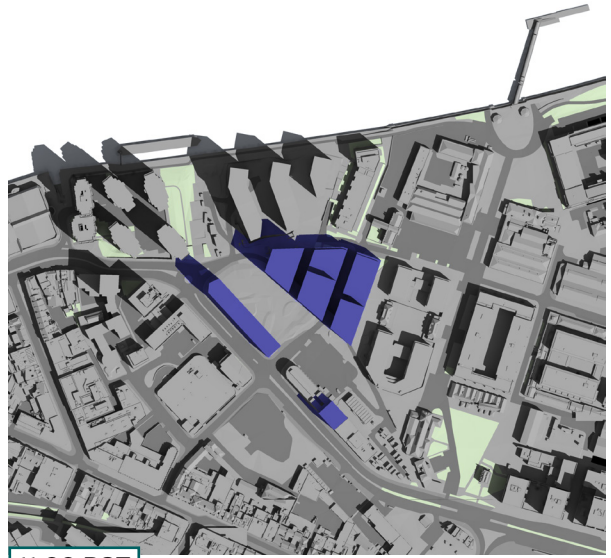

11:00 BST

CONSENTED

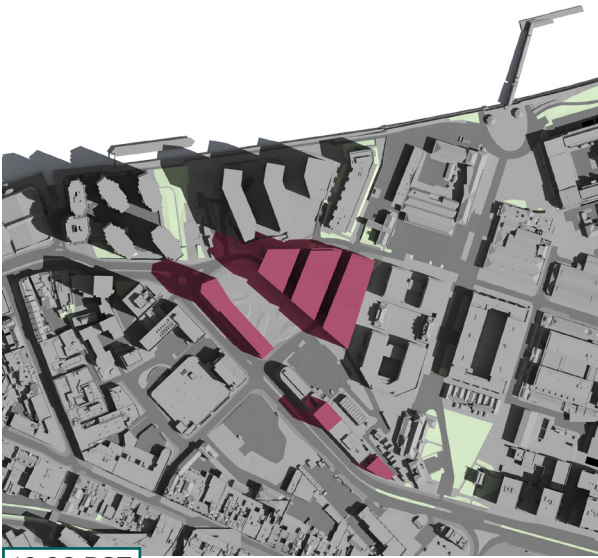

10:00 BST

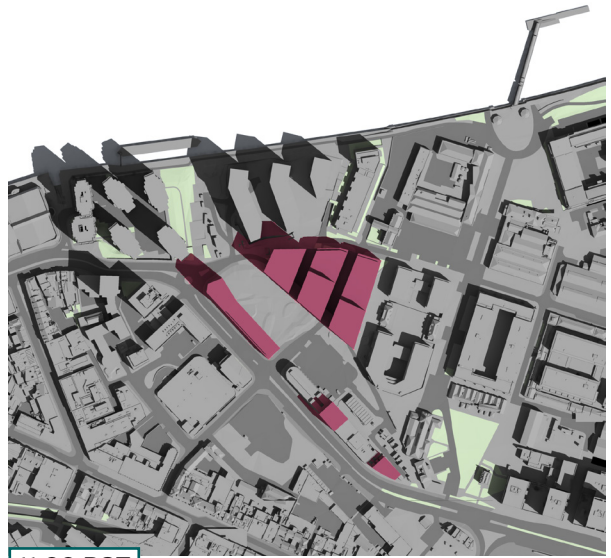

11:00 BST

EXISTING

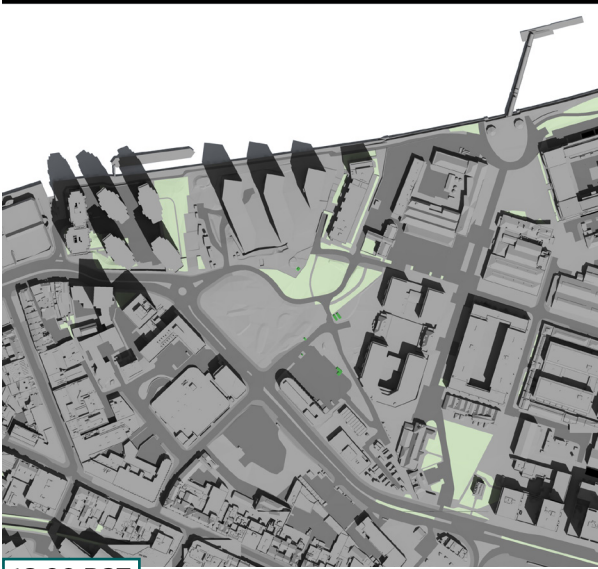

12:00 BST

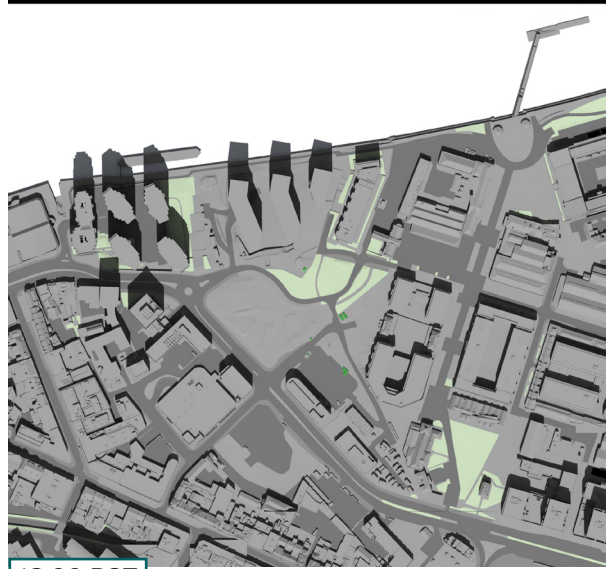

13:00 BST

PROPOSED

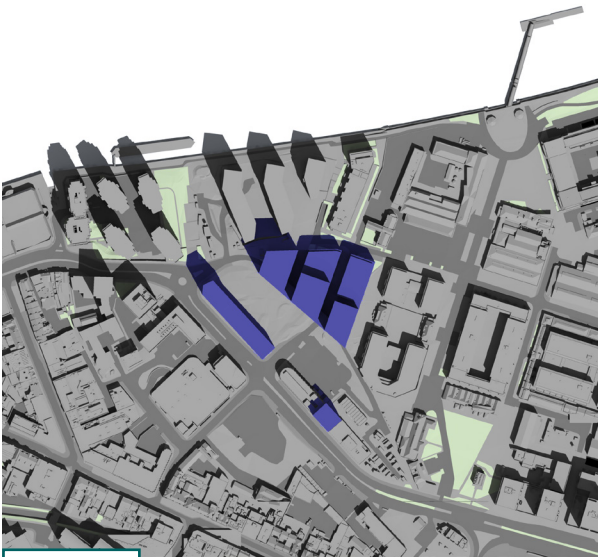

12:00 BST

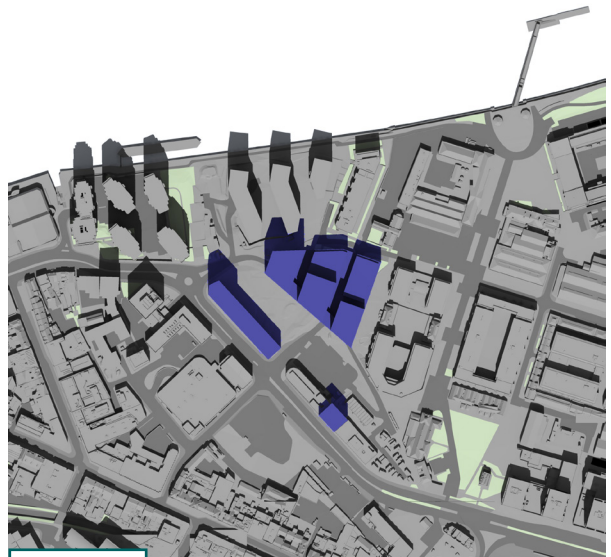

13:00 BST

CONSENTED

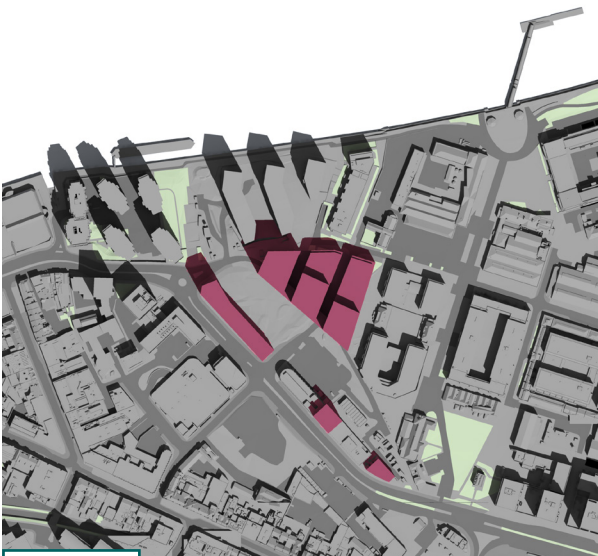

12:00 BST

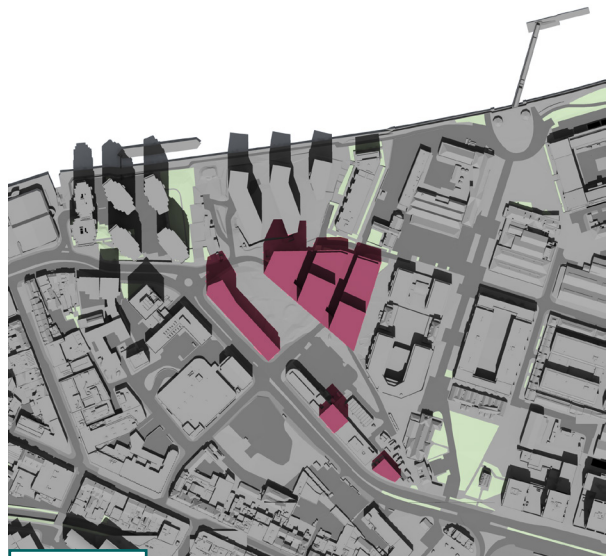

13:00 BST

TRANSIENT OVERSHADOWING ASSESSMENT
21ST JUNE (14:00 - 17:00 BST)

EXISTING

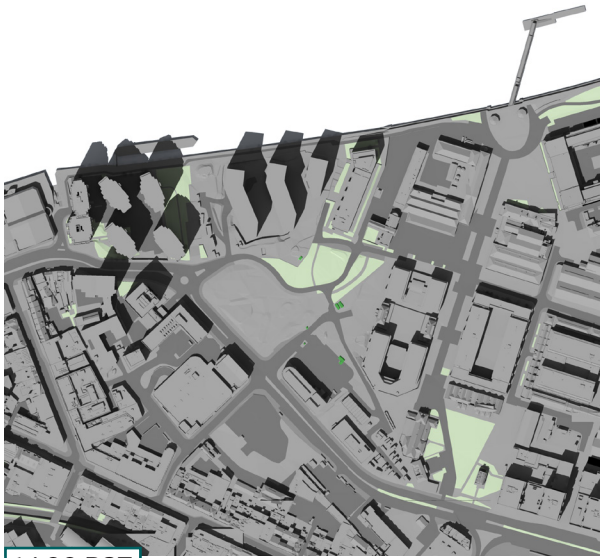

14:00 BST

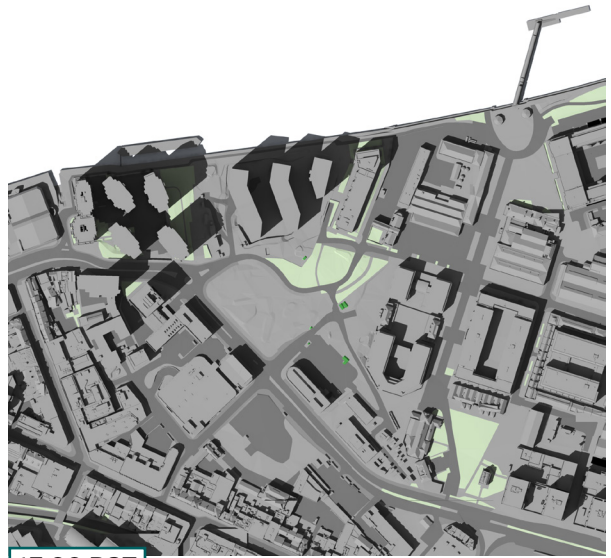

15:00 BST

PROPOSED

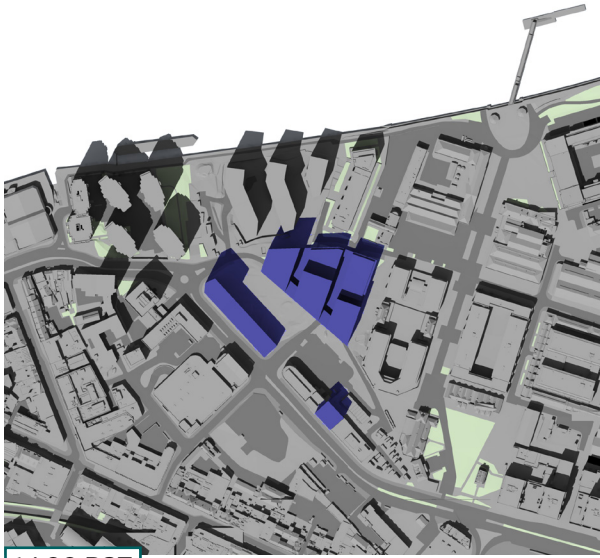

14:00 BST

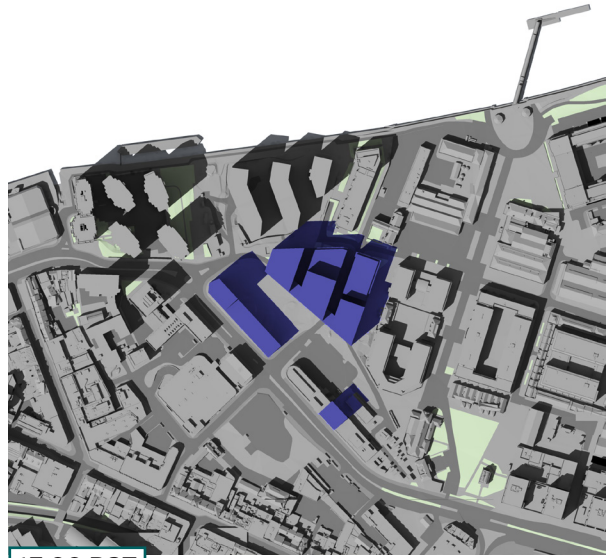

15:00 BST

CONSENTED

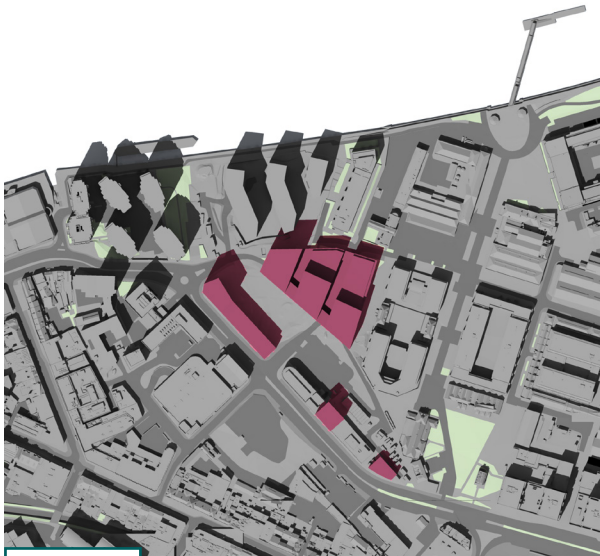

14:00 BST

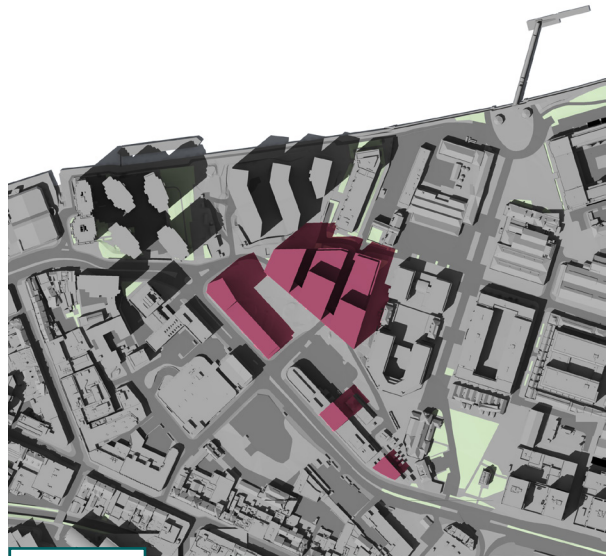

15:00 BST

EXISTING

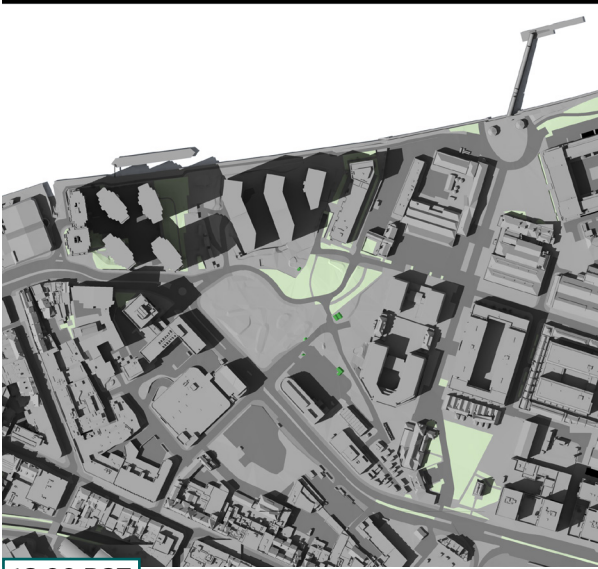

16:00 BST

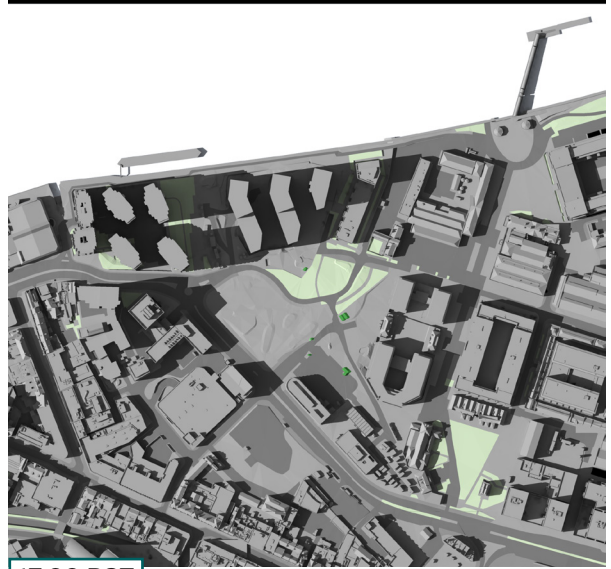

17:00 BST

PROPOSED

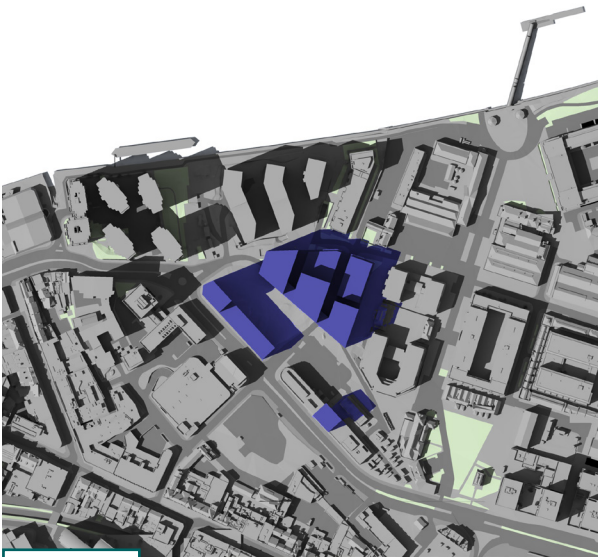

16:00 BST

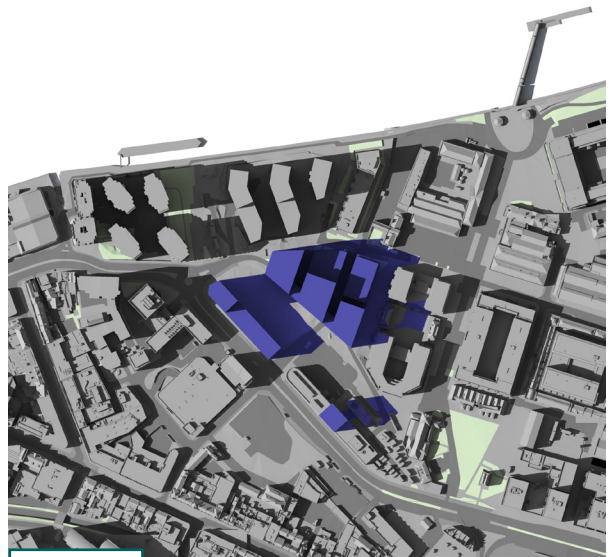

17:00 BST

CONSENTED

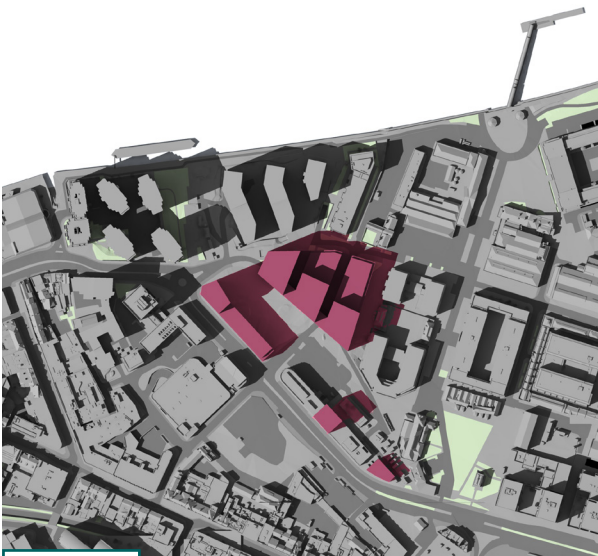

16:00 BST

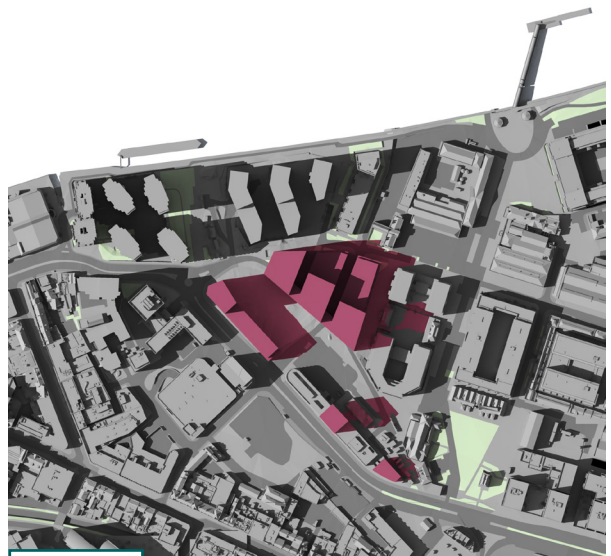

17:00 BST

TRANSIENT OVERSHADOWING ASSESSMENT
21ST JUNE (18:00 - 20:00 BST)

EXISTING

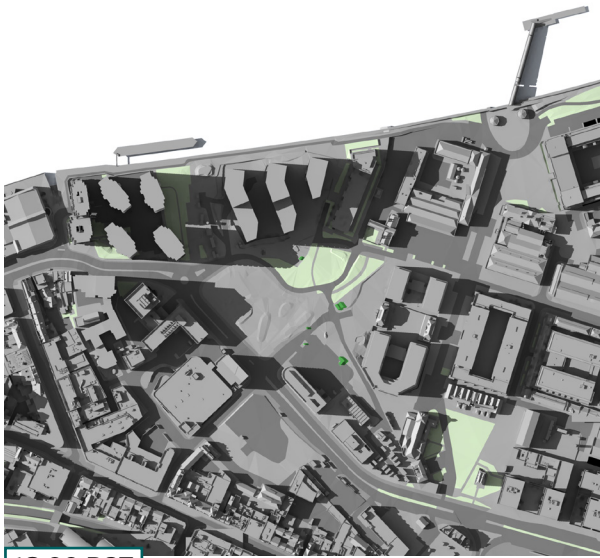

18:00 BST

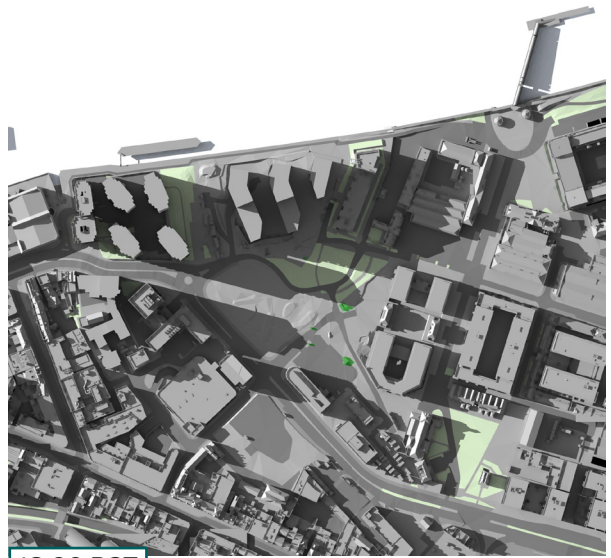

19:00 BST

PROPOSED

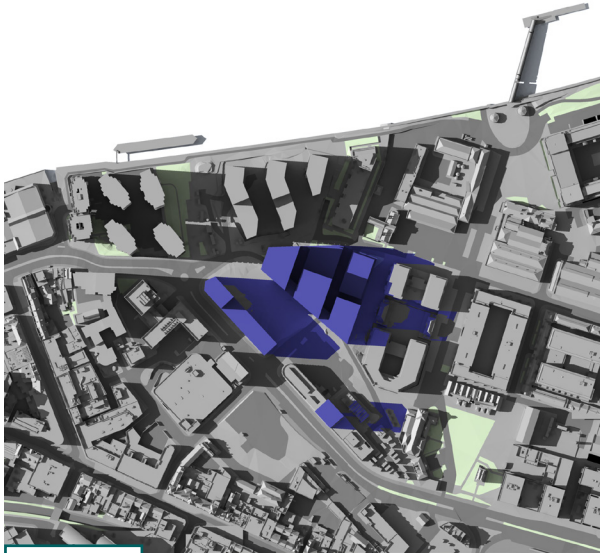

18:00 BST

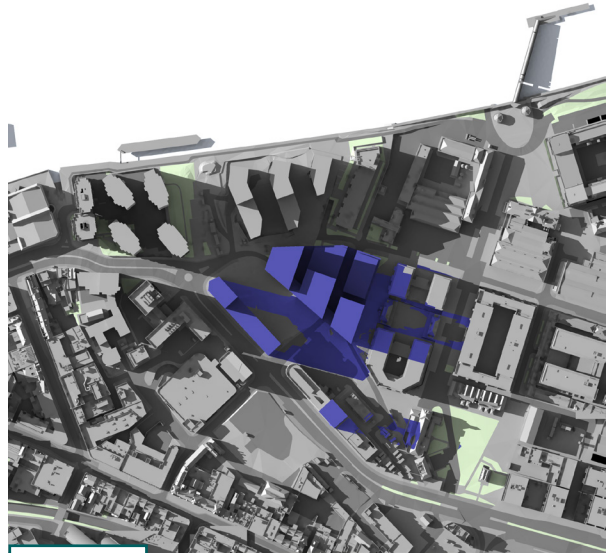

19:00 BST

CONSENTED

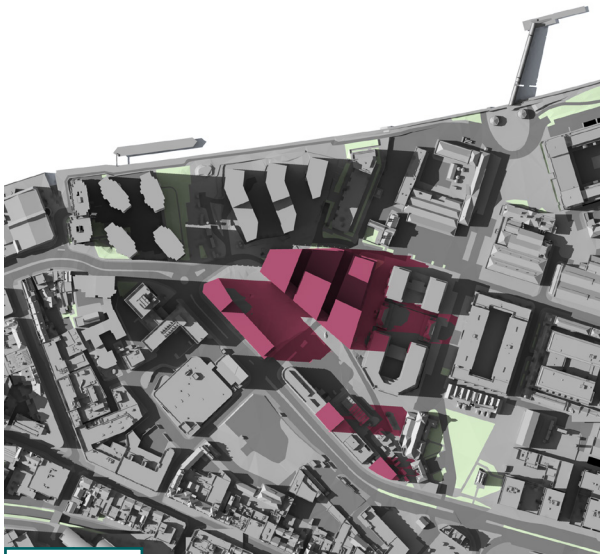

18:00 BST

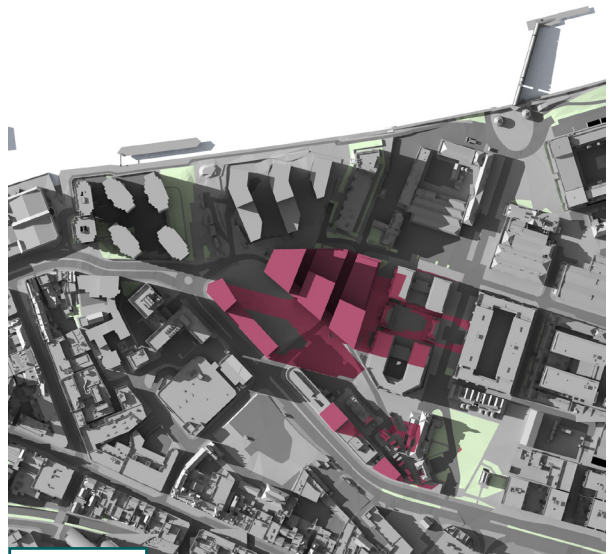

19:00 BST

EXISTING

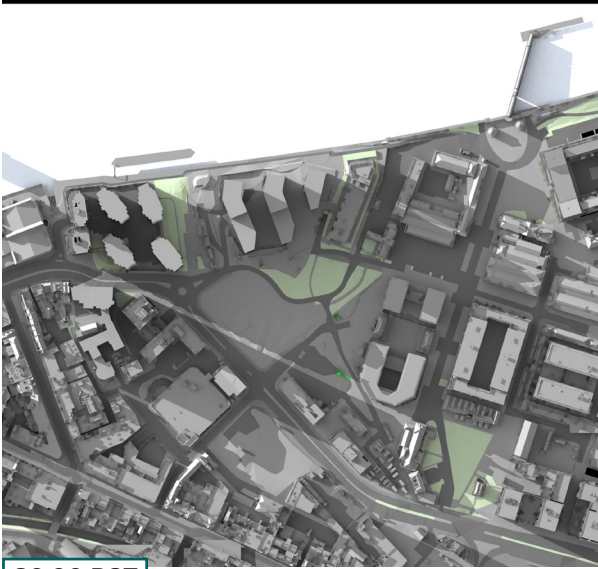

20:00 BST

PROPOSED

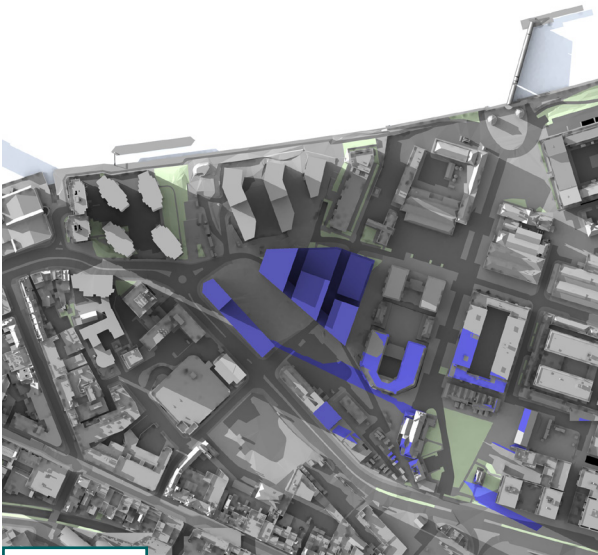

20:00 BST

CONSENTED

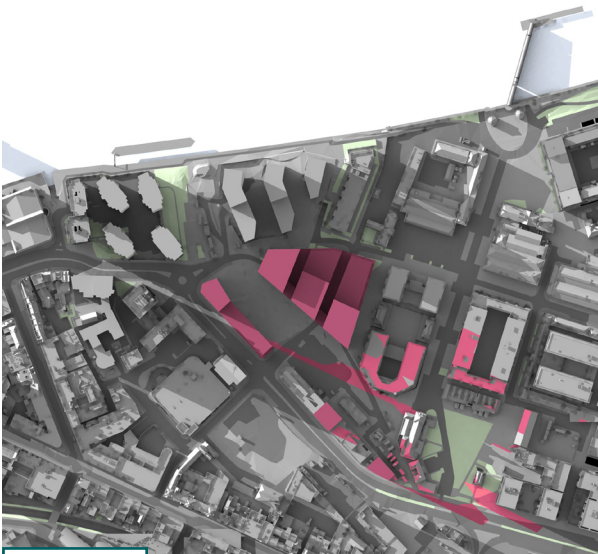

20:00 BST

TRANSIENT OVERSHADOWING ASSESSMENT
21ST DECEMBER (09:00 - 12:00 GMT)

EXISTING



09:00 GMT

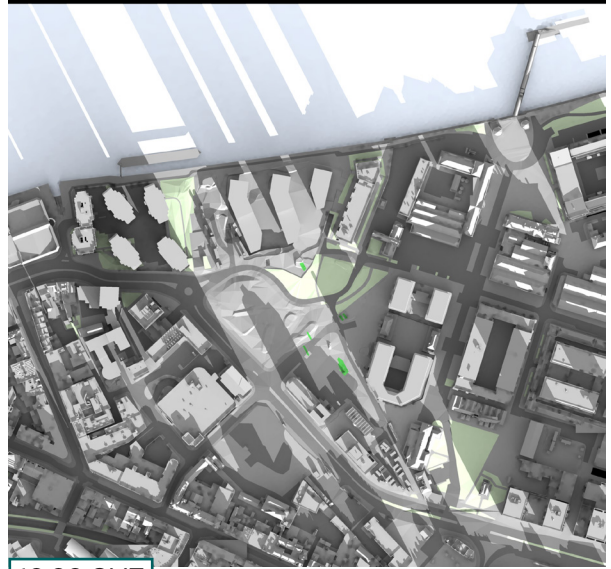

10:00 GMT

PROPOSED

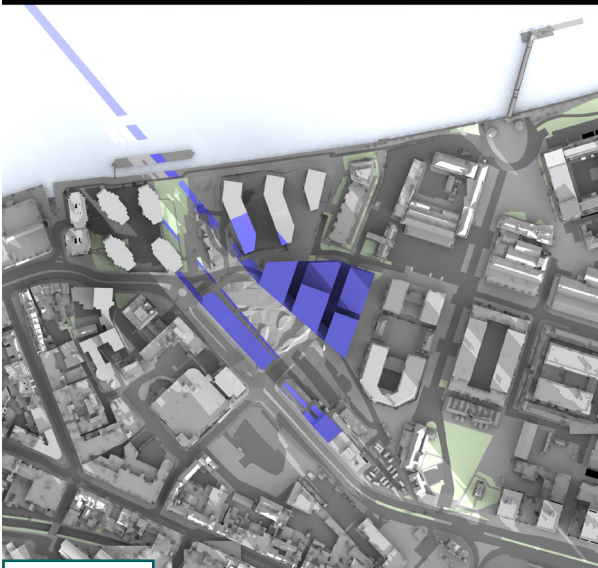

09:00 GMT

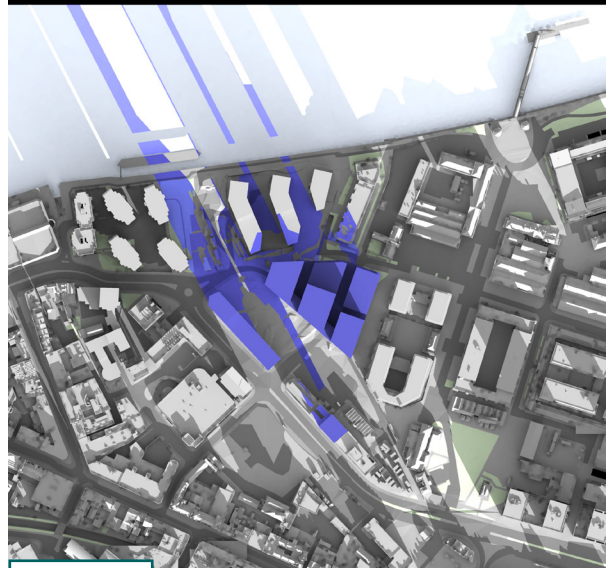

10:00 GMT

CONSENTED



09:00 GMT

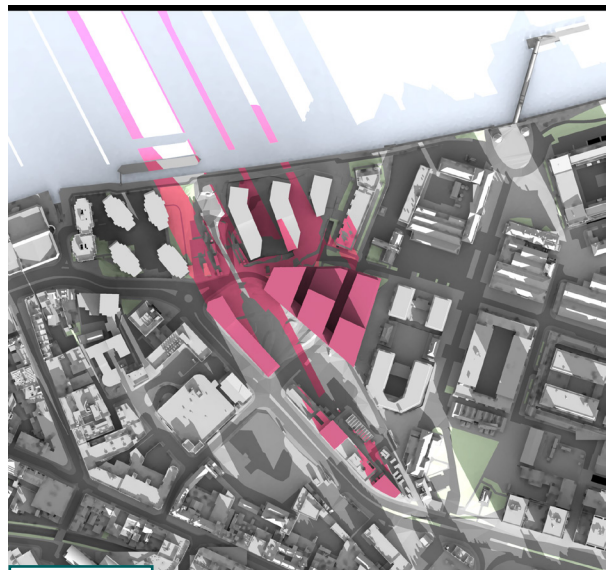

10:00 GMT

EXISTING

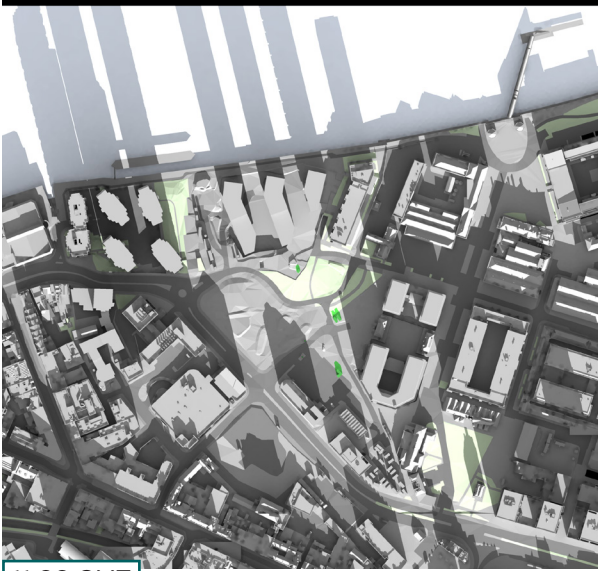

11:00 GMT

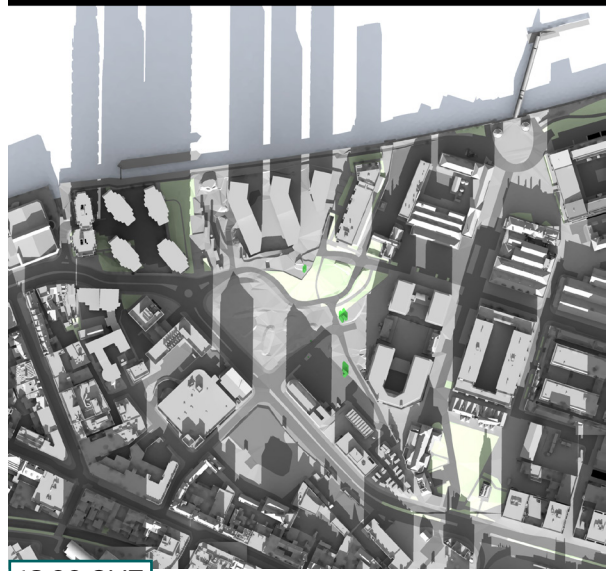

12:00 GMT

PROPOSED

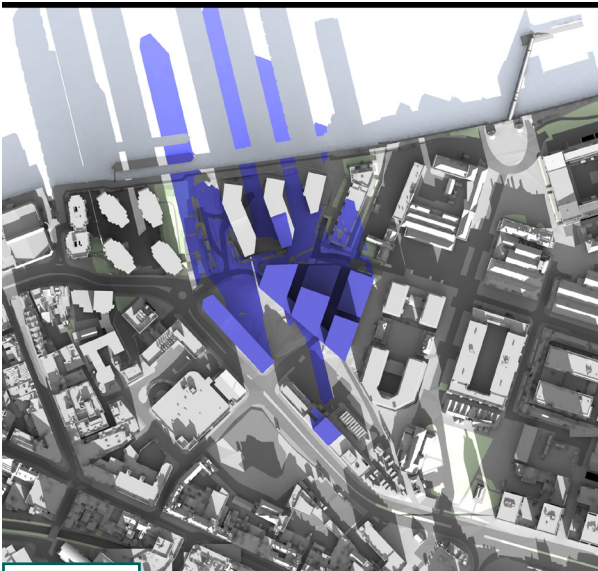

11:00 GMT

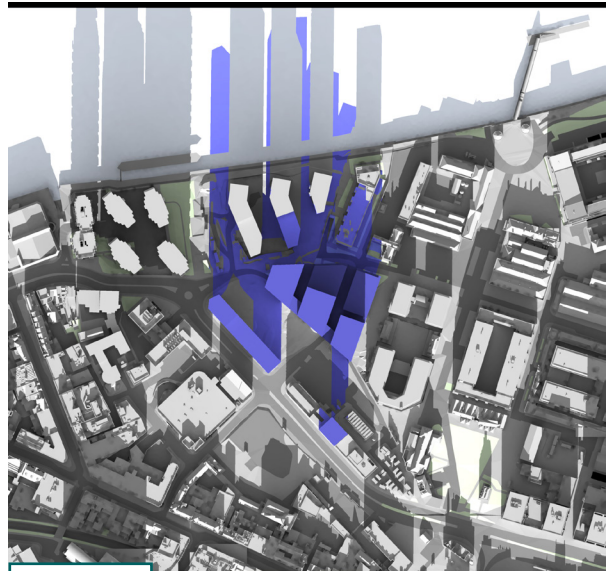

12:00 GMT

CONSENTED

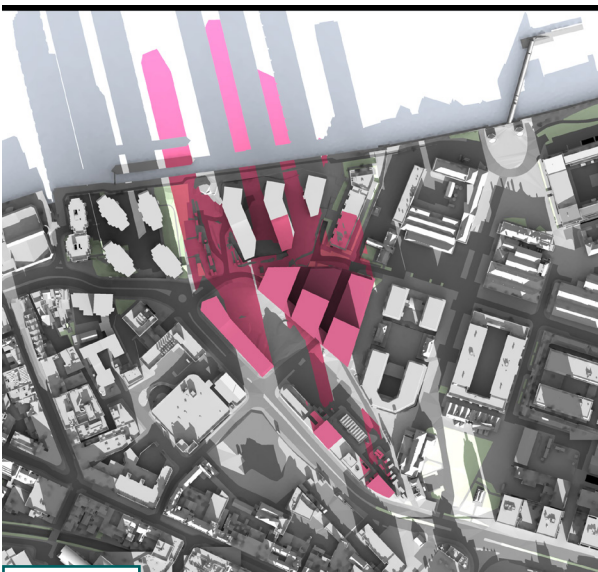

11:00 GMT

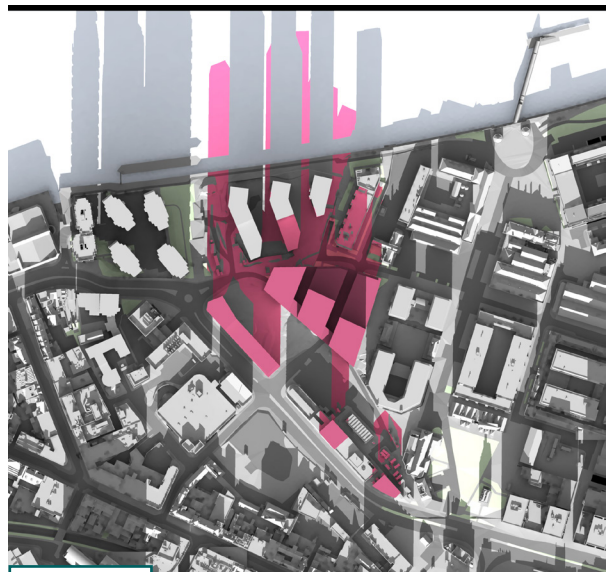

12:00 GMT

TRANSIENT OVERSHADOWING ASSESSMENT
21ST DECEMBER (13:00 - 15:00 GMT)

EXISTING

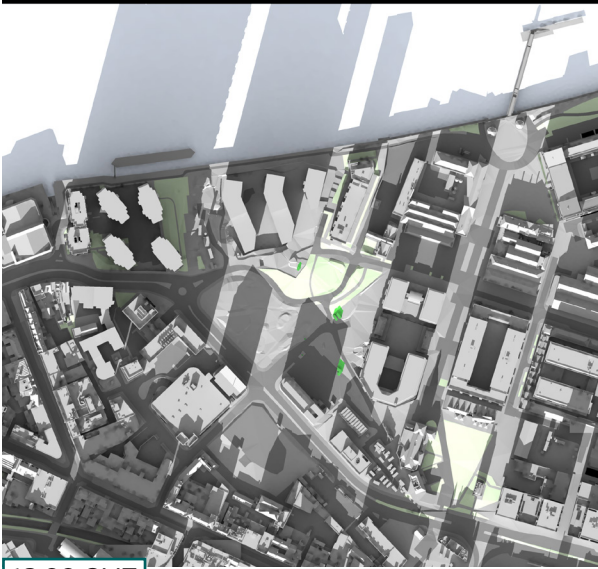

13:00 GMT

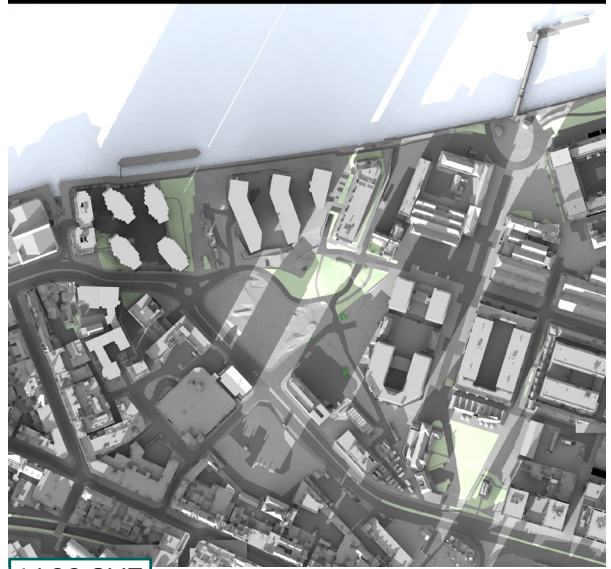

14:00 GMT

PROPOSED

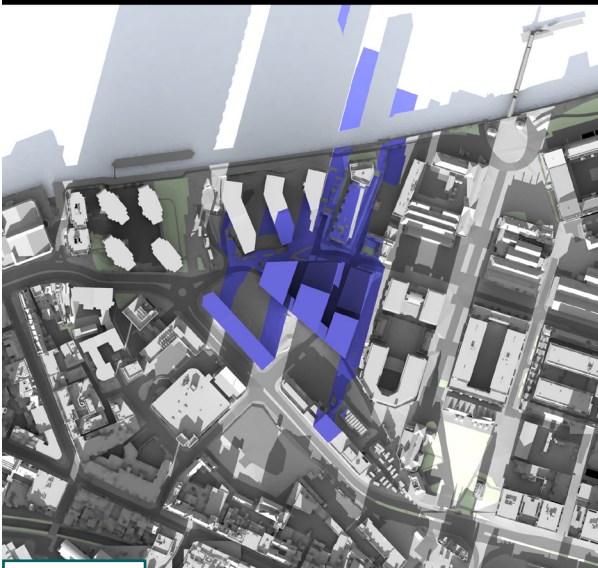

13:00 GMT

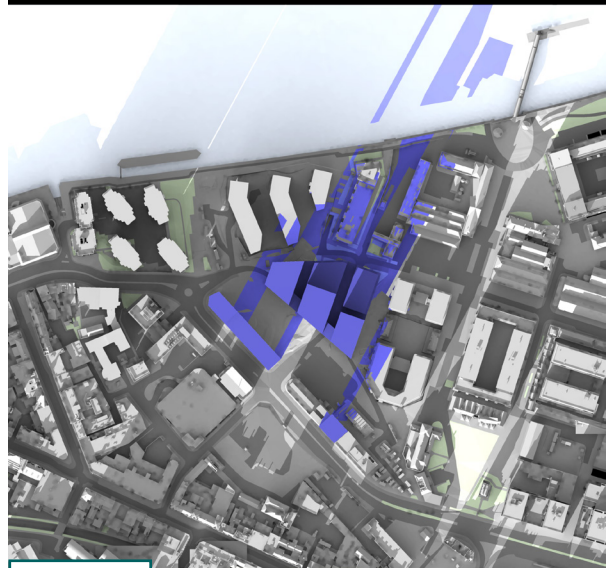

14:00 GMT

CONSENTED

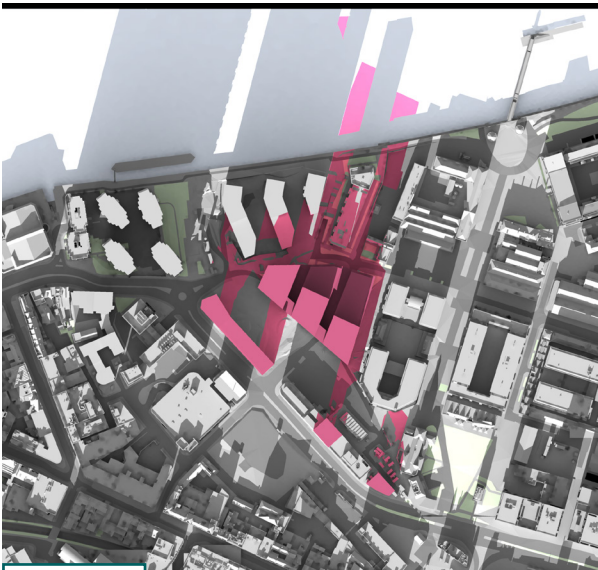

13:00 GMT

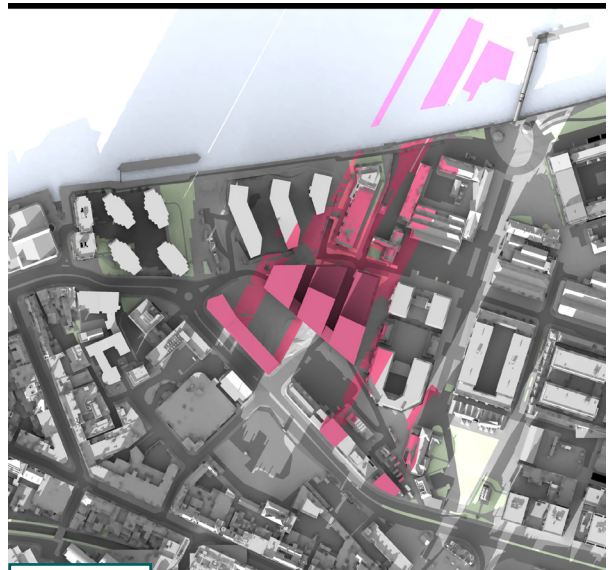

14:00 GMT

EXISTING

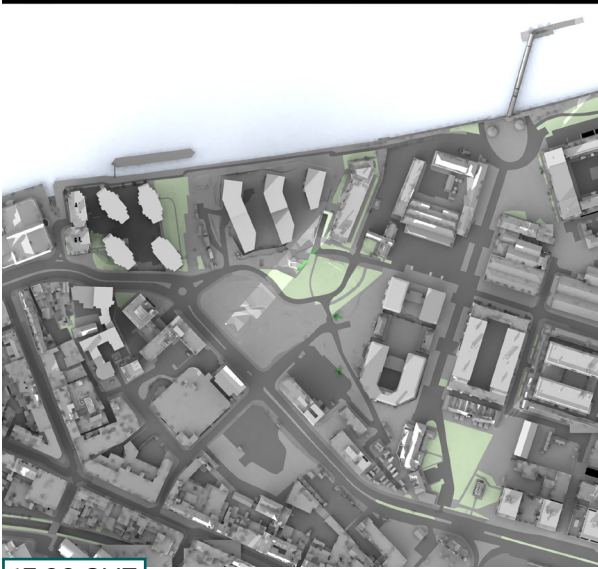

15:00 GMT

PROPOSED

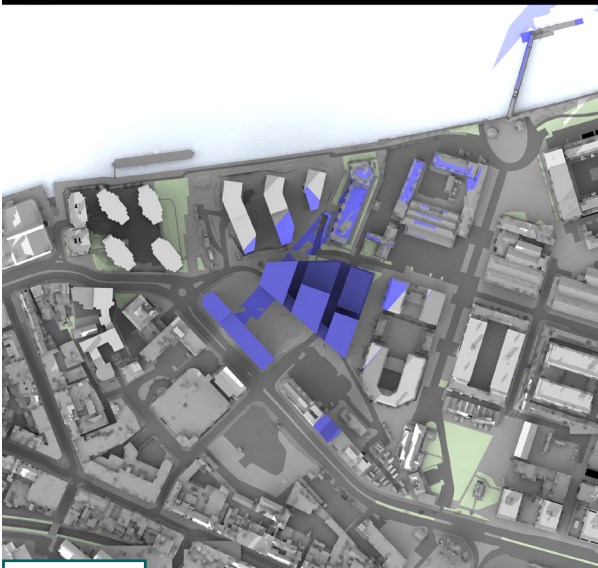

15:00 GMT

CONSENTED



15:00 GMT

1 OVERSHADOWING ASSESSMENTS

OVERSHADOWING ASSESSMENT - CONSENTED SUN HOURS ON GROUND - BRE TEST

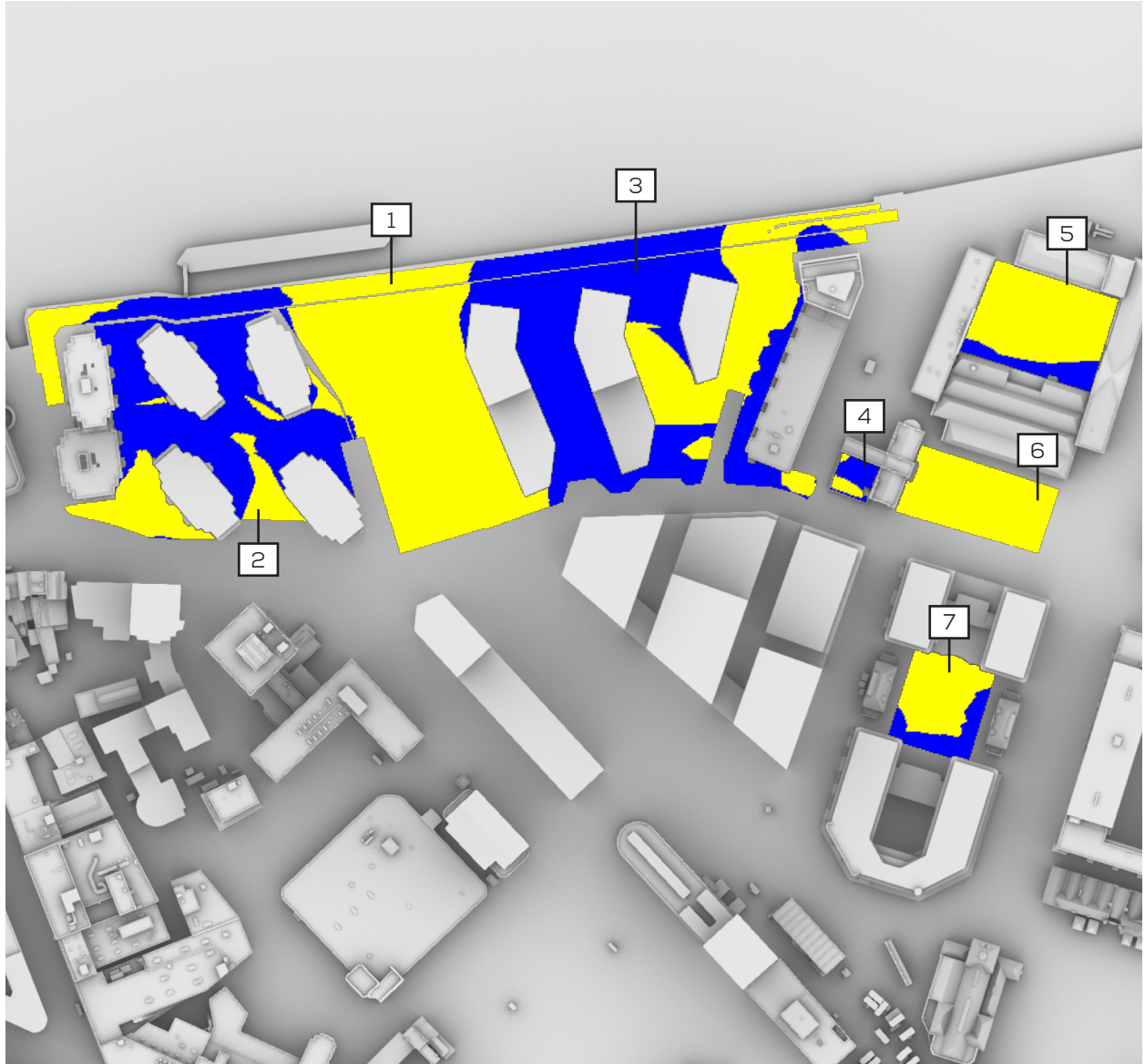

SUN HOURS ON GROUND
BRE TEST - 21ST MARCH



OVERSHADOWING ASSESSMENT - PROPOSED
SUN HOURS ON GROUND - BRE TEST

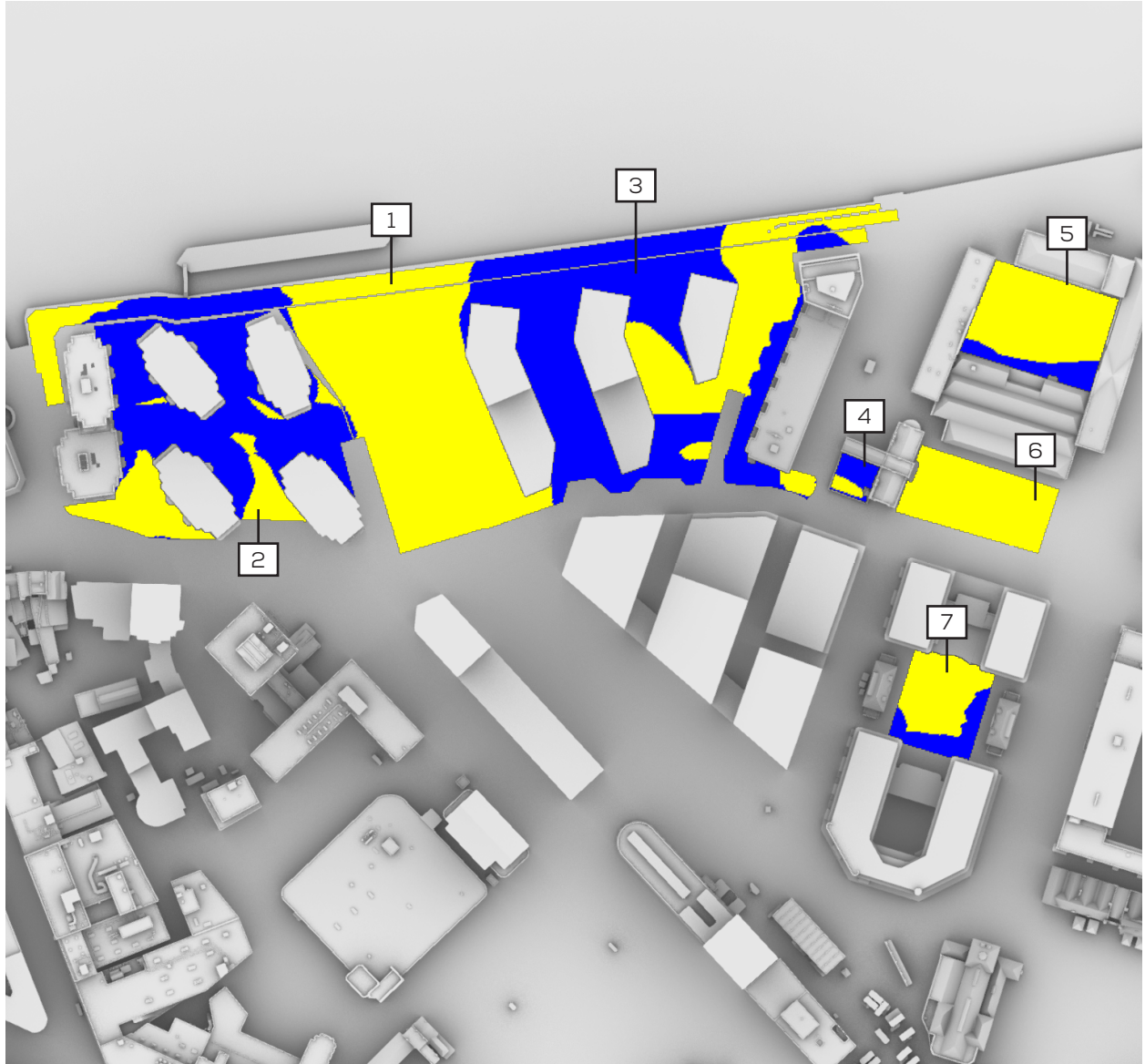

SUN HOURS ON GROUND
BRE TEST - 21ST MARCH



SUN HOURS ON GROUND SUMMARY TABLE

CONSENTED Vs PROPOSED PERCENTAGE LOSS

AREA	% Area seeing 2+ hrs of sunlight on 21st March		
	CONSENTED	PROPOSED	CONS vs PROP % LOSS
1	53	53	0%
2	29	28	3%
3	63	62	2%
4	29	26	10%
5	83	83	0%
6	100	100	0%
7	69	69	0%

PAGE INTENTIONALLY LEFT BLANK

OVERSHADOWING ASSESSMENT - CONSENTED
 SUN EXPOSURE ON GROUND - 21ST MARCH (SPRING EQUINOX)

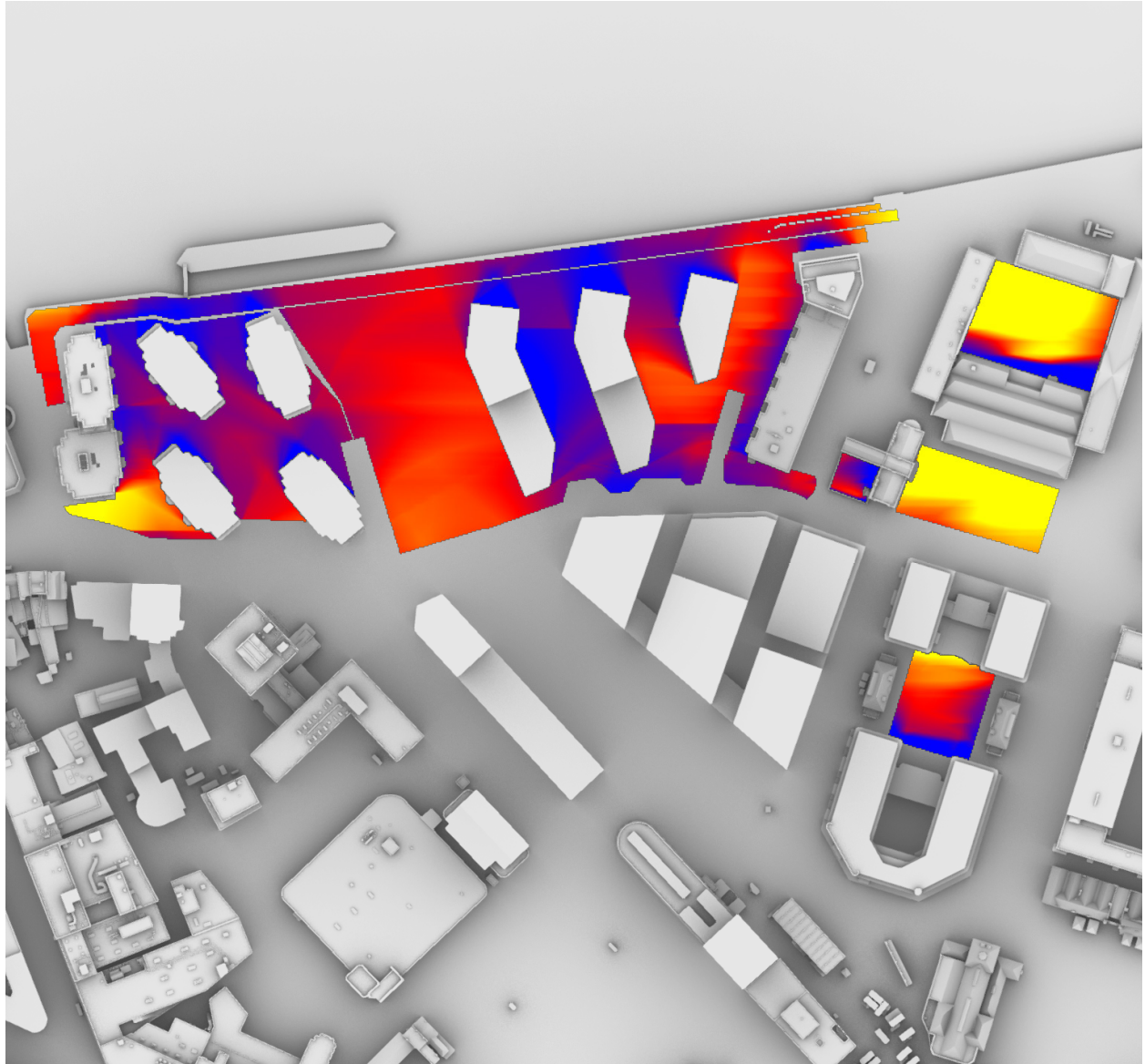

SUN EXPOSURE
 TOTAL HOURS



21st March
 (SPRING EQUINOX)

LONDON

Latitude: 51.5

Longitude: 0.0

Sunrise: 06:02 GMT

Sunset: 18:14 GMT

Total Available Sunlight:
 12hrs 12mins

OVERSHADOWING ASSESSMENT - PROPOSED
 SUN EXPOSURE ON GROUND - 21ST MARCH (SPRING EQUINOX)

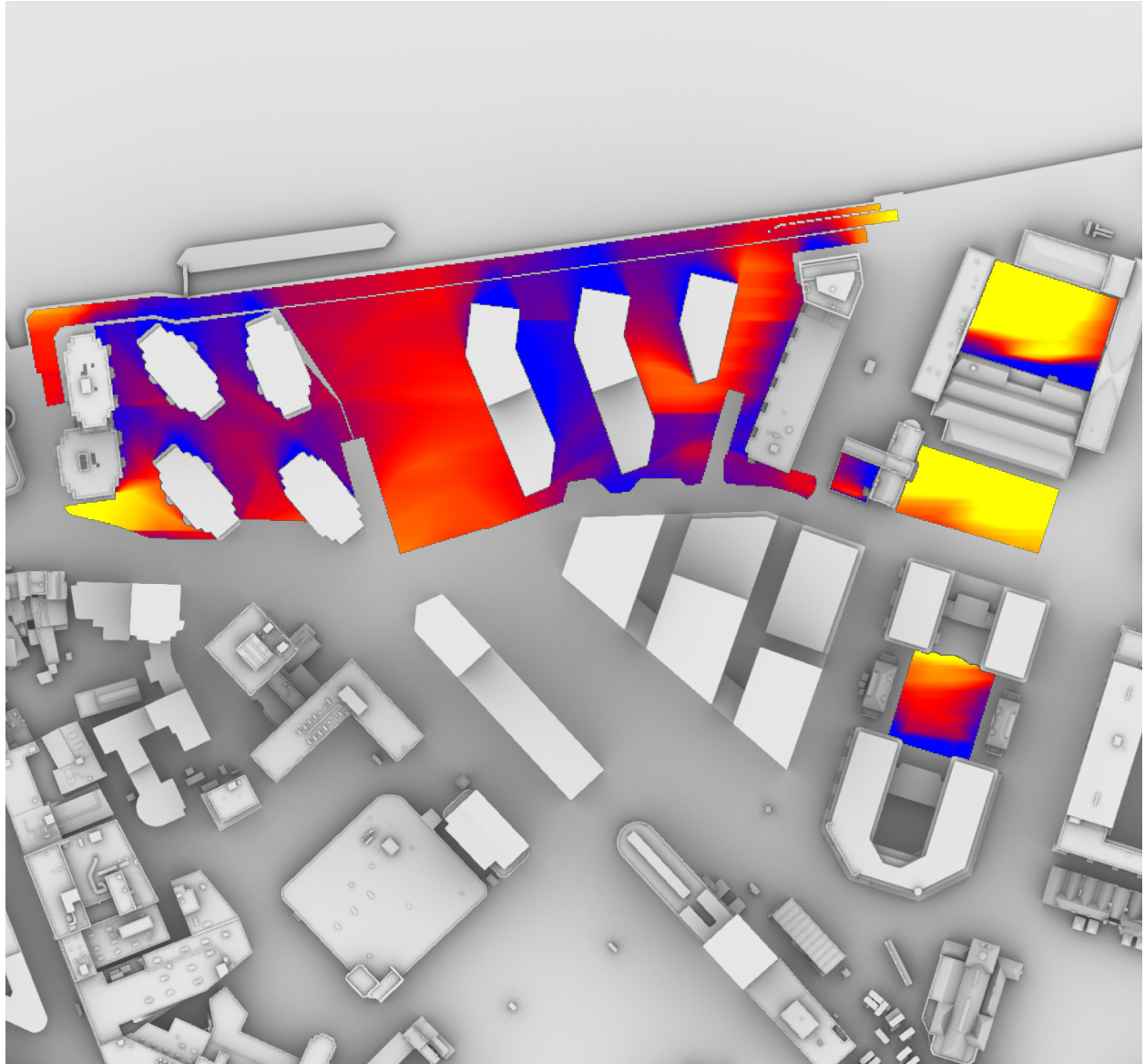

SUN EXPOSURE
 TOTAL HOURS

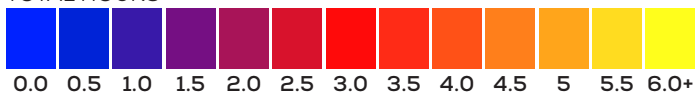

21st March
 (SPRING EQUINOX)

LONDON

Latitude: 51.5

Longitude: 0.0

Sunrise: 06:02 GMT

Sunset: 18:14 GMT

Total Available Sunlight:
 12hrs 12mins

OVERSHADOWING ASSESSMENT - CONSENTED
 SUN EXPOSURE ON GROUND - 21ST JUNE (SUMMER SOLSTICE)

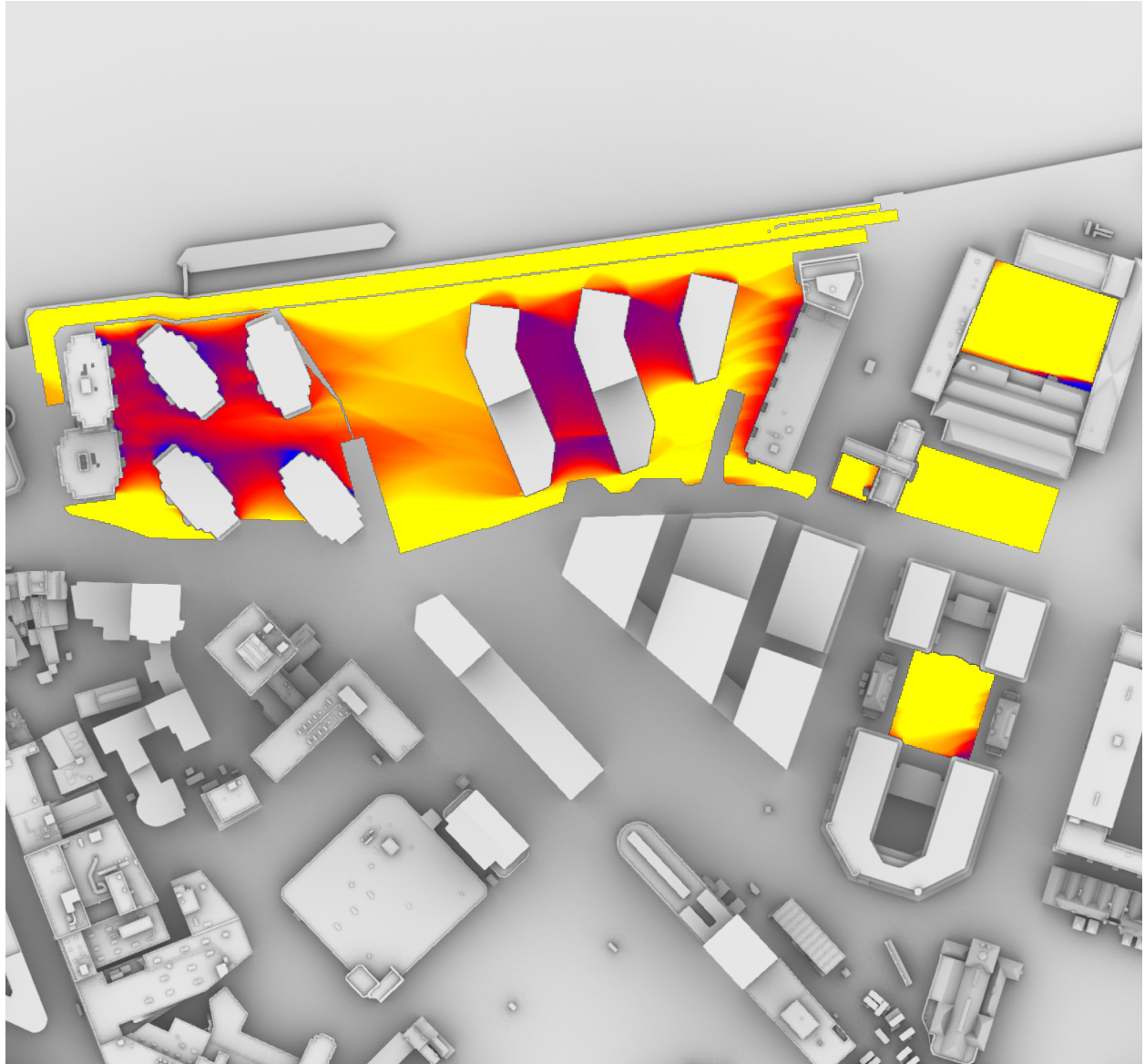

SUN EXPOSURE
 TOTAL HOURS



21st June
 (SUMMER SOLSTICE)

LONDON

Latitude: 51.5
 Longitude: 0.0
 Sunrise: 04:43 GMT
 Sunset: 21:21 GMT

Total Available Sunlight:
 16hrs 38mins

OVERSHADOWING ASSESSMENT -PROPOSED
 SUN EXPOSURE ON GROUND - 21ST JUNE (SUMMER SOLSTICE)

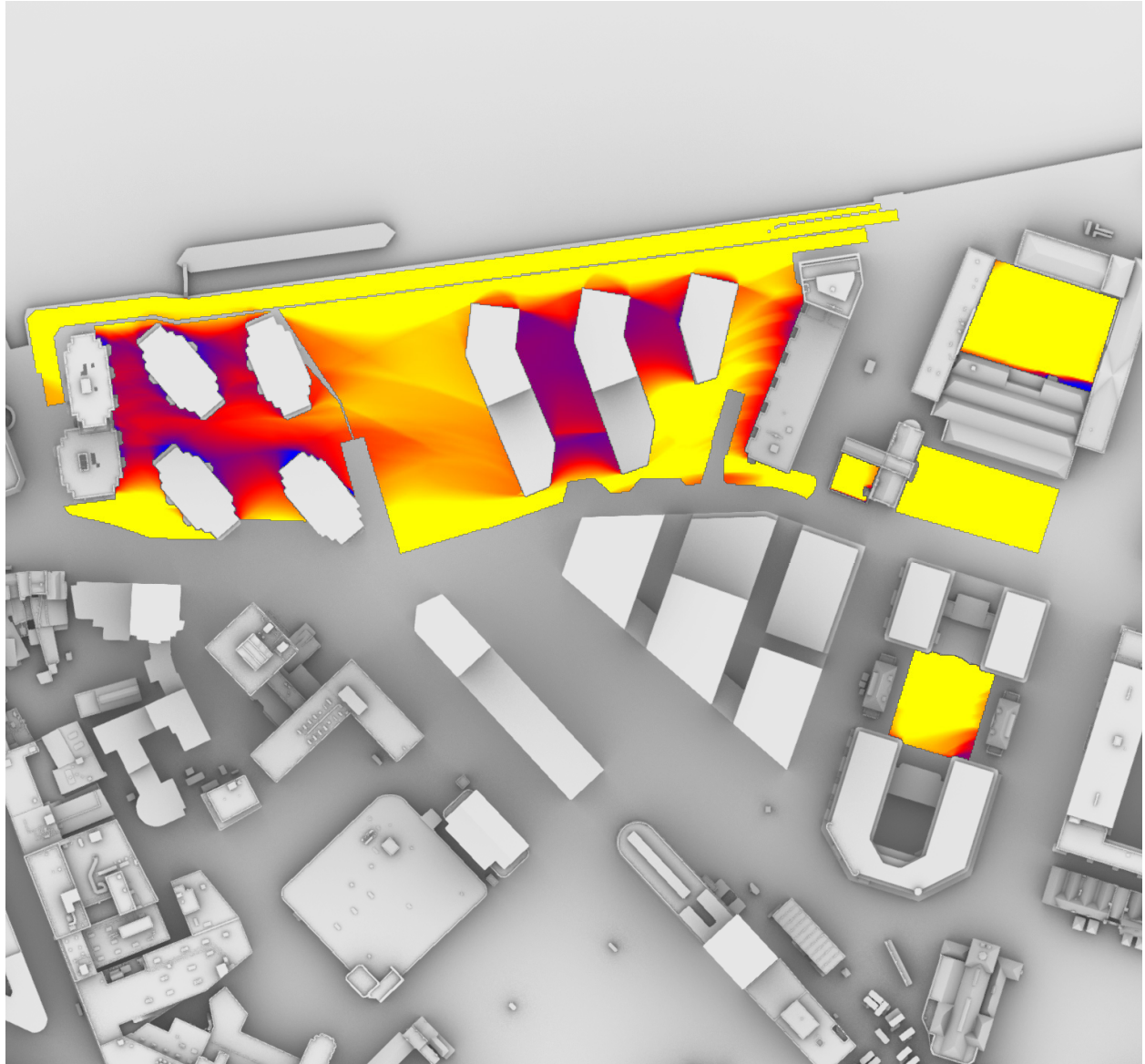

SUN EXPOSURE
 TOTAL HOURS

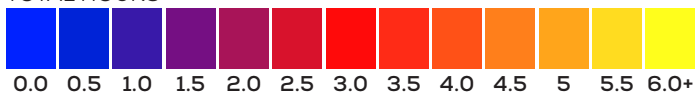

21st June
 (SUMMER SOLSTICE)

LONDON

Latitude: 51.5
 Longitude: 0.0
 Sunrise: 04:43 GMT
 Sunset: 21:21 GMT

Total Available Sunlight:
 16hrs 38mins



For further details please contact us on:

LONDON

T 020 7202 1400

E mail@gia.uk.com

The Whitehouse
Belvedere Road
London SE1 8GA

MANCHESTER

T 0161 672 5100

E manchester@gia.uk.com

2 Commercial Street
Manchester
M15 4RO

BELFAST

T 02892 449 674

E belfast@gia.uk.com

River House
48-60 High Street
Belfast BT1 2BE

BRISTOL

T 0117 374 1504

E bristol@gia.uk.com

33 Bristol
Colston Avenue
Bristol BS1 4UA

DUBLIN

T 020 7202 1400

E hello@giasurveyors.ie

77 Lower Camden Street
Dublin Ireland
D02 XE80