

PROPOSED GROUND FLOOR PLAN  
SCALE: 1/100 @A3

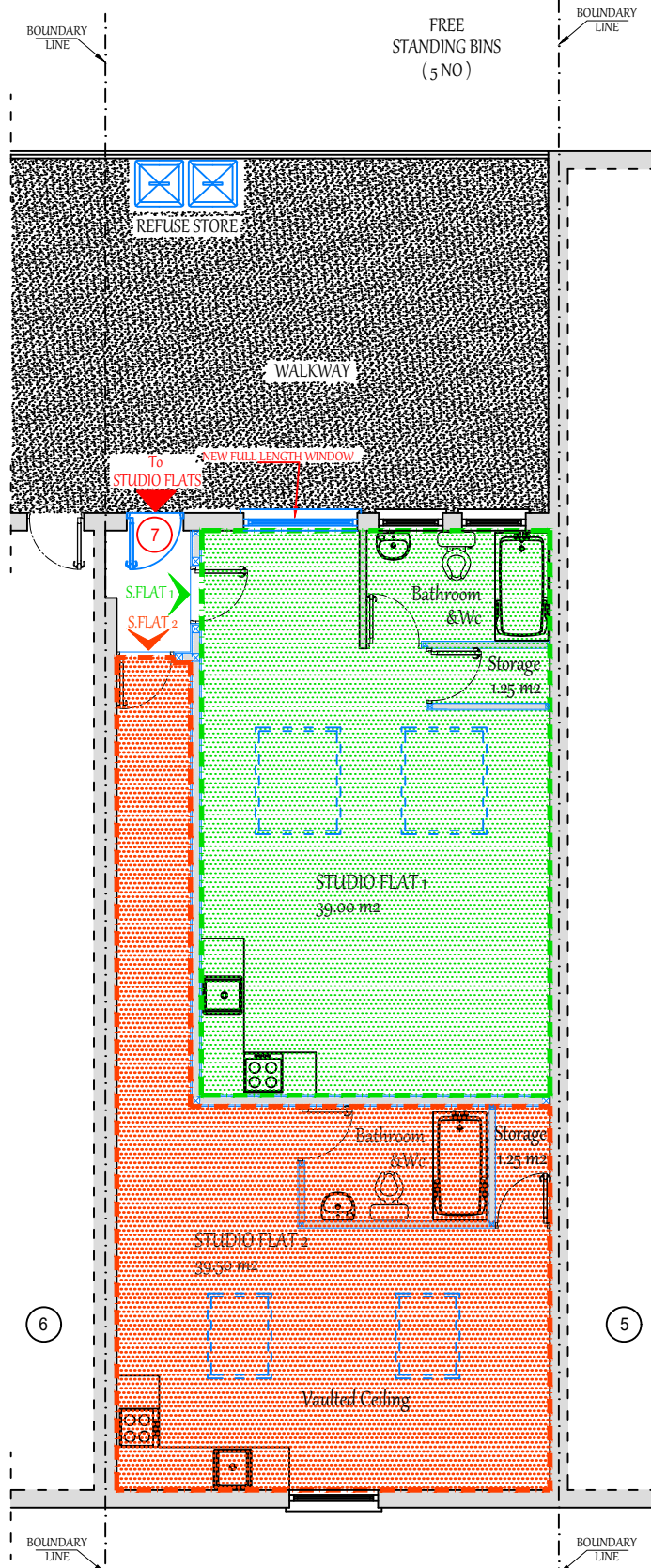

PROPOSED FIRST FLOOR PLAN  
SCALE: 1/100 @A3

REV. A	MRC. 24	-SKYLIGHT
--------	---------	-----------

PROPOSED  
GROUND FLOOR AREA : 120.00 m<sup>2</sup>  
PROPOSED  
FIRST FLOOR AREA : 89.50 m<sup>2</sup>



**Delta Tech Ltd**

Architecture & Construction

TOWN PLANNING CONSULTANTS  
&  
ARCHITECTURAL DESIGN  
86-90 PAUL STREET LONDON EC2A 4NE  
info@deltatechtd.com  
www.deltatechtd.com

7 THE CHAUNTRY  
HIGH STREET  
HAVERHILL  
CB9 8AA

PROPOSED  
-SITE PLAN  
-GROUND FLOOR PLAN  
-FIRST FLOOR PLAN

PROJECT: PLANNING

SCALE: 1/100 @A3  
1/500

REF. NO :CHN7/24/05

DATE: JAN. 2024

DRG BY: B.OZDEMIR

Copyright © Delta Tech Ltd. All Rights Reserved  
Deviating from these drawings without consultation and/or agreement with the employer is unacceptable. This drawing is indicative and exact dimensions should be checked and confirmed on site by the nominated contractor or competent person/s prior to commencement of building works. All drawings and dimensions shall be verified by the relevant contractor/s on site prior to commencement of any works, ordering of materials or setting out. Any discrepancies should be reported in writing to Delta Tech Ltd. Do not scale from this drawing unless trained to use a scale ruler - only work from written and checked dimensions. This drawing is the property of Delta Tech Ltd and copyright reserved by them. This drawing is not to be used, copied or disclosed by or to any unauthorised persons without prior written authorisation consent from Delta Tech Ltd. DO NOT PROCEED WORKS IN THE EVENT OF A DRAWING DISCREPANCY

For all structural aspects please refer to Structural Engineers project information and cross reference all drawings, details and calculations with the architectural drawing prior to commencement of building works. Delta Tech Ltd holds no responsibility or liability for any works carried out on site.

FLOOR	FLAT no	SQM	PERSON
First	STUDIO FLAT1	39.00 m <sup>2</sup>	1
First	STUDIO FLAT2	39.50 m <sup>2</sup>	1

