

Appendix 1

Flat 8, Royal Victoria Court, Royal Victoria Park, Brentry, BS10 6TL
Tree Location Plan (TLP) Ref AJE 29527Rev1

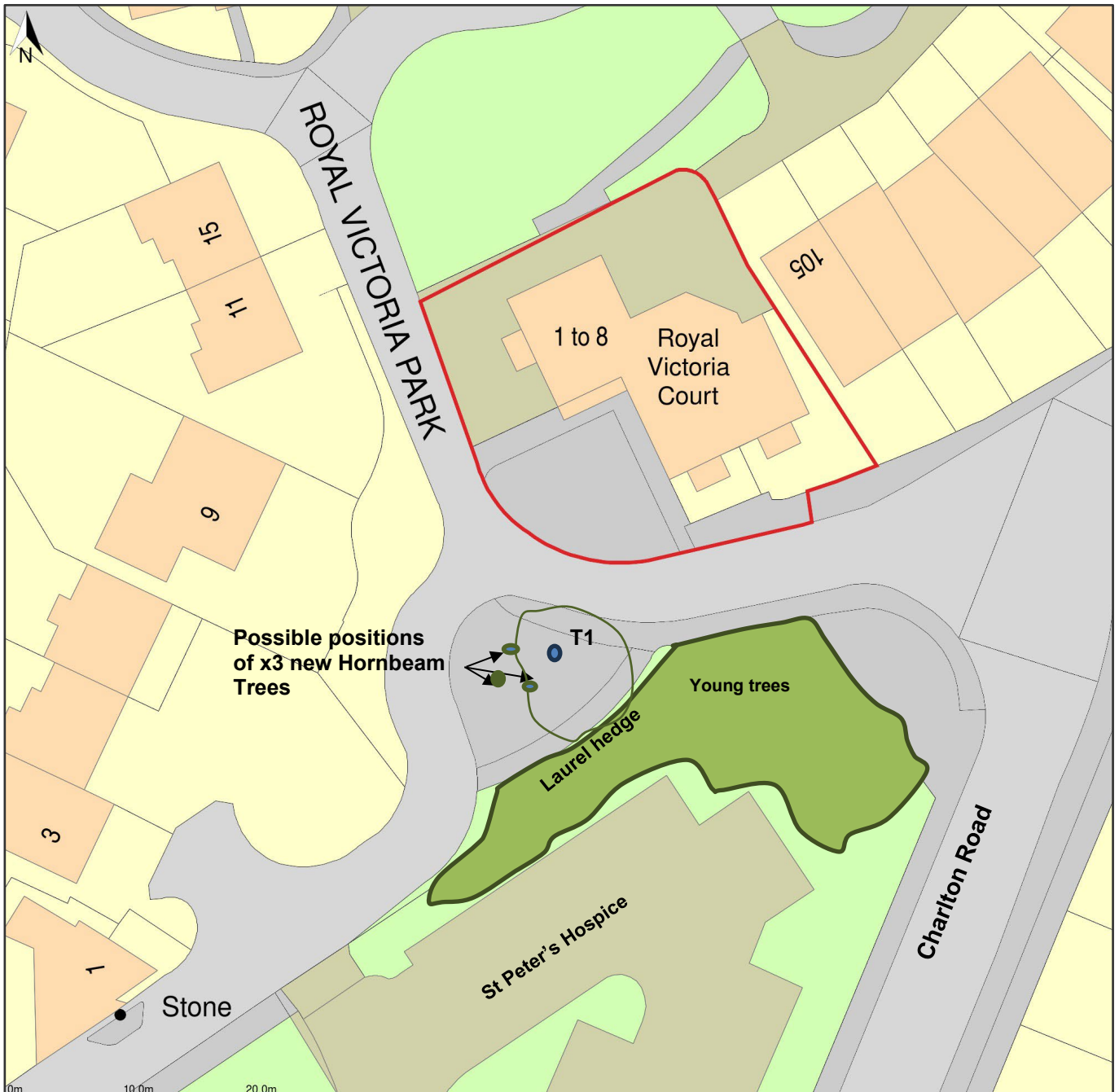

**Tree on land opposite 1-8 Royal Victoria Court, Royal Victoria Park,
Brentry, BS10 6TL**

15 March 2024

(TLP) (approximate positions, not to scale) Ref; AJE/29527Rev1

UNDERTAKEN BY

Alan Engley

M.Arb. (R.F.S), F.Arbor.A. MCI.Hort. M.I.C.For. RCArborA
Registered Consultant of the Arboricultural Association and Chartered Forester
Telephone: 01225 851200

Guidott House, 205 Bailbrook Lane, Bath BA1 7AB

Email: alan@engleytrees.co.uk

www.engleytrees.co.uk

Engley rights, not to be reproduced without consent from AJ Engley.