

**Site Location Plan**

Scale: 1/1250

© Crown Copyright  
All rights reserved  
Licence No: AL 100025996

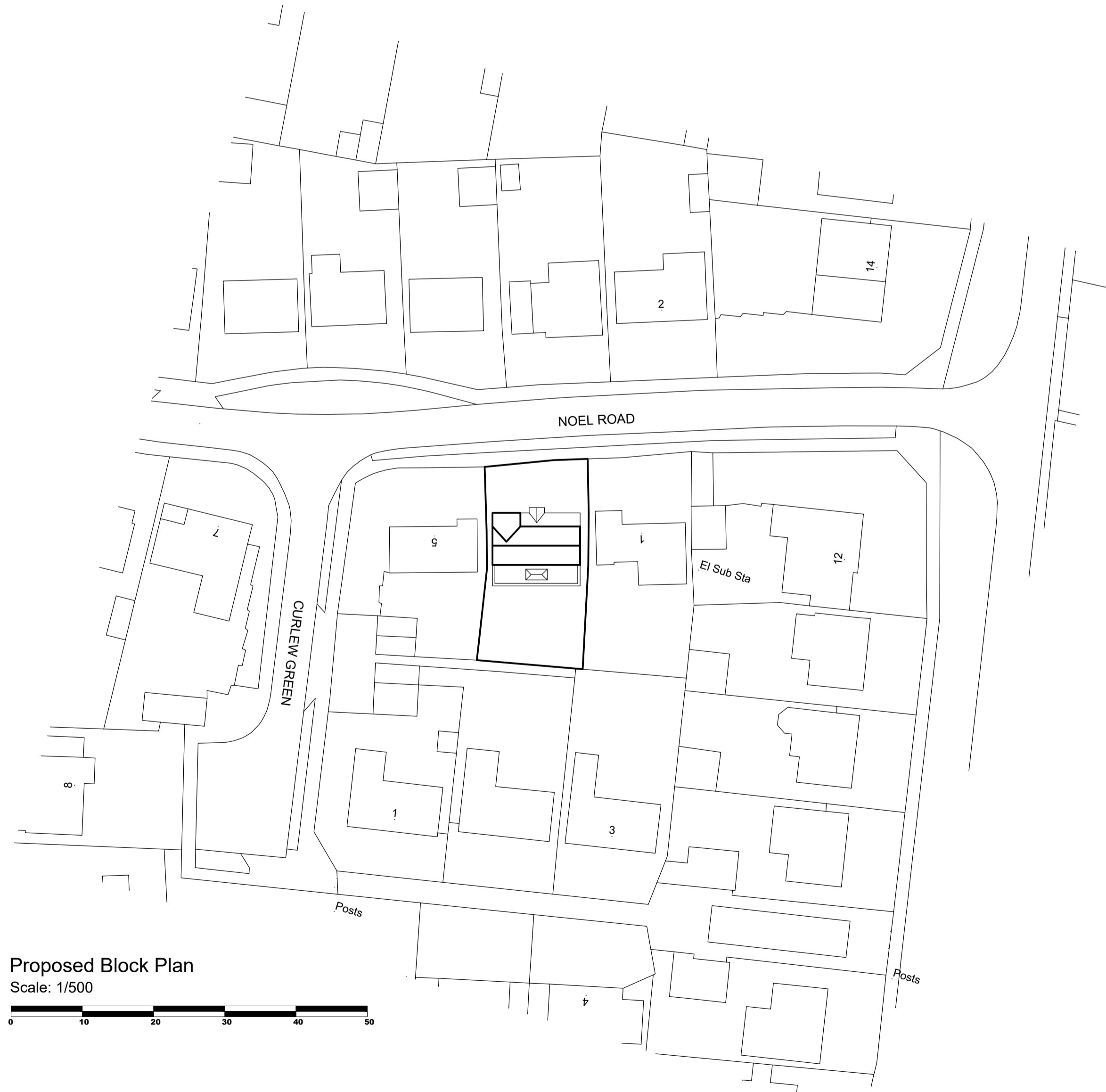
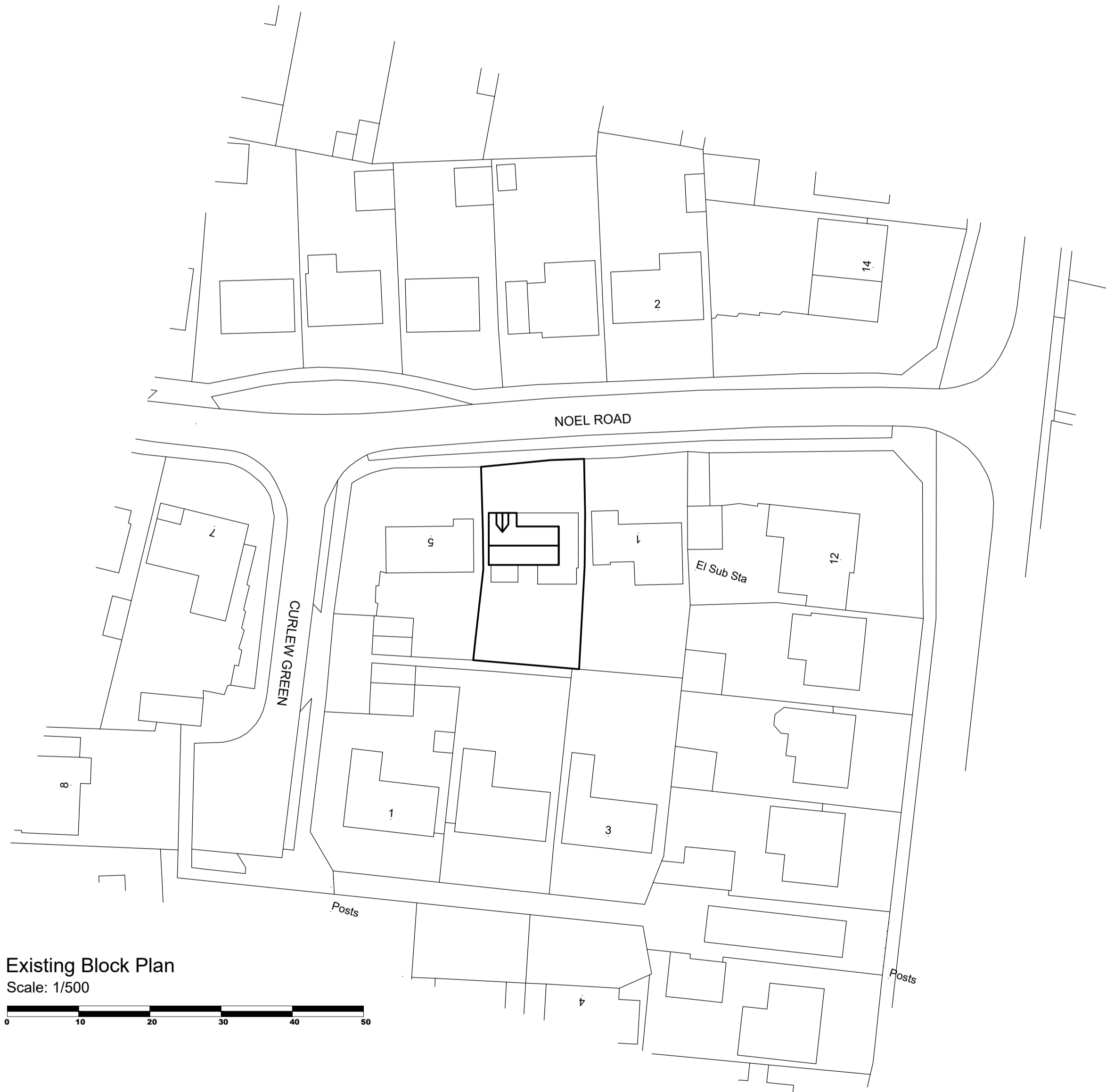
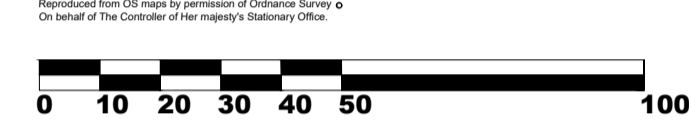

**Notes:**  
This drawing and any design shown upon it are the exclusive copyright of Ian Garrett Building Design Limited, UK. No other person may use this design for any purpose, without prior written permission or discharge being received from in a written form from - Ian Garrett Building Design Limited, UK the copyright holder.  
This drawing shall not be scaled, check all site dimensions & from fixed positions. Use dimensions on the plans in preference.  
This drawing has been prepared for planning or building regulation purposes only, it thus shall not be regarded as a fully working drawing. All dimensions, levels, foundations, ground conditions, drains, heights, DPC & DPM together with complete drawing shall be checked and agreed prior to any manufacture of any component.  
All work, workmanship & materials are to comply with the current applicable BS Code of Practice, building regulations.  
Check planning conditions that may be relevant to the application. This drawing shall be read in conjunction with the specifications, engineers designs, details that may be applied to assist.  
Any changes to the design or specifications, shall need to be agreed with the Local Authority planning & building control departments. Changes could compromise the design requirements.  
No alterations to the drawings or specifications shown may be undertaken other than by Ian Garrett Building Design Ltd the copyright holder.

Revisions:	
Date	Description
19.02.24	Drawing updated.
19.02.24	Drawing updated - Non Material Amendment
3	

**3 Noel Road**  
Lowestoft  
Suffolk  
NR32 3JS  
  
Client:  
Ms Wilson & Mr Mummery

**Site Location and Block Plans**

Drawing no: 3146.23.4B  
Date: November 2023  
Scale: 1:50, 1:100, 1:500 & 1:1250