

Do not scale from drawing. Use figured dimensions only.  
All dimensions to be checked on site by the contractor and any discrepancies to be notified to the architect prior to works being carried out.

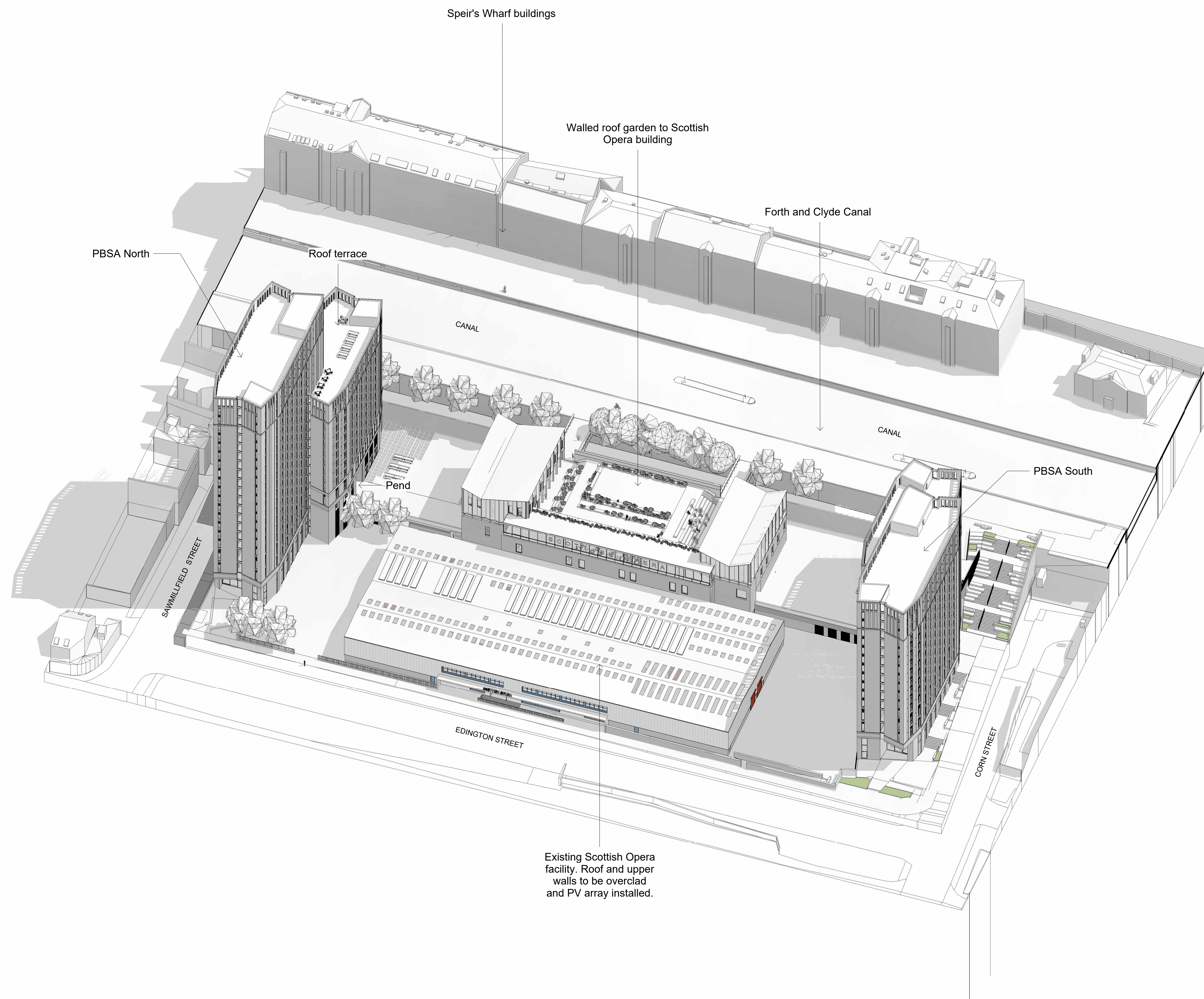

Existing Scottish Opera facility. Roof and upper walls to be overclad and PV array installed.

Revisions: **PLANNING**

Title: Proposed Site Axo 1

Project: New Rotterdam Wharf

Client: Scottish Opera

Drawing No: NRW-PPA-0-XX-DR-A-9420

Scale: @ A1

Revision:

Date: 19/02/24

**PAGE \ PARK**

Page Park Architects  
20 James Morrison Street, Glasgow G1 5PE, UK  
T 0141 553 5440 F 0141553 5441  
mail@pagepark.co.uk www.pagepark.co.uk