

EXISTING PART NE (FRONT) ELEVATION 1:50

EXISTING PART SE (FRONT) ELEVATION 1:50

EXISTING PART SE (REAR) ELEVATION 1:50

EXISTING PART SW (REAR) ELEVATION 1:50

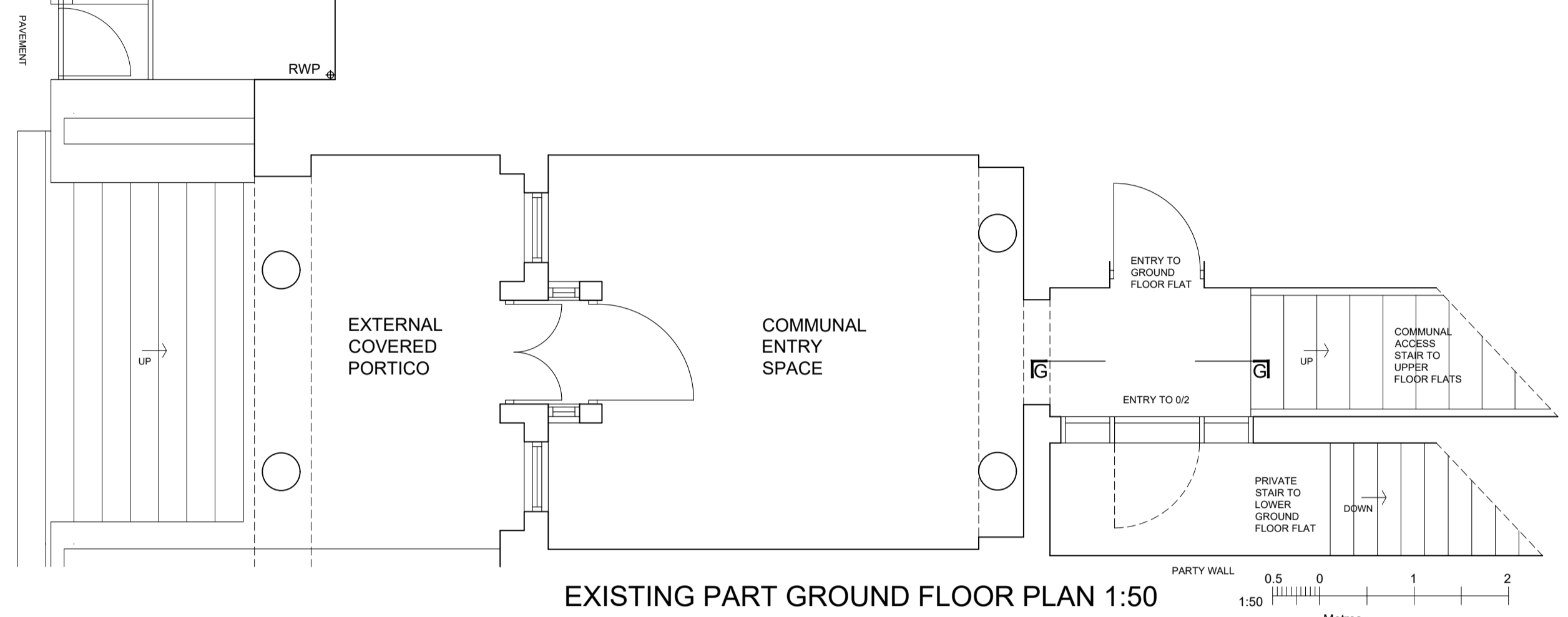

EXISTING PART GROUND FLOOR PLAN 1:50



EXISTING FRONT ELEVATIONS

EXISTING REAR ELEVATIONS

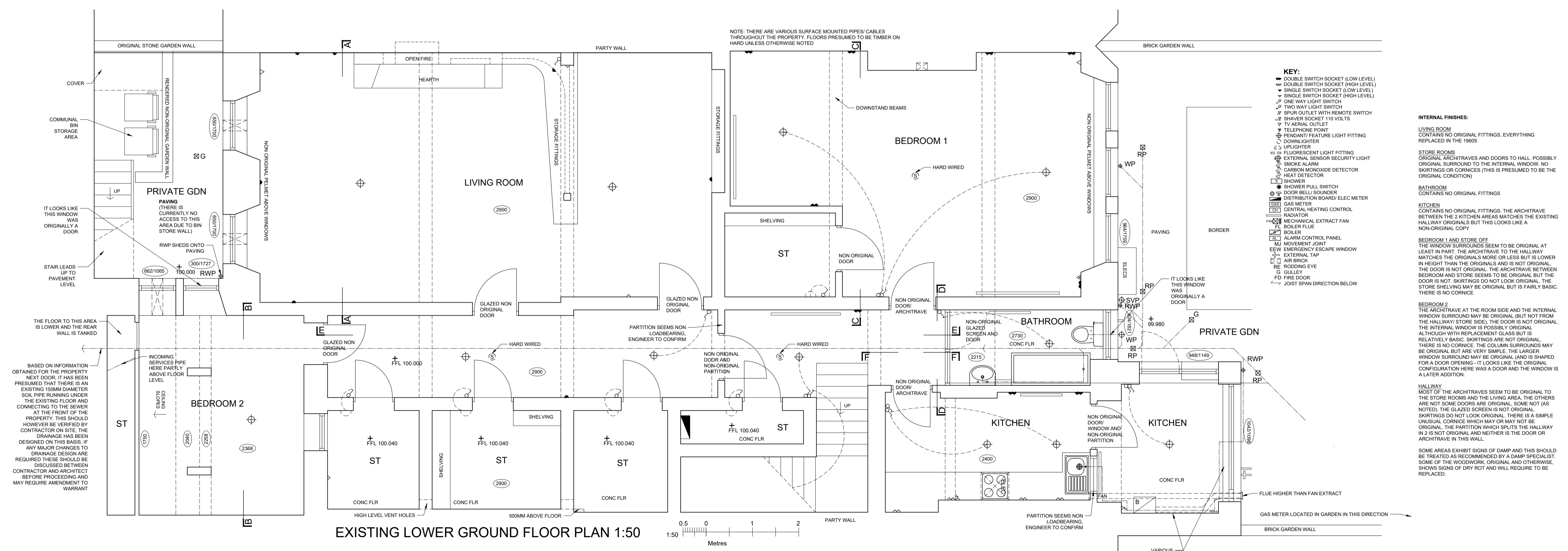

EXISTING LOWER GROUND FLOOR PLAN 1:50

- KEY:**
- ◆ DOUBLE SWITCH SOCKET (LOW LEVEL)
  - ◇ DOUBLE SWITCH SOCKET (HIGH LEVEL)
  - ▽ SINGLE SWITCH SOCKET (LOW LEVEL)
  - ◇ SINGLE SWITCH SOCKET (HIGH LEVEL)
  - ◇ ONE WAY LIGHT SWITCH
  - ◇ TWO WAY LIGHT SWITCH
  - ◇ SPUR OUTLET WITH REMOTE SWITCH
  - ◇ SHOWER SOCKET 110 VOLTS
  - ◇ TV AERIAL OUTLET
  - ◇ TELEPHONE POINT
  - ◇ PENDANT FEATURE LIGHT FITTING
  - ◇ DOWNLIGHTER
  - ◇ UP LIGHTER
  - ◇ FLUORESCENT LIGHT FITTING
  - ◇ EXTERNAL SENSOR SECURITY LIGHT
  - ◇ SMOKE ALARM
  - ◇ CARBON MONOXIDE DETECTOR
  - ◇ HEAT DETECTOR
  - ◇ SHOWER PULL SWITCH
  - ◇ DOOR BELL SOUNDER
  - ◇ DISTRIBUTION BOARD/ ELEC METER
  - ◇ GAS METER
  - ◇ CENTRAL HEATING CONTROL RADIATOR
  - ◇ MECHANICAL EXTRACT FAN
  - ◇ BOILER FLUE
  - ◇ ALARM CONTROL PANEL
  - ◇ MOVEMENT JOINT
  - ◇ EEW EMERGENCY ESCAPE WINDOW
  - ◇ EXTERNAL TAP
  - ◇ AIR BRICK
  - ◇ ROOFING EYE
  - ◇ GULLLEY
  - ◇ FIRE DOOR
  - ◇ JOIST SPAN DIRECTION BELOW

**INTERNAL FINISHES:**

**LIVING ROOM**  
CONTAINS NO ORIGINAL FITTINGS. EVERYTHING REPLACED IN THE 1960S

**STORE ROOMS**  
ORIGINAL ARCHITRAVES AND DOORS TO HALL. POSSIBLY ORIGINAL SURROUND TO THE INTERNAL WINDOW. NO SKIRTINGS OR CORNICES (THIS IS PRESUMED TO BE THE ORIGINAL CONDITION)

**BATHROOM**  
CONTAINS NO ORIGINAL FITTINGS

**KITCHEN**  
CONTAINS NO ORIGINAL FITTINGS. THE ARCHITRAVE BETWEEN THE 2 KITCHEN AREAS MATCHES THE EXISTING HALLWAY ORIGINALS BUT THIS LOOKS LIKE A NON-ORIGINAL COPY

**BEDROOM 1 AND STORE OFF**  
THE WINDOW SURROUNDS SEEM TO BE ORIGINAL AT LEAST IN PART. THE ARCHITRAVE TO THE HALLWAY MATCHES THE ORIGINALS MORE OR LESS BUT IS LOWER IN HEIGHT THAN THE ORIGINALS AND IS NOT ORIGINAL. THE DOOR IS NOT ORIGINAL. THE ARCHITRAVE BETWEEN BEDROOM AND STORE SEEMS TO BE ORIGINAL BUT THE DOOR IS NOT. SKIRTINGS DO NOT LOOK ORIGINAL. THE STORE SHELVING MAY BE ORIGINAL BUT IS FAIRLY BASIC. THERE IS NO CORNICE

**BEDROOM 2**  
THE ARCHITRAVE AT THE ROOM SIDE AND THE INTERNAL WINDOW SURROUND MAY BE ORIGINAL (BUT NOT FROM THE HALLWAY STORE SIDE). THE DOOR IS NOT ORIGINAL. THE INTERNAL WINDOW IS POSSIBLY ORIGINAL ALTHOUGH WITH REPLACEMENT GLASS BUT IS RELATIVELY BASIC. SKIRTINGS ARE NOT ORIGINAL. THERE IS NO CORNICE. THE COLUMN SURROUNDS MAY BE ORIGINAL BUT ARE VERY SIMPLE. THE LARGER WINDOW SURROUND MAY BE ORIGINAL (AND IS SHAPED FOR A DOOR OPENING - IT LOOKS LIKE THE ORIGINAL CONFIGURATION HERE WAS A DOOR AND THE WINDOW IS A LATER ADDITION)

**HALLWAY**  
MOST OF THE ARCHITRAVES SEEM TO BE ORIGINAL TO THE STORE ROOMS AND THE LIVING AREA. THE OTHERS ARE NOT. SOME DOORS ARE ORIGINAL, SOME NOT (AS NOTED). THE GLAZED SCREEN IS NOT ORIGINAL. SKIRTINGS DO NOT LOOK ORIGINAL. THERE IS A SIMPLE UNUSUAL CORNICE WHICH MAY OR MAY NOT BE ORIGINAL. THE PARTITION WHICH SPLITS THE HALLWAY IN 2 IS NOT ORIGINAL AND NEITHER IS THE DOOR OR ARCHITRAVE IN THIS WALL

**SOME AREAS EXHIBIT SIGNS OF DAMP AND THIS SHOULD BE TREATED AS RECOMMENDED BY A DAMP SPECIALIST. SOME OF THE WOODWORK, ORIGINAL AND OTHERWISE, SHOWS SIGNS OF DRY ROT AND WILL REQUIRE TO BE REPLACED.**