

PROPOSED GROUND FLOOR PLAN

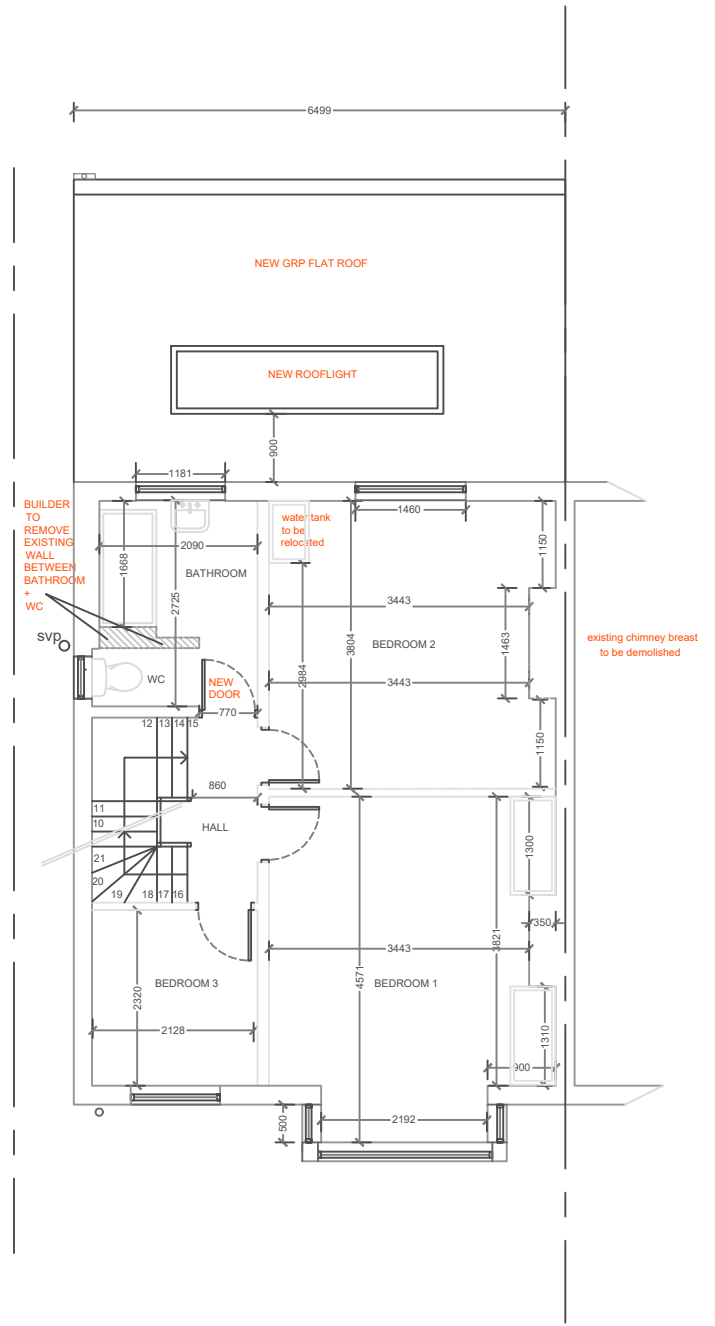

PROPOSED FIRST FLOOR PLAN

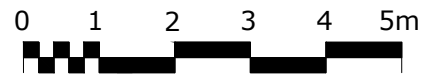

REV	DATE	DESCRIPTION
A	12.07.17	TO BE RE-SUBMITTED FOR PLANNING HOUSEHOLDER APPLICATION (GWT).
B	23.10.19	GENERAL UPDATE FOR LAWFUL CERTIFICATE OF DEVELOPMENT (GWT).
C	30.01.20	REAR EXTENSION INCREASED TO 4M IN LENGTH FOR FULL PLANNING APPLICATION (GWT).
D	07.03.20	FIRST FLOOR BATHROOM LAYOUT AS
E	11.03.24	KITCHEN LAYOUT REVISED; RESUBMITTED FOR PLANNING APPLICATION HOUSEHOLDER (GWT).

Copyright in this drawing belongs to and is vested in **Truscott Architects Ltd** and may not be reproduced or distributed in any way or for any purpose without their written consent. Any person firm or company unlawfully reproducing or distributing this drawing or in any way infringing the copyright therein will be prosecuted.
Do not scale dimensions from drawing. All dimensions are to be checked on site and any discrepancy reported immediately to designers.

PROJECT: 26 Grayham Road
New Malden
KT3 5HW

DRAWING No: 027-05

DRAWING TITLE: SINGLE STOREY
REAR EXTENSION
PROPOSED GROUND FLOOR &
FIRST FLOOR PLANS

SCALE: 1:100@A3

DATE: MARCH 2024

STATUS: HOUSEHOLDER (PLANNING)

Revision: E

TRUSCOTT ARCHITECTS

239 Malden Way, New Malden, Surrey KT3 5QW
United Kingdom
M: +44(0)7786 266793 E: gwongt@tarch.co.uk www.tarch.co.uk