

KEY

EXISTING TREES & VEGETATION TO BE RETAINED AND PROTECTED
Taken from the Tyler Grange 'Soft Landscape Proposals' (Dwg. No. 12176_P10 Rev. C)

EXISTING PALISADE FENCE

HEAVY STANDARD TREES
(Tree pit size: 1000x1000x750mm)
12-14cm stem girth
3.5-4.0m height
1.8-2.1m clear stem
Root wrapped

Species	Common Name
Acer campestre 'Elsrijk'	Field Maple var.
Betula pendula	Silver Birch
Pyrus calleryana 'Chanticleer'	Ornamental Pear
Prunus padus	Bird Cherry

LOW ORNAMENTAL SHRUB/HERBACEOUS PLANTING
(300mm depth of topsoil + minimum 300mm depth subsoil)
Ultimate plant height is below 1m.

Species	Supply Size	Pot	Spacing
Brachyglottis 'Sunshine'	300-400mm	3L	500mm c/s
Cotoneaster 'Coral Beauty'	300-400mm	3L	500mm c/s
Hebe 'Midsummer Beauty'	300-400mm	3L	500mm c/s
Persicaria affinis 'Darjeeling Red'	Full Pot	3L	450mm c/s
Prunus laurocerasus 'Otto Luyken'	300-400mm	3L	500mm c/s
Spiraea japonica 'Goldflame'	300-400mm	3L	500mm c/s

TALL ORNAMENTAL SHRUB PLANTING
(300mm depth of topsoil + minimum 300mm depth subsoil)
Ultimate plant height is above 1m.

Species	Supply Size	Pot	Spacing
Berberis thunbergii 'Atropurpurea'	300-400mm	3L	600mm c/s
Cornus alba 'Sibirica'	600-800mm	3L	600mm c/s
Escallonia rubra macrantha	400-600mm	3L	600mm c/s
Lonicera nitida 'Baggesen's Gold'	300-400mm	3L	600mm c/s
Osmanthus x burkwoodii	300-400mm	3L	600mm c/s
Skimmia japonica	300-400mm	3L	500mm c/s
Spiraea nipponica 'Snowmound'	400-600mm	3L	500mm c/s

MIXED SPECIES NATIVE HEDGEROW
(300mm depth of topsoil + minimum 600mm depth subsoil)
Planted at 450mm centres in a double staggered row.
Rows to be 500mm apart.

%	Species	Size	Age	Root/Pot
40%	Acer campestre	600-800mm	1+1	OG
25%	Corylus avellana	600-800mm	1+2	OG
10%	Ilex aquifolium	400-600mm	3L	
25%	Ligustrum vulgare	600-800mm	0/2	OG
100%	Total			

WOODLAND MIX PLANTING
(300mm depth of topsoil + minimum 600mm depth subsoil)
Where woodland or thicket is planted next to a hard surface/kerb/fence, it should be positioned 1m from the edge.
Feathered trees planted in single species groups of 3-5 at 3m apart.
Whip/transplants to be planted in groups of 3-9 of the same species at 750mm centres.

Feathered Trees - Well furnished with lateral roots to the base

%	Species	Size	Age	Root/Pot
15%	Quercus robur	1750-2000mm	2x	Transplanted OG
20%	Tilia cordata	1750-2000mm	2x	Transplanted OG
35%	Total			

Whip/Transplants

%	Species	Size	Age	Root/Pot
10%	Acer campestre	600-800mm	1+1	OG
10%	Corylus avellana	600-800mm	1+2	OG
10%	Crataegus monogyna	600-800mm	1+1	OG
5%	Lonicera periclymenum	600-800mm	-	3L
15%	Prunus padus	600-800mm	1+1	OG
10%	Pinus sylvestris	600-800mm	2+2	OG
5%	Rosa canina	600-800mm	1+1	OG
55%	Total			

Note: The following species should be planted no closer than the stated minimum distances away from hard landscape surfaces & retaining structures.

Tree Species	Min. distance from retaining structure (m)
Acer campestre	4m
Prunus padus	3m
Pinus sylvestris	5.5m
Quercus robur	5.5m

GRASS SEEDED AREAS (CLOSE MOWN)
(150mm depth of topsoil + minimum 150mm depth subsoil)
To be sown with DLF Seeds Ltd PM 120 'Slowgrowth' or similar approved
Sown at a rate of 35-50g/m²

SPECIES RICH GRASSLAND & WILDFLOWER SEEDED AREAS
(Cultivated subsoil to a depth of 300mm)
To be sown with DLF Seeds Ltd Pro-Flora 10 'Country Meadow' or similar approved
Sown at a rate of 5g/m²

BULB PLANTING

%	Species	Grade	Density
25%	Galanthus nivalis	10+	20no. per m ²
25%	Narcissus 'Geranium'	10+	20no. per m ²
25%	Narcissus 'Orange Sunset'	10+	20no. per m ²
25%	Narcissus pseudonarcissus 'Lobularis'	4/5	20no. per m ²

ARMCO BARRIER

ROOT BARRIER
'Re-Root Ribbed'
Depth 1000mm
Supplied by Green Blue Urban

SITE BOUNDARY

OWNERSHIP BOUNDARY

WOODLAND MIX PLANTING (672m²)

%	Species	Qty.
15%	Quercus robur	171
20%	Tilia cordata	228
35%	Total	399

Whip/Transplants

%	Species	Qty.
10%	Acer campestre	114
10%	Corylus avellana	114
10%	Crataegus monogyna	114
5%	Lonicera periclymenum	57
15%	Prunus padus	171
10%	Pinus sylvestris	114
5%	Rosa canina	57
55%	Total	741

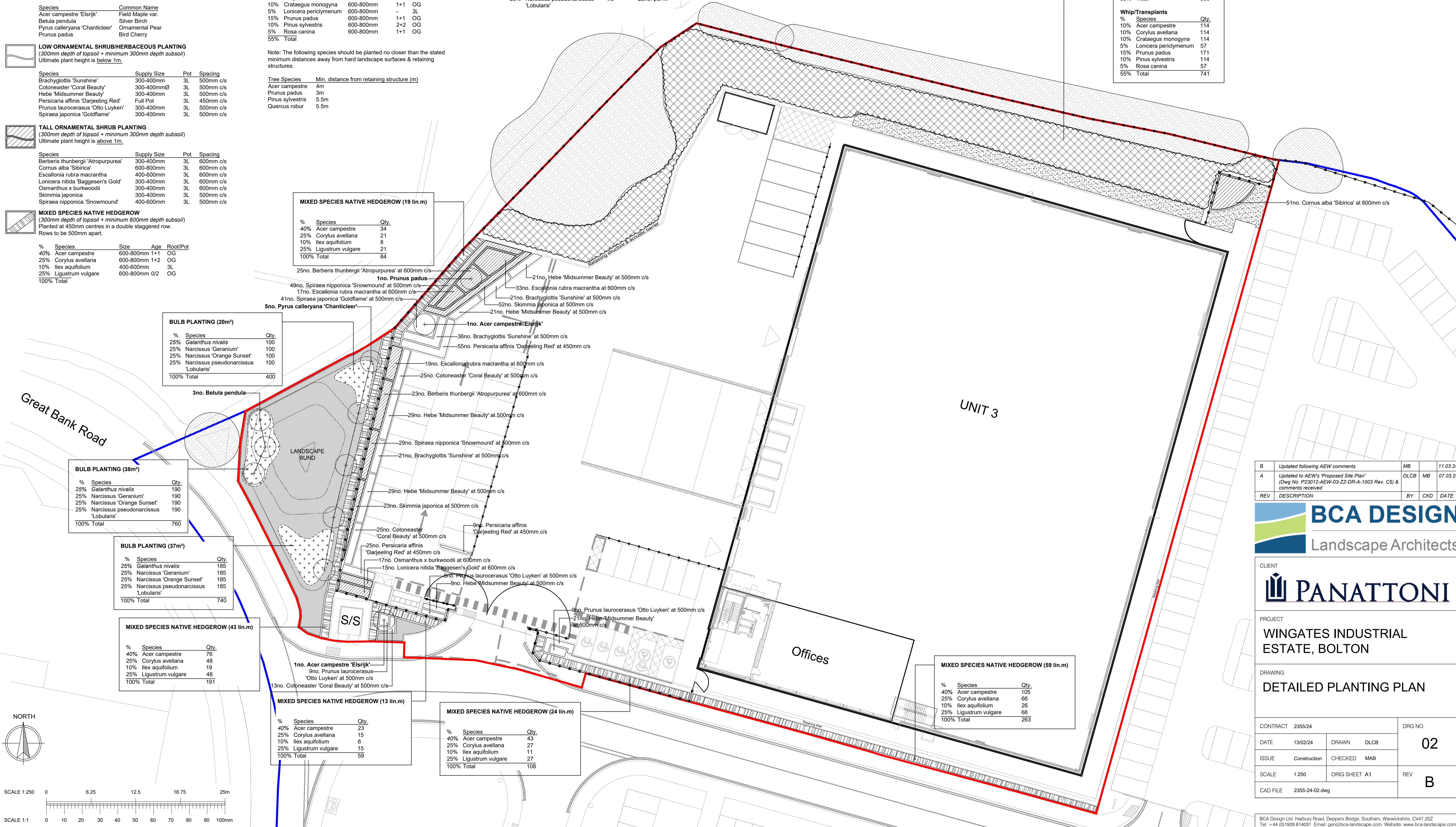

NOTES:
This drawing is based on AEW Architect's 'Proposed Site Plan' (Dwg. No. P23012-AEW-03-ZZ-DR-A-1003 Rev. C5) & the Tyler Grange 'Soft Landscape Proposals' (Dwg. No. 12176_P10 Rev. C)

Root barriers to be used where proposed trees are installed next to underground services and/or apparatus. Refer to Winvic's 'Unit 3 Combined M&E External Services Layout' (Dwg. No. P23012-EBM-EX-XX-DR-E-0935 Rev. C2) for details

REV	DESCRIPTION	BY	CHKD	DATE
B	Updated following AEW comments	MB		11.03.24
A	Updated to AEW's 'Proposed Site Plan' (Dwg No. P23012-AEW-03-ZZ-DR-A-1003 Rev. C5) & comments received	DLCB	MB	07.03.24

BCA DESIGN
Landscape Architects

CLIENT
PANATTONI

PROJECT
WINGATES INDUSTRIAL ESTATE, BOLTON

DRAWING
DETAILED PLANTING PLAN

DATE	13/02/24	DRAWN	DLCB	DRG NO.	02
ISSUE	Construction	CHECKED	MAB	REV	B
SCALE	1:250	ORIG SHEET	A1		
CAD FILE	2355-24-02.dwg				