

Land at Fryern Court Road

This drawing is copyright and is not to be reproduced. The contractor will be held responsible for the accuracy of works involving the setting out and checking of all dimensions on the drawing and on site. Dimensions must not be scaled from this drawing.

Unless for planning purposes



Existing Site plan 1:1000



Site Location plan 1:1250

Rev - **outline application**

Client: Mrs Barr		Planning	
Project: Land to the rear of No.7, Fryern Court Road, Fordingbridge SP6 1NG		Drawing No: 0428-02-001	Revision:
Title: Existing Location plan	Drawn: nb	Scale: 1:2500 & 1000 @a3	First Issue: March 2024

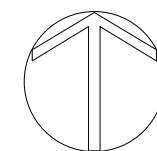

bircharchitects
Lambourne, Grove Lane, Redlynch, Salisbury, Wilts, SP5 2NR
T: +44 (0)1725 510407
e: info@bircharchitects.co.uk

Land at Fryern Court Road

This drawing is copyright and is not to be reproduced. The contractor will be held responsible for the accuracy of works involving the setting out and checking of all dimensions on the drawing and on site. Dimensions must not be scaled from this drawing.

Unless for planning purposes

Topographical Plan
ADS Surveys Ltd office:

Andell House,
Highfield Lane,
Woodfalls,
Salisbury,
Wiltshire,
SP5 2NG

T: 07738462205



Existing Site plan 1:1000

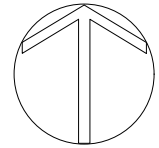

outline application



Client: Mrs Barr	Planning	
Project: Land to the rear of No.7, Fryern Court Road, Fordingbridge SP6 1NG	Drawing No: 0428-02-001	Revision:
Title: Existing Topo plan	Drawn: nb	Scale: 1:2500 & 1000 @α3
	Check:	First Issue: March 2024

bircharchitects
Lambourne, Grove Lane, Redlynch, Salisbury, Wilts, SP5 2NR
T: +44 (0)1725 510407
e: info@bircharchitects.co.uk

Land at Fryern Court Road

This drawing is copyright and is not to be reproduced. The contractor will be held responsible for the accuracy of works involving the setting out and checking of all dimensions on the drawing and on site. Dimensions must not be scaled from this drawing.

Unless for planning purposes



Proposed Site plan 1:500



Site Location plan 1:1250

outline application

Rev -

Client: Mrs Barr		Planning	
Project: Land to the rear of No.7, Fryern Court Road, Fordingbridge SP6 1NG		Drawing No: 0428-02-003	Revision:
Title: Proposed Location plan	Drawn: nb	Scale: 1:1250 & 500 @a3	First Issue: March 2024
Check:			

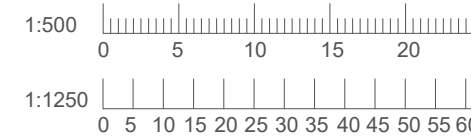
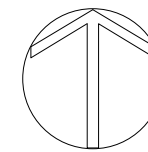

bircharchitects
Lambourne, Grove Lane, Redlynch, Salisbury, Wilts, SP5 2NR
T: +44 (0)1725 510407
e: info@bircharchitects.co.uk

Land at Fryern Court Road

This drawing is copyright and is not to be reproduced. The contractor will be held responsible for the accuracy of works involving the setting out and checking of all dimensions on the drawing and on site. Dimensions must not be scaled from this drawing. Unless for planning purposes

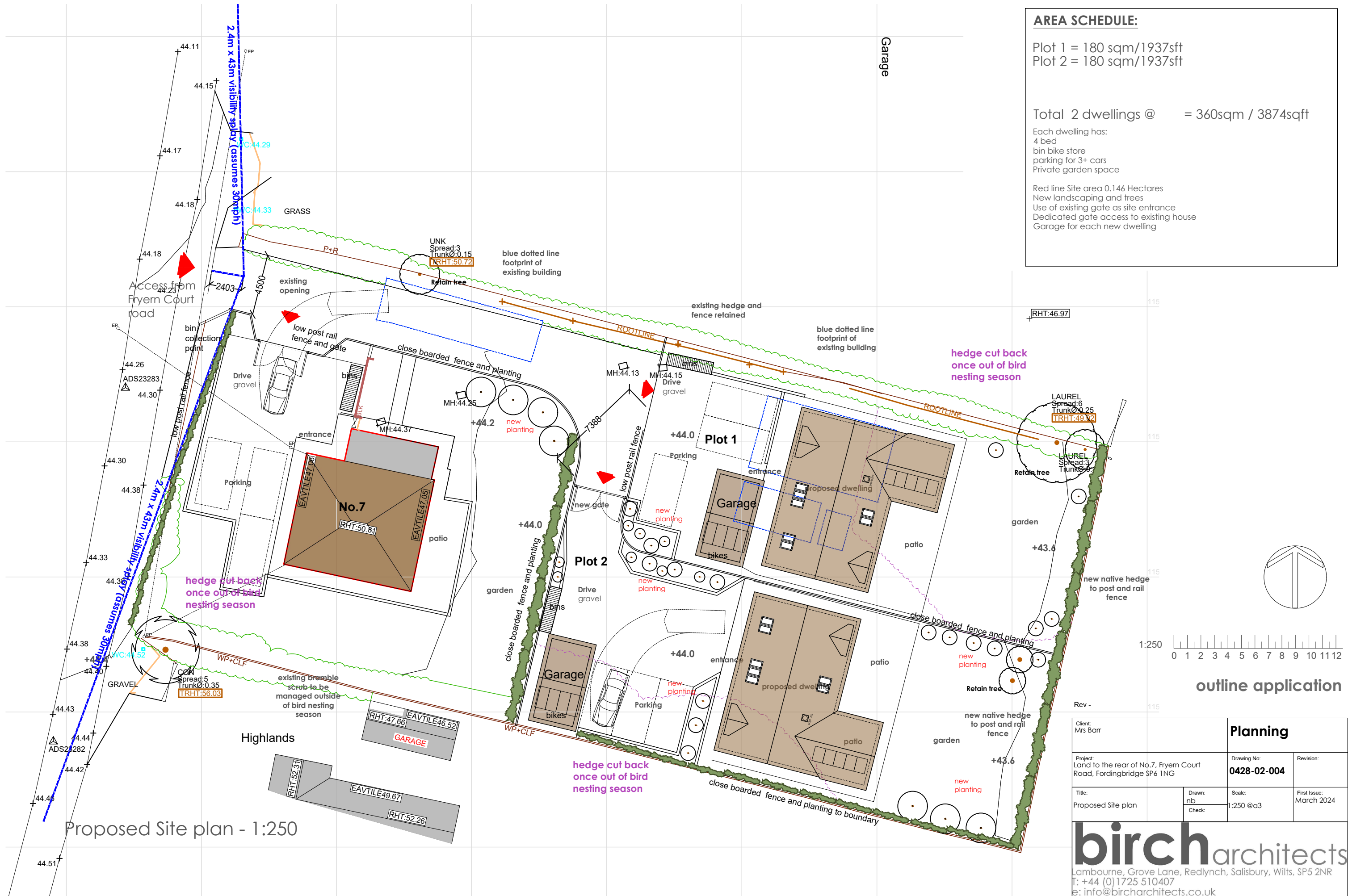

AREA SCHEDULE:

Plot 1 = 180 sqm/1937sft
Plot 2 = 180 sqm/1937sft
Total 2 dwellings @ = 360sqm / 3874sqft
Each dwelling has: 4 bed bin bike store parking for 3+ cars Private garden space
Red line Site area 0.146 Hectares New landscaping and trees Use of existing gate as site entrance Dedicated gate access to existing house Garage for each new dwelling



outline application

Client: Mrs Barr	Planning	
Project: Land to the rear of No.7, Fryern Court Road, Fordingbridge SP6 1NG	Drawing No: 0428-02-004	Revision:
Title: Proposed Site plan	Drawn: nb	Scale: 1:250 @a3
	Check:	First Issue: March 2024

birch architects
Lambourne, Grove Lane, Redlynch, Salisbury, Wilts, SP5 2NR
T: +44 (0)1725 510407
e: info@bircharchitects.co.uk

Proposed Site plan - 1:250

Land at Fryern Court Road

This drawing is copyright and is not to be reproduced. The contractor will be held responsible for the accuracy of works involving the setting out and checking of all dimensions on the drawing and on site. Dimensions must not be scaled from this drawing. Unless for planning purposes

