

Existing floor plan - GROUND FLOOR

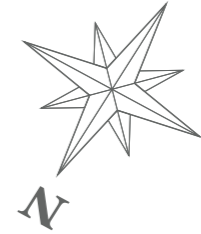

Proposed floor plan - GROUND FLOOR

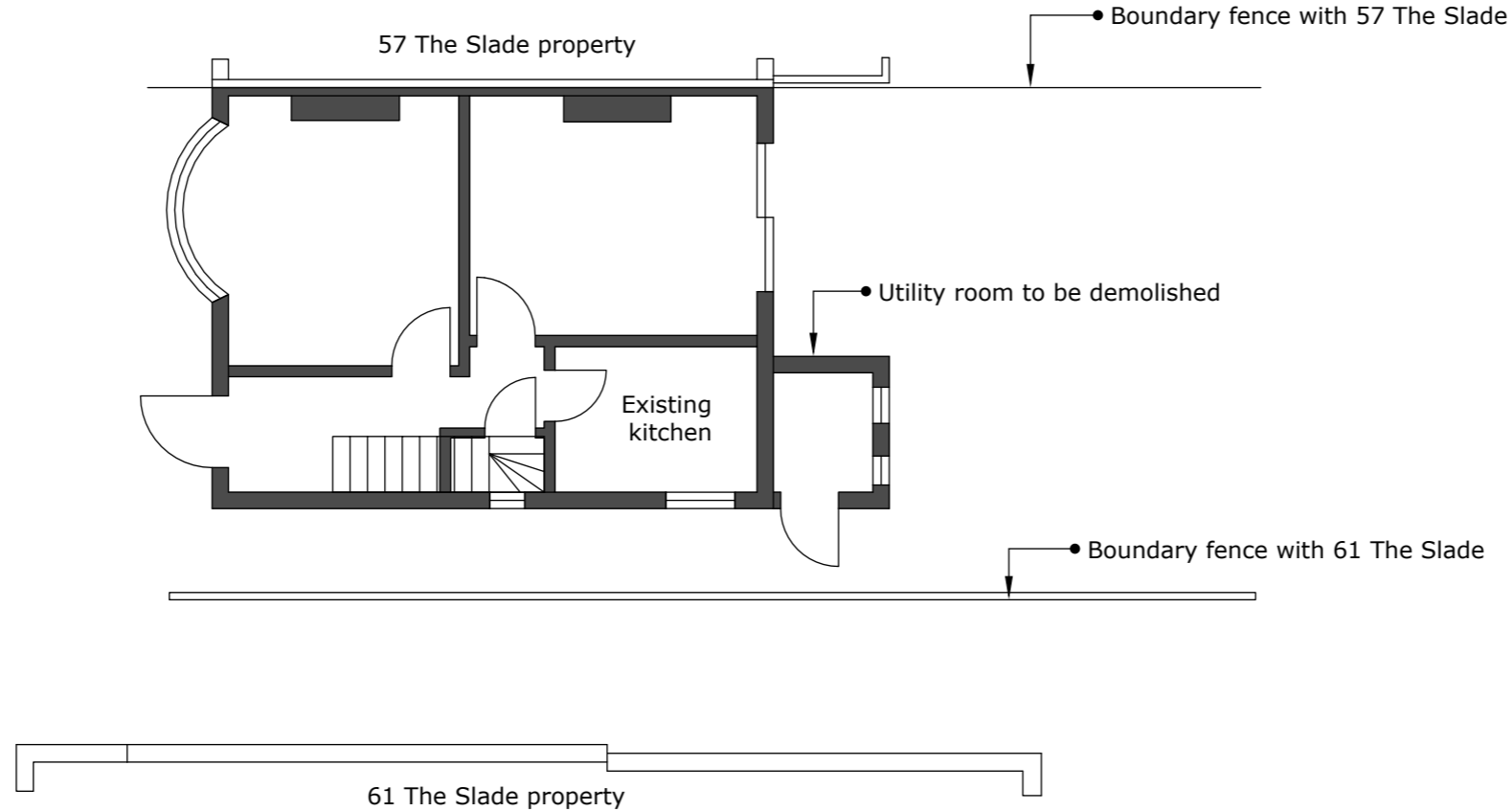
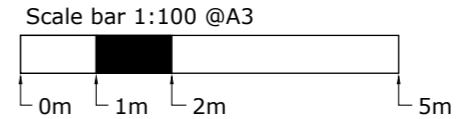
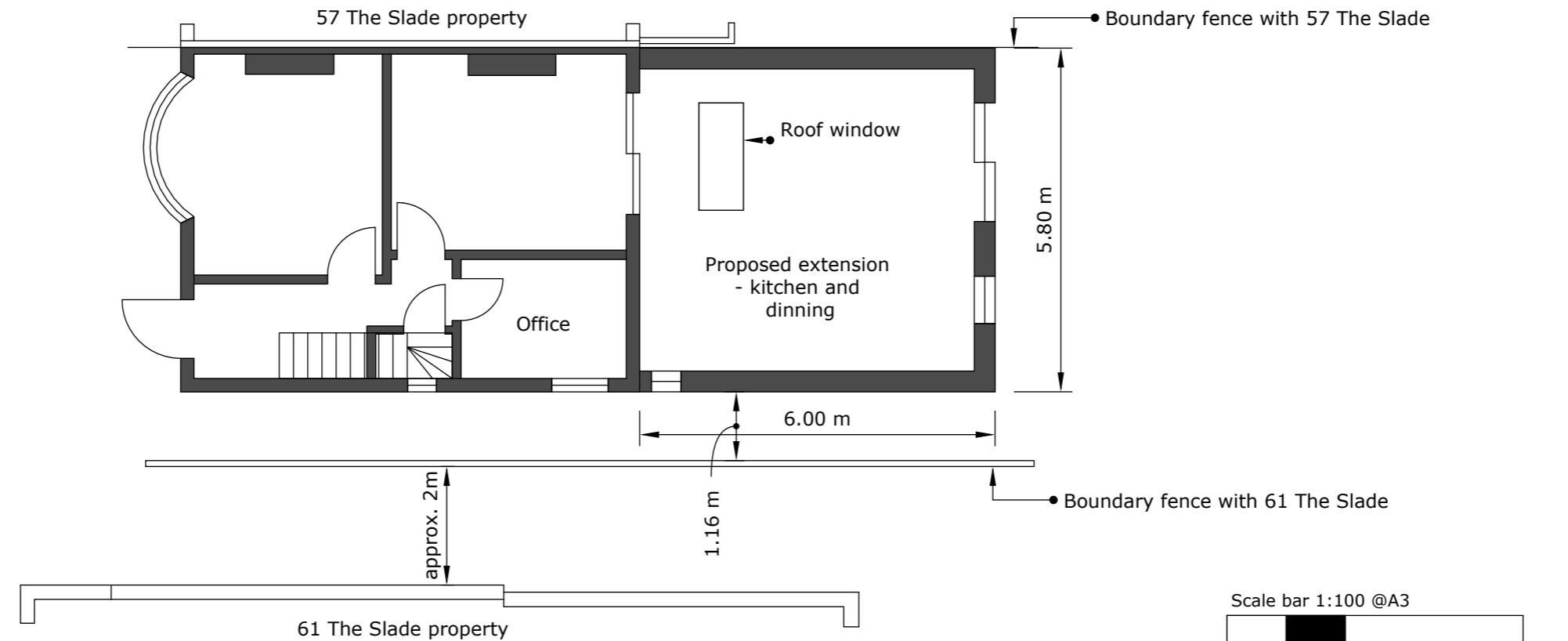

Existing outside utility room to be demolished.

Erect a single storey extension to be used as a kitchen and dining room.

The single storey rear extension extends by 6.0m, for which maximum height would be 3.05m, and for which the height of the eaves would be 2.85m.

The current kitchen will be converted into an office.

PROJECT

Demolition of a rear outside utility room. Erection of a single storey rear extension to the dwelling.

**59 The Slade
Oxford, OX3 7HN**

DRAWING

**Floor Plan -
Ground Floor**

**DRAWING NUMBER
A1**

CLIENT

Katarzyna Hutnik
Grzegorz Agacinski

DATE

March 2024

SCALE @ A3

1:100