

Y STATIONS	No	Northings	Height
78	432203.600	50.367	
79	432208.307	50.215	
80	432214.265	50.239	
81	432224.754	51.234	
82	432227.753	49.880	
83	432210.154	48.555	
84	432219.185	47.550	
85	432191.882	45.892	

Drainage Strategy - Scale (1:200)

Drainage Strategy

The site is located within flood zone 1 with a low risk of flooding from rivers or the sea and is less than 1 hectare, therefore a site specific flood risk assessment should not be required.

Under SuDs guidance the first point of discharge for surface water is percolation via soakaway. Site percolation was carried on 28th April 2022 and is proven infiltration via soakaway is not viable. Please refer to Topping Engineers report.

The existing site is a greenfield with an area of a 1500m². The proposed site consist of one dwelling, therefore we propose to discharge surface water at 0.5l/s due to blockages.

NPPF guidelines require that surface water arising from a developed site should as far as practicable be managed in a sustainable manner to mimic the surface water flows arising from the site prior to development.

Surface Water:
Flow restriction 0.5l/s will be achieved using a 16mm orifice plate.

The proposed impermeable area is 827m² + 10% urban creep equates to 909m². Based on a flow restriction of 0.5l/s and modeling using Micro Drainage software the attenuation requirement for a peak return period of 1 in 100year plus 30% climate change is 60.8m³.

Attenuation for the proposed impermeable area of 909m² to be provided via GEO-CELLULAR TANK 9.5x8x0.8m DEEP = 60.8m³. The flows will be restricted using a 16mm orifice plate.

Surface water from the proposed site will connect into an open drainage ditch subject to consent from the IDB and land owner of the farm to the south of site.

Foul Water:
The foul water is proposed to connect to a Klargester Biotec 6 treatment tank and discharge treated water into an open drainage ditch, subject to consent from the IDB and land owner of the farm to the south of site.

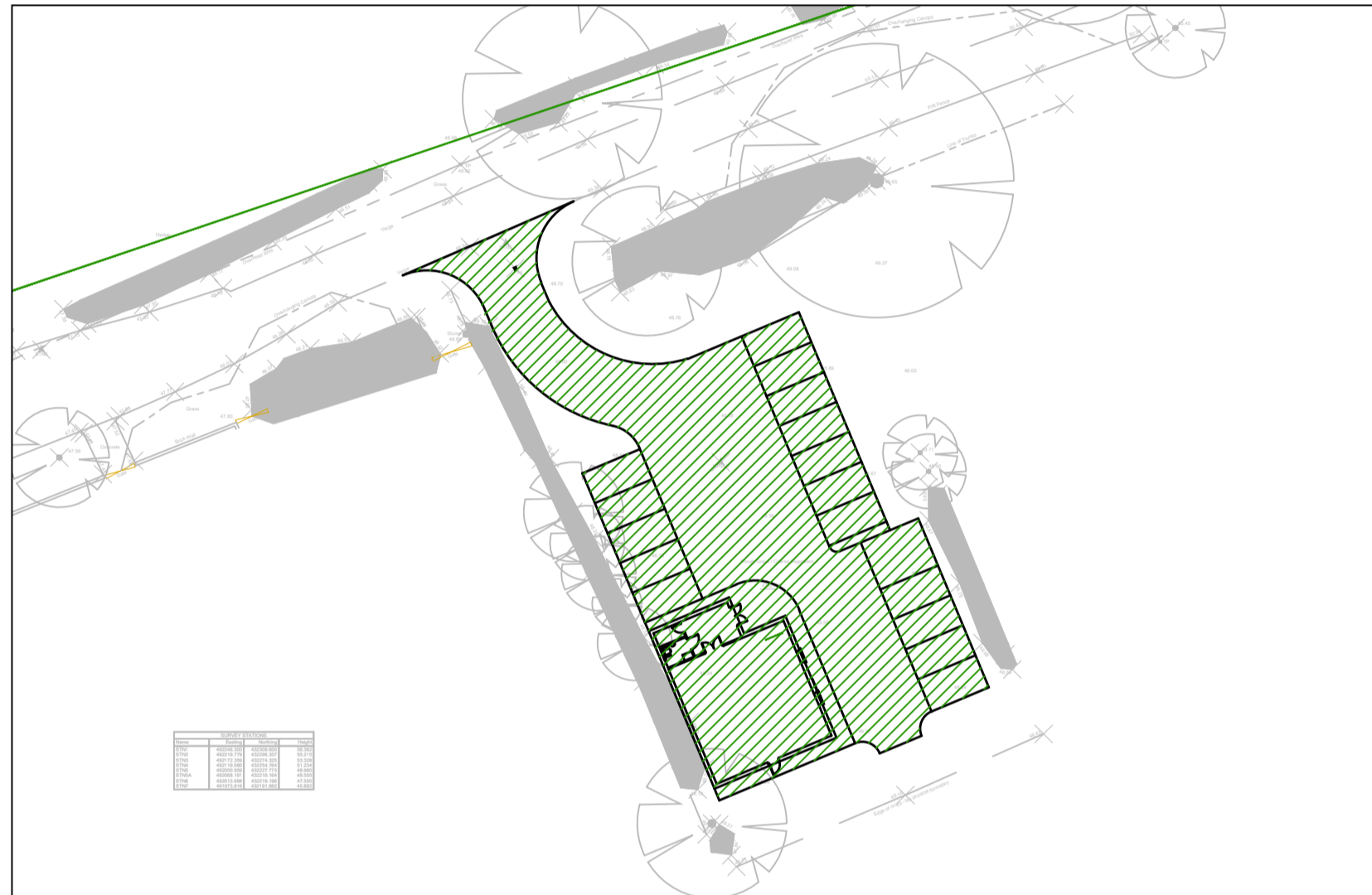

Proposed Impermeable Area Plan = 909m² - Scale (NTS)

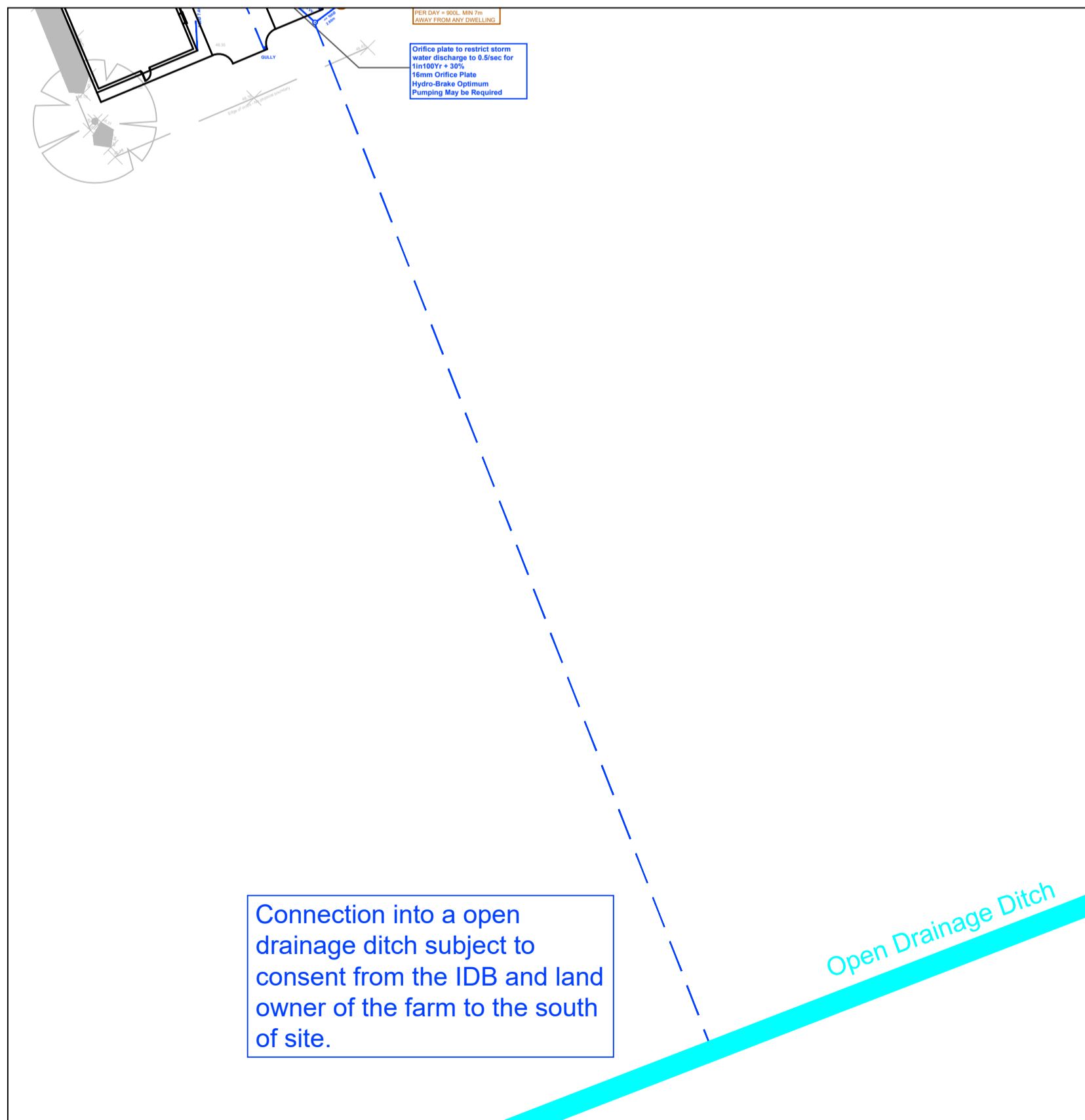

Off Site Drainage - Scale (NTS)

This drawing is copyright of Topping Engineers LTD and must not be copied or reproduced in anyway without written consent.
DO NOT SCALE OFF THIS DRAWING

Notes:
1. This drawing is to be read in conjunction with all relevant architect's and engineer's drawings.
2. It is assumed that all works will be carried out by a competent contractor working, where appropriate, to an approved method statement.

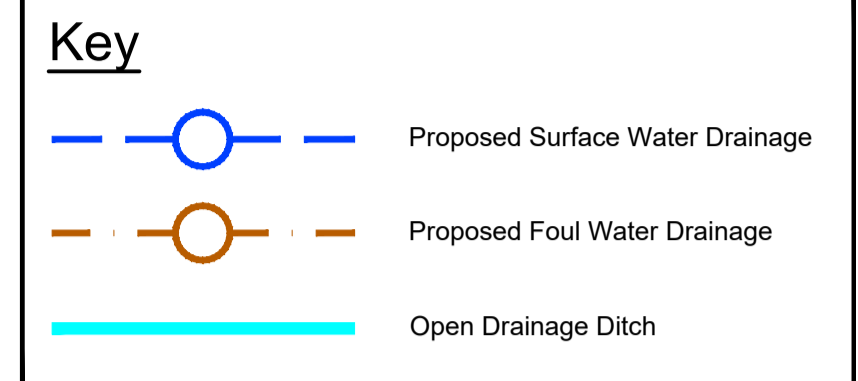

P1	First Revision	09/05/22	JS
----	----------------	----------	----

No.	Revision	Date	Drwn
-----	----------	------	------

Status: **Preliminary**

Unit 223 Ducie House
Ducie Street Manchester M1 2JW
t: 0161 806 1701
www.topping-engineers.com

Client: **Mark Lant**

Project: **Drewton Paddock South Cave**

Drawing title: **Drainage Strategy**

Drawn	Chkd	RT	Date	Scale
SF			JULY 2022	As Shown @ A1
Contract No.	22236	Drig No.	DR-C-0100	Revision
				P2