

Notes:
 Please report all discrepancies, errors and omissions.
 Verify all dimensions on site before commencing any work on site or preparing shop drawings.
 All materials, components and workmanship are to comply with the relevant British Standards, Codes of Practice, and appropriate manufacturers recommendations that from time to time shall apply.
 For all specialist work, see relevant drawings.
 This drawing and design are copyright of RMB Consultants (Civil Engineering) Ltd.
 When this document is provided in electronic file format it is intended as a guide only and the recipient is to verify all dimensions and details with the Architects. If this is not acceptable, the files must be returned unused together with a written communication declining acceptance of this condition.

Key

- Public foul sewer
- Public SW sewer
- Foul drainage
- SW drainage
- Channel Drain
- ▶ Rodding eye

Reference / diameter gradient / length

F1 000 / 100
80.0 / 2.000

Tree Protection

 No dig hard surfacing

 New wearing course over existing hardstanding

Levels based on topographical survey and finished floor levels.

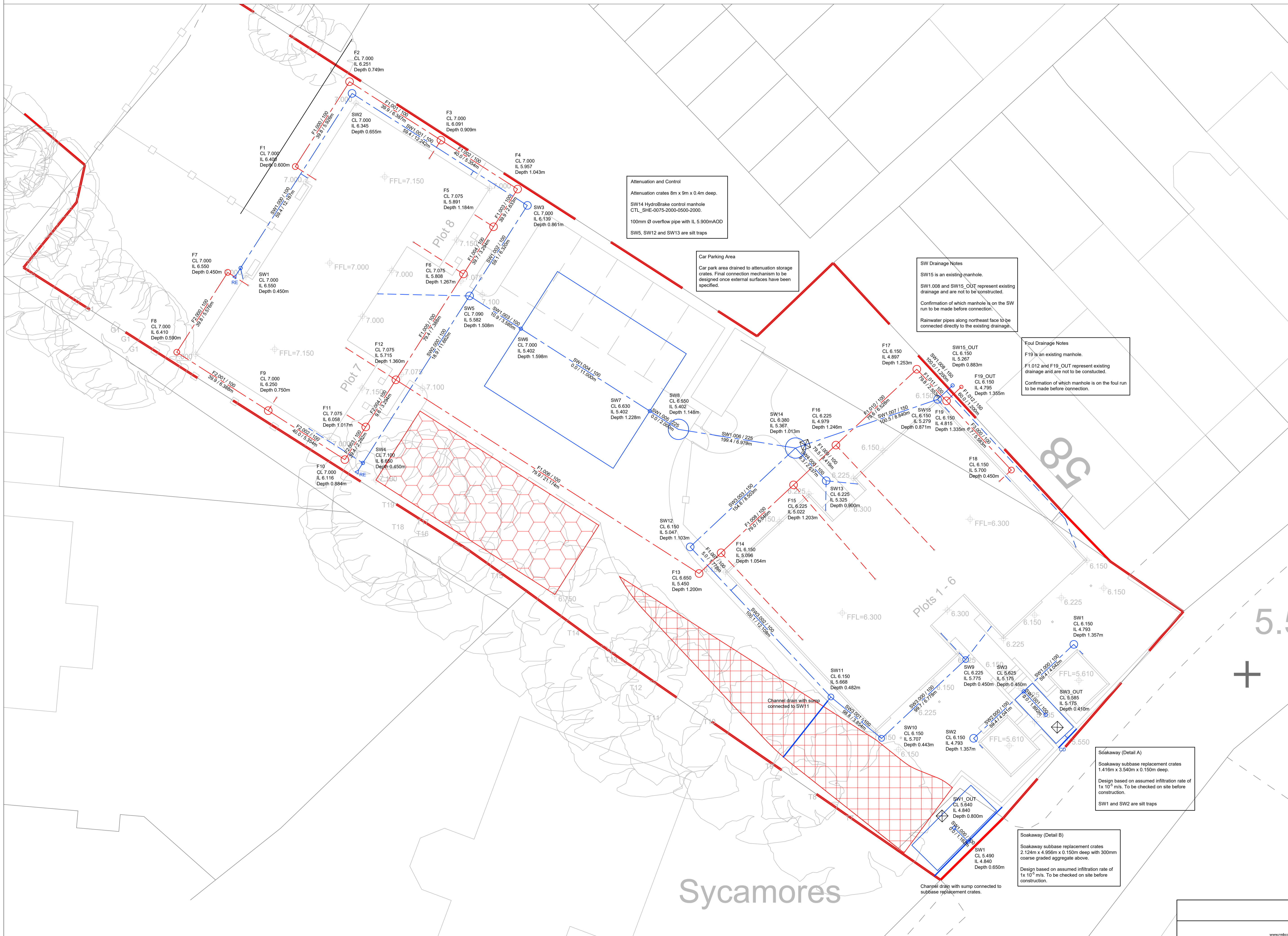

Rev.

0 5m

N

Sycamores

39 Cossington Road Canterbury Kent CT1 3HU Tel/Fax: 01227 471238 • Mobile: 07886 185705 www.rmbconsultants.co.uk • robert.beech@rmbconsultants.co.uk		RMB	
client Fleet House	project Fleet House Upnor Road Lower Upnor ME2 4UP	drawing no. Drainage Layout - Plots 1 - 8	scale 1:100 @ A1
date March 2024	drawn by RB	drawing no. 1262/202	drawn by RB