

EXTERNAL ELEVATION

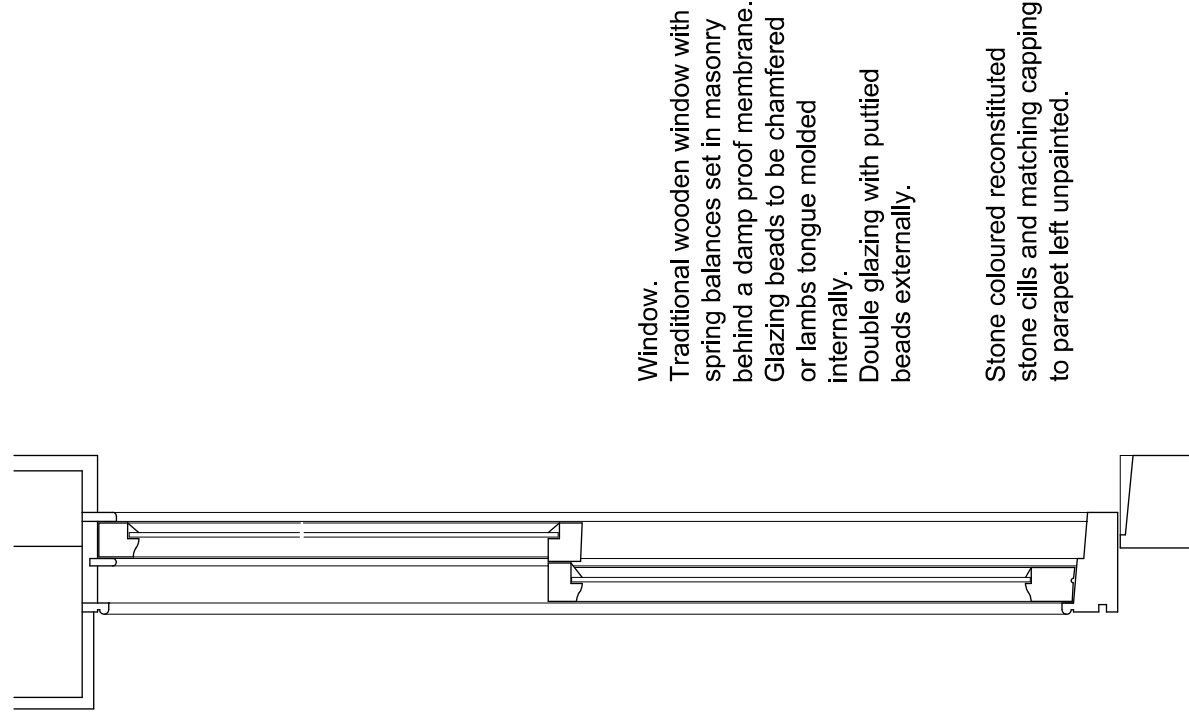

SECTION

Window.  
 Traditional wooden window with  
 spring balances set in masonry  
 behind a damp proof membrane.  
 Glazing beads to be chamfered  
 or lambs tongue molded  
 internally.  
 Double glazing with putted  
 beads externally.

Stone coloured reconstituted  
 stone cills and matching capping  
 to parapet left unpainted.

--	--	--	--	--	--	--	--	--	--

Revisions

Project	4-6 BATH ROAD CHELTENHAM
Condition	CONDITION 4A DISCHARGE NEW WINDOWS & CILLS PARAPET COPING
Drawing No.	484- CD11 A,C,D
Scale	1:10 @ A3
Date	February 2024
ARCHITECNICS 01242 234351 BUILDING DESIGN AND PROJECT MANAGEMENT 27 Cambray Place Cheltenham GL50 1JN	

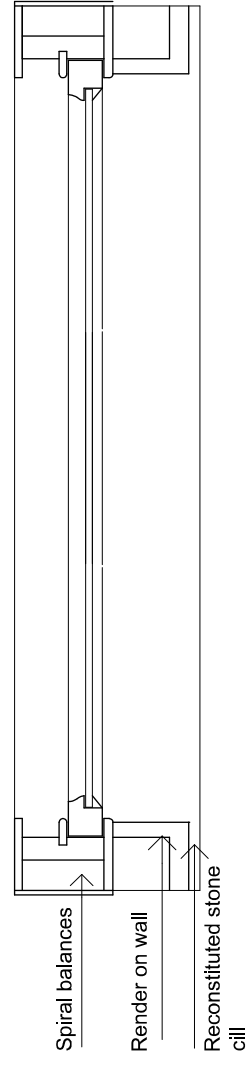

PLAN