

NOTE:- All existing dimensions must be checked on site by the contractor prior to work commencing. Any discrepancies must be reported prior to works starting. DO NOT SCALE !

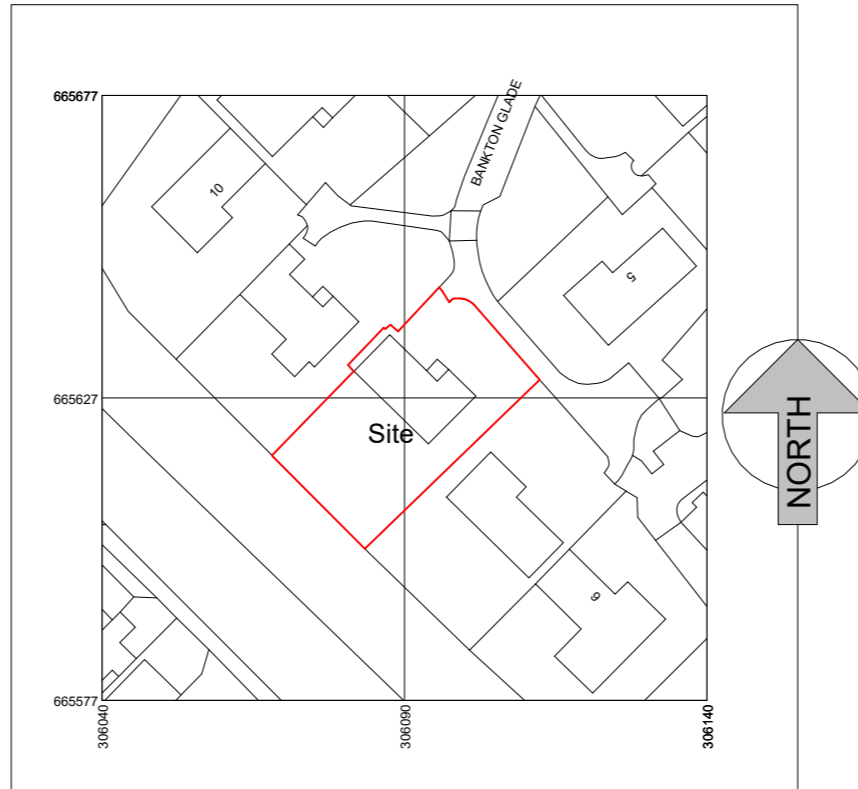

Produced on 09 January 2024 from the Ordnance Survey National Geographic Database and incorporating surveyed revision available at this date.
 This map shows the area bounded by 306040 665577,306140 665577,306140 665677,306040 665677,306040 665577
 Crown copyright and database rights 2024 OS 100054135. Supplied by copla ltd trading as UKPlanningMaps.com a licensed Ordnance Survey partner (OS 100054135).
 Data licence expires 09 January 2025. Unique plan reference: v1e/1043697/1406496



1 OS Location Plan
 1 : 1250

Note : Area bounded in red is owned by the applicant, and they own no other adjacent land.

© i Line Designs (Scotland) Ltd 2023

i Line Designs
 (Scotland) Limited
 36 Glenview Drive, Falkirk FK1 5JU
 T : 01324 871898 M : 07590 008376
 E : info@ilinedesigns.com W : www.ilinedesigns.com

No.	Description	Date	Client : Mr & Mrs Douglas		Title OS Location Plan		
			Project Address : 8 Bankton Glade, Livingston EH54 9DG	Project : Proposed Single Storey Extension to Rear	Stage Planning	Drawing no 101	Rev
					Job no 24101		
					Date March 2024		