

KEY:

- ① Timber clad sheds.
- ② Sedum roof.
- ③ Timber clad PPC galvanised steel framed telescopic sliding vehicle gates.
- ④ Personnel door.
- ⑤ Infill panel with letter/parcel box.
- ⑥ EV charging point.

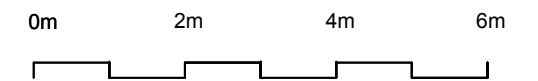
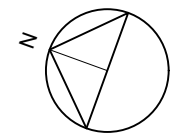
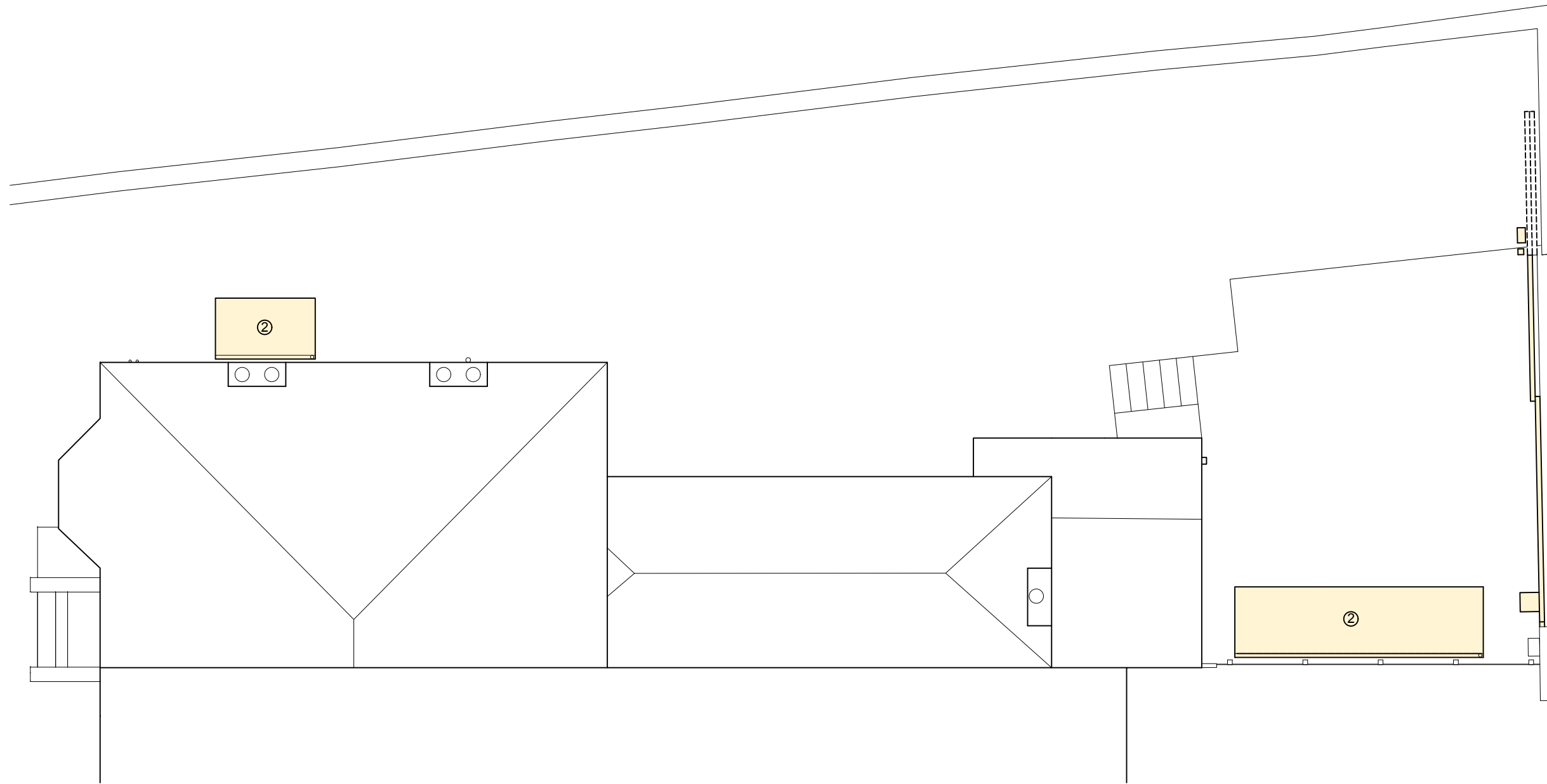

SCALE 1:100

- Denotes demolition/downtakings of existing fabric.
- Denotes new construction/alterations.

01 PROPOSED ROOF PLAN  
P-04

Langley, Main Street, Gullane, East Lothian, EH31 2DR e-mail: fiona@fionalumsdenarchitect.com www.fionalumsdenarchitect.com Tel: 01620 842971 Mob: 07908 125118	A 180124 Client Issue B 310124 Planning Query B 280324 Planning Application	PLANNING
<b>Fiona Lumsden   Architect</b>	Seadrift, 1 Marine Terrace, Gullane, EH31 2AY Landscaping	1:100@A3 Proposed Roof Plan <b>048-P-04B</b>

**Notes:** This drawing has been prepared for the sole purpose of applying for Planning Consent. No liability will be accepted for any omission should the information contained herein be used for any other purpose. **Copyright** belongs to Fiona Lumsden Architect Limited. Company Registered in Scotland No. 743660.