

All dimensions are to be checked and confirmed on site. All discrepancies are to be reported to this Office.
 This drawing and design is protected under copyright, and it shall not be reproduced in whole or part without our prior consent.

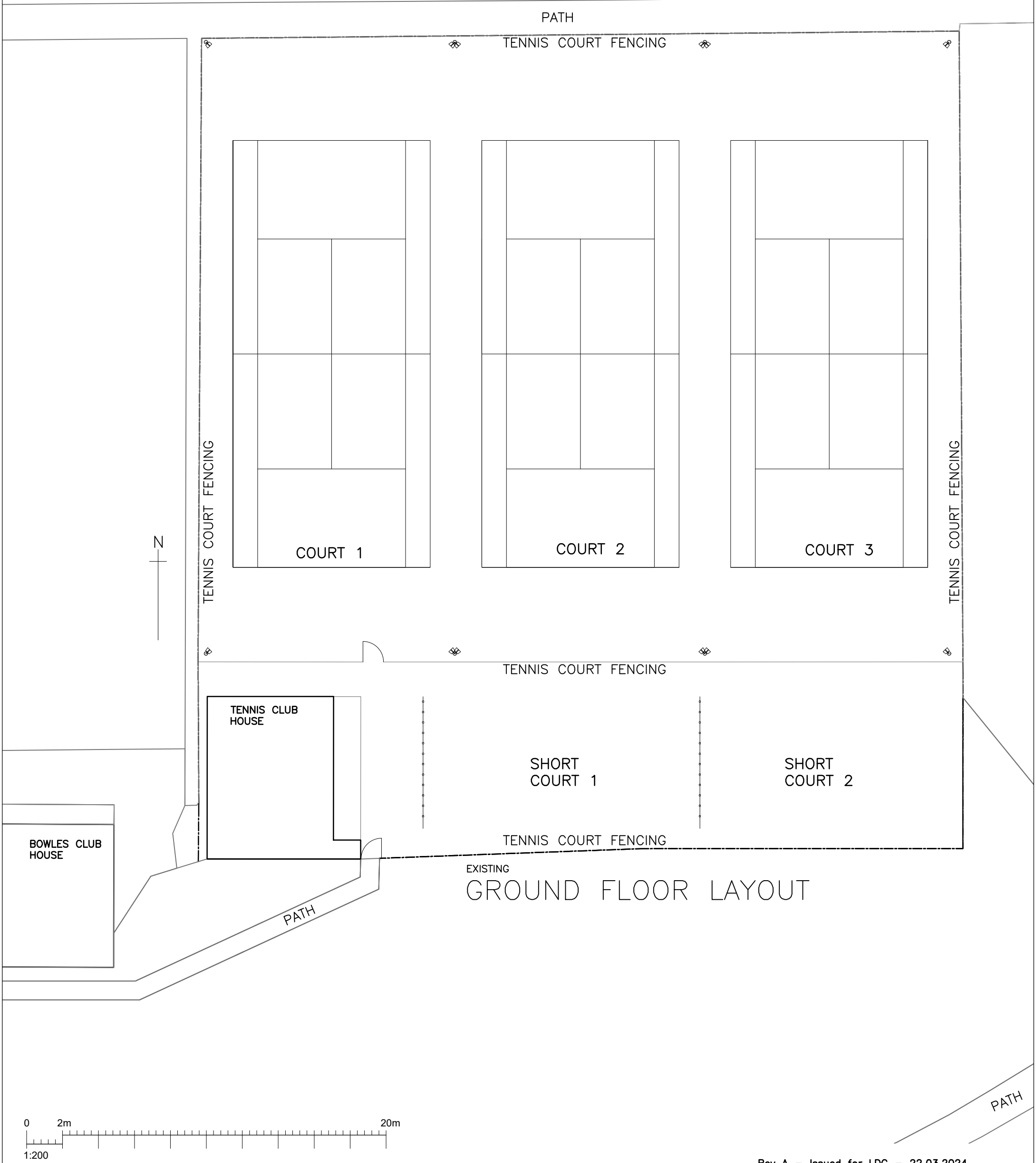

EXISTING
 GROUND FLOOR LAYOUT

Rev A - Issued for LDC - 22.03.2024

FAVERSHAM TENNIS CLUB, RECREATION GROUND
 FAVERSHAM ME13 8ES
 PROPOSED ARTIFICIAL CLAY SURFACE.
 PROPOSED GROUND LAYOUT & ELEVATION

SCALE	1:200 @ A3		
DATE	Mar 2024	DRAWN BY	P,O,
CLIENT			
DRAWING NO.	810 - 03	REV.	P1

OLSON DESIGN GROUP
 INTERIOR & ARCHITECTURAL DESIGN
 ISLAND VIEW, 23 HAMPTON PIER AVE
 HERNE BAY KENT CT6 8EW
 pennylolson7@hotmail.com
 07788972736